

Bldg. Dimensions : 1352' x 300'

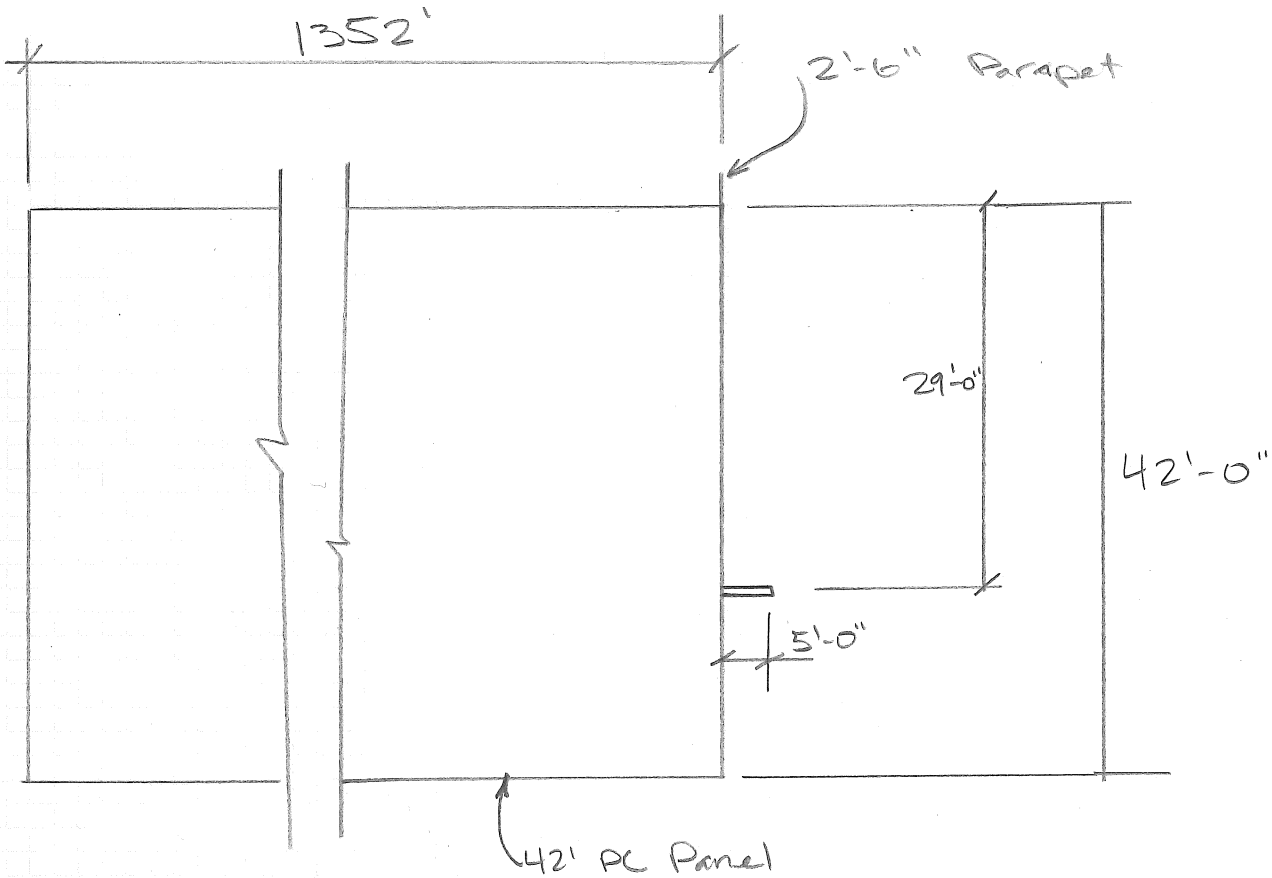

Per AISC :

$$h_d = 0.433 \sqrt{1352} \sqrt{30+10} - 1.5 = 10.5'$$

$$\gamma h_d = 188 \text{ psf.}$$

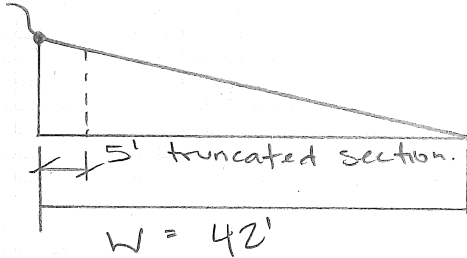

RUNDE ENGINEERING, INC.
Structural Engineers

39 W. New York Street Tel. 630.966.0250
 Aurora, Illinois 60506 Fax. 630.966.0255
 Professional Design Firm #184-004461

PREPARED	SCALE	DESCRIPTION	DATE
CHECKED	APPROVED		JOB NO.
REVISIONS		TITLE	SHEET NO.
		CLIENT NO.	