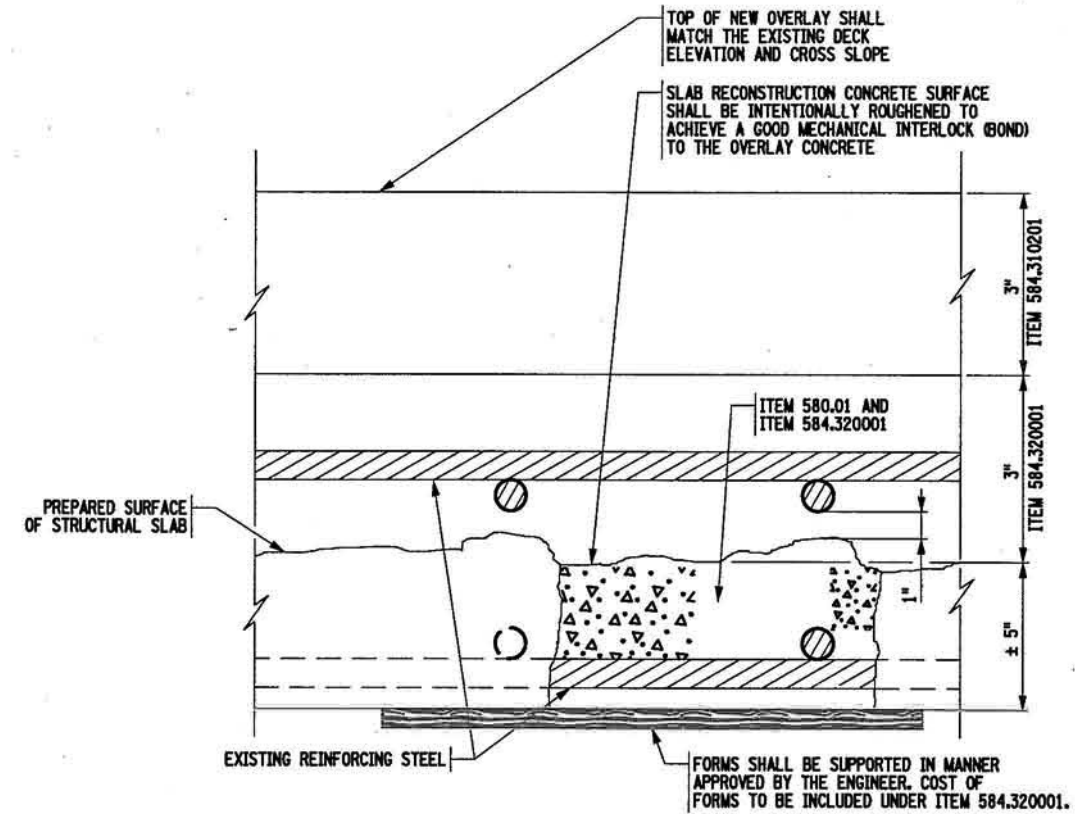

**REINFORCING BAR EXPOSURE - BOTH BARS OF UPPER BAR MAT**

(LIMITS OF COMPLETE CONCRETE REMOVAL FROM AROUND UPPER AND LOWER BARS.)

**REPAIR PROCEDURE LOCALIZED AREAS****NOTES:**

1. CONTRACTOR TO COORDINATE WITH EIC FOR LOCATIONS AND LIMITS OF WORK.
2. IT IS ASSUMED THAT 5% OF THE DECK AREA WILL REQUIRE A FULL DEPTH REPAIR AS SHOWN ABOVE.

AFFIX SEAL: ON: 12/4/13	ALTERED BY: ON:
	

AS-BUILT REVISIONS
DESCRIPTION OF ALTERATIONS:

BRIDGE REHABILITATION ROUTE 5 & 20 IN GENEVA
BIN 1001939 SH 52-10
COUNTY: ONTARIO

PIN 4005.59 5 & 20 UTILITY QUALITY LEVEL C
--

BRIDGES 1001939

CULVERTS

ALL DIMENSIONS IN FT UNLESS OTHERWISE NOTED
CONCRETE OVERLAY DETAILS
ROUTE 5 & 20 OVER NORFOLK SOUTHERN RAILROAD

CONTRACT NUMBER D262543
DRAWING NO. ST1-33 SHEET NO. 37

IT IS A VIOLATION OF LAW FOR ANY PERSON, UNLESS THEY ARE ACTING UNDER THE DIRECTION OF A LICENSED PROFESSIONAL ENGINEER, ARCHITECT, LANDSCAPE ARCHITECT, OR LAND SURVEYOR, TO ALTER AN ITEM IN ANY WAY. IF AN ITEM BEARING THE STAMP OF A LICENSED PROFESSIONAL IS ALTERED, THE ALTERING ENGINEER, ARCHITECT, LANDSCAPE ARCHITECT, OR LAND SURVEYOR SHALL STAMP THE DOCUMENT AND INCLUDE THE NOTATION "ALTERED BY" FOLLOWED BY THEIR SIGNATURE, THE DATE OF SUCH ALTERATION, AND A SPECIFIC DESCRIPTION OF THE ALTERATION.

NEW YORK STATE DEPARTMENT OF TRANSPORTATION REGION 04
DOCUMENT NAME: 400559.opb.crd.dgn

FILE NAME = 302119.107_CPB_GAL_ANOD.01_DTL.DGN
DATE/TIME = 02-JAN-2014 09:17
USER = rcollins

PROJECT MANAGER KURT BOWER
CHECK KURT BOWER
DRAFTING M. CHASE
CHECK NICK REEVES
DESIGN MIKE WERESZYNSKI
JOB MANAGER KURT BOWER
DESIGN SUPERVISOR JOHN SEXTON

GALVANIC ANODE INSTALLATION

1. GALVANIC ANODES SHALL BE FURNISHED AND PLACED ALONG THE PERIMETER OF THE REPAIR AREA AT SPACING SPECIFIED IN THE PLANS. IN NO CASE, SHALL THE DISTANCE BETWEEN ANODES EXCEED 2'-6".
2. PROVIDE SUFFICIENT CLEARANCE BETWEEN ANODES AND SUBSTRATE TO ALLOW REPAIR MATERIAL TO ENCASE THE ANODE.
3. SECURE THE GALVANIC ANODES AS CLOSE AS POSSIBLE TO THE PATCH EDGE USING THE ANODE TIE WIRES. THE TIE WIRES SHOULD BE TIGHTENED TO ALLOW LITTLE OR NO FREE MOVEMENT.
4. IF THE ANODE IS TO BE TIED ONTO A SINGLE BAR, OR IF LESS THAN 1 INCH OF CONCRETE COVER IS EXPECTED, PLACE ANODE BENEATH THE BAR, AND SECURE TO CLEAN (WIRE BRUSHED) REINFORCING STEEL.
5. IF SUFFICIENT CONCRETE COVER EXISTS, THE ANODE MAY BE PLACED AT THE INTERSECTION BETWEEN TWO BARS, AND SECURED TO EACH CLEAN BAR.
6. LOOSE REINFORCING STEEL SHALL BE SECURED BY TYING TIGHTLY TO EXISTING BARS WITH UNCOATED STEEL TIE WIRE.
7. GALVANIC ANODES SHALL BE PLACED IN ALL PEDESTAL REPAIR AREAS. GALVANIC ANODES SHALL NOT BE PLACED IN NEW PEDESTALS.
8. GALVANIC ANODES SHALL BE PLACED IN ALL SUBSTRUCTURE JOINT, AND DECK REPAIR AREAS AT THE NEW/EXISTING CONCRETE INTERFACE.

ELECTRICAL CONTINUITY

1. CONFIRM ELECTRICAL CONNECTION BETWEEN ANODE, TIE WIRE, AND REINFORCING STEEL WITH A MULTIMETER.
2. CONFIRM ELECTRICAL CONTINUITY OF THE EXPOSED REINFORCING STEEL WITHIN THE REPAIR AREA. IF NECESSARY, ELECTRICAL CONTINUITY SHALL BE ESTABLISHED WITH STEEL TIE WIRE.

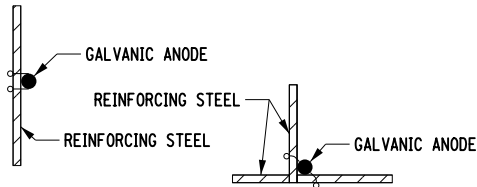

TYPICAL GALVANIC ANODE
BESIDE REBAR
NOT TO SCALE

TYPICAL GALVANIC ANODE
AT REBAR INTERSECTION
NOT TO SCALE

TYPICAL GALVANIC ANODE
BELOW REBAR
NOT TO SCALE

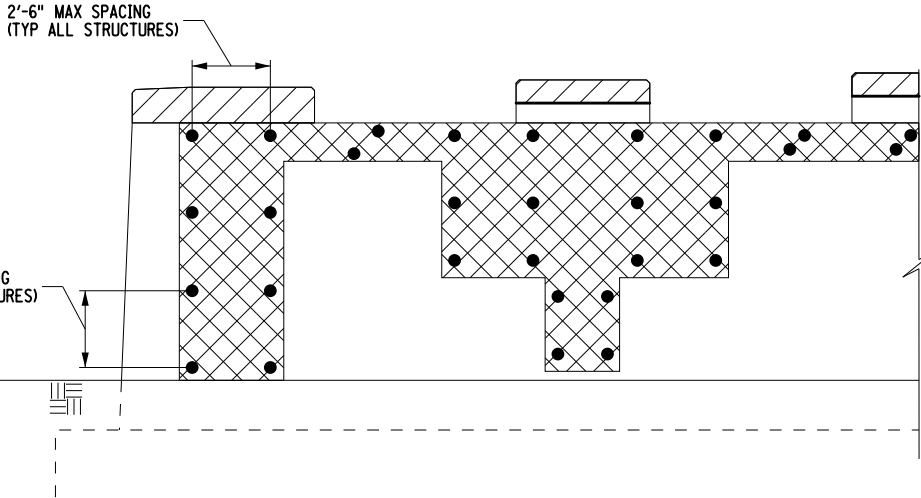
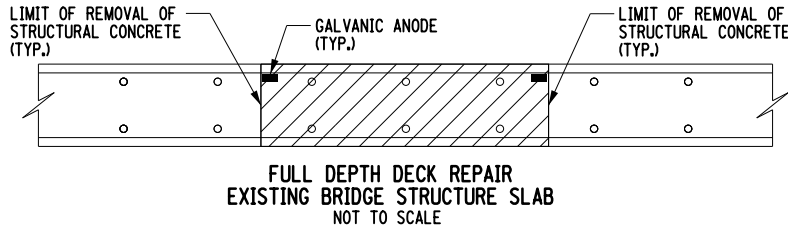
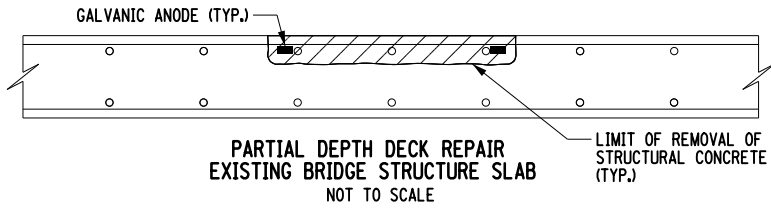

TYPICAL SUBSTRUCTURE REPAIR
EXAMPLE 1

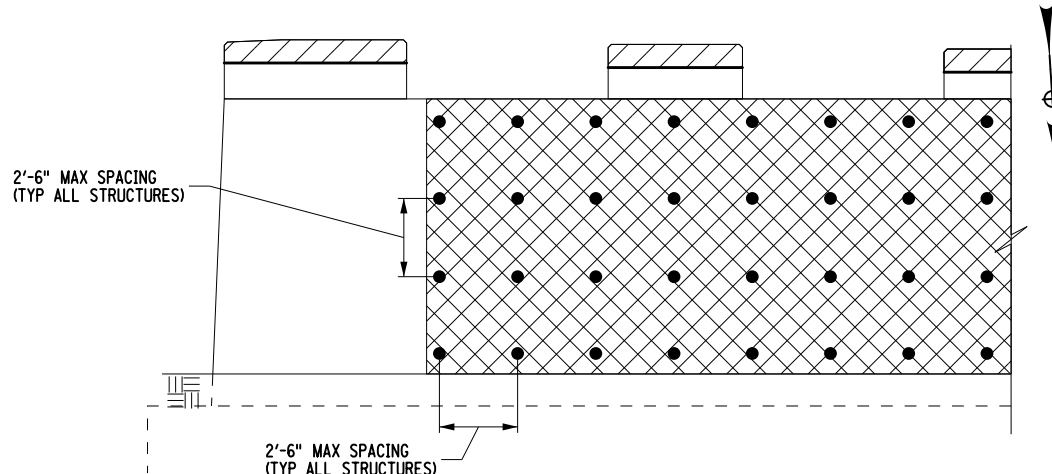

TYPICAL SUBSTRUCTURE REPAIR
EXAMPLE 2

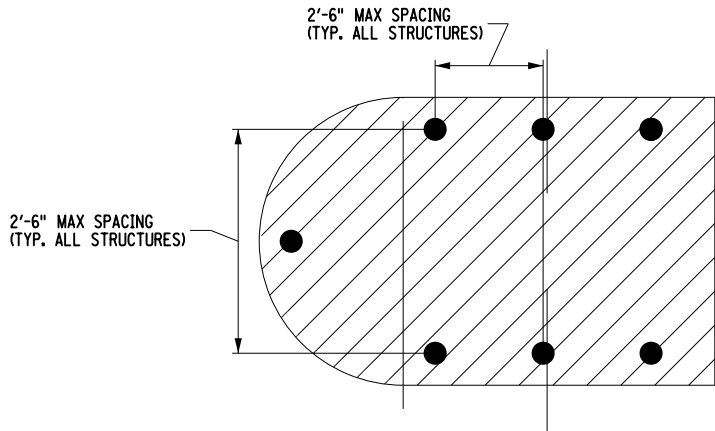

TYPICAL PEDESTAL REPAIR
NOT TO SCALE

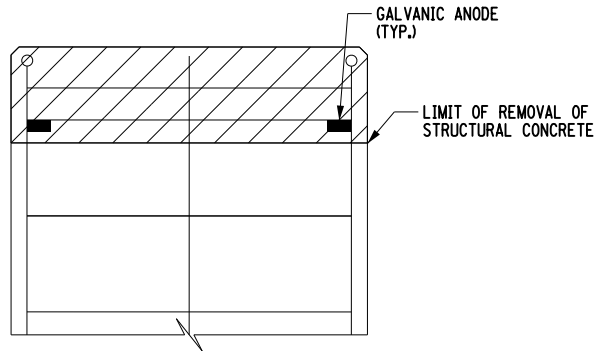

TYPICAL PEDESTAL REPAIR
NOT TO SCALE

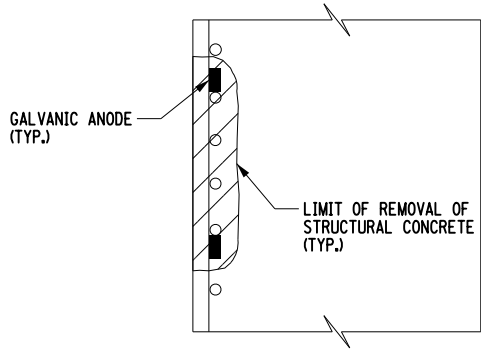

TYPICAL SUBSTRUCTURE REPAIR
NOT TO SCALE

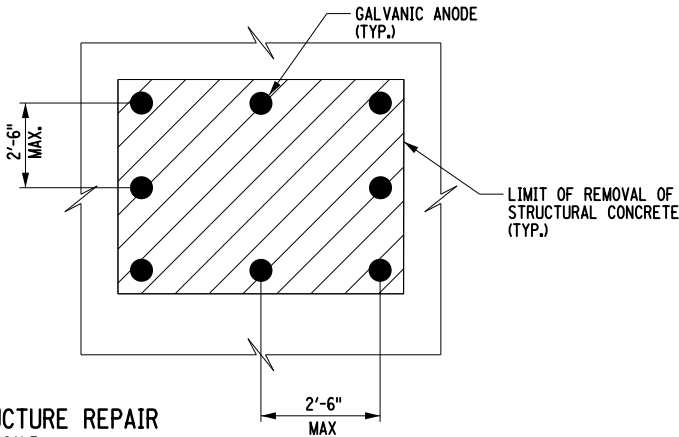

AFFIX SEAL: ON:	ALTERED BY: ON:

AS-BUILT REVISIONS DESCRIPTION OF ALTERATIONS:	SH NO. 8323 - HALSEY CORNERS - SAVANNAH, PART 1	PIN 3021.19	BRIDGES 4060410	CULVERTS	ALL DIMENSIONS IN ft UNLESS OTHERWISE NOTED MISCELLANEOUS ANODE DETAILS	CONTRACT NUMBER D262543	
	TOWN OF TYRE					DRAWING NO. ST2-47	
	COUNTY: SENECA					SHEET NO. 107	
	IT IS A VIOLATION OF LAW FOR ANY PERSON, UNLESS THEY ARE ACTING UNDER THE DIRECTION OF A LICENSED PROFESSIONAL ENGINEER, ARCHITECT, LANDSCAPE ARCHITECT, OR LAND SURVEYOR, TO ALTER AN ITEM IN ANY WAY. IF AN ITEM BEARING THE STAMP OF A LICENSED PROFESSIONAL IS ALTERED, THE ALTERING ENGINEER, ARCHITECT, LANDSCAPE ARCHITECT, OR LAND SURVEYOR SHALL STAMP THE DOCUMENT AND INCLUDE THE NOTATION "ALTERED BY" FOLLOWED BY THEIR SIGNATURE, THE DATE OF SUCH ALTERATION, AND A SPECIFIC DESCRIPTION OF THE ALTERATION.						