

23-D-121

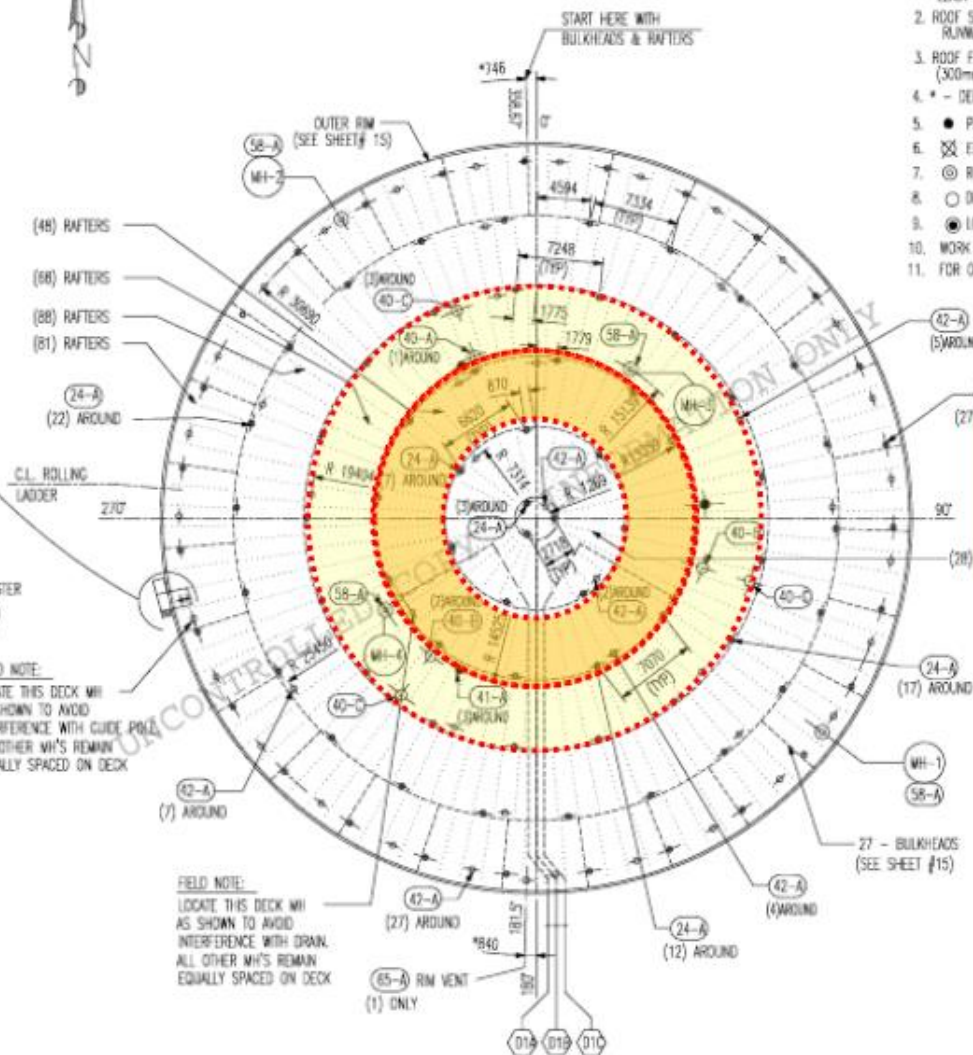

- NOTES:

1. ROOF SUPPORTS SHALL CLEAR MOVING PARTS OF PIPE DRAIN BY AT LEAST 610mm AND OTHER PARTS OF PIPE DRAIN BY AT LEAST 305mm.
2. ROOF SUPPORTS SHALL CLEAR ALL FITTINGS AND ROLLING LADDER RUNWAY ANGLES BY A MINIMUM OF 305mm.
3. ROOF FITTINGS AND SUPPORTS MAY BE MOVED CIRCUMFERENTIALLY (300mm MAX) TO CLEAR RAFTERS AND 3 PLATE LAPS IN DECKS
4. * - DENOTES ARC ON OUTSIDE OF DECK OUTER RIM PLATE. 1"=558.5mm
5. ● PRESSURE VACUUM VENTS (LOCATE APPROX. 120' APART) (3) 41-
6. ☒ EMERGENCY DRAINS (LOCATE APPROX. 120' APART) (6) 40-A/2/2
7. ☒ ROOF MANHOLES (4) 58-A
8. ○ DECK MANHOLES (46) 42-A
9. ● LOCKING TYPE ROOF SUPPORTS (88) 24-A
10. WORK THIS SHT WITH SHTS. 1, 2 & 15.
11. FOR ORIENTATION AND LAYOUT OF COLEXIP FLEXIBLE HOSE SEE SHT 6A

Product Reformat filled to a height of approximately 5~6" in highlighted compartments

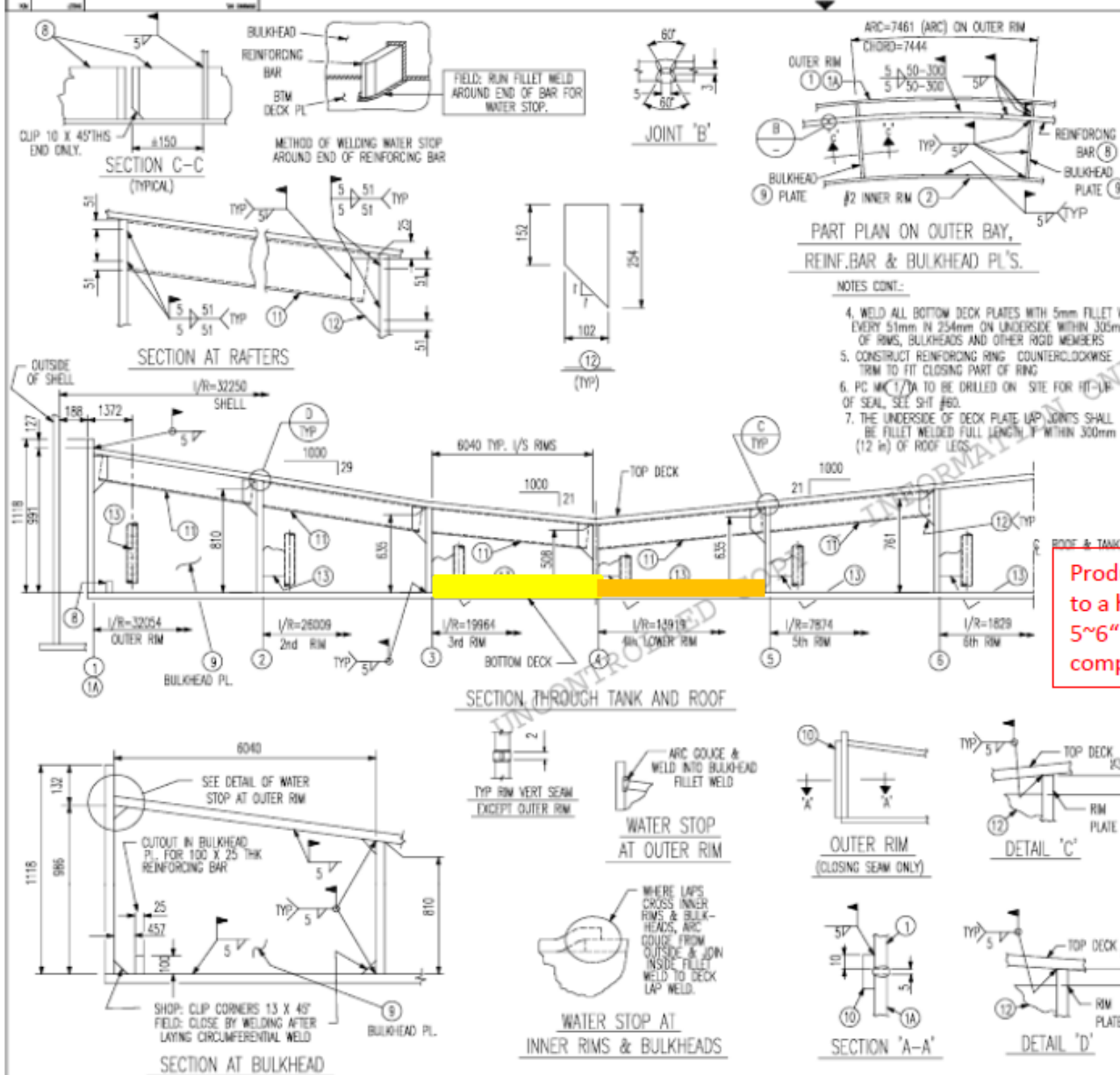

SHIP PC	MARK	ASSM PC	DESCRIPTION	LENGTH MM	SPEC	ID
20	15-1	PL 1118 x 8	[C/F 2400 x 10000]C2	9906	**2	C
1	15-1A	PL 1118 x 8 [C/F PL 2400 x 10000]C4		3326	**2	C
17	15-2	PL 810 x 5	[C/F 1830 x 10000]C2	9614	**2	C
13	15-3	PL 635 x 5	[C/F 2000 x 10000]C3	9650	**2	C
9	15-4	PL 508 x 5	[C/F 2400 x 10000]C4	9719	**2	C
5	15-5	PL 635 x 5	[C/F 2000 x 10000]C3	9898	**2	C
2	15-6	PL 761 x 5	[C/F 2400 x 6000]C3	5754	**2	C
27	15-8	RM 100 x 25	ROLL RM-31572	7350	**2	C
27	15-9	PL 5K X 5	[C/F 1830 x 6010]C2		**2	C
1	15-10	PL 40 X 5	[C/W 15-3]	991	**2	C
373	15-11	UPN 160 x 85 @ 18.8 kg/m		6000 *	A39	C
394	15-12	PL 5K x 8 [C/F PL 2400 x 10000]C316			**2	C
88	15-13	PLATE 203 x 5 [C/W 15-2 TO 6]		408	**2	C

DETAILED & BILLED FOR ONE TANK / (4) REQUIRED

NOTES:

- SHITS #1, #2 TO 5 & #11 TO 14
- WELD TOP DECK TO RAFTERS WITH 5mm FILLET WHERE EDGE OF PL. CROSSES RAFTER
- ALL WELDING ON A BULKHEAD OR A RM IS TO BE DONE FROM ONE SIDE ONLY

NOTES CONT. 4-6

Product Reformat filled to a height of approximately 5~6" in highlighted compartments

SLEEVE ASSY
SEE SHIT #24

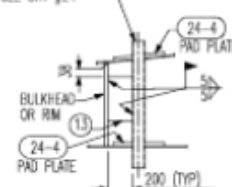

TYPICAL SECTION AT ROOF SUPPORTS