

The application for which the component is designed is a rubber vulcanizing machine with two mould halves. The upper mould has linear movement with respect to lower fixed mould. The upper mould support consists of a shell welded to a plate. The plate initially used was a 150mm thick plate. Now for weight saving, replacing a thick plate with thin plates and ribs are being considered. This is to have less weight while maintaining same stiffness in bending.

The material savings can be projected only after the ribs are sized. The rib thickness is fixed as 20mm and rib height is to be determined.

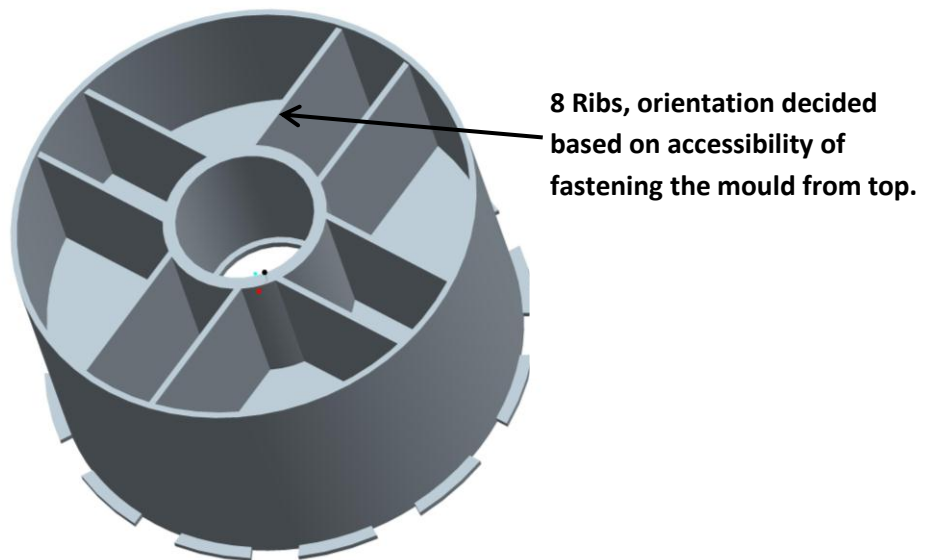

UPPER MOULD SUPPORT

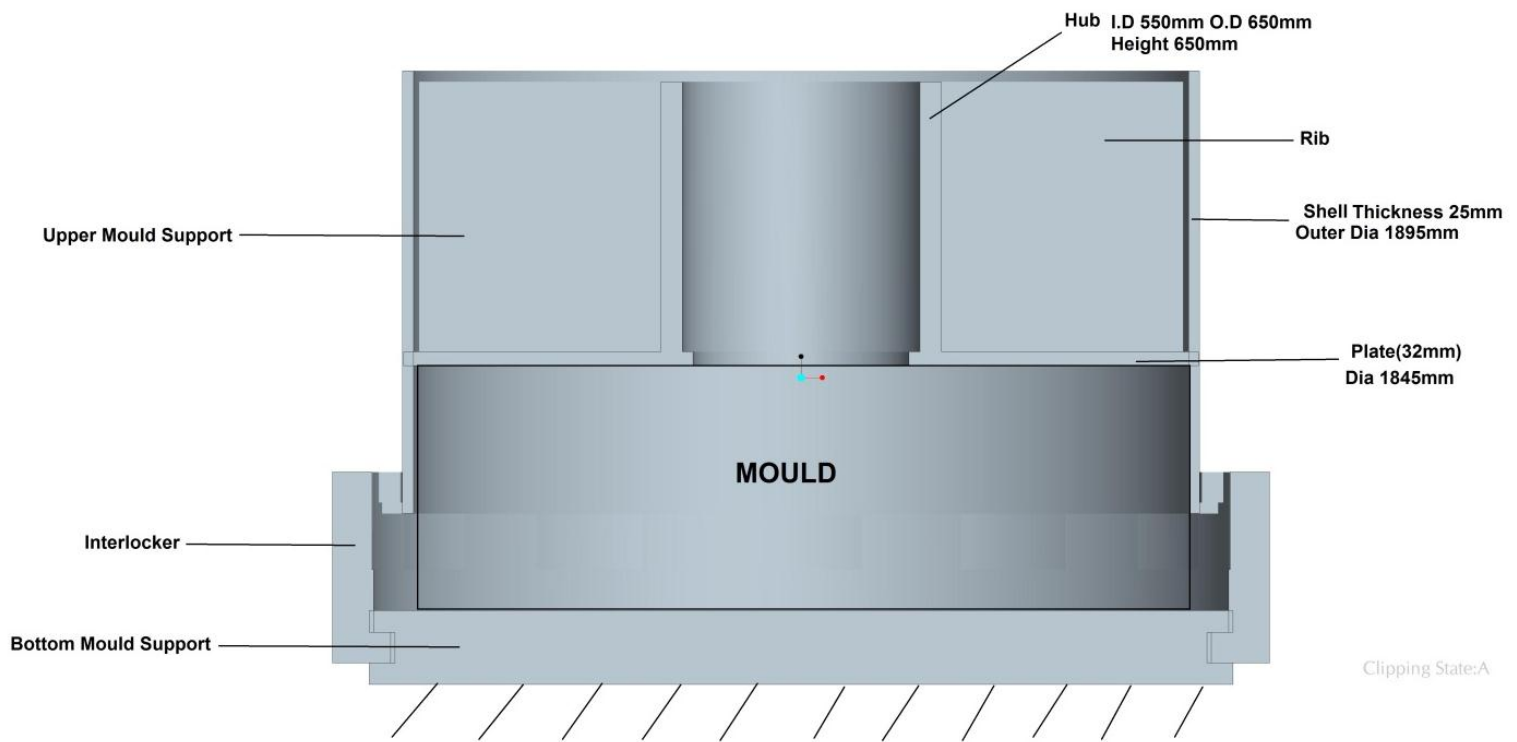
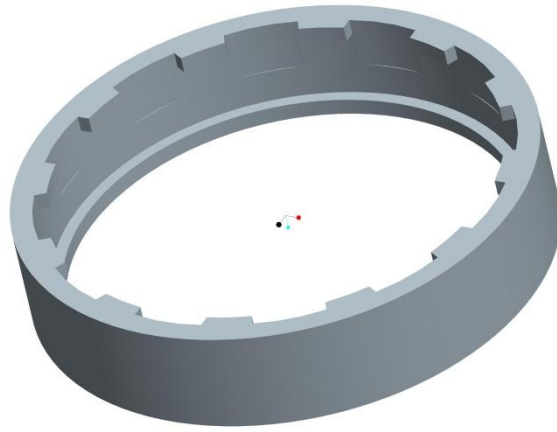

INTERLOCKER

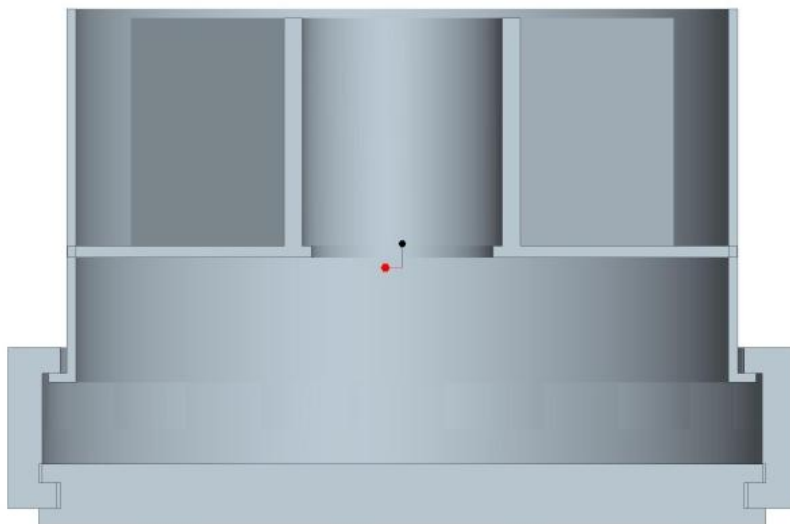

SECTION WITHOUT RIBS