

Changing Bond Beam Height

When bond beam height must be changed within a wall, such as to accommodate openings or a change in building height, the following detail helps ensure structural continuity. See Figure 1E.5 for standard hook requirements.

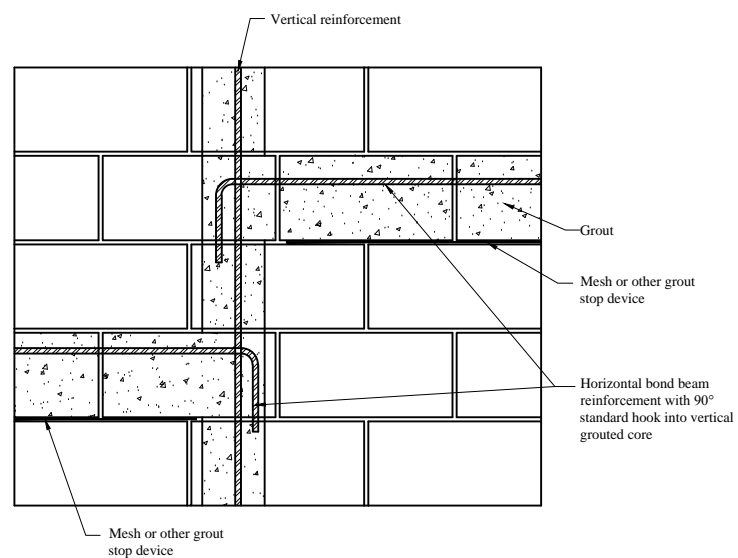

Last Modified: December, 2002

Annotated Design and Construction
Details for Concrete Masonry

Figure 7F.1
Page 7-8