

## Case 1

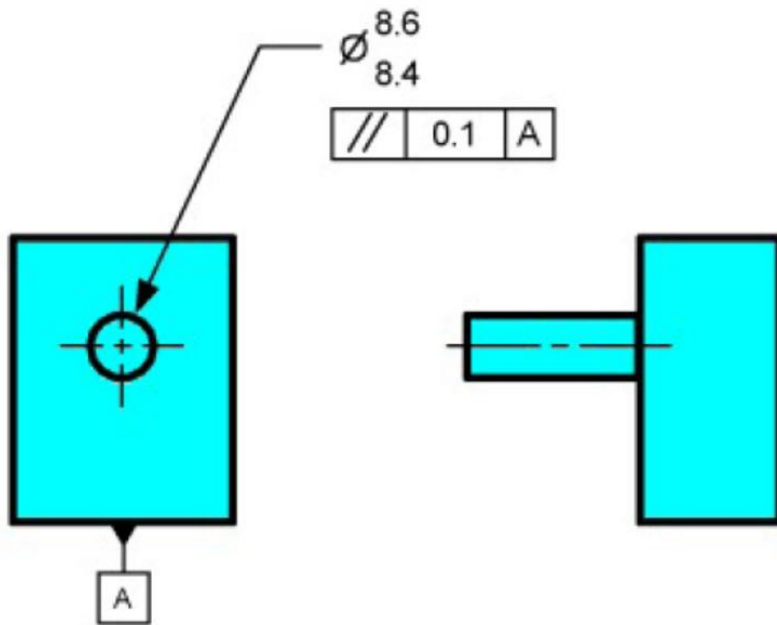

In this example, the shape of the tolerance zone for the parallelism control is :

- a.) a cylinder
- b.) undefined
- c.) two parallel cylinders
- d.) two parallel planes

The answer is d.) two parallel planes

## Case 2

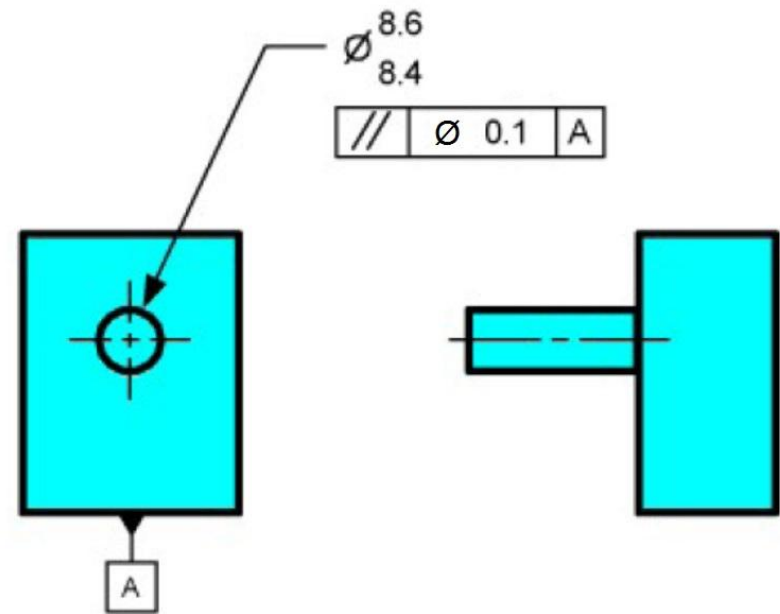

When parallelism is applied to a cylindrical feature of size and a diameter symbol precedes the tolerance value, the tolerance zone is cylindrical.

So, Case1 can be added a diameter as shown above, but what is the differences between them ? When should we use Case 1 in application ? and when should we use Case 2 ?