

6 CIP Double Tee System PLAN

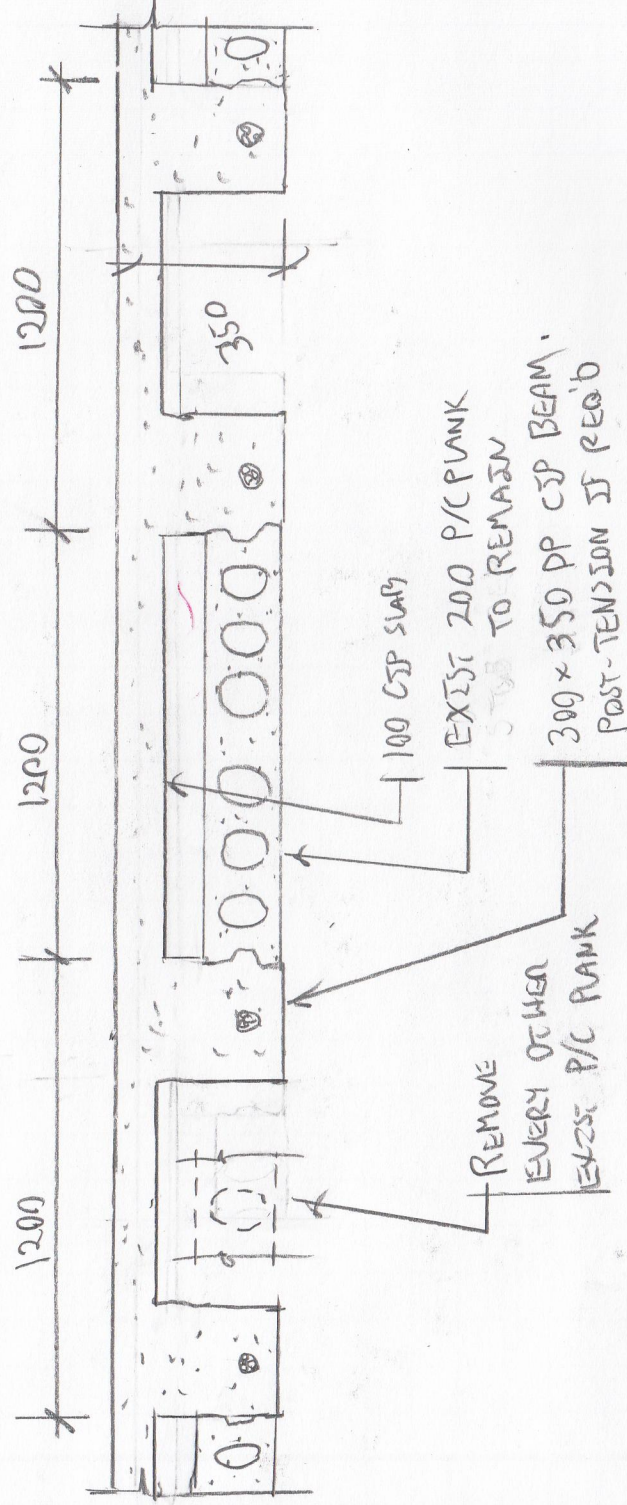

NOTE: ALL BEAMS TO  
BE SAW CUT TO WIDTH 500mm  
IF BEAMS 500mm REMOVED  
EVEN OTHER P/C PLANK



## P CSP DOUBLE TEE SYSTEM

### SECTION



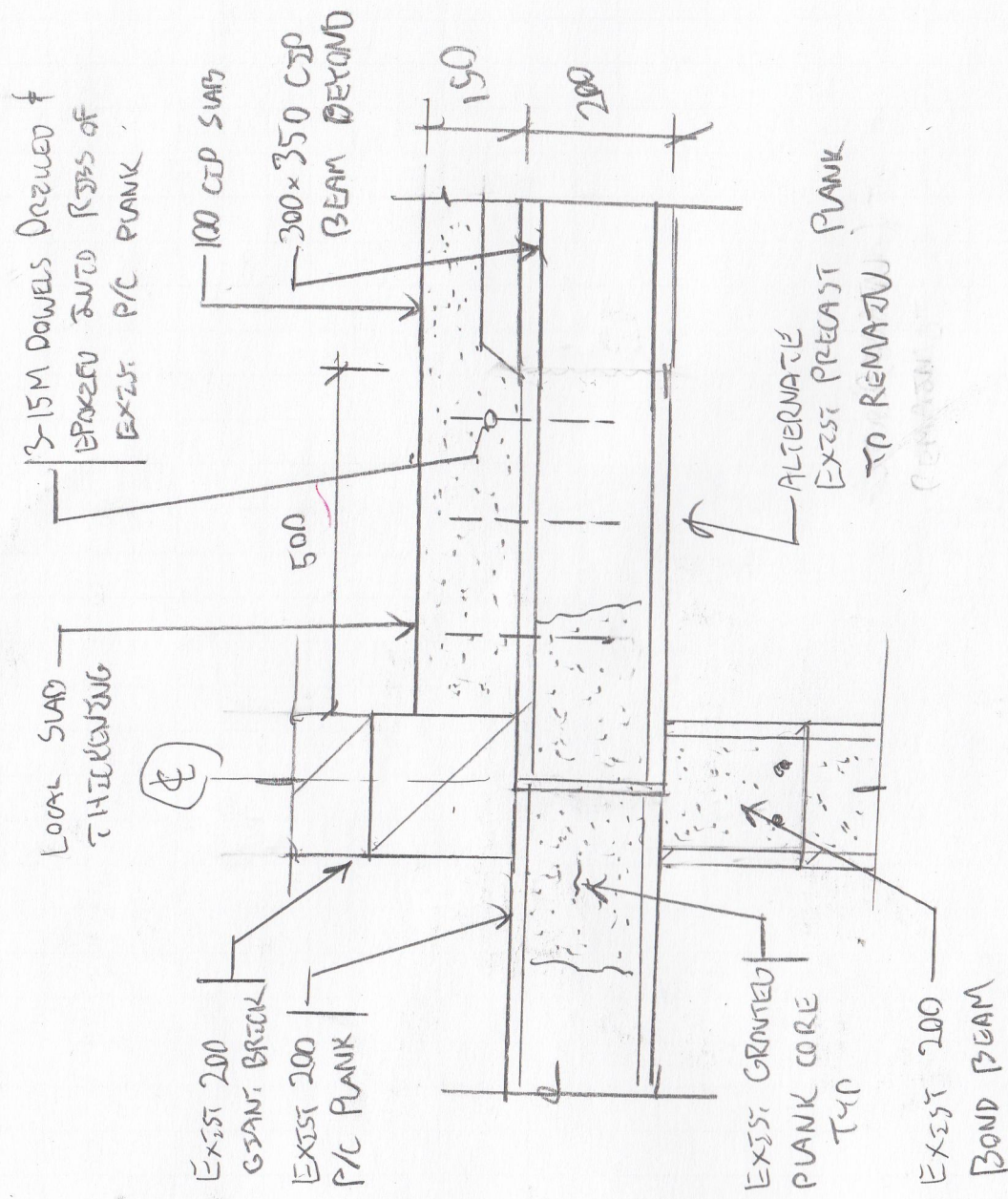

E CIP TT @ REMAINING P/C PLANK SUB  
SECTION



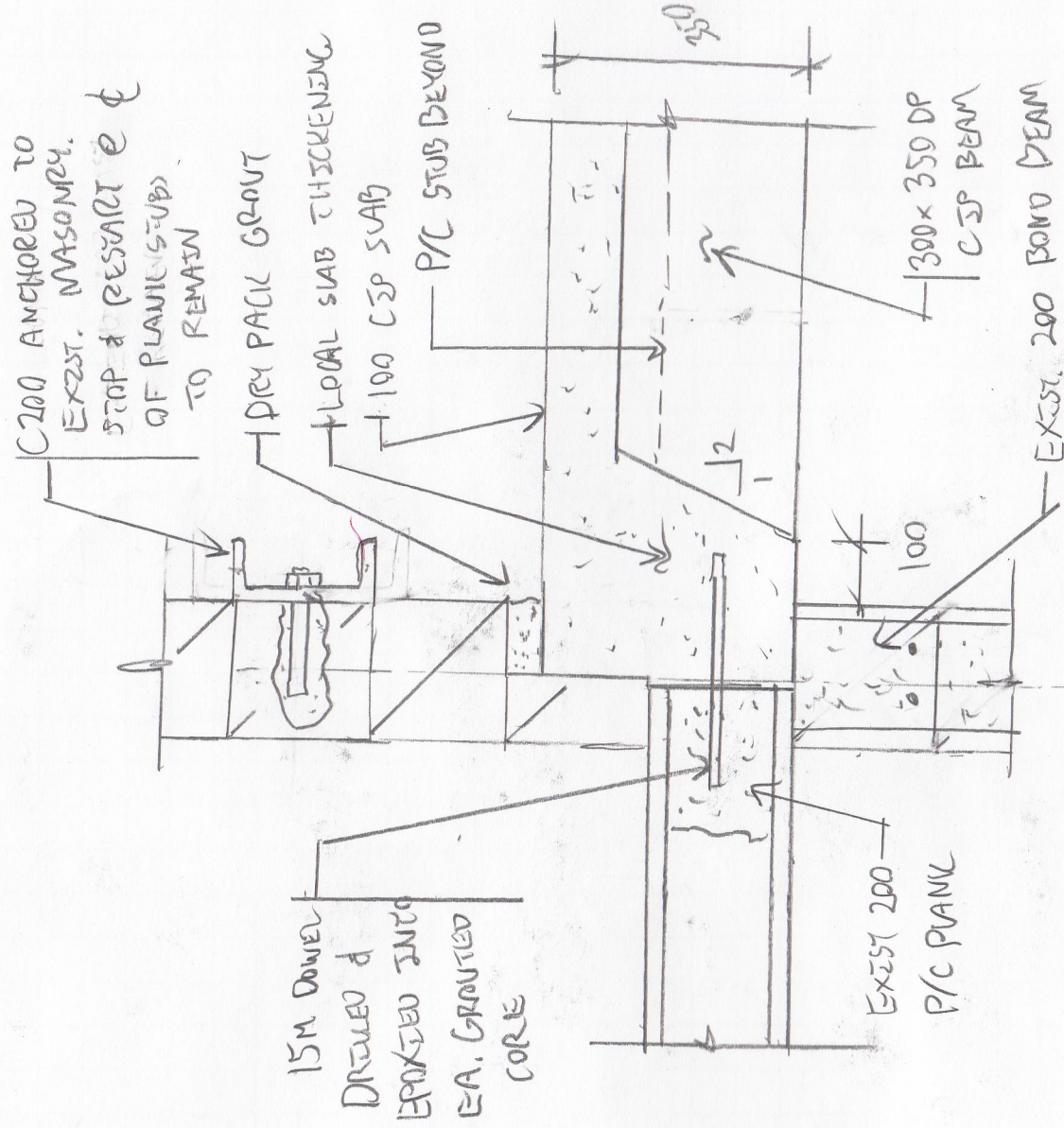

F CSP IT @ REMOVED P/C PLANK  
SECTION