

14" pipe full flow

5'-6"
62'-3"
3'-6"
4'-11"
97'-3"
111'-0"
13'-4"
5'-6"
7'-0"
307'-39"
310'-3"

90° elbows
10

Open Channel flow

15'-9"
4'-4"
27'-2"
73'-8"
119'-23"
120'-11"

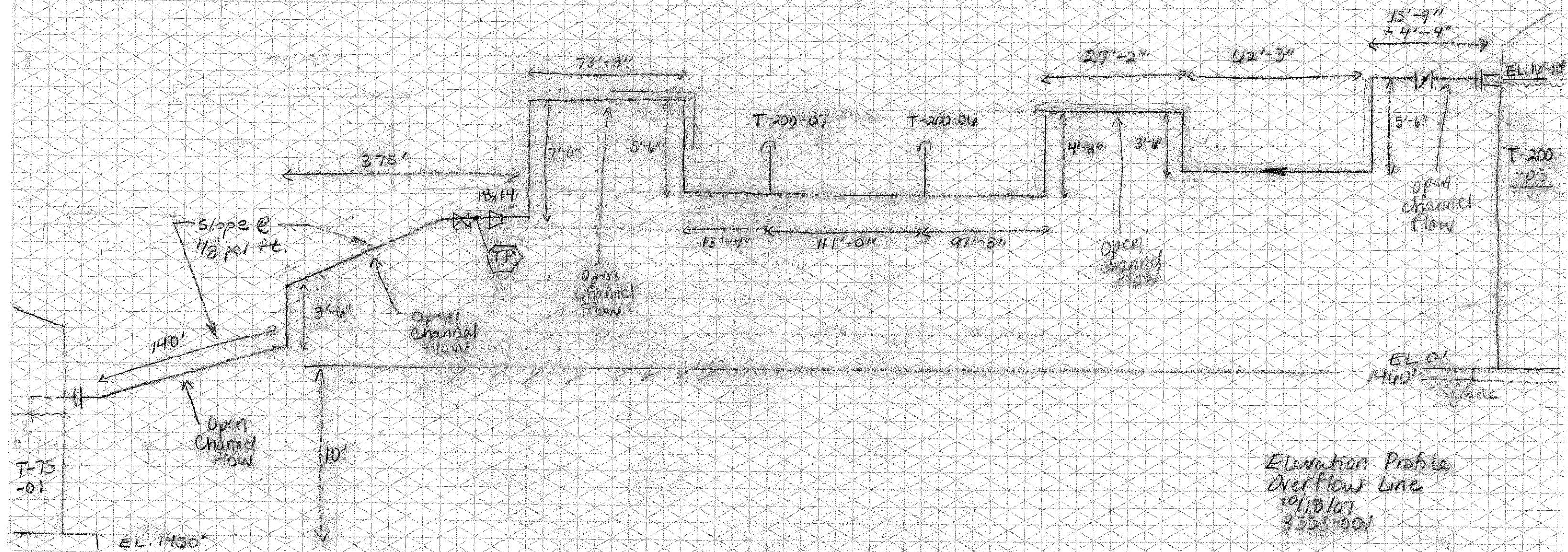

Elevation Profile
Overflow Line
10/18/07
3553 001