

Socket Screw Catalog

Effective January, 2011





**Made in
the U.S.A.**



General Information	5
Ordering Information	6
Drive System Selection	7
Products	Price List Technical Data
Inch Sizes	
Socket Head Cap Screws, 1960 Series	8.....26
Socket Head Shoulder Screws	11.....29
18-8 Stainless Steel Socket Head Shoulder Screws	12.....29
Socket Button Head Cap Screws	14.....30
Flanged Button Head Cap Screws.....	15
Socket Low Head Cap Screws	16.....31
Socket Flat Countersunk Head Cap Screws	17.....32
Socket Set Screws – Cup Point	18.....33
Socket Set Screws – Knurled Cup Point	19.....33
Precision Hardened Ground Machine Dowel Pins	20.....34
Metric Sizes	
Socket Head Cap Screws.....	21.....35
Socket Button Head Cap Screws	22.....36
Socket Flat Countersunk Head Cap Screws	23.....37
Drive Tools	
TORX PLUS® Drive System	24
TORX® Drive System	25
Warranty.....	38
Note: Specials Manufactured Upon Request	

This Socket Screw Catalog is designed to offer you a guide for utilizing Camcar® brand Socket Screws. We have attempted to provide complete information regarding the Camcar socket screw product line.

Camcar Socket Screws

Infastech takes pride in designing, producing and delivering superior products – an attitude you would expect from the industry's leading innovator. That pride, combined with the latest fastener technology and engineering expertise, makes Infastech one of the most reliable sources of Socket Screw products in the industry today.

Infastech is committed to offering a broad range of socket screw standard products, including inch and metric sizes in TORX PLUS® Drive and hex drive systems.

Also, we can supply you with innovative socket screw specials or socket screw products for high-temperature or corrosive environments. Any products not shown in this handbook may be considered specials. Please contact the application engineers at Decorah Operations for design assistance or further information.

Commitment to Quality

All Camcar socket screws are made from carefully selected and analyzed raw material, and critically inspected during the manufacturing processes. We utilize both Statistical Process Control and Quality at the Source methods to ensure our socket screws



meet your quality requirements. Each manufacturing lot is assigned an identification number to give you complete traceability of quality in the finished product. Also, many Camcar socket screw products are marked with the “Camcar” name for further assurances of the manufacturing source.

Distributors Located Around the World

The Camcar socket screw product line is readily available through our network of distributors. To find a distributor near you, please contact us at 800-648-0642.



Ordering Information

For the purposes of electronic data processing, stock numbers are assigned to all items in the Camcar® socket screw product line. These numbers are shown in each price list in this catalog. Infastech maintains a minimum order of \$150.

For price quotations on either stocked items or specials, contact the Decorah Operations Customer Service Department. Lead times from these quotations can be verified at the time of the order. All quotes are subject to review of the complete and clear print.

Packaged Camcar Socket Screws

As part of our ongoing efforts to improve our socket screw product line, we offer bar coded, safety-sealed packages. This not only ensures the package has not been tampered with, but also provides needed product information in an easy to read format. The information on the label includes lot number for traceability, part description, item number and a bar code for easier receiving.

Stock numbers

For the purposes of electronic data-processing (EDP), Infastech has assigned stock numbers to all the items in this price list. For inch sizes, hex recess EDP numbers begin with a "1"; TORX PLUS® recess EDP stock numbers begin with a "3".

The NIDA-SIDA manufacturer's code number assigned to Infastech is 697264.

Socket screw products described in this catalog are manufactured from the highest quality alloy and stainless steels in strict conformance with standards and dimensions as set forth in ANSI B 18.3 - 1986; ANSI B 18.8.2 - 1978; MS16555 - 1985; and ANSI B 2.2 - 1968. Camcar socket products meet the respective ASTM Standard Specifications required in ANSI B18.3.

All products in this catalog are DFAR compliant.

Special products

Products not listed in this schedule are special and will be priced upon request. Blueprints must accompany your request for quotation.

Special materials

Products manufactured from metals other than indicated in this price schedule are specials and priced on request.

Product weights

Weight of products listed in this schedule are approximate pounds per box.

Returned goods

No products accepted for return without written authorization.

Price quotations

Quotations valid for 30 days from date of issue.

Plating

Products which are not plated by Infastech are not guaranteed and are not subject to return. Infastech will only plate those thread designations (i.e. 2A) which provide for plating allowance.

Minimum order charge

Orders will not be accepted for less than \$150.00.

Infastech shall not be responsible or liable for misapplication or misuse of this product. All warranties are void if the product is plated or modified in any manner not under the control of Infastech.



Decorah Operations

1304 Kerr Drive • Decorah, IA 52101-2494

voice: 563.382.4216

fax: 563.387.3326

www.infastech.com

Drive System Availability

Infastech is committed to offering the marketplace the latest in fastening solutions. As such, many of our most popular socket screw products are available with both the TORX PLUS® Drive System and hex drive system. We also offer the tooling to support whichever drive system you choose.

Drive System Selection

There are several issues impacting proper socket screw drive system selection which must be reviewed prior to specification. Among the questions requiring review are:

- Does the drive system's torque capabilities meet the requirements of my application?
- Will the drive system withstand the high torque levels used in fastening socket screws?
- Is the required tooling readily available?
- Will I need separate tooling for inch and metric screws?
- Will the drive system enhance my overall operations?

In order to answer these questions, it is important to compare the available drive systems.

Introduction to the TORX PLUS Drive System

Developed as an improvement of the original TORX® Drive System, the TORX PLUS Drive consistently outperforms hex and other commonly-used drive systems. Used in virtually every industrialized nation in a multitude of industries, the TORX PLUS Drive System can enhance product reliability, increase productivity, and reduce total assembly costs.

The TORX PLUS Drive System offers a 100% improvement in driver bit fatigue life and a 25% average improvement in driver bit torsional strength. In addition, its unique design provides optimum torque transfer and eliminates the need for excessive end load pressure while driving the fastener. The TORX PLUS configuration also virtually eliminates tool camout and slippage that can damage the head of the fastener and cause reduced tool life.



TORX PLUS Drive System vs. Hex Drive

The hex drive has weaknesses inherent in its design which can cause problems during assembly. The engagement of the hex drive tool to the recess produces highly concentrated stress at the six corners of the drive tool (see below).

Hex Drive

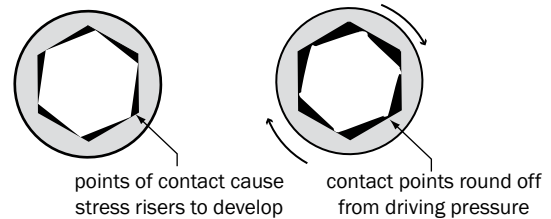

This stress at the thin cross-sectional areas of the fastener crushes the corners of the hex tool. This reduces the amount of wrenching engagement, causing reamed socket recesses and/or damaged socket tooling. This type of failure with the hex drive system is so common, it is often accepted as normal practice.

The TORX PLUS Drive System features deep engaging lobes with broad contact surfaces that spread out driving forces, preventing stress risers from forming. This minimizes damage to the drive tool and fastener, resulting in longer tool life. Customers have reported driving 2 to 10 times more fasteners per drive tool after switching to the TORX PLUS Drive.

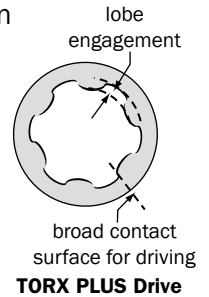

TORX PLUS Drive Tooling Availability

TORX PLUS Drive tools are readily available throughout the world from licensed manufacturers and authorized distributors. Your existing tooling suppliers often also carry TORX PLUS Drive tools, in many standard styles and sizes to meet your installation requirements. Infastech also stocks many standard TORX PLUS Drive tools; see page 24 of this catalog for more information.

For service in the field, TORX PLUS Drive fasteners can be removed and reinstalled using commonly available TORX PLUS Drive or TORX Drive tooling. However, in order to fully realize the benefits of the TORX PLUS Drive, including extended bit life, TORX PLUS Drive tools should be used.

Pricing and Product Information – Inch Sizes

Socket Head Cap Screws – 1960 Series



Made in
the U.S.A.



Product Description:

- Heat-treated alloy steel
- Class 3A thread fit standard except as noted
- TORX PLUS® Drive recess available
- DFAR Compliant

Pricing Notes:

- Net price per 100 available in listed thread series only
- Bulk pricing upon request

Dia. Recess TPI	Len. Und. Head	UNRC			UNRF			Ct./ Box	Wt./ Box
		Hex EDP No.	TORX PLUS EDP No.	Price Per 100	Hex EDP No.	TORX PLUS EDP No.	Price Per 100		
#0 .050 Hex UNRF 80 TPI	1/8				11035		30.67	100	0.1
	3/16				11038		30.78	100	0.1
	1/4				11041		31.00	100	0.1
	3/8				11044		31.21	100	0.1
#1 1/16 Hex UNRF 72 TPI	1/8				11047		30.78	100	0.1
	3/16				11050		31.00	100	0.1
	1/4				11053		31.10	100	0.1
	3/8				11056		31.54	100	0.1
#2 5/64 Hex UNRC 56 TPI	3/16	10003		29.70				100	0.1
	1/4	10006		29.92				100	0.1
	3/8	10012		30.24				100	0.1
	1/2	10015		30.46				100	0.2
#3 5/64 Hex UNRC 48 TPI	3/16	10024		29.59				100	0.1
	1/4	10027		30.24				100	0.1
	3/8	10030		31.00				100	0.1
	1/2	10033		31.32				100	0.2
#4 3/32 Hex 10IP TORX PLUS UNRC 40 TPI	3/16	10040		16.01				100	0.2
	1/4	10042	30042	15.26				100	0.2
	5/16	10043		15.48				100	0.2
	3/8	10048	30048	15.58				100	0.2
	1/2	10054	30054	15.90				100	0.3
	5/8	10057	30057	16.01				100	0.3
	3/4	10060	30060	16.43				100	0.3
	7/8	10061		19.08				100	0.3
	1	10062		19.82				100	0.3
	1-1/4	10065		36.15				100	0.4
#5 3/32 Hex 10IP TORX PLUS UNRC 40 TPI	1-1/2	10068		40.07				100	0.5
	1/4	10078	30078	15.37				100	0.2
	3/8	10084	30084	15.48				100	0.3
	1/2	10090	30090	16.11				100	0.3
	5/8	10093		16.22				100	0.3
UNRC 40 TPI	3/4	10096		16.54				100	0.4
	1	10099		25.86				100	0.5

Dia. Recess TPI	Len. Und. Head	UNRC			UNRF			Ct./ Box	Wt./ Box
		Hex EDP No.	TORX PLUS EDP No.	Price Per 100	Hex EDP No.	TORX PLUS EDP No.	Price Per 100		
#6 7/64 Hex 15IP TORX PLUS UNRC 32 TPI UNRF 40 TPI	1/4	10108	30108	15.48	11062		17.92	100	0.3
	3/8	10114	30114	15.69	11068		18.13	100	0.3
	1/2	10120	30120	15.90	11074		18.44	100	0.4
	5/8	10123	30123	15.90	11077		18.44	100	0.4
	3/4	10126	30126	16.96	11080		18.44	100	0.4
	7/8	10129	30129	18.66				100	0.4
	1	10132	30132	20.56				100	0.5
	1-1/4	10133		23.74				100	0.6
	1-1/2	10136		25.97				100	0.6
	1-3/4	10139		27.56				100	0.8
#8 9/64 Hex 25IP TORX PLUS UNRC 32 TPI UNRF 36 TPI	2	10141		29.47				100	1.2
	1/4	10156	30156	15.16				100	0.4
	5/16	10165		15.37				100	0.5
	3/8	10162	30162	15.58	11089		23.32	100	0.5
	1/2	10168	30168	16.01	11092		23.74	100	0.5
	5/8	10174	30174	16.11				100	0.6
	3/4	10177	30177	17.81	11095		26.82	100	0.7
	7/8	10180	30180	18.66				100	0.7
	1	10186	30186	20.88				100	0.8
	1-1/4	10192	30192	22.90				100	0.9
#10 5/32 Hex 27IP TORX PLUS UNRC 24 TPI UNRF 28 TPI	1-1/2	10198	30198	24.80				100	1.1
	2	10201		30.74				100	1.5
	2-1/2	10208		34.24				100	1.5
	1/4	10210		21.09	11105		20.99	100	0.6
	3/8	10216		15.69	11107	31107	16.01	100	0.6
	1/2	10219	30219	16.01	11113	31113	16.22	100	0.7
	5/8	10225	30225	16.54	11119	31119	17.38	100	0.8
	3/4	10228	30228	17.70	11122	31122	18.13	100	0.9
	7/8	10231	30231	19.19	11125	31125	20.78	100	0.9
	1	10234	30234	20.88	11128	31128	21.31	100	1.0
UNRC 24 TPI UNRF 28 TPI	1-1/4	10240	30240	22.68	11134	31134	23.75	100	1.3
	1-1/2	10246	30246	25.33	11137	31137	26.61	100	1.4
	1-3/4	10249		27.88	11140	31140	29.04	100	1.6
	2	10255		30.21	11143	31143	32.33	100	1.9
	2-1/4	10258		32.86	11145		35.62	100	2.0
	2-1/2	10260		32.65	11147		38.16	100	2.0
	3	10262		45.47	11150		50.37	100	3.0

Pricing and Product Information – Inch Sizes

Socket Head Cap Screws – 1960 Series (continued)



Made in
the U.S.A.

Dia. Recess TPI	Len. Und. Head	UNRC			UNRF			Ct./ Box	Wt./ Box
		Hex EDP No.	TORX PLUS EDP No.	Price Per 100	Hex EDP No.	TORX PLUS EDP No.	Price Per 100		
1/4" 3/16 Hex 30IP TORX PLUS UNRC 20 TPI UNRF 28 TPI	1/4	10265		20.14				100	1.0
	3/8	10267	30267	16.54	11161	31161	18.55	100	1.0
	1/2	10270	30270	16.96	11164	31164	18.97	100	1.2
	5/8	10273	30273	17.60	11170	31170	19.29	100	1.4
	3/4	10276	30276	19.08	11176	31176	20.88	100	1.5
	7/8	10279	30279	20.56	11179		23.11	100	1.6
	1	10282	30282	21.84	11182	31182	24.49	100	1.8
	1-1/4	10291	30291	23.43	11188	31188	26.92	100	2.1
	1-1/2	10294	30294	26.50	11191	31191	29.79	100	2.5
	1-3/4	10300	30300	28.99	11194	31194	32.86	100	2.8
	2	10306	30306	31.38	11200	31200	35.93	100	3.0
	2-1/4	10309	30309	39.22	11203		44.10	100	3.4
	2-1/2	10312	30312	43.57				100	3.8
	2-3/4	10315	30315	52.68				100	3.9
	3	10318	30318	58.30				100	4.3
	3-1/4	10319		62.12				100	5.0
	3-1/2	10320		73.25				100	5.0
	4	10322		97.10				100	5.0
5/16" 1/4 Hex 45IP TORX PLUS UNRC 18 TPI UNRF 24 TPI	3/8	10348	30348	27.98				100	1.8
	1/2	10351	30351	21.62	11221		23.11	100	2.0
	5/8	10354	30354	22.58	11224		24.17	100	2.3
	3/4	10357	30357	23.32	11227	31227	25.76	100	2.5
	7/8	10360	30360	25.55	11230	31230	28.41	100	2.7
	1	10363	30363	26.18	11233	31233	28.94	100	2.9
	1-1/4	10369	30369	29.36	11239	31239	30.63	100	3.4
	1-1/2	10372	30372	31.16	11242	31242	34.24	100	3.9
	1-3/4	10375	30375	34.98	11248		37.74	100	4.4
	2	10381	30381	37.74	11254		41.55	100	4.9
	2-1/4	10387	30387	46.64	11257		49.18	100	5.4
	2-1/2	10393	30393	50.99	11260		57.03	100	5.9
	2-3/4	10396	30396	69.43				100	6.4
	3	10399	30399	79.92				100	6.9
	3-1/4	10402	30402	99.64				100	7.3
	3-1/2	10405	30405	109.82				100	7.8
	4	10410	30410	115.33				100	9.0
	4-1/2	10413	30413	129.53				100	10.5
	5	10416	30416	182.43				100	11.6

Dia. Recess TPI	Len. Und. Head	UNRC			UNRF			Ct./ Box	Wt./ Box
		Hex EDP No.	TORX PLUS EDP No.	Price Per 100	Hex EDP No.	TORX PLUS EDP No.	Price Per 100		
3/8" 5/16 Hex 50IP TORX PLUS UNRC 16 TPI UNRF 24 TPI	1/2	10435	30435	26.61	11275		37.95	100	3.4
	5/8	10438	30438	27.45	11278		38.58	100	3.4
	3/4	10441	30441	28.09	11281	31281	33.07	100	4.0
	7/8	10444	30444	30.74	11284		36.04	100	4.3
	1	10447	30447	31.80	11287	31287	36.68	100	4.6
	1-1/4	10450	30450	34.24	11290	31290	39.64	100	5.2
	1-1/2	10456	30456	37.74	11293	31293	43.35	100	6.0
	1-3/4	10459	30459	43.04	11296	31296	49.71	50	3.3
	2	10462	30462	46.43	11299	31299	54.59	50	3.9
	2-1/4	10465	30465	58.09	11302		69.75	50	4.3
	2-1/2	10468	30468	63.18	11305		76.32	50	4.5
	2-3/4	10471	30471	86.18				50	4.9
	3	10474	30474	94.13	11308		103.46	50	5.1
	3-1/4	10477	30477	112.78				50	5.4
	3-1/2	10483	30483	128.37				50	5.8
	4	10489	30489	151.58				50	6.6
	4-1/2	10495		181.58				50	7.4
	5	10501		217.09				50	8.0
	6	10510		303.58				10	13.0
7/16" 3/8 Hex 55IP TORX PLUS UNRC 14 TPI UNRF 20 TPI	1/2	10517		57.56				100	5.0
	5/8	10518		58.41				100	6.0
	3/4	10519		59.78				100	6.5
	7/8	10521		64.02				100	6.8
	1	10525	30525	65.72	11326		72.40	100	7.0
	1-1/4	10528	30528	71.13	11329		77.49	100	7.3
	1-1/2	10531	30531	78.02	11332		87.24	100	8.1
	1-3/4	10537		86.18				100	9.3
	2	10540	30540	93.07	11338	31338	101.87	50	5.0
	2-1/4	10543	30543	103.14				50	5.5
	2-1/2	10546		109.18				50	6.0
	2-3/4	10549		125.82				25	3.3
	3	10552		135.68				25	3.5
	3-1/2	10558		156.99				25	4.0
	4	10564		174.16				25	4.5

Pricing and Product Information – Inch Sizes



Made in
the U.S.A.

Dia. Recess TPI	Len. Und. Head	UNRC			UNRF			Ct./ Box	Wt./ Box
		Hex EDP No.	TORX PLUS EDP No.	Price Per 100	Hex EDP No.	TORX PLUS EDP No.	Price Per 100		
1/2" 3/8 Hex 55IP TORX PLUS UNRC 13 TPI UNRF 20 TPI	1/2	10573	30573	79.29				50	3.7
	5/8	10576	30576	83.00				50	4.0
	3/4	10579	30579	66.14				50	4.2
	7/8	10582		73.46				50	4.5
	1	10585	30585	73.99	11356		75.58	50	4.8
	1-1/4	10588	30588	76.74	11359		85.97	50	5.3
	1-1/2	10591	30591	86.92	11362		92.54	25	6.3
	1-3/4	10594	30594	96.25	11365		101.87	25	3.4
	2	10597	30597	102.18	11368		109.29	25	3.8
	2-1/4	10600	30600	116.07	11371		122.22	25	4.0
	2-1/2	10606	30606	124.13	11374		128.58	25	4.4
	2-3/4	10609	30609	142.89				25	4.6
	3	10612	30612	151.69	11377		164.62	25	4.9
	3-1/4	10618	30618	165.78				25	5.1
	3-1/2	10621	30621	175.75				25	6.0
	4	10627	30627	211.36				25	6.3
	4-1/2	10633		247.83				25	7.0
	5	10639		274.96				25	7.9
	5-1/2	10645		305.39				25	8.6
	6	10654		325.95				25	9.3
5/8" 1/2 Hex 70IP TORX PLUS UNRC 11 TPI UNRF 18 TPI	6-1/2	10657		508.06				10	3.8
	7	10660		579.29				10	4.2
	8	10663		722.71				10	5.0
	1-1/4	10672		157.03	11404		159.73	50	8.6
	1-1/2	10678		168.59	11407		171.29	50	9.4
	1-3/4	10681		179.71	11410		185.44	50	10.5
	2	10684		190.99	11413		196.88	50	11.2
	2-1/4	10687		204.98				25	6.8
	2-1/2	10690		213.08	11419		190.84	25	7.3
	3	10696		250.56				25	8.4
	3-1/2	10702		275.29				25	9.5
	4	10705		304.88				25	10.5
	4-1/2	10711		408.00				25	11.4
	5	10714		455.20				25	12.4
	5-1/2	10717		584.20				10	5.3

Dia. Recess TPI	Len. Und. Head	UNRC			UNRF			Ct./ Box	Wt./ Box
		Hex EDP No.	TORX PLUS EDP No.	Price Per 100	Hex EDP No.	TORX PLUS EDP No.	Price Per 100		
3/4" 5/8 Hex UNRC 10 TPI	1-1/2	10747		298.43				25	7.6
	1-3/4	10750		318.56				25	8.4
	2	10753		334.95				25	9.1
	2-1/4	10756		350.68				25	9.9
	2-1/2	10759		366.63				25	10.6
	3	10765		460.79				25	12.3
	3-1/4	10768		483.10				25	13.0
	3-1/2	10771		488.90				25	13.8
	4	10774		521.60				25	15.4
	4-1/2	10777		608.80				25	17.0
	5	10783		678.90				25	25.0
	5-1/2	10789		788.40				10	7.8
	6	10804		867.10				10	8.5
	2	10873		813.90				10	7.8
1" 1/2 Hex UNRC 8 TPI	2-1/4	10876		876.60				10	8.3
	2-1/2	10879		920.40				10	8.8
	2-3/4	10882		964.20				10	9.3
	3	10885		1014.30				10	9.8
	3-1/4	10888		1070.70				10	10.3
	3-1/2	10891		1127.50				10	10.8
	4	10897		1252.20				10	12.1
	4-1/2	10903		1502.70				10	13.3
	5	10906		1646.70				10	14.5
	5-1/2	10909		1853.30				10	15.6
	6	10930		1953.40				10	16.7
	6-1/2	10933		2404.30				10	17.6
	7	10936		2567.00				10	19.6
	8	10939		3080.40				10	21.4

Pricing and Product Information – Inch Sizes

Camcar® Socket Head Shoulder Screws



Made in
the U.S.A.



Product Description:

- Heat-treated alloy steel
- Class 3A thread fit standard
- DFAR compliant

Pricing Notes:

- Net price per 100
- Bulk pricing upon request

Shldr . Dia. Recess Size	Shldr. Length	EDP No.	Thrd. Dia.	TPI	Price Per 100	Ct. / Box	Wt. Lb./ Box
1/4" 1/8 Hex	1/4	13755	#10	24	120.10	25	.4
	3/8	13759	#10	24	105.05	25	.4
	1/2	13762	#10	24	106.11	25	.4
	5/8	13765	#10	24	110.24	25	.4
	3/4	13768	#10	24	113.53	25	.5
	1	13771	#10	24	118.40	25	.6
	1-1/4	13774	#10	24	128.37	25	.6
	1-1/2	13777	#10	24	133.35	25	.8
	2	13780	#10	24	158.89	25	1.2
5/16" 5/32 Hex	1/4	13793	1/4	20	147.76	25	.4
	3/8	13795	1/4	20	124.44	25	.4
	1/2	13798	1/4	20	125.72	25	.4
	5/8	13801	1/4	20	128.05	25	.7
	3/4	13804	1/4	20	130.59	25	.8
	1	13810	1/4	20	133.77	25	.9
	1-1/4	13813	1/4	20	147.13	25	1.0
	1-1/2	13816	1/4	20	152.32	25	1.1
3/8" 3/16 Hex	1-3/4	13819	1/4	20	160.70	25	1.3
	2	13822	1/4	20	162.07	25	1.4
	1/4	13834	5/16	18	186.14	25	.8
	3/8	13837	5/16	18	141.72	25	.9
	1/2	13840	5/16	18	143.63	25	1.0
	5/8	13843	5/16	18	144.90	25	1.1
	3/4	13846	5/16	18	147.55	25	1.3
	1	13849	5/16	18	148.61	25	1.4
1/2" 1/4 Hex	1-1/4	13852	5/16	18	157.73	25	1.6
	1-1/2	13855	5/16	18	162.18	25	1.9
	1-3/4	13858	5/16	18	166.84	25	2.1
	2	13861	5/16	18	179.35	25	2.3
	2-1/4	13864	5/16	18	188.79	25	2.4
	2-1/2	13867	5/16	18	208.08	25	2.6
	2-3/4	13870	5/16	18	219.95	25	2.9
	3	13873	5/16	18	231.61	25	3.1
3/4" 3/8 Hex	3-1/4	13876	5/16	18	263.52	25	3.3
	3-1/2	13879	5/16	18	286.31	25	3.5
	3-3/4	13882	5/16	18	326.90	25	3.6
	4	13885	5/16	18	332.63	25	3.9
	3/8	13889	3/8	16	269.45	25	1.8
	1/2	13891	3/8	16	229.07	25	2.0
	5/8	13894	3/8	16	239.35	25	2.3
	3/4	13897	3/8	16	240.62	25	2.4
1 1/2" 1 1/4 Hex	1	13900	3/8	16	241.89	25	2.8
	1-1/4	13903	3/8	16	248.15	25	3.1
	1-1/2	13906	3/8	16	253.66	25	3.4
	1-3/4	13909	3/8	16	268.18	25	3.8
	2	13912	3/8	16	281.32	25	4.1
	2-1/4	13915	3/8	16	295.00	25	4.5
	2-1/2	13918	3/8	16	304.64	25	4.9

Shldr . Dia. Recess Size	Shldr. Length	EDP No.	Thrd. Dia.	TPI	Price Per 100	Ct. / Box	Wt. Lb./ Box
1/2" cont.	2-3/4	13921	3/8	16	322.77	25	5.2
	3	13924	3/8	16	342.06	25	5.5
	3-1/4	13927	3/8	16	380.12	25	5.9
	3-1/2	13930	3/8	16	407.57	25	6.2
	3-3/4	13933	3/8	16	456.65	25	6.5
	4	13936	3/8	16	467.99	25	6.9
	4-1/4	13939	3/8	16	553.53	25	7.2
	4-1/2	13942	3/8	16	563.07	10	3.0
5/8" 5/16 Hex	4-3/4	13945	3/8	16	618.09	10	3.2
	5	13948	3/8	16	635.05	10	3.4
	3/4	13956	1/2	13	459.57	25	4.5
	1	13958	1/2	13	540.99	25	4.8
	1-1/4	13960	1/2	13	390.76	25	5.1
	1-1/2	13963	1/2	13	413.56	25	5.6
	1-3/4	13966	1/2	13	423.83	25	6.2
	2	13969	1/2	13	439.24	25	6.6
3/4" 3/8 Hex	2-1/4	13972	1/2	13	486.32	25	7.2
	2-1/2	13975	1/2	13	520.13	25	7.8
	2-3/4	13978	1/2	13	541.31	25	8.4
	3	13981	1/2	13	543.99	25	8.9
	3-1/4	13984	1/2	13	696.68	25	9.4
	3-1/2	13987	1/2	13	779.17	25	9.9
	3-3/4	13990	1/2	13	882.22	10	4.2
	4	13993	1/2	13	922.55	10	4.4
1 1/4" 1 1/4 Hex	4-1/4	13996	1/2	13	1036.72	10	4.6
	4-1/2	13999	1/2	13	1062.83	10	4.9
	4-3/4	14002	1/2	13	1139.76	10	5.1
	5	14005	1/2	13	1155.71	10	5.3
	5-1/2	14008	1/2	13	1816.97	10	6.2
	6	14011	1/2	13	2164.50	10	6.6
	1-1/2	14020	5/8	11	722.81	10	3.4
	1-3/4	14023	5/8	11	728.20	10	3.7
1 3/4" 1 3/4 Hex	2	14026	5/8	11	692.67	10	4.0
	2-1/4	14029	5/8	11	770.22	10	4.4
	2-1/2	14032	5/8	11	836.11	10	4.7
	2-3/4	14035	5/8	11	878.68	10	5.0
	3	14038	5/8	11	918.17	10	5.4
	3-1/4	14041	5/8	11	1076.46	10	5.6
	3-1/2	14044	5/8	11	1103.19	10	6.0
	3-3/4	14047	5/8	11	1166.33	10	6.3
2" 2 Hex	4	14050	5/8	11	1201.97	10	6.6
	4-1/4	14053	5/8	11	1341.89	10	7.0
	4-1/2	14056	5/8	11	1357.95	10	7.2
	4-3/4	14059	5/8	11	1486.65	10	7.6
	5	14062	5/8	11	1491.05	10	8.0
	5-1/2	14065	5/8	11	2326.28	10	8.5
	6	14068	5/8	11	2647.59	10	9.1

Pricing and Product Information – Inch Sizes

Camcar® Stainless Steel Socket Head Shoulder Screws



Made in
the U.S.A.

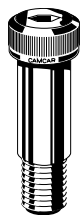

Product Description:

- 300 Series(18-8) Stainless Steel
- Made in USA
- DFAR compliant

Pricing Notes:

- Net Price per/ea. available in listed thread series only
- Bulk pricing available upon request

Shldr. Dia. Recess	Shoulder Length	EDP No.	Thread Dia.	TPI	Price Each	Count /Box	Wt. / Box
1/4"	1/8	73000	#10	24	1.21	25	0.3
	3/16	73003	#10	24	1.23	25	0.3
	1/4	73006	#10	24	1.25	25	0.3
	5/16	73009	#10	24	1.26	25	0.3
	3/8	73012	#10	24	1.27	25	0.3
	1/2	73015	#10	24	1.30	25	0.4
	5/8	73018	#10	24	1.35	25	0.4
	3/4	73021	#10	24	1.38	25	0.5
	1	73024	#10	24	1.45	25	0.5
	1-1/4	73027	#10	24	1.54	25	0.6
	1-1/2	73030	#10	24	1.63	25	0.7
	1-3/4	73033	#10	24	1.73	25	0.8
	2	73036	#10	24	1.81	25	0.9
	2-1/4	73039	#10	24	2.49	25	1.0
	2-1/2	73042	#10	24	2.59	25	1.1
	2-3/4	73045	#10	24	2.66	25	1.2
	3	73048	#10	24	2.73	25	1.3
5/16"	1/4	73051	1/4	20	1.40	25	0.5
	5/16	73054	1/4	20	1.43	25	0.5
	3/8	73057	1/4	20	1.45	25	0.5
	1/2	73060	1/4	20	1.50	25	0.6
	5/8	73063	1/4	20	1.55	25	0.7
	3/4	73066	1/4	20	1.62	25	0.7
	1	73069	1/4	20	1.72	25	0.9
	1-1/4	73072	1/4	20	1.86	25	1.0
	1-1/2	73075	1/4	20	1.97	25	1.1
	1-3/4	73078	1/4	20	2.09	25	1.3
	2	73081	1/4	20	2.19	25	1.4
	2 1/4	73084	1/4	20	2.91	25	1.6
	2 1/2	73087	1/4	20	3.01	25	1.7
	2 3/4	73090	1/4	20	3.11	25	1.8
	3	73093	1/4	20	3.26	25	2.0
	3 1/2	73096	1/4	20	3.47	25	2.2
	4	73099	1/4	20	3.97	25	2.5

Shldr. Dia. Recess	Shoulder Length	EDP No.	Thread Dia.	TPI	Price Each	Count /Box	Wt. / Box
3/8"	1/4	73102	5/16	18	2.01	25	0.8
	3/8	73105	5/16	18	2.08	25	0.9
	1/2	73108	5/16	18	2.15	25	1.0
	5/8	73112	5/16	18	2.23	25	1.1
	3/4	73115	5/16	18	2.30	25	1.2
	1	73118	5/16	18	2.47	25	1.4
	1-1/4	73121	5/16	18	2.61	25	1.6
	1-1/2	73124	5/16	18	2.76	25	1.8
	1-3/4	73127	5/16	18	2.91	25	2.0
	2	73130	5/16	18	3.09	25	2.2
	2-1/4	73133	5/16	18	3.80	25	2.4
	2-1/2	73136	5/16	18	3.95	25	2.6
	2-3/4	73139	5/16	18	4.14	25	2.8
	3	73142	5/16	18	4.28	25	3.0
	3-1/4	73145	5/16	18	4.78	25	3.2
	3-1/2	73148	5/16	18	4.97	25	3.4
1/2"	3-3/4	73151	5/16	18	5.69	25	3.6
	4	73154	5/16	18	5.85	25	3.8
	4-1/2	73157	5/16	18	7.00	25	4.2
	5	73160	5/16	18	7.36	25	4.6
	3/8	73163	3/8	16	2.77	25	1.8
	1/2	73166	3/8	16	2.91	25	2.0
	5/8	73169	3/8	16	3.03	25	2.1
	3/4	73172	3/8	16	3.18	25	2.3
	1	73175	3/8	16	3.44	25	2.7
	1-1/4	73178	3/8	16	3.71	25	3.0
	1-1/2	73181	3/8	16	3.99	25	3.4
	1-3/4	73184	3/8	16	4.25	25	3.7
	2	73187	3/8	16	4.52	25	4.1
	2-1/4	73190	3/8	16	5.34	25	4.4
	2-1/2	73193	3/8	16	5.62	25	4.8
	2-3/4	73196	3/8	16	5.88	25	5.1
5/8"	3	73199	3/8	16	6.14	25	5.5
	3-1/4	73202	3/8	16	6.45	25	5.8
	3-1/2	73205	3/8	16	6.71	25	6.2
	3-3/4	73208	3/8	16	8.07	25	6.5
	4	73211	3/8	16	8.39	25	6.9
	4-1/4	73214	3/8	16	9.10	25	7.3
	4-1/2	73217	3/8	16	9.41	10	3.1
	4-3/4	73220	3/8	16	9.84	10	3.2
	5	73223	3/8	16	10.13	10	3.3

Pricing and Product Information – Inch Sizes

Camcar® Stainless Steel Socket Head Shoulder Screws – *continued*



Made in
the U.S.A.

Shldr. Dia. Recess	Shoulder Length	EDP No.	Thread Dia.	TPI	Price Each	Count /Box	Wt. / Box	Shldr. Dia. Recess	Shoulder Length	EDP No.	Thread Dia.	TPI	Price Each	Count /Box	Wt. / Box
5/8" 5/16 Hex	1/2	73226	1/2	13	5.89	25	3.4	1" 1/2 Hex	1	73343	3/4	10	21.05	10	5.5
	5/8	73229	1/2	13	6.02	25	3.6		1-1/2	73346	3/4	10	24.73	10	6.6
	3/4	73232	1/2	13	6.25	25	3.9		1-3/4	73349	3/4	10	26.22	10	7.2
	1	73235	1/2	13	6.74	25	4.5		2	73352	3/4	10	28.18	10	7.8
	1-1/4	73238	1/2	13	7.24	25	5.0		2-1/2	73355	3/4	10	32.09	10	8.9
	1-1/2	73241	1/2	13	7.72	25	5.6		3	73358	3/4	10	35.31	10	10.0
	1-3/4	73244	1/2	13	8.26	25	6.1		3-1/2	73361	3/4	10	39.22	10	11.2
	2	73247	1/2	13	8.75	25	6.7		4	73364	3/4	10	49.91	10	12.3
	2 1/4	73250	1/2	13	11.35	25	7.2		5	73367	3/4	10	57.85	10	14.6
	2-1/2	73253	1/2	13	12.92	25	7.8								
	2-3/4	73256	1/2	13	13.56	25	8.3								
	3	73259	1/2	13	14.05	25	8.9								
	3-1/4	73262	1/2	13	14.55	25	9.4								
	3-1/2	73265	1/2	13	15.04	25	10.0								
	3-3/4	73268	1/2	13	15.63	10	4.2								
	4	73271	1/2	13	16.12	10	4.4								
	4-1/2	73274	1/2	13	17.13	10	4.9								
3/4" 3/8 Hex	1/2	73277	5/8	11	11.32	10	2.3								
	5/8	73280	5/8	11	11.62	10	2.5								
	3/4	73283	5/8	11	12.08	10	2.6								
	1	73286	5/8	11	12.88	10	2.9								
	1-1/4	73289	5/8	11	14.15	10	3.3								
	1-1/2	73292	5/8	11	14.49	10	3.6								
	1-3/4	73295	5/8	11	15.76	10	3.9								
	2	73298	5/8	11	16.79	10	4.2								
	2-1/4	73301	5/8	11	17.94	10	4.5								
	2-1/2	73304	5/8	11	19.09	10	4.8								
	2-3/4	73307	5/8	11	20.82	10	5.2								
	3	73310	5/8	11	21.62	10	5.5								
	3-1/4	73313	5/8	11	22.54	10	5.8								
	3-1/2	73316	5/8	11	23.81	10	6.1								
	3-3/4	73319	5/8	11	25.07	10	6.4								
	4	73322	5/8	11	26.45	10	6.7								
	4-1/4	73325	5/8	11	35.65	10	6.9								
	4-1/2	73328	5/8	11	37.03	10	7.2								
	4-3/4	73331	5/8	11	38.30	10	7.5								
	5	73334	5/8	11	39.68	10	7.8								
	5-1/2	73337	5/8	11	42.55	10	8.5								
	6	73340	5/8	11	45.31	10	9.1								

Pricing and Product Information – Inch Sizes

Camcar® Button Head Screws



Made in
the U.S.A.

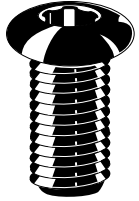

Product Description:

- Heat-treated alloy steel
- Class 3A thread fit standard
- TORX PLUS® Drive recess available
- DFAR compliant

Pricing Notes:

- Net price per 100 available in listed thread series only
- Bulk pricing upon request

Dia. Recess Size TPI	Length Under Head	UNRC			UNRF			Ct./ Box	Wt./ Box
		Hex EDP No.	TORX PLUS EDP No.	Price Per 100	Hex EDP No.	TORX PLUS EDP No.	Price Per 100		
#2 .050 Hex UNRC 56 TPI	3/16	14070		34.66				100	.1
	1/4	14072		36.89				100	.1
	3/8	14074		39.64				100	.1
#4 1/16 Hex 8IP TORX PLUS UNRC 40 TPI	3/16	14078		20.67				100	.1
	1/4	14080	34080	14.42				100	.1
	3/8	14083	34083	15.37				100	.2
	1/2	14089	34089	16.43				100	.2
#6 5/64 Hex 10IP TORX PLUS UNRC 32 TPI	3/16	14095		21.73				100	.2
	1/4	14101	34101	14.84				100	.2
	3/8	14107	34107	15.16				100	.2
	1/2	14110	34110	16.11				100	.3
	5/8	14113	34113	16.96				100	.3
#8 3/32 Hex 15IP TORX PLUS UNRC 32 TPI	3/16	71066		43.78				100	.2
	1/4	14125	34125	16.11				100	.2
	3/8	14131	34131	16.75				100	.2
	1/2	14134	34134	16.96				100	.3
	5/8	14137	34137	19.29				100	.3
	3/4	14140	34140	20.14				100	.4
	1	14143		21.52				100	.6
#10 1/8 Hex 25IP TORX PLUS UNRC 24 TPI UNRF 32 TPI	1/4	14152	34152	16.01	14302	34302	16.01	100	.3
	3/8	14155	34155	16.32	14305	34305	16.32	100	.4
	1/2	14158	34158	16.96	14311	34311	16.96	100	.4
	5/8	14161	34161	19.19	14314	34314	19.19	100	.5
	3/4	14164	34164	20.56	14317	34317	20.56	100	.6
	7/8	14167		23.32	14320	34320	23.32	100	.7
	1	14170	34170	24.17	14323	34323	24.17	100	.7

Dia. Recess Size TPI	Length Under Head	UNRC			UNRF			Ct./ Box	Wt./ Box
		Hex EDP No.	TORX PLUS EDP No.	Price Per 100	Hex EDP No.	TORX PLUS EDP No.	Price Per 100		
1/4"	1/4	71093		53.00				100	.6
	3/8	14176	34176	18.23	14329	34329	18.23	100	.6
	1/2	14179	34179	18.55	14332	34332	18.55	100	.8
	5/8	14182	34182	19.08	14335	34335	19.08	100	.9
	3/4	14185	34185	19.82	14338	34338	19.82	100	1.1
	7/8	14188		22.79				100	1.2
	1	14191	34191	23.11	14344	34344	23.11	100	1.3
	1-1/4	14194		28.30				100	1.5
	1-1/2	14197		30.74				100	1.8
	1-3/4	71096		70.60				100	2.2
5/16"	2	71099		82.15				100	2.6
	3/8	14203	34203	23.85	14350		23.85	100	1.0
	1/2	14206	34206	24.06	14353	34353	24.06	100	1.3
	5/8	14209	34209	28.51	14356		28.51	100	1.5
	3/4	14212	34212	28.94	14359	34359	28.94	100	1.7
	7/8	14215	34215	31.80				100	2.1
	1	14218	34218	32.33	14365	34365	32.33	100	2.1
	1-1/4	14221		51.41				100	2.3
	1-1/2	14224		54.27				100	2.5
	2	71108		70.07				100	2.8
3/8"	1/2	14230	34230	35.51	14371	34371	35.51	100	1.8
	5/8	14233	34233	39.22				100	2.2
	3/4	14236	34236	41.76				100	2.5
	7/8	14239	34239	45.90				100	2.9
	1	14242	34242	43.46	14380	34380	43.46	100	3.2
	1-1/4	14245	34245	46.43				100	3.9
	1-1/2	14248		57.98				100	4.2
	2	71120		89.36				100	4.6
1/2"	3/4	14257		71.34				100	6.0
	1	14260	34260	73.56				50	3.3
	1-1/4	14263		87.03				50	3.6
	1-1/2	14266		97.10				50	3.9
	2	14272		124.44				50	5.6

Pricing and Product Information – Inch Sizes

Camcar® Flanged Button Head Cap Screws



Made in
the U.S.A.

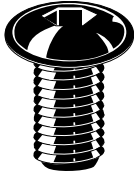

Product Description:

- Heat-treated alloy steel
- Fully threaded
- Large bearing surface
- DFAR compliant

Pricing Notes:

- Net price per 100 available in listed thread series only
- Bulk pricing upon request

Diameter, TPI and Drive Size	Length Under Head	Hex EDP Number	Price Per 100	Count /Box	Wt. / 100 Pcs.
#8 32 TPI 3/32 Hex	1/4	16453	14.20	100	0.2
	3/8	16456	14.73	100	0.2
	1/2	16459	15.48	100	0.3
#10 24 TPI 1/8 Hex	3/8	16462	15.26	100	0.4
	1/2	16465	15.58	100	0.4
	5/8	16468	16.85	100	0.5
	3/4	16471	17.91	100	0.6
#10 32 TPI 1/8 Hex	3/8	16513	15.26	100	0.4
	1/2	16517	15.58	100	0.4
	5/8	16520	16.96	100	0.5
	3/4	16523	18.02	100	0.6

Diameter, TPI and Drive Size	Length Under Head	Hex EDP Number	Price Per 100	Count /Box	Wt. / 100 Pcs.
1/4" 20 TPI 5/32 Hex	3/8	16474	16.96	100	0.6
	1/2	16477	17.28	100	0.8
	3/4	16480	18.44	100	1.1
	1	16483	21.20	100	1.3
5/16" 18 TPI 3/16 Hex	3/8	16486	20.67	100	1.0
	1/2	16489	20.99	100	1.3
	5/8	16491	23.32	100	1.5
	3/4	16495	24.49	100	1.7
	1	16498	27.77	100	1.9
3/8" 16 TPI 7/32 Hex	1/2	16501	29.15	100	1.8
	3/4	16504	36.46	100	2.5
	1	16507	38.69	100	3.2
	1-1/4	16510	41.87	100	3.9

Pricing and Product Information – Inch Sizes

Camcar® Low Head Cap Screws



Made in
the U.S.A.



Product Description:

- Heat-treated alloy steel
- Class 3A thread fit standard
- DFAR compliant

Pricing Notes:

- Net price per 100 available in listed thread series only
- Bulk pricing upon request

Dia., Recess Size, TPI	Length Under Head	UNRC		UNRF		Ct./ Box	Wt./Box (Lbs)
		Hex EDP No.	Price Per 100	Hex EDP No.	Price Per 100		
#6 5/64 Hex UNRC 32 TPI	1/4	20091	24.61			100	.2
	3/8	20094	25.25			100	.2
	1/2	20097	26.54			100	.2
	5/8	20098	27.61			100	.2
#8 5/64 Hex UNRC 32 TPI	1/4	20103	28.99			100	.2
	3/8	20003	26.75			100	.3
	1/2	20006	28.14			100	.3
	5/8	20009	28.99			100	.3
	3/4	20012	31.46			100	.5
	1	20015	34.35			100	.7
	1-1/4	20105	37.02			100	.7
	1-1/2	20108	39.38			100	.9
#10 3/32 Hex UNRC 24 TPI UNRF 32 TPI	1/4	20111	26.75	20141	27.71	100	.4
	3/8	20018	27.18	21003	28.14	100	.4
	1/2	20021	27.50	21006	28.89	100	.5
	5/8	20024	29.96	21009	30.01	100	.6
	3/4	20027	30.71	21012	31.14	100	.7
	1	20030	32.74	21015	33.01	100	.8
	1-1/4			20144	36.49	100	.8
	1-1/2			20147	39.38	100	.9

Dia., Recess Size, TPI	Length Under Head	UNRC		UNRF		Ct./ Box	Wt./Box (Lbs)	
		Hex EDP No.	Price Per 100	Hex EDP No.	Price Per 100			
1/4" 1/8 Hex UNRC 20 TPI UNRF 28 TPI	1/4	20114	25.79			100	.7	
	3/8	20033	27.29			100	.7	
	1/2	20036	27.93	20150	31.46	100	.8	
	5/8	20039	29.96			100	1.1	
	3/4	20042	31.46	20153	35.42	100	1.2	
	1	20045	34.35			100	1.3	
	1-1/2	20117	36.49			100	1.8	
	1-1/4	20050	36.00			100	1.5	
5/16" 5/32 Hex UNRC 18 TPI UNRF 24 TPI	1/2	20048	32.10	20159	35.95	100	1.4	
	3/4	20051	35.10	20161	38.20	100	1.8	
	1	20054	38.95			100	2.2	
	1-1/4	20057	44.19			100	2.8	
	1-1/2	20060	52.75			100	3.3	
	2	20129	60.77			100	4.0	
	3/8" 3/16 Hex UNRC 16 TPI	1/2	20063	43.98			100	2.2
		5/8	20064	48.10			100	2.6
3/4		20066	46.01			100	2.8	
1		20069	49.01			100	3.5	
1-1/4		20072	57.03			100	4.2	
1-1/2		20075	62.49			100	5.0	
2		20132	67.73			100	5.8	
1/2" 1/4 Hex UNRC 13 TPI		1	20078	106.36			50	3.7
	3/4	20076	118.10			50	3.3	
	1-1/4	20081	119.95			50	4.1	
	1-1/2	20084	134.18			50	4.7	
	2	20138	140.81			50	5.4	

Pricing and Product Information – Inch Sizes

Camcar® Flat Countersunk Head Cap Screws



Made in
the U.S.A.

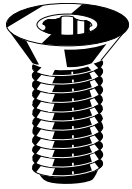

Product Description:

- Heat-treated alloy steel
- Class 3A thread fit standard except as noted
- TORX PLUS® Drive recess available
- DFAR compliant

Pricing Notes:

- Net price per 100 available in listed thread series only
- Bulk pricing upon request

Dia., Recess Size, TPI	Len. Under Head	UNRC			UNRF			Ct./ Box	Wt./ Box (Lbs)
		Hex EDP No.	TORX PLUS EDP No.	Price Per 100	Hex EDP No.	TORX PLUS EDP No.	Price Per 100		
#2 .050 Hex UNRC 56 TPI	3/16	14382		39.33				100	.1
	1/4	14385		42.29				100	.1
	3/8	14387		46.00				100	.1
	1/2	14390		49.40				100	.1
#4 1/16 Hex 10IP TORX PLUS UNRC 40 TPI	1/4	14392	34392	19.08				100	.1
	3/8	14395	34395	19.72				100	.1
	1/2	14398	34398	20.88				100	.1
	5/8	14401	34401	21.84				100	.2
	3/4	14404	34404	24.91				100	.2
#5 5/64 Hex 10IP TORX PLUS UNRC 40 TPI	1/4	14413	34413	20.67				100	.1
	3/8	14416	34416	20.56				100	.1
	1/2	14419	34419	21.84				100	.2
	5/8	14422		24.17				100	.2
	3/4	14425		27.35				100	.2
#6 5/64 Hex 15IP TORX PLUS UNRC 32 TPI	1/4	14434	34434	21.41				100	.1
	3/8	14440	34440	21.94				100	.2
	1/2	14443	34443	22.58				100	.2
	5/8	14446	34446	24.49				100	.3
	3/4	14449	34449	25.02				100	.3
	1	14451		29.57				100	.3
#8 3/32 Hex 20IP TORX PLUS UNRC 32 TPI	3/8	14458	34458	21.52				100	.3
	1/2	14461	34461	21.84				100	.3
	5/8	14464	34464	23.85				100	.4
	3/4	14467	34467	26.08				100	.4
	1	14473	34473	29.04				100	.5
#10 1/8 Hex 25IP TORX PLUS UNRC 24 TPI UNRF 32 TPI	3/8	14482	34482	21.62	14773	34773	21.62	100	.3
	1/2	14485	34485	21.84	14779	34779	21.84	100	.4
	5/8	14488	34488	24.80	14782	34782	24.80	100	.5
	3/4	14491	34491	25.02	14785	34785	25.02	100	.5
	1	14497	34497	30.00	14791	34791	30.00	100	.7
	1-1/4	14500		38.58	14794	34794	38.58	100	.9
1/4" 5/32 Hex 30IP TORX PLUS UNRC 20 TPI UNRF 28 TPI	1-1/2	14503		44.31	14797	34797	44.31	100	1.1
	3/8	14506	34506	24.38	14809		24.38	100	.6
	1/2	14509	34509	23.53	14815	34815	23.53	100	.8
	5/8	14515	34515	25.02	14818	34818	25.02	100	.9
	3/4	14518	34518	25.12	14821	34821	25.12	100	1.1
	7/8	72051		31.27				100	1.2
	1	14524	34524	27.98	14824	34824	27.98	100	1.3
	1-1/4	14527	34527	37.10	14827	34827	37.10	100	1.6
	1-1/2	14530	34530	43.46	14830		43.46	100	2.0
	1-3/4	14533	34533	52.68				100	2.3
	2	14536	34536	57.24				100	2.7
	2-1/2	14542		62.65				100	3.0
	3	72057		100.59				100	3.5

Dia., Recess Size, TPI	Len. Under Head	UNRC			UNRF			Ct./ Box	Wt./ Box (Lbs)
		Hex EDP No.	TORX PLUS EDP No.	Price Per 100	Hex EDP No.	TORX PLUS EDP No.	Price Per 100		
5/16"	1/2	14548	34548	27.88	14839	34839	27.88	100	1.4
	5/8	14554	34554	29.26	14842	34842	29.26	100	1.6
	3/4	14557	34557	29.68	14845	34845	29.68	100	1.8
	7/8	14560		30.74	14846		30.74	100	2.1
3/16" Hex 40IP TORX PLUS	1	14563	34563	31.80	14848	34848	31.80	100	2.3
	1-1/4	14566	34566	40.60	14851		40.60	100	2.7
	1-1/2	14572	34572	45.05	14854		45.05	100	3.2
	1-3/4	14575	34575	64.66				100	3.8
	2	14578	34578	71.23				100	4.3
	2-1/4	14581		82.26				100	4.8
UNRC 18 TPI UNRF 24 TPI	2-1/2	14584		92.33				100	5.3
	1/2	14590	34590	43.04				100	2.2
3/8"	5/8	14593	34593	41.34	14866	34866	41.34	100	2.5
	3/4	14596	34596	44.63	14869	34869	44.63	100	2.8
	1	14602	34602	45.05	14872	34872	45.05	100	3.6
	1-1/4	14605	34605	48.02	14875	34875	48.02	100	4.1
	1-1/2	14608	34608	50.56	14878		50.46	100	4.8
	1-3/4	14611	34611	73.25				100	5.4
UNRC 16 TPI UNRF 24 TPI	2	14614	34614	80.56				100	6.2
	2-1/4	14617		95.82				100	6.9
	2-1/2	14620	34620	103.46				50	3.9
	3	14626		122.32				50	4.6
7/16"	3/4	14635		88.09				100	3.6
	1	14638	34638	96.78				100	4.5
	1-1/4	14641		106.00				100	5.3
	1-1/2	14644		113.21				100	6.2
	1-3/4	14647		118.51				100	7.1
	2	14650		123.38				100	8.8
1/2"	3/4	14653	34653	90.18	14884		90.18	100	4.5
	1	14662	34662	94.28	14887		94.28	100	5.7
	1-1/4	14665	34665	108.65	14890		108.65	100	6.7
	1-1/2	14668	34668	114.80	14893		114.80	100	7.7
	1-3/4	14671	34671	129.60	14896		129.60	50	4.5
	2	14674	34674	135.00	14902		135.00	50	5.1
UNRC 13 TPI UNRF 20 TPI	2-1/4	14677		161.78				25	2.9
	2-1/2	14680		173.99				25	3.3
	3	14686		198.61				25	4.0
	1-1/4	14698		204.88				25	5.7
5/8"	3/8 Hex 55IP	14701		223.56				25	6.5
	1-3/4	14704		258.66				25	7.4
	2	14707		269.57				25	8.3

Pricing and Product Information – Inch Sizes

Camcar® Socket Set Screws – Cup Point



Made in
the U.S.A.



Product Description:

- Heat-treated alloy steel
- Class 3A thread fit standard
- TORX PLUS® Drive recess available
- DFAR compliant

Pricing Notes:

- Net price per 100 available in listed thread series only
- Bulk pricing available upon request

Dia., Recess Size, TPI	Len. Under Head	UNRC			UNRF			Ct./ Box	Wt./ Box (Lbs)
		Hex EDP No.	TORX PLUS EDP No.	Price Per 100	Hex EDP No.	TORX PLUS EDP No.	Price Per 100		
#2 .035 Hex UNC 56 TPI	1/16	11449		51.30				100	.03
	3/32	11450		53.42				100	.03
	1/8	11452		54.06				100	.03
	3/16	11455		56.50				100	.03
	1/4	11458		57.24				100	.03
#3 .050 Hex UNC 48 TPI	3/32	11463		41.98				100	.04
	1/8	11464		42.40				100	.04
	3/16	11467		43.04				100	.04
	1/4	11470		43.46				100	.04
#4 .050 Hex UNC 40 TPI UNF 48 TPI	1/8	11473		14.42	11962		14.42	100	.1
	3/16	11476		14.63	11965		14.63	100	.1
	1/4	11479		14.73	11968		14.73	100	.1
	5/16	11482		14.95				100	.1
	3/8	11485		15.90				100	.1
	1/2	11491		18.66				100	.2
	5/8	11494		22.58				100	.2
#5 1/16 Hex UNC 40 TPI UNF 44 TPI	1/8	11497		15.48	11977		15.48	100	.1
	3/16	11500		15.79				100	.1
	1/4	11503		16.11				100	.1
	5/16	11506		16.32				100	.1
	3/8	11509		17.99				100	.2
	1/2	11515		19.08				100	.2
	5/8	11518		19.82				100	.3
	3/4	11521		20.78				100	.3
#6 1/16 Hex 6IP TORX PLUS (UNC) 7IP TORX PLUS (UNF)	1/8	11524		16.96	11986		16.96	100	.1
	3/16	11527	31527	15.16	11989		15.16	100	.1
	1/4	11530	31530	15.37	11992		15.37	100	.1
	5/16	11533		15.58				100	.1
	3/8	11536	31536	15.79	11998		15.79	100	.2
	1/2	11542		16.75				100	.3
	5/8	11545		22.58				100	.3
	3/4	11548		25.23				100	.4
	7/8	11551		34.98				100	.4
	1	11554		37.52				100	.4
#8 5/64 Hex 8IP TORX PLUS	1/8	11557		14.10				100	.1
	3/16	11560	31560	14.31				100	.1
	1/4	11563	31563	14.52	12007		14.52	100	.1
	5/16	11566		14.84				100	.2
	3/8	11569	31569	15.26	12013	32013	15.26	100	.2
	1/2	11575		17.28				100	.3
	5/8	11578		23.64				100	.3
	3/4	11581		25.02				100	.4
	7/8	11584		33.28				100	.4
	1	11587		36.89				100	.5

Dia., Recess Size, TPI	Len. Under Head	UNRC			UNRF			Ct./ Box	Wt./ Box (Lbs)
		Hex EDP No.	TORX PLUS EDP No.	Price Per 100	Hex EDP No.	TORX PLUS EDP No.	Price Per 100		
#10 3/32 Hex 10IP TORX PLUS	3/16	11590		14.52	12022		14.52	100	.2
	1/4	11593	31593	14.84	12025	32025	14.84	100	.2
	5/16	11596	31596	15.26	12028		15.26	100	.2
	3/8	11599	31599	16.43	12031	32031	16.43	100	.3
	1/2	11602		17.70	12037	32037	17.70	100	.3
	5/8	11605		18.44	12040	32040	18.44	100	.4
	3/4	11608		20.88	12043	32043	20.88	100	.5
	7/8	11611		34.98				100	.6
	1	11617		38.58	12049		38.58	100	.7
	1-1/4	11620		40.39	12052		40.39	100	.8
1/4" 1/8 Hex 15IP TORX PLUS (UNC) 20IP TORX PLUS (UNF)	3/16	11626		15.90	12061	32061	15.90	100	.2
	1/4	11629	31629	14.52	12064	32064	14.52	100	.3
	5/16	11632	31632	14.84	12067	32067	14.84	100	.3
	3/8	11635	31635	16.22	12070	32070	16.22	100	.4
	1/2	11641	31641	17.17	12076	32076	17.17	100	.5
	5/8	11644		20.56	12079	32079	20.56	100	.6
	3/4	11647	31647	23.32	12082	32082	23.32	100	.7
	7/8	11650		29.47				100	.8
	1	11653		33.50	12085	32085	33.50	100	.9
	1-1/4	11656		42.40	12088	32088	42.40	100	1.2
UNC 20 TPI UNF 28 TPI	1-1/2	11659		53.32				100	1.5
	1-3/4	11662		68.16				100	1.9
	2	11665		77.70				100	2.2
	1/4	11671		17.38	12094		17.38	100	.4
	5/16	11674	31674	16.43	12097		16.43	100	.5
5/32 Hex 25IP TORX PLUS (UNC) 27IP TORX PLUS (UNF)	3/8	11677	31677	16.64	12100		16.64	100	.6
	7/16	11680		17.07				100	.7
	1/2	11683	31683	17.38	12106		17.38	100	.8
	5/8	11686		22.05	12109		22.05	100	1.0
	3/4	11689		25.44	11687		25.44	100	1.2
	7/8	11692		35.62				100	1.4
	1	11695		37.95	12118		37.95	100	1.6
	1-1/4	11698		43.46				100	1.9
	1-1/2	11701		57.56				100	2.4
	1-3/4	11704		71.13				100	3.0
UNC 18 TPI UNF 24 TPI	2	11707		75.58				100	3.4

Pricing and Product Information – Inch Sizes

Camcar® Socket Set Screws – Cup Point, *continued*



Made in
the U.S.A.

Dia., Recess Size, TPI	Len. Under Head	UNRC			UNRF			Ct./ Box	Wt./ Box (Lbs)
		Hex EDP No.	TORX PLUS EDP No.	Price Per 100	Hex EDP No.	TORX PLUS EDP No.	Price Per 100		
3/8"	1/4	11713		21.41	12124		21.41	100	.6
	5/16	11716		22.79				100	.6
	3/8	11719		19.08	12130		19.08	100	.8
	1/2	11725		22.26	12136		22.26	100	1.1
	5/8	11728		25.76	12139		25.76	100	1.3
	3/4	11731		27.56	12142		27.56	100	1.8
	1	11737		37.95	12148		37.95	100	2.3
	1-1/4	11740		48.12	12151		48.12	100	2.7
	1-1/2	11743		62.65	12134		62.65	100	3.6
	1-3/4	11746		76.11				100	3.6
UNC 16 TPI UNF 24 TPI	2	11749		88.09				100	5.0
	2-1/2	11752		96.46				100	6.3

Dia., Recess Size, TPI	Len. Under Head	UNRC			UNRF			Ct./ Box	Wt./ Box (Lbs)
		Hex EDP No.	TORX PLUS EDP No.	Price Per 100	Hex EDP No.	TORX PLUS EDP No.	Price Per 100		
7/16"	3/8				12163		53.00	100	1.1
	1/2	11761		46.22	12169		46.22	100	1.4
	5/8	11764		50.46				100	1.7
	3/4	11767		54.48				100	2.2
7/32 Hex	1	11773		70.28				100	3.0
	1-1/4	11776		75.47				100	4.1
	1-1/2	11779		88.09				100	4.5
	2	11782		110.98				50	3.4
UNC 14 TPI UNF 20 TPI	3/8	11794		56.16				100	1.3
	1/2	11800		55.40	12187		55.40	100	1.7
	5/8	11803		60.91				100	2.2
	3/4	11806		63.07	12193		63.07	100	2.9
1/2"	7/8	11809		70.52				100	3.3
	1	11812		79.70	12196		79.70	100	3.9
	1-1/4	11815		100.22				100	5.0
	1-1/2	11818		111.56				100	6.2
UNC 13 TPI UNF 20 TPI	1-3/4	11821		129.17				50	3.7
	2	11824		146.23				50	4.3
	2-1/2	11830		188.24				50	5.4
	3	11833		195.91				50	6.5

Camcar® Socket Set Screws – Knurled Cup Point



Product Description:

- Heat-treated alloy steel
- Class 3A thread fit standard
- DFAR compliant

Pricing Notes:

- Net price per 100 available in listed thread series only
- Bulk pricing available upon request

Dia., Recess Size, TPI	Length Under Head	UNRC		UNRF		Ct./ Box	Wt./ Box (Lbs)
		Hex EDP No.	Price Per 100	Hex EDP No.	Price Per 100		
#6	1/8	13180	14.98			100	.1
	3/16	13183	15.19			100	.1
	1/4	13186	15.52			100	.1
#8	1/8	13210	14.66			100	.1
	1/4	13216	15.52			100	.2
	3/8	13222	15.41			100	.2
#10	3/16	13240	15.09	13627	15.09	100	.2
	1/4	13243	15.41	13630	15.41	100	.2
	3/8	13246	16.37	13636	16.37	100	.3

Dia., Recess Size, TPI	Length Under Head	UNRC		UNRF		Ct./ Box	Wt./ Box (Lbs)
		Hex EDP No.	Price Per 100	Hex EDP No.	Price Per 100		
1/4"	3/16	13270	15.62			100	.2
	1/4	13273	15.52	13657	15.52	100	.3
	5/16	13276	15.52			100	.3
	3/8	13279	16.26			100	.4
1/8 Hex	1/2	13282	17.23			100	.5
	5/8	13285	20.65			100	.6
	3/4	13288	24.08			100	.7
UNC 20 TPI UNF 28 TPI	1/4	13309	18.30	13681	18.30	100	.4
	5/16	13312	16.37			100	.5
	3/8	13315	16.59			100	.6
	1/2	13321	17.76			100	.8
5/16"	3/8	13354	19.26	13711	19.26	100	.8
	1/2	13360	20.65	13714	20.65	100	1.1
	5/8	13363	23.33			100	1.2
	3/4	13366	24.93			100	1.3

Pricing and Product Information – Inch Sizes

Camcar® Precision Hardened Ground Machine Dowel Pins



Made in
the U.S.A.

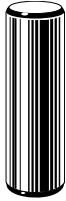

Product Description:

- Heat-treated alloy steel
- Standard size (.0002 over nominal diameter)
- DFAR compliant

Pricing Notes:

- Net price per 100
- Bulk pricing available upon request

Dia. Overall	Length	EDP No.	Price Per 100	Count Per Box	Wt. Lb./ Box
1/16"	3/16	15766	23.98	100	.05
	1/4	15769	24.31	100	.05
	3/8	15775	24.64	100	.1
	1/2	15781	25.74	100	.1
	5/8	15784	25.96	100	.1
	3/4	15787	26.29	100	.1
3/32"	3/16	15736	22.77	100	.06
	1/4	15739	22.88	100	.06
	5/16	15742	22.99	100	.06
	3/8	15745	23.21	100	.06
	7/16	15748	23.98	100	.1
	1/2	15751	24.42	100	.1
	5/8	15754	24.86	100	.1
	3/4	15757	25.08	100	.1
1/8"	1	15763	25.30	100	.2
	3/8	15802	23.65	100	.5
	1/2	15808	23.98	100	.5
	5/8	15811	24.19	100	.5
	3/4	15814	25.38	100	.5
	7/8	15817	27.43	100	.5
	1	15820	29.81	100	.5
	1-1/4	15826	30.56	100	.5
	1-1/2	15832	35.32	100	.5
	1-3/4	15835	38.56	100	.5
3/16"	2	15838	42.34	100	.5
	1/2	15841	25.49	100	.5
	5/8	15844	26.14	100	.5
	3/4	15847	28.08	100	.5
	7/8	15850	29.81	100	.5
	1	15853	31.10	100	1.0
	1-1/4	15859	34.56	100	1.0
	1-1/2	15865	38.23	100	1.0
	1-3/4	15868	42.44	100	1.5
	2	15871	47.20	100	1.5
1/4"	1/2	15874	28.62	100	.5
	5/8	15877	30.13	100	1.0
	3/4	15880	30.67	100	1.0
	7/8	15883	33.48	100	1.5
	1	15886	34.34	100	1.5
	1-1/4	15892	37.37	100	2.0
	1-1/2	15898	41.90	100	2.0
	1-3/4	15901	47.41	100	2.5
	2	15904	52.49	100	3.0
	2-1/4	15907	64.04	100	3.5
	2-1/2	15910	65.23	100	3.5

Dia. Overall	Length	EDP No.	Price Per 100	Count Per Box	Wt. Lb./ Box
5/16"	1/2	15919	35.21	100	1.0
	5/8	15922	36.94	100	1.5
	3/4	15925	38.12	100	1.5
	7/8	15928	39.07	100	2.0
	1	15931	39.20	100	2.0
	1-1/4	15937	43.42	100	3.0
	1-1/2	15943	48.60	100	3.5
	1-3/4	15946	58.97	100	4.0
	2	15952	63.61	100	4.5
	2-1/2	15958	79.16	100	5.5
3/8"	3	15961	94.61	100	6.5
	1/2	15967	43.20	20	.3
	5/8	15970	44.82	20	.4
	3/4	15973	46.01	20	.5
	7/8	15976	47.20	20	.6
	1	15979	47.84	20	.7
	1-1/4	15985	51.30	20	.8
	1-1/2	15991	58.32	20	1.0
	1-3/4	15994	66.96	20	1.1
	2	15997	73.66	20	1.3
7/16"	2-1/4	16000	80.57	20	1.4
	2-1/2	16003	91.80	20	1.6
	3	16009	113.29	20	1.9
	1	16021	88.88	20	.9
	1-1/4	16024	95.80	20	1.0
	1-1/2	16027	102.71	20	1.3
	2	16033	116.54	20	2.1
	3/4	16051	95.15	20	.8
	1	16057	100.76	20	1.1
	1-1/4	16060	107.35	20	1.4
1/2"	1-1/2	16063	114.05	20	1.7
	1-3/4	16066	121.39	20	2.0
	2	16069	135.00	20	2.2
	2-1/4	16072	151.74	20	2.5
	2-1/2	16075	162.65	20	2.8
	3	16081	193.54	20	3.3
	1-1/4	16099	172.70	10	1.1
	1-1/2	16102	179.63	10	1.3
	1-3/4	16106	208.34	10	1.5
	2	16108	225.50	10	1.8
5/8"	2-1/2	16114	265.43	10	2.3
	3	16120	314.93	10	2.6

Pricing and Product Information – Metric Sizes

Camcar® Socket Head Cap Screws



Made in
the U.S.A.



Product Description:

- Class 12.9
- Standard package
- DFAR compliant

Pricing Notes:

- Net price per 100 available in listed thread series only
- Bulk pricing upon request

Diameter, Thread Pitch, Key Size	Length Under Head	Hex EDP No.	Price Per 100	Ct./Box	Weight Lbs/Box
M3 0.5 pitch 2.5mm Hex	6	60003	18.90	100	0.071
	8	60005	17.01	100	0.080
	10	60007	17.22	100	0.088
	12	60009	17.96	100	0.096
	16	60011	18.27	100	0.116
	20	60013	18.90	100	0.138
	25	60015	22.58	100	0.161
M4 0.7 pitch 3mm Hex	8	60025	17.22	100	0.165
	10	60027	17.54	100	0.180
	12	60029	18.27	100	0.195
	16	60031	19.11	100	0.225
	20	60033	20.48	100	0.265
	25	60035	23.10	100	0.315
	30	60037	23.26	100	0.365
	35	60039	24.47	100	0.415
	40	60041	29.04	100	0.465
	45	60043	32.32	100	0.515
M5 0.8 pitch 4mm Hex	50	60045	37.13	100	0.565
	8	60047	21.53	100	0.245
	10	60049	18.90	100	0.270
	12	60051	20.48	100	0.295
	16	60053	21.42	100	0.345
	20	60055	22.05	100	0.401
	25	60057	22.68	100	0.478
M6 1.0 pitch 5mm Hex	30	60059	23.84	100	0.555
	10	60071	18.69	100	0.470
	12	60073	19.32	100	0.507
	16	60075	20.48	100	0.575
	20	60077	21.42	100	0.653
	25	60079	22.89	100	0.759
	30	60081	24.57	100	0.870
	35	60083	28.35	100	0.991
	40	60085	29.93	100	1.10
	50	60089	33.63	100	1.32

Diameter, Thread Pitch, Key Size	Length Under Head	Hex EDP No.	Price Per 100	Ct./Box	Weight Lbs/Box
M8 1.25 pitch 6mm Hex	12	60103	24.80	100	1.08
	16	60105	25.33	100	1.21
	20	60107	26.50	100	1.34
	25	60109	29.26	100	1.50
	30	60111	31.16	100	1.69
	35	60113	33.92	100	1.89
	40	60115	35.72	100	2.09
	50	60119	43.13	100	2.49
M10 1.5 pitch 8mm Hex	16	60133	37.52	100	2.09
	20	60135	37.95	100	2.29
	25	60137	38.90	100	2.54
	30	60139	40.70	100	2.79
	35	60141	44.52	100	3.10
	40	60143	48.02	100	3.41
	45	60145	50.88	50	3.72
	50	60147	54.38	50	4.03
	60	60151	67.63	50	4.65
	70	60155	87.45	50	5.27
M12 1.75 pitch 10mm Hex	20	60165	76.32	50	3.21
	25	60167	79.29	50	3.57
	30	60169	81.62	50	3.93
	35	60171	91.58	50	4.29
	40	60173	105.68	50	4.73
	45	60175	115.12	50	5.17
	50	60177	122.01	50	5.61
	55	60179	132.50	25	6.05
	60	60181	141.09	25	6.49
M16 2.0 pitch 14mm Hex	30	60199	176.81	25	7.78
	35	60201	194.40	25	8.44
	40	60203	196.31	25	9.10
	45	60205	216.03	25	9.76
	50	60207	223.07	25	10.6
	55	60209	240.94	25	11.4
	60	60211	249.95	25	12.2

Pricing and Product Information – Metric Sizes

Camcar® Socket Head Button Head Screws



Made in
the U.S.A.

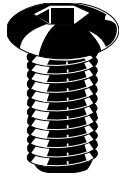

Product Description:

- Heat-treated alloy steel
- DFAR compliant

Pricing Notes:

- Net price per 100 available in listed thread series only
- Bulk pricing upon request

Dia., Thread Pitch, Key Size	Length Under Head	Hex EDP No.	Price Per 100	Ct./Box	Weight Lb/Box
M3 0.50 pitch 2mm Hex	6	77109	14.10	100	0.048
	8	60405	14.84	100	0.050
	10	60407	15.16	100	0.064
	12	60409	15.90	100	0.073
	16	77112	17.00	100	0.19
M4 0.70 pitch 2.5mm Hex	8	60411	16.75	100	0.118
	10	60413	17.38	100	0.136
	12	60415	17.91	100	0.154
	16	60417	19.61	100	0.195
M5 0.80 pitch 3mm Hex	10	60419	17.38	100	0.218
	12	60421	17.81	100	0.245
	16	60423	19.61	100	0.290
	20	77115	22.10	100	0.44
	25	77118	24.60	100	0.55
	30	77121	26.40	100	0.61
M6 1.00 pitch 4mm Hex	10	60431	18.02	100	0.295
	12	60433	18.66	100	0.334
	16	60435	20.46	100	0.408
	20	60437	21.73	100	0.476
	25	60439	24.80	100	0.562
	30	77124	27.10	100	0.648

Dia., Thread Pitch, Key Size	Length Under Head	Hex EDP No.	Price Per 100	Ct./Box	Weight Lb/Box
M8 1.25 pitch 5mm Hex	10	77127	24.50	100	0.512
	12	60445	25.02	100	0.535
	16	60447	25.33	100	0.699
	20	60449	25.55	100	0.848
	25	60451	29.47	100	1.04
	30	60453	32.86	100	1.26
	35	77130	33.90	100	1.49
M10 1.50 pitch 6mm Hex	40	77133	36.10	100	1.71
	16	77136	37.20	100	1.41
	20	60459	38.58	100	1.66
	25	60461	44.94	100	1.91
	30	60463	51.30	100	2.15
	35	77139	53.60	100	2.39
M12 1.75 pitch 8mm Hex	40	77142	55.20	100	2.63
	16	77145	79.30	50	1.8
	20	77148	83.10	50	2.2
	25	77151	86.00	50	2.56
	30	77154	89.30	50	2.8
	35	77157	93.60	50	3.12
	40	77160	96.60	50	3.45
	50	77163	102.00	50	3.69

Pricing and Product Information – Metric Sizes

Camcar® Socket Countersunk Flat Head Screws



Made in
the U.S.A.

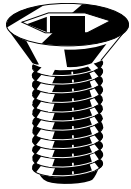

Product Description:

- Heat-treated alloy steel
- DFAR compliant

Pricing Notes:

- Net price per 100
- Bulk pricing upon request

Dia., Thread Pitch, Key Size	Length Under Head	Hex EDP No.	Price Per 100	Ct./Box	Weight Lb/Box
M3 0.50 pitch 2mm Hex	6	77000	19.50	100	0.06
	8	60277	20.14	100	0.062
	10	60279	21.62	100	0.071
	12	60281	22.26	100	0.080
	16	60283	23.74	100	0.098
	20	77003	25.10	100	0.12
	25	77006	26.70	100	0.15
M4 0.70 pitch 2.5mm Hex	8	60287	21.62	100	0.105
	10	60289	22.15	100	0.120
	12	60291	23.11	100	0.135
	16	60293	23.74	100	0.165
	20	77009	24.80	100	0.20
	25	77012	25.70	100	0.23
	30	77015	27.10	100	0.26
M5 0.80 pitch 3mm Hex	35	77018	29.30	100	0.29
	40	77021	31.10	100	0.32
	8	77024	24.00	100	0.19
	10	60303	24.80	100	0.207
	12	60305	25.02	100	0.231
	16	60307	25.55	100	0.277
	20	60309	26.08	100	0.335
M6 1.00 pitch 4mm Hex	25	60311	29.79	100	0.404
	30	77027	31.60	100	0.47
	35	77030	33.40	100	0.54
	40	77033	36.90	100	0.61
	50	77036	41.10	100	0.68
	8	77039	22.90	100	0.30
	10	77042	23.60	100	0.31
M8 1.25 pitch 5mm Hex	12	60319	24.38	100	0.344
	16	60321	25.02	100	0.414
	20	60323	27.03	100	0.484
	25	60325	31.16	100	0.571
	30	60327	36.15	100	0.682
	35	60329	41.45	100	0.793
	40	77045	43.80	100	0.90
	45	77048	45.60	100	1.02
	50	77051	48.10	100	1.13

Dia., Thread Pitch, Key Size	Length Under Head	Hex EDP No.	Price Per 100	Ct./Box	Weight Lb/Box
M8 1.25 pitch 5mm Hex	10	77054	35.00	100	0.69
	12	77057	36.10	100	0.80
	16	60337	36.89	100	0.92
	20	60339	37.74	100	1.04
	25	60341	39.22	100	1.19
	30	60343	41.45	100	1.34
	35	60345	45.37	100	1.54
	40	60347	45.65	100	1.83
	45	77060	46.10	100	1.94
	50	77063	49.30	100	2.14
	60	77066	57.10	100	2.34
	70	77069	66.00	100	2.54
M10 1.50 pitch 6mm Hex	16	77072	45.10	100	1.51
	20	60351	47.28	100	1.63
	25	60353	47.70	100	1.88
	30	60355	51.73	100	2.13
	35	77075	54.60	100	2.38
	40	77078	57.10	100	2.69
	45	77082	60.90	100	3.00
	50	77085	64.10	100	3.31
M12 1.75 pitch 8mm Hex	60	77088	72.00	100	3.62
	70	77091	81.00	100	3.93
	20	77094	96.40	50	2.42
	25	77097	99.30	50	2.78
	30	77100	106.10	50	3.14
	35	77103	109.80	50	3.50
	40	77106	116.40	50	3.86

Pricing and Product Information – Drive Tools



Made in
the U.S.A.

TORX PLUS® Drive Tools

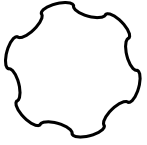

Pricing Notes:

- All prices are net each



TORX PLUS Insert Bits

Hex Shank	Size	Overall Length	EDP No.	Quantity Break Price Per Each			
				<100	101-500	501-1000	Over 1000
1/4"	1IP	1	357-P0101-61	20.62	18.32	17.19	15.77
	2IP	1	357-P0201-61	19.64	17.45	16.37	15.02
	3IP	1	357-P0301-61	18.70	16.62	15.59	14.30
	4IP	1	357-P0401-61	12.28	11.22	10.69	9.88
	5IP	1	357-P0501-61	10.52	9.70	9.10	8.73
	6IP	1	357-P0601-61	9.24	8.03	7.48	7.36
	7IP	1	357-P0701-61	7.48	6.69	6.16	6.02
	8IP	1	357-P0801-61	7.48	6.69	6.16	6.02
	10IP	1	357-P1001-61	4.15	3.74	3.47	3.36
	15IP	1	357-P1501-61	4.15	3.74	3.47	3.36
	20IP	1	357-P2001-61	4.15	3.74	3.47	3.36
	25IP	1	357-P2501-61	4.15	3.74	3.47	3.36
	27IP	1	357-P2701-61	4.15	3.74	3.47	3.36
	30IP	1	357-P3001-61	4.15	3.74	3.47	3.36
	40IP	1	357-P4001-61	4.15	3.74	3.47	3.36
5/16"	30IP	1-1/4	357-P3002-01	4.15	3.74	3.47	3.36
	40IP	1-1/4	357-P4002-01	4.15	3.74	3.47	3.36
	45IP	1-1/4	357-P4502-01	4.80	4.29	4.02	3.74
5/8"	50IP	1-1/2	357-P5002-41	74.36	71.94	61.38	58.30
	55IP	1-1/2	357-P5502-41	74.36	71.94	61.38	58.30
	60IP	1-1/2	357-P6002-41	74.36	71.94	61.38	58.30
	70IP	1-1/2	357-P7002-41	74.36	71.94	61.38	58.30
7/8"	80IP	2	357-P8003-21	96.25	93.50	90.97	79.20

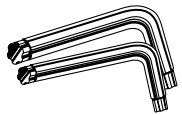

TORX PLUS Short Arm Keys*

Size	Part Number	Price Each
10IP	356-P010-01	4.40
15IP	356-P015-01	4.40
20IP	356-P020-01	4.68
25IP	356-P025-01	4.80
27IP	356-P027-01	5.23
30IP	356-P030-01	5.36
40IP	356-P040-01	5.75
45IP	356-P045-01	6.16
50IP	356-P050-01	6.71

*25 pieces per box

TORX PLUS Power Bits (1/4" Shank)



Size	Overall Length	EDP Number	Quantity Break Price Per Each			
			<100	101-500	501-1000	Over 1000
6IP	2	357-P0603-21	11.77	10.45	10.03	9.49
7IP	2	357-P0703-21	11.77	10.45	10.03	9.49
8IP	2	357-P0803-21	11.77	10.45	10.03	9.49
10IP	2	357-P1003-21	8.80	8.03	7.65	7.37
15IP	2	357-P1503-21	8.80	8.03	7.65	7.37
20IP	2	357-P2003-21	8.80	8.03	7.65	7.37
25IP	2	357-P2503-21	8.80	8.03	7.65	7.37
27IP	2	357-P2703-21	8.80	8.03	7.65	7.37
30IP	2	357-P3003-21	8.80	8.03	7.65	7.37
40IP	2	357-P4003-21	8.80	8.03	7.65	7.37
6IP	2-3/4	357-P0604-41	12.16	10.69	9.94	9.76
7IP	2-3/4	357-P0704-41	12.16	10.69	9.94	9.76
8IP	2-3/4	357-P0804-41	12.16	10.69	9.94	9.76
10IP	2-3/4	357-P1004-41	9.35	8.31	7.76	7.48
15IP	2-3/4	357-P1504-41	9.35	8.31	7.76	7.48
20IP	2-3/4	357-P2004-41	9.35	8.31	7.76	7.48
25IP	2-3/4	357-P2504-41	9.35	8.31	7.76	7.48
27IP	2-3/4	357-P2704-41	9.35	8.31	7.76	7.48
30IP	2-3/4	357-P3004-41	9.35	8.31	7.76	7.48
40IP	2-3/4	357-P4004-41	9.35	8.31	7.76	7.48
6IP	3-1/2	357-P0605-61	14.03	12.43	12.05	11.66
7IP	3-1/2	357-P0705-61	14.03	12.43	12.05	11.66
8IP	3-1/2	357-P0805-61	14.03	12.43	12.05	11.66
10IP	3-1/2	357-P1005-61	11.09	9.77	9.35	9.08
15IP	3-1/2	357-P1505-61	11.09	9.77	9.35	9.08
20IP	3-1/2	357-P2005-61	11.09	9.77	9.35	9.08
25IP	3-1/2	357-P2505-61	11.09	9.77	9.35	9.08
27IP	3-1/2	357-P2705-61	11.09	9.77	9.35	9.08
30IP	3-1/2	357-P3005-61	11.09	9.77	9.35	9.08
8IP	6	357-P0809-61	14.19	12.65	12.21	11.77
10IP	6	357-P1009-61	14.19	12.65	12.21	11.77
15IP	6	357-P1509-61	14.19	12.65	12.21	11.77
20IP	6	357-P2009-61	14.19	12.65	12.21	11.77
25IP	6	357-P2509-61	14.19	12.65	12.21	11.77
27IP	6	357-P2709-61	14.19	12.65	12.21	11.77
30IP	6	357-P3009-61	14.19	12.65	12.21	11.77



TORX PLUS Tamper-Resistant Insert Bits

Hex Shank	Size	Overall Length	EDP Number	Price Per Each
1/4"	10IPR	1	357-P1091-61	Call For Current Pricing & Availability
	15IPR	1	357-P1591-61	Call For Current Pricing & Availability
	20IPR	1	357-P2091-61	Call For Current Pricing & Availability
	25IPR	1	357-P2591-61	Call For Current Pricing & Availability
	27IPR	1	357-P2791-61	Call For Current Pricing & Availability
	30IPR	1	357-P3091-61	Call For Current Pricing & Availability
	40IPR	1	357-P4091-61	Call For Current Pricing & Availability

Pricing and Product Information – Tools



TORX® Drive Tools

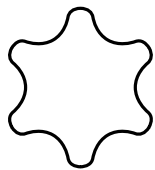

Pricing Notes:

- All prices are net each



TORX Insert Bits

Hex Shank	TORX Size	Overall Length	EDP Number	Price Each
1/4"	T-1	1	357-00101-61	17.66
	T-2	1	357-00201-61	17.66
	T-3	1	357-00301-61	15.13
	T-4	1	357-00401-61	11.77
	T-5	1	357-00501-61	11.13
	T-6	1	357-00601-61	8.58
	T-7	1	357-00701-61	3.61
	T-8	1	357-00801-61	3.61
	T-9	1	357-00901-61	3.61
	T-10	1	357-01001-61	2.00
	T-15	1	357-01501-61	2.00
	T-20	1	357-02001-61	2.00
	T-25	1	357-02501-61	2.00
	T-27	1	357-02701-61	2.00
	T-30	1	357-03001-61	2.00
	T-40	1	357-04001-61	2.13
5/16"	T-30	1-1/4	357-03002-01	3.36
	T-40	1-1/4	357-04002-01	3.88
	T-45	1-1/4	357-04502-01	4.55
	T-55	1-1/2	357-05502-41	55.88
	T-60	1-1/2	357-06002-41	55.88
5/8"	T-70	1-1/2	357-07002-41	55.88
7/8"	T-90	2	357-09003-21	69.41
	T-100	2	357-10003-21	71.94

TORX Drive System Interchangability Table

TORX Size	Socket Head Cap Screw	Button Head Cap Screw	Flat Head Cap Screw	Pressure Plug	Socket Set Screw
T-7					6
T-8		4			8
T-9					
T-10	4,5	6	4,5		10
T-15	6	8	6		1/4
T-20			8		
T-25	8	10	10		
T-27	10	1/4		1/16	5/16
T-30	1/4		1/4	1/8	3/8
T-40		5/16	5/16		
T-45	5/16	3/8	3/8	1/4	1/2
T-50	3/8		7/16, 1/2		
T-55	7/16, 1/2	1/2	5/8	3/8	
T-60	5/8	3/4			
T-70	5/8				
T-90	3/4				
T-100					

TORX Sockets

TORX Size	Drive Size	EDP Number	Price Each
E-5	1/4	359-00500-41	16.83
E-8	1/4	359-00800-41	17.38
E-18	1/2	359-01800-81	30.25
E-20	1/2	359-02000-81	30.58
E-20	3/4	359-02001-21	44.33
E-22	1	359-02201-61	207.21
E-32	3/4	359-03201-21	65.67
E-36	1	359-03601-61	223.41

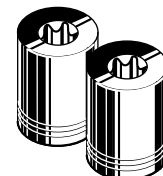

TORX Short Arm Keys

TORX Size	EDP Number	Price Each
T-7	356-0007-01	4.18
T-8	356-0008-01	4.18
T-9	356-0009-01	4.18
T-10	356-0010-01	1.49
T-15	356-0015-01	1.49
T-20	356-0020-01	1.62
T-25	356-0025-01	1.76
T-27	356-0027-01	1.87
T-30	356-0030-01	2.31

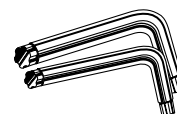

TORXalign® Bits (1/4" Hex Shank, Insert Bit)

TORX Size	Overall Length	EDP Number	Price Each
T-6	1	357-00611-61	8.69
T-7	1	357-00711-61	8.69
T-8	1	357-00811-61	8.69
T-9	1	357-00911-61	7.92
T-10	1	357-01011-61	6.93
T-15	1	357-01511-61	6.93
T-20	1	357-02011-61	6.93
T-25	1	357-02511-61	6.93
T-27	1	357-02711-61	6.93
T-30	1	357-03011-61	6.93

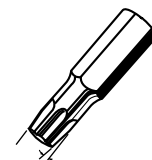

Tamper-Resistant TORX Insert Bits

TORX Size	Overall Length	EDP Number	Price Each
T-8	1	357-00891-61	10.82
T-10	1	357-01091-61	8.42
T-15	1	357-01591-61	8.42
T-20	1	357-02091-61	8.42
T-25	1	357-02591-61	8.42
T-27	1	357-02791-61	8.42
T-30	1	357-03091-61	8.42
T-40	1	357-04091-61	8.42



Adaptors

TORX Size	Drive Size	EDP Number	Price Each
3/4	5/8 Hex	359-07201-21	34.43
3/4	7/8 Hex	359-07281-21	47.94
1	5/8 Hex	359-0820L-61	108.45
1	7/8 Hex	359-08281-61	61.67

Technical and Torque Data – Inch Sizes

Camcar® Socket Head Cap Screws

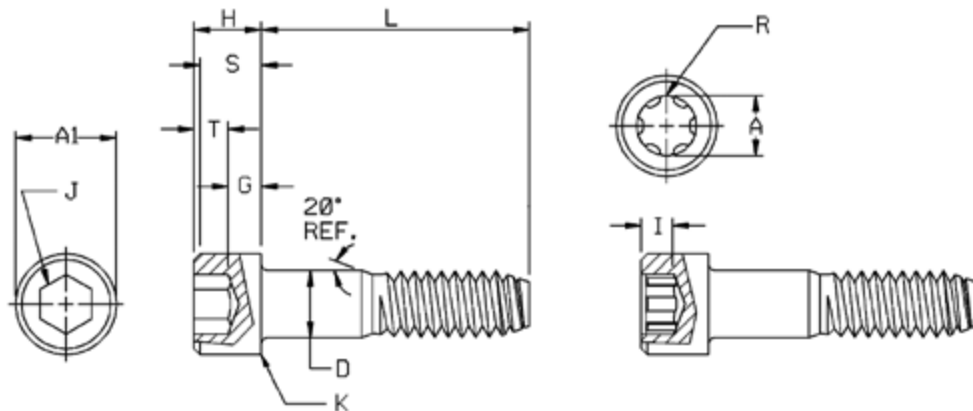

Dimensions of Hex and TORX PLUS® Drive Socket Head Cap Screws

Nominal Size or Basic Screw Diameter		D Body Diameter		A1 Head Diameter		H Head Height		S	R	A	I	J		T	G	K
								Head Side	TORX PLUS			Hex Socket Size		Hex Key Engag. Min.	Wall Thick. Min.	Chamfer or Radius Max.
		Max.	Min.	Max.	Min.	Max.	Min.	Height Min.	Drive Size	Recess Dim. Ref.	Key Eng. Min.	Nom.	In.			
0	0.0600	0.0600	0.0568	0.096	0.091	0.060	0.057	0.054	6IP	0.069	0.027		0.050	0.025	0.020	0.003
1	0.0730	0.0730	0.0695	0.118	0.112	0.073	0.070	0.066	7IP	0.081	0.036	1/16	0.062	0.031	0.025	0.003
2	0.0860	0.0860	0.0822	0.140	0.134	0.086	0.083	0.077	8IP	0.094	0.037	5/64	0.078	0.038	0.029	0.003
3	0.0990	0.0990	0.0949	0.161	0.154	0.099	0.095	0.089	8IP	0.094	0.041	5/64	0.078	0.044	0.034	0.003
4	0.1120	0.1120	0.1075	0.183	0.176	0.112	0.108	0.101	10IP	0.111	0.049	3/32	0.094	0.051	0.038	0.005
5	0.1250	0.1250	0.1202	0.205	0.198	0.125	0.121	0.112	10IP	0.111	0.049	3/32	0.094	0.057	0.043	0.005
6	0.1380	0.1380	0.1329	0.226	0.218	0.138	0.134	0.124	15IP	0.132	0.058	7/64	0.109	0.064	0.047	0.005
8	0.1640	0.1640	0.1585	0.270	0.262	0.164	0.159	0.148	25IP	0.178	0.078	9/64	0.141	0.077	0.056	0.005
10	0.1900	0.1900	0.1840	0.312	0.303	0.190	0.185	0.171	27IP	0.200	0.088	5/32	0.156	0.090	0.065	0.005
1/4	0.2500	0.2500	0.2435	0.375	0.365	0.250	0.244	0.225	30IP	0.221	0.097	3/16	0.188	0.120	0.095	0.008
5/16	0.3125	0.3125	0.3053	0.469	0.457	0.312	0.306	0.281	45IP	0.312	0.137	1/4	0.250	0.151	0.119	0.008
3/8	0.3750	0.3750	0.3678	0.562	0.550	0.375	0.368	0.337	50IP	0.352	0.155	5/16	0.312	0.182	0.143	0.008
7/16	0.4375	0.4375	0.4294	0.656	0.642	0.438	0.430	0.394	55IP	0.446	0.202	3/8	0.375	0.213	0.166	0.010
1/2	0.5000	0.5000	0.4919	0.750	0.735	0.500	0.492	0.450	55IP	0.446	0.202	3/8	0.375	0.245	0.190	0.010
5/8	0.6250	0.6250	0.6163	0.938	0.921	0.625	0.616	0.562	70IP	0.619	0.291	1/2	0.500	0.307	0.238	0.010
3/4	0.7500	0.7500	0.7406	1.125	1.107	0.750	0.740	0.675	80IP	0.699	0.332	5/8	0.625	0.370	0.285	0.010
7/8	0.8750	0.8750	0.8467	1.312	1.293	0.875	0.864	0.787	100IP	0.882	0.425	3/4	0.750	0.432	0.333	0.015
1	1.0000	1.0000	0.9886	1.500	1.479	1.000	0.988	0.900	100IP	0.882	0.425	3/4	0.750	0.495	0.380	0.015
1-1/4	1.2500	1.2500	1.2336	1.875	1.852	1.250	1.236	1.125				7/8	0.875	0.620	0.475	0.015
1-1/2	1.5000	1.5000	1.4818	2.250	2.224	1.500	1.485	1.350				1	1.000	0.745	0.570	0.015

Technical and Torque Data – Inch Sizes

Camcar® Socket Head Cap Screws

Mechanical Properties

Nominal Size	Tensile Strength	Yield Strength	Elongation* in 2"	Reduction of Area*	Hardness
	PSI Min.	PSI Min.	% Min.	% Min.	Rockwell C
0 to 1/2"	180,000	162,000	8%	35%	39 - 45
Over 1/2"	170,000	153,000	8%	35%	37 - 45

Nominal Size	Basic Screw Dia.	Tensile Stress Area		Tensile Strength (Lbs. Min.)		Yield Strength (Lbs. Min.)		Single Shear Strength* (Lbs Min.)
		UNRC	UNRF	UNRC	UNRF	UNRC	UNRF	Body Section
0	0.0600		0.00180		324		290	280
1	0.0730	0.00263	0.00278	473	500	425	450	420
2	0.0860	0.00370	0.00394	666	709	600	635	580
3	0.0990	0.00487	0.00523	877	941	790	845	770
4	0.1120	0.00604	0.00661	1,090	1,190	975	1,070	985
5	0.1250	0.00796	0.00830	1,430	1,490	1,290	1,345	1,225
6	0.1380	0.00909	0.01015	1,640	1,830	1,470	1,645	1,495
8	0.1640	0.01400	0.01474	2,520	2,650	2,270	2,385	2,110
10	0.1900	0.01750	0.02000	3,150	3,600	2,835	3,240	2,835
1/4	0.2500	0.03180	0.03640	5,725	6,500	5,150	5,900	4,910
5/16	0.3125	0.05240	0.05800	9,430	10,400	8,490	9,395	7,670
3/8	0.3750	0.07750	0.08780	13,950	15,800	12,555	14,225	11,045
7/16	0.4375	0.10630	0.11870	19,135	21,400	17,220	19,230	15,035
1/2	0.5000	0.14190	0.15990	25,540	28,800	22,990	25,905	19,635
5/8	0.6250	0.22600	0.25600	38,400	43,500	34,550	39,150	30,680
3/4	0.7500	0.33400	0.37300	56,750	63,400	51,100	57,050	44,180
7/8	0.8750	0.46200	0.50900	78,500	86,500	70,700	77,850	60,130
1	1.0000	0.60600	0.66300	103,000	113,000	92,700	101,450	78,540
1-1/4	1.2500	0.96900	1.07300	164,700	182,000	148,250	164,150	122,720
1-1/2	1.5000	1.40500	1.48100	238,800	269,000	214,950	241,900	176,710

* Calculated at 100 ksi shear strength

Technical and Torque Data – Inch Sizes

Camcar® Socket Head Cap Screws

This product is a high tensile strength fastener designed for use in applications where the material being clamped is of sufficient hardness (generally Rockwell B90/614 MPa ultimate tensile strength for steel and cast iron is adequate for the preload induced by the above seating torques; softer materials may require a washer under the head to prevent indentation). The application can be recessed with a counterbore where clearance for open and socket wrenches is a problem. Typical applications include use in a machine assembly, punch press tooling, bearing caps, split collars, etc.

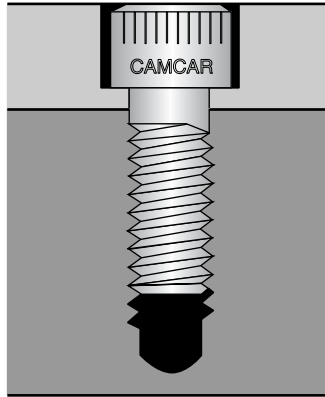

Applications Data

Nom. Size	Basic Screw Dia.	Tension Induced in Screws Torqued as Recommended (Lb.)		Suggested Seating Torque (In-Lb)	
		UNRC	UNRF	UNRC	UNRF
#0	0.0600		220		2.7
#1	0.0730	320	340	4.9	5.2
#2	0.0860	450	480	8.1	8.6
#3	0.0990	590	630	12.3	13.2
#4	0.1120	730	800	17.2	18.9
#5	0.1250	970	1,010	25.4	26.5
#6	0.1380	1,100	1,230	32.0	35.7
#8	0.1640	1,700	1,790	58.6	61.6
#10	0.1900	2,130	2,430	84.8	97.0
1/4"	0.2500	3,860	4,420	202.8	232.3
5/16"	0.3125	6,370	7,050	417.8	462.4
3/8"	0.3750	9,416	10,670	741.5	840.2
7/16"	0.4375	12,910	14,420	1,186.6	1,325.1
1/2"	0.5000	17,240	19,430	1,810.5	2,040.0
5/8"	0.6250	25,910	29,560	3,401.0	3,854.0
3/4"	0.7500	38,320	42,790	6,036.0	6,739.0
7/8"	0.8750	53,020	53,390	9,743.0	10,728.0
1"	1.0000	69,525	76,087	14,600.0	15,978.0
1-1/4"	1.2500	111,120	123,113	29,186.0	32,317.0
1-1/2"	1.5000	161,212	181,425	50,782.0	57,149.0

Notes for Socket Head Cap Screws – Inch

- (1) Nominal Size: Where specifying nominal size in decimals, zeros preceding decimal and in the fourth decimal place shall be omitted.
- (2) Body: The term body refers to the unthreaded portion of the shank for screws not threaded to the head.
- (3) Head Diameter: Heads may be plain or knurled at the option of the manufacturer, unless specified by the customer. For knurled screws, the maximum head diameter shall be measured across the tops of the knurl and the minimum head diameter shall be the diameter of the unknurled portion, or the diameter across the tops of the knurls for those screws not having an unknurled portion, just above the radius or chamfer at the bottom edge of the head.
- (4) Head Chamfer: The head shall be chamfered at an angle with the plane of the top of the head. The edge between the top of the head and the chamfer may be slightly rounded.
- (5) Bearing Surface: The plane of the bearing surface shall be perpendicular to the axis of the screw within a maximum deviation of 1°.
- (6) Edge of Head: The edge between the bearing surface and the side of the head may be broken (rounded or chamfered) but the radius or chamfer measured along the bearing surface shall not exceed the values listed for "K".
- (7) Mechanical Properties: The mechanical properties included in the above charts are based on testing that was performed at normal room temperatures. When application environment temperatures fall dramatically below or are substantially higher than room temperature, certain variables need to be taken into consideration. If temperatures exceed 400°F (204°C), short time tensile, creep and relaxation need to be evaluated. When application temperatures drop below -20°F (-29°C), lower ductility, impact strength and fatigue life should be taken into account.
- (8) Material: Camcar Socket Head Cap Screws shall be fabricated from an alloy steel having one or more of the following alloying elements: chromium, nickel, molybdenum or vanadium, in sufficient quantity to assure that the specified hardness range of Rockwell C39-45 for sizes #0 to 1/2" and C37-45 for sizes over 1/2" is achieved. Decarburization and carburization limits shall be the same as those specified for Socket Head Cap Screws in ASTM Specification A574, Alloy Steel Socket Head Cap Screws.

Technical and Torque Data – Inch Sizes

Camcar® Socket Shoulder Screws

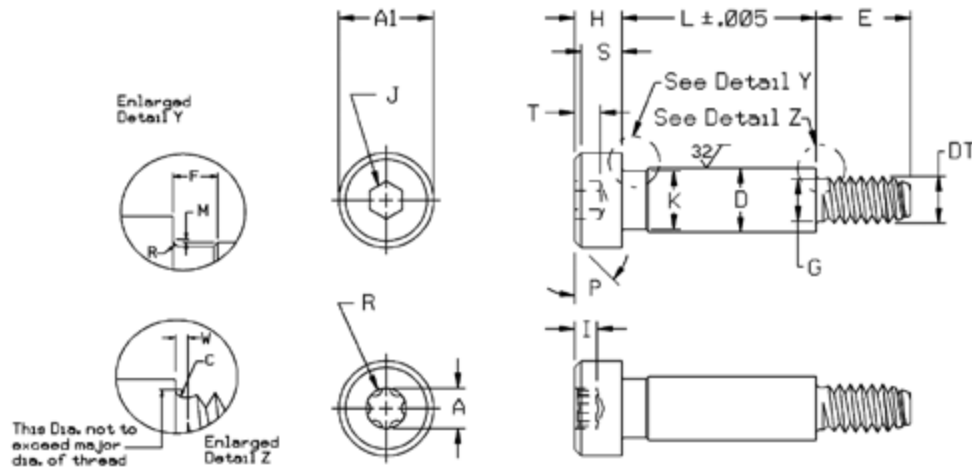

Dimensions of Hex and TORX PLUS® Socket Shoulder Screws

Nom. Shoulder Dia.		D Shoulder Dia.		A1 Head Dia.		H Head Height		S Head Side Height	R TORX PLUS			J Hex Socket Size Nom.		T Hex Key Eng.	M Head Fillet Extended Above D	R Head Fillets Radius
									Drive Size	Recess Dim. Ref	Key Eng. Min.					
		Max.	Min.	Max.	Min.	Max.	Min.		Min.	Max	Min.					
1/4	0.2500	0.2480	0.2460	0.375	0.357	0.188	0.177	0.157	20IP	0.155	0.068	1/8	0.125	0.094	0.014	0.009
5/16	0.3125	0.3105	0.3085	0.438	0.419	0.219	0.209	0.183	27IP	0.200	0.088	5/32	0.156	0.117	0.017	0.012
3/8	0.3750	0.3730	0.3710	0.562	0.543	0.250	0.240	0.209	40IP	0.266	0.117	3/16	0.188	0.141	0.020	0.015
1/2	0.5000	0.4980	0.4960	0.750	0.729	0.312	0.302	0.262	45IP	0.312	0.137	1/4	0.250	0.188	0.026	0.020
5/8	0.6250	0.6230	0.6210	0.875	0.853	0.375	0.365	0.315	55IP	0.446	0.196	5/16	0.312	0.234	0.032	0.024
3/4	0.7500	0.7480	0.7460	1.000	0.977	0.500	0.490	0.421	60IP	0.529	0.245	3/8	0.375	0.281	0.039	0.030

Nom. Shoulder Dia.		K	F	DT Nominal Thread Size or Basic Dia.		TPI	G		W	C		E
		Shoulder Neck Dia.	Neck Width				Threaded Neck Dia.		Thread Neck Width	Threaded Neck Fillet		Threaded Length
		Max.	Max.				Max.	Min.	Max.	Max.	Min.	Basic
1/4	0.2500	0.227	0.093	10	0.1900	24	0.142	0.133	0.083	0.023	0.017	0.375
5/16	0.3125	0.289	0.093	1/4	0.2500	20	0.193	0.182	0.100	0.028	0.022	0.438
3/8	0.3750	0.352	0.093	5/16	0.3125	18	0.249	0.237	0.111	0.031	0.025	0.500
1/2	0.5000	0.477	0.093	3/8	0.3750	16	0.304	0.291	0.125	0.035	0.029	0.625
5/8	0.6250	0.602	0.093	1/2	0.5000	13	0.414	0.397	0.154	0.042	0.036	0.750
3/4	0.7500	0.727	0.093	5/8	0.6250	11	0.521	0.502	0.182	0.051	0.045	0.875

Nominal or Basic Shoulder Diameter		Mechanical Properties			Application Data
		Tensile Strength	Shear Strength		Suggested Seating Torque*
			Thread Neck Area	Shoulder Area	
		Lb. Min.			
1/4	0.2500	1,950	8,246	1,167	36
5/16	0.3125	3,640	12,885	2,185	89
3/8	0.3750	6,170	18,555	3,706	188
1/2	0.5000	9,310	32,986	5,587	340
5/8	0.6250	17,300	51,541	10,398	845
3/4	0.7500	27,700	74,220	16,625	1,688

Socket head shoulder screws are designed and recommended for use with stripper springs and guides in punch press die sets. They can also be used for attaching cams, rollers, links and levers, as stationary guides and as pressure pads.

Technical and Torque Data – Inch Sizes

Camcar® Button Head Cap Screws

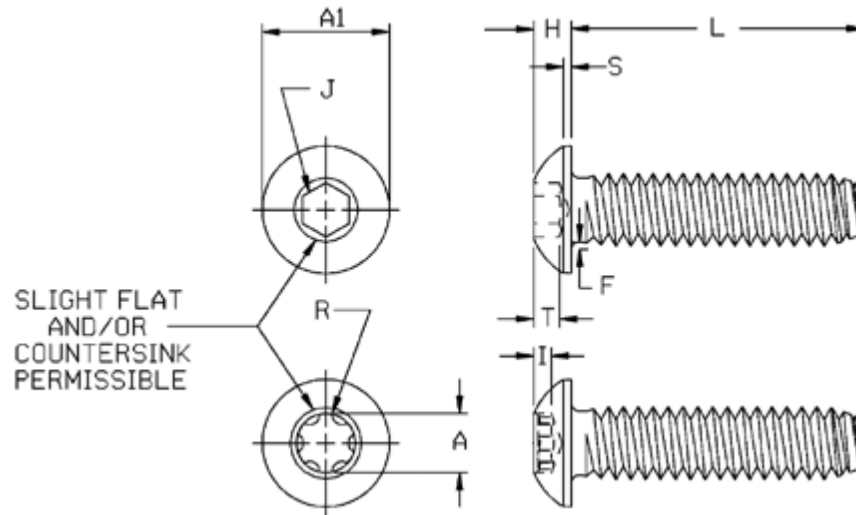

Dimensions of Hex and TORX PLUS® Drive Socket Button Head Cap Screws

Nominal Size or Basic Screw Diameter		A1 Head Dia.		H Head Height		S Head Side Height	R	A	I	J Hexagon Socket Size		T Hex Head Key Engmt.	F Ext. Fillet Above D		L Max. Length
							TORX PLUS								
							Drive Size	Recess Dim.	Key Engmt.						
		Max.	Min.	Max.	Min.	Ref.		Ref.	Min.	Nom.	In.	Min.	Max.	Min.	Nom.
0	0.0600	0.114	0.104	0.032	0.026	0.010					0.035	0.020	0.010	0.005	1/2
2	0.0860	0.164	0.154	0.046	0.038	0.010	6IP	.069	0.023		0.050	0.028	0.010	0.005	1/2
4	0.1120	0.213	0.201	0.059	0.051	0.015	8IP	.094	0.032	1/16	0.062	0.035	0.010	0.005	1/2
6	0.1380	0.262	0.250	0.073	0.063	0.015	10IP	.111	0.038	5/64	0.078	0.044	0.010	0.005	5/8
8	0.1640	0.312	0.298	0.087	0.077	0.015	15IP	.132	0.045	3/32	0.094	0.052	0.015	0.010	3/4
10	0.1900	0.361	0.347	0.101	0.091	0.020	25IP	.178	0.052	1/8	0.125	0.070	0.015	0.010	1
1/4	0.2500	0.437	0.419	0.132	0.122	0.031	27IP	.200	0.068	5/32	0.156	0.087	0.020	0.015	1
5/16	0.3125	0.547	0.527	0.166	0.152	0.031	40IP	.266	0.090	3/16	0.188	0.105	0.020	0.015	1
3/8	0.3750	0.656	0.636	0.199	0.185	0.031	45IP	.312	0.106	7/32	0.219	0.122	0.020	0.015	1-1/4
1/2	0.5000	0.875	0.851	0.265	0.245	0.046	55IP	.446	0.158	5/16	0.312	0.175	0.030	0.020	2
5/8	0.6250	1.000	0.970	0.331	0.311	0.062	60IP	.529	0.192	3/8	0.375	0.210	0.030	0.020	2

Mechanical and Application Data

Nominal Tensile Size or Basic Screw Diameter		Single Shear*		Suggested Seating Torque** lb./in.	
		Strength (lb.) Min. UNRC/UNRF	Strength (lb.) Body Section	UNRC	UNRF
				Plain Finish	Plain Finish
0	0.060	260	282	1	1
2	0.086	540	580	3	3
4	0.112	840	985	7	8
6	0.138	1,260	1,495	13	14
8	0.164	1,940	2,110	23	24
10	0.190	2,440	2,835	34	38
1/4	0.250	4,430	4,910	80	92
5/16	0.3125	7,300	7,670	165	182
3/8	0.375	10,880	11,045	293	332
1/2	0.500	19,800	19,633	715	806
5/8	0.625	31,500	30,680	1,425	1,610

* Some shear values derived by calculation.

** Seating torques calculated to induce 48,000 psi tensile stress with a "K" factor of .21.

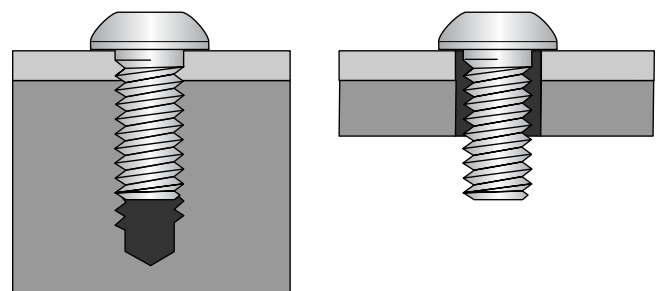

This product is designed and recommended for applications where a low profile socket head screw is desired. Wrenchability is limited by the socket size and key engagement. Because of the head configuration, this product is not recommended for use in high-strength applications or where maximum fatigue resistance is required.

Technical and Torque Data – Inch Sizes

Camcar® Low Head Cap Screws

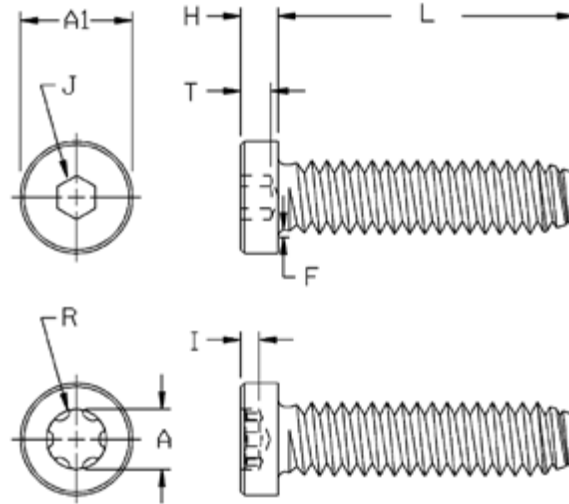

Dimensions of Hex and TORX PLUS® Socket Low Head Cap Screws

Nominal Size		A1 Head Diameter		H Head Height		R	A	I	J Hex Socket Size		T Hex Key Engmt.	F Fillet Extension	
						TORX PLUS							
		Max.	Min.	Max.	Min.	Drive Size	Recess Dim. Ref.	Key Engmt. Min.	Nom.	In.	Min.	Max.	Min.
8	0.1640	0.270	.265	.082	.079	15IP	.132	.045	5/64	.0781	.060	.012	.007
10	0.1900	0.312	.307	.095	.092	20IP	.155	.053	3/32	.0938	.072	.014	.009
1/4	0.2500	0.375	.369	.125	.121	27IP	.200	.068	1/8	.1250	.094	.014	.009
5/16	0.3125	0.437	.431	.156	.152	30IP	.221	.075	5/32	.1562	.120	.017	.012
3/8	0.3750	0.562	.556	.187	.182	40IP	.266	.090	3/16	.1875	.145	.020	.015
1/2	0.5000	0.750	.743	.250	.244	50IP	.352	.120	1/4	.2500	.184	.026	.020

Mechanical & Applications Data

Nominal Size or Basic Screw Diameter		Tensile Strength lb. Min.		Single Shear* Strength (lb.) Thru Body Section	Suggested Seating Torque** (lb./in.)	
		UNRC	UNRF		UNRC	UNRF
8	0.164	2,380	2,510	2,110	23	24
10	0.190	2,980	3,400	2,835	34	38
1/4	0.250	5,400	6,100	4,910	80	92
5/16	0.3125	8,900	9,800	7,670	165	182
3/8	0.375	13,100	14,900	11,045	293	332
1/2	0.500	24,100	27,100	19,635	715	806

* Some shear values are derived by calculation.

** Seating torques calculated to induce 48,000 psi tensile stress with a "K" factor of .26.

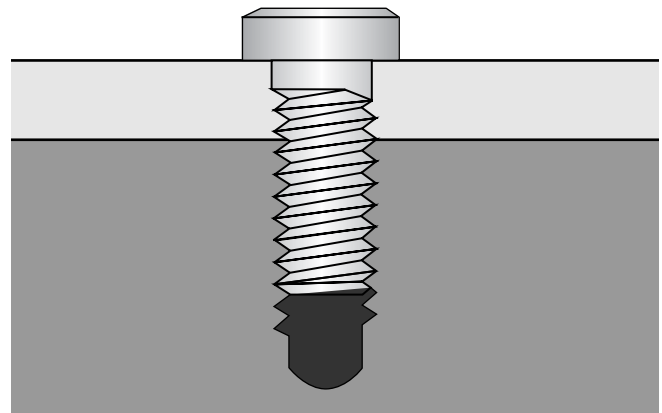

Socket low head cap screws are precision fasteners designed for applications where head height clearance is a problem. Because of their reduced head height and smaller socket size, they normally **can not be preloaded as high** as standard socket head cap screws and should not be subjected to high tensile loads.

Technical and Torque Data – Inch Sizes

Camcar® Countersunk Flat Head Cap Screws

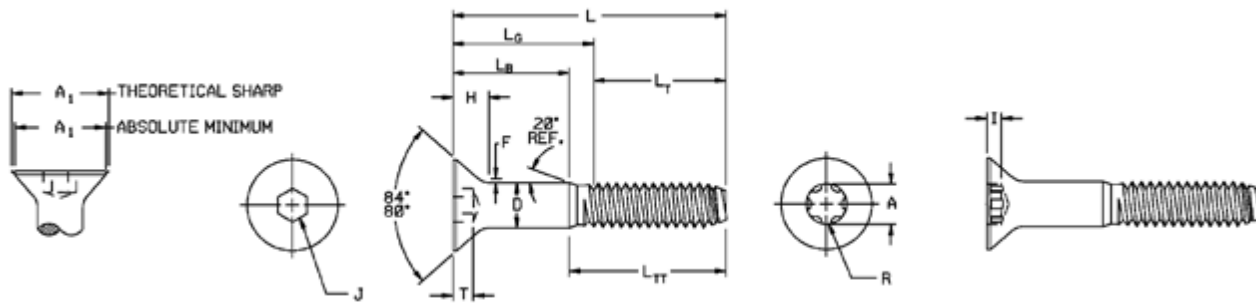

Dimensions of Hex and TORX PLUS® Flat Countersunk Head Cap Screws

Nominal Size or Basic Screw Dia.		D		A1 Head Dia.		H Head Height		R	A	I	J Hex Socket Size		T Hex Key Engmt. Min.	F Ext. Fillet Above D Max.
								TORX PLUS						
		Body Dia. Max.	Theor. Sharp Min.	Abs. Min.	Abs. Max.	Min.	Flush. Tol.	Drive Size	Recess Dim. Ref.	Key Engmt. Min.	Nom.	In.		
4	0.1120	0.1120	0.1075	0.255	0.218	0.083	0.011	10IP	.111	.038	1/16	0.062	0.055	0.012
5	0.1250	0.1250	0.1202	0.281	0.240	0.090	0.012	10IP	.111	.038	5/64	0.078	0.061	0.014
6	0.1380	0.1380	0.1329	0.307	0.263	0.097	0.013	15IP	.132	.045	5/64	0.078	0.066	0.015
8	0.1640	0.1640	0.1585	0.359	0.311	0.112	0.014	20IP	.155	.053	3/32	0.094	0.076	0.015
10	0.1900	0.1900	0.1840	0.411	0.359	0.127	0.015	25IP	.178	.061	1/8	0.125	0.087	0.015
1/4	0.2500	0.2500	0.2435	0.531	0.480	0.161	0.016	30IP	.221	.075	5/32	0.156	0.111	0.015
5/16	0.3125	0.3125	0.3053	0.656	0.600	0.198	0.017	40IP	.266	.090	3/16	0.188	0.135	0.015
3/8	0.3750	0.3750	0.3678	0.781	0.720	0.234	0.018	45IP	.312	.106	7/32	0.219	0.159	0.015
7/16	0.4375	0.4375	0.4294	0.844	0.781	0.234	0.018	50IP	.352	.120	1/4	0.250	0.159	0.015
1/2	0.5000	0.5000	0.4919	0.938	0.872	0.251	0.018	50IP	.352	.120	5/16	0.312	0.172	0.015
5/8	0.6250	0.6250	0.6163	1.188	1.112	0.324	0.022	55IP	.446	.158	3/8	0.375	0.220	0.015
3/4	0.7500	0.7500	0.7406	1.438	1.355	0.396	0.024	60IP	.529	.192	1/2	0.500	0.220	0.015

Mechanical & Application Data

Nom. Size	Basic Screw Diameter	Tensile Strength (lbs) Min. UNRC/UNRF	Single Shear Strength* (lbs)			Suggested Seating Torque** (lb./in.)	
			Body Section	Thread Section		UNRC Plain Finish	UNRF Plain Finish
				UNRC	UNRF		
4	0.1120	900	950	630	690	8.4	9.2
5	0.1250	1,185	1,190	830	870	12.0	13.0
6	0.1380	1,350	1,460	950	1,060	16.0	18.0
8	0.164	2,085	2,070	1,470	1,550	29.0	30.0
10	0.1900	2,610	2,790	1,840	2,100	42.0	47.0
1/4	0.2500	4,750	4,900	3,340	3,830	99.0	114.0
5/16	0.3125	7,800	7,700	5,500	6,100	204.0	226.0
3/8	0.3750	11,600	11,100	8,100	9,200	363.0	411.0
7/16	0.4375	15,900	15,200	11,100	12,400	580.0	648.0
1/2	0.5000	21,200	20,000	14,900	16,800	885.0	998.0
5/8	0.6250	33,800	31,400	23,700	26,900	1,763.0	1,997.0
3/4	0.7500	50,000	45,300	35,100	39,200	3,126.0	3,491.0

* Some shear values are derived by calculation.

** Seating torques calculated to induce 48,000 psi tensile stress with a "K" factor of .26.

Technical and Torque Data – Inch Sizes

Camcar® Socket Set Screws

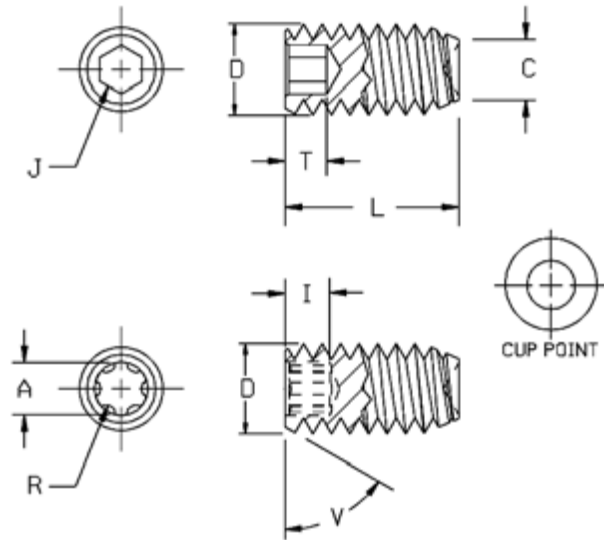

Mechanical & Application Data

Nominal Screw Size	Suggested Seating Torque*	Axial Holding Power lbs.
2	0.0860	85
3	0.0990	120
4	0.1120	160
5	0.1250	200
6	0.203	250
8	0.164	385
10	0.1900	540
1/4	0.2500	1,000
5/16	0.3125	1,500
3/8	0.3750	2,000
7/16	0.4375	2,500
1/2	0.5000	3,000
5/8	0.6250	4,000
3/4	0.7500	5,000
7/8	0.8750	5,600
1	1.0000	6,500

* Calculated to reach 85% of minimum key strength.

NOTE: Set screws must have minimum recess depth shown above to generate full recess strength. The axial holding power data in the table above is for cup point set screws and is provided for reference only, as actual holding power may vary by +25%. It is recommended that laboratory testing of your set screw application be performed to verify results.

Dimensions of Hex and TORX PLUS® Socket Set Screws

D			R	A	I	J Hex Socket Size		T Min. Key Eng. To Develop Functional Capability of Key Hex Socket	B Shortest Opt. Nom. Length To Which "T" Applies Cup and Flat Pts.	C Cup and Flat Dia.	
			TORX PLUS Drive							Max.	Min.
Nom. Size	Thread Series	Basic Screw Dia.	Rec Size	Rec. Dia. Ref.	Min. Eng.	Nom Size.	In.				
#2	UNC	.086					.035	.060	.13	.047	.039
#3	UNC	.099					.050	.070	.19		
#4	UNC/UNF	.112	6IP	.069	.027		.050	.070	.19	.061	.051
#5	UNC/UNF	.125	7IP	.081	.036	1/16"	.062	.080	.19	.067	.057
#6	UNC	.138	6IP	.069	.027	1/16"	.062	.080	.19	.074	.064
#6	UNF	.138	7IP	.081	.036	1/16"	.062	.080	.19	.074	.064
#8	UNC	.164	8IP	.094	.041	5/64"	.078	.090	.19	.087	.076
#10	UNC	.190	10IP	.111	.049	3/32"	.094	.100	.25	.102	.088
1/4"	UNC	.250	15IP	.132	.067	1/8"	.125	.125	.31	.132	.118
1/4"	UNF	.250	20IP	.155	.079	1/8"	.125	.125	.38	.132	.118
5/16"	UNC	.313	25IP	.200	.088	5/32"	.156	.156	.31	.172	.156
5/16"	UNF	.313	27IP	.200	.088	5/32"	.156	.156	.31	.172	.156
3/8"	UNC	.375	27IP	.221	.097	3/16"	.188	.188	.38	.212	.194
3/8"	UNF	.375	30IP	.221	.097	3/16"	.188	.188	.38	.212	.194
7/16"	UNC/UNF	.438	40IP	.266	.117	7/32"	.219	.219	.44	.291	.270
1/2"	UNC/UNF	.500	45IP	.312	.137	1/4"	.250	.250	.50		
5/8"	UNC/UNF	.625	55IP	.446	.202	5/16"	.312	.312	.63	.371	.340
3/4"	UNC	.750	60IP	.529	0.245	3/8"	.375	.375	.75		
7/8"	UNC	.875	70IP	.619	0.291	1/2"	.500	.500	.88		
1"	UNC	1.000	70IP	.619	0.291	9/16"	.562	.562	1.00		

Technical and Torque Data – Inch Sizes

Camcar® Hardened Ground Machine Dowel Pins

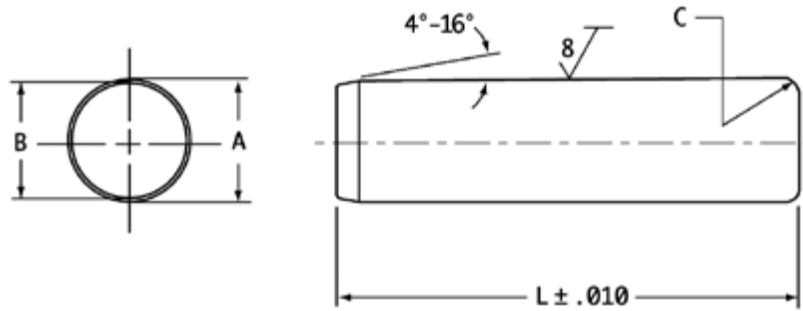

Dimensions of Hardened Ground Machined Dowel Pins

Nom Size or Pin Dia.		A Pin Diameter						B Point Diameter		C Crown Height or Radius	
		Standard Series Pins			Oversize Series Pins						
Nom.	In.	Basic	Max.	Min.	Basic	Max.	Min.	Max.	Min.	Max.	Min.
1/16	0.0625	0.0627	0.0628	0.0626	0.0635	0.0636	0.0634	0.058	0.048	0.020	0.008
3/32	0.0938	0.0940	0.0941	0.0939	0.0948	0.0949	0.0947	0.089	0.079	0.031	0.012
1/8	0.1250	0.1252	0.1253	0.1251	0.1260	0.1261	0.1259	0.120	0.110	0.041	0.016
3/16	0.1875	0.1877	0.1878	0.1876	0.1885	0.1886	0.1884	0.180	0.170	0.062	0.023
1/4	0.2500	0.2502	0.2503	0.2501	0.2510	0.2511	0.2509	0.240	0.230	0.083	0.031
5/16	0.3125	0.3127	0.3128	0.3126	0.3135	0.3136	0.3134	0.302	0.290	0.104	0.039
3/8	0.3750	0.3752	0.3753	0.3751	0.3760	0.3761	0.3759	0.365	0.350	0.125	0.047
7/16	0.4375	0.4377	0.4378	0.4376	0.4385	0.4386	0.4384	0.424	0.409	0.146	0.055
1/2	0.5000	0.5002	0.5003	0.5001	0.5010	0.5011	0.5009	0.486	0.471	0.167	0.063
5/8	0.6250	0.6252	0.6253	0.6251	0.6260	0.6261	0.6259	0.611	0.595	0.208	0.078
3/4	0.7500	0.7502	0.7503	0.7501	0.7510	0.7511	0.7509	0.735	0.715	0.250	0.094
7/8	0.8750	0.8752	0.8753	0.8751	0.8760	0.8761	0.8759	0.860	0.840	0.293	0.109
1	1.0000	1.0002	1.0003	1.0001	1.0010	1.0011	1.0009	0.980	0.960	0.333	0.125

Mechanical & Application Data

Nominal Pin Size	Suggested Hole Dia. for Standard Series Pins		Double Shear Load Lb.
	Max.	Min.	
1/16	0.0625	0.0620	800
5/64	0.0781	0.0776	1,240
3/32	0.0937	0.0932	1,80
1/8	0.1250	0.1245	3,200
5/32	0.1562	0.1557	5,000
3/16	0.1875	0.1870	7,200
1/4	0.2500	0.2495	12,800
5/16	0.3125	0.3120	20,000
3/8	0.3750	0.3745	28,700
7/16	0.4375	0.4370	39,100
1/2	0.5000	0.4995	51,000
5/8	0.6250	0.6245	79,800
3/4	0.7500	0.7495	114,000
7/8	0.8750	0.8745	156,000
1	1.0000	0.9995	204,000

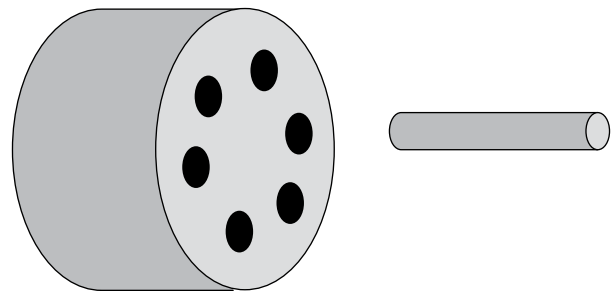

Hardened ground machine dowel pins are intended for applications where precise locating of mating parts is essential, such as, for doweling hardened tool and machine components or to serve as stops, guides and load bearing pins, etc., where strength shock or wear factors necessitate a hardened pin.

Technical and Torque Data – Metric Sizes

Camcar® Socket Head Cap Screws

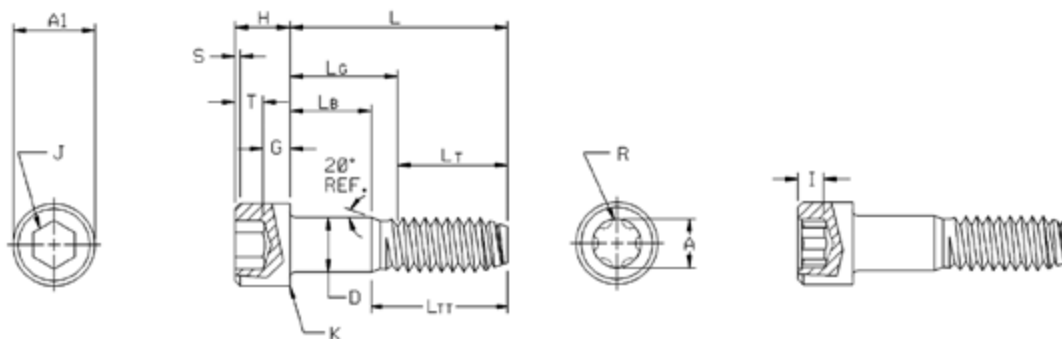

Dimensions of Hex and TORX PLUS® Metric Socket Head Cap Screws

Nominal Size x Thread Pitch	D Body Dia.		A1 Head Dia.		H Head Height		S Head Side Height Min.	R	A	I	J Hex Socket Size Nom.	T Key Engmt. Min.	G Wall Thick. Min.	Chamfer or Radius Max.
	Max.	Min.	Max.	Min.	Max.	Min.		TORX PLUS						
								Drive Size	Recess Dim. Ref.	Key Engmt. Min.				
M1.6 x 0.35	1.60	1.46	3.00	2.87	1.60	1.52	0.16				1.5	0.80	0.54	0.08
M2 x 0.4	2.00	1.86	3.80	3.65	2.00	1.91	0.20	6IP	1.75	0.77	1.5	1.00	0.68	0.08
M2.5 x 0.45	2.50	2.36	4.50	4.33	2.50	2.40	0.25	8IP	2.39	1.05	2.0	1.25	0.85	0.08
M3 x 0.5	3.00	2.86	5.50	5.32	3.00	2.89	0.30	10IP	2.82	1.24	2.5	1.50	1.02	0.13
M4 x 0.7	4.00	3.82	7.00	6.80	4.00	3.88	0.40	25IP	4.52	1.76	3.0	2.00	1.52	0.13
M5 x 0.8	5.00	4.82	8.50	8.27	5.00	4.86	0.50	27IP	5.08	2.24	4.0	2.50	1.90	0.13
M6 x 1	6.00	5.82	10.00	9.74	6.00	5.85	0.60	30IP	5.61	2.47	5.0	3.00	2.28	0.20
M8 x 1.25	8.00	7.78	13.00	12.70	8.00	7.83	0.80	45IP	7.92	3.48	6.0	4.00	3.20	0.20
M10 x 1.5	10.00	9.78	16.00	15.67	10.00	9.81	1.00	50IP	8.94	3.93	8.0	5.00	4.00	0.20
M12 x 1.75	12.00	11.73	18.00	17.63	12.00	11.79	1.20	55IP	11.33	5.15	10.0	6.00	4.80	0.25
M16 x 2	16.00	15.73	24.00	23.58	16.00	15.76	1.60	70IP	15.72	7.39	14.0	8.00	6.40	0.25
M20 x 2.5	20.00	19.67	30.00	29.53	20.00	19.73	2.00	90IP	20.19	9.67	17.0	10.00	8.00	0.40
M24 x 3	24.00	23.67	36.00	35.48	24.00	23.70	2.40	100IP	22.10	10.79	19.0	12.00	9.60	0.40

Mechanical and Application Data

Nominal Size x Thread Pitch	Tensile Strength Min.		Single Shear* Body Section		Suggested Seating Torque** Plain Finish	
	Kn	Lb	Kn	Lb	Nm	Lb-In
M3 x 0.5	6.14	1,380	4.9	1,095	2.6	23
M4 x 0.7	10.7	2,410	8.7	1,947	6.1	54
M5 x 0.8	17.3	3,890	13.5	3,043	12.39	109
M6 x 1	24.5	5,510	19.5	4,382	20.9	185
M8 x 1.25	44.6	10,030	34.6	7,791	50.8	450
M10 x 1.5	70.8	15,920	54.1	12,173	100.8	892
M12 x 1.75	103.0	23,150	78.0	17,530	175.9	1,554
M16 x 2	192.0	43,160	138.6	31,164	437.0	3,964
M20 x 2.5	299.0	67,220	217.0	48,695	851.0	7,536
M24 x 3	431.0	96,890	312.0	70,120	1,471.0	13,026

* Based on 100 ksi shear strength

** Seating torques calculated to induce 65,000 psi tensile stress with a "K" factor of 0.21.

Technical and Torque Data – Metric Sizes

Camcar® Button Head Cap Screws

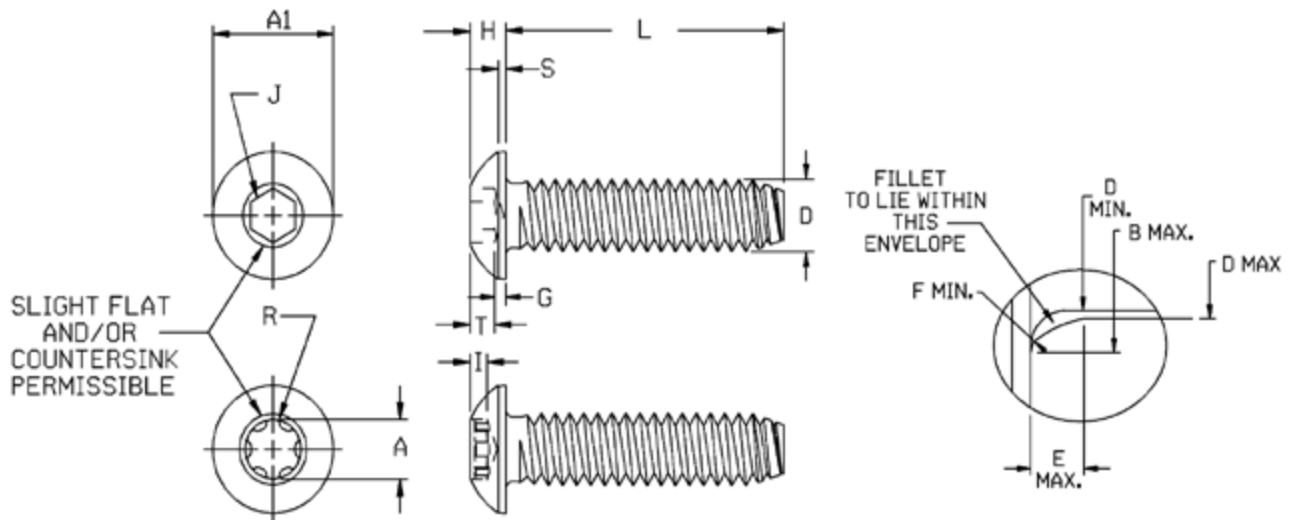

Dimensions of Hex and TORX PLUS® Metric Button Head Cap Screws

D Nom. Size x Thread Pitch	A1 Head Diameter		H Head Diameter		S Side Height Ref.	R	A	I	J Hex Socket Size Nom.	T Hex Key Eng. Min.	G Wall Thick- ness Min.	B Transition		E Underhead Juncture Max.	F Fillet Std. Radius Min.	L Max. Length Nom.
						TORX PLUS										
	Max.	Min.	Max.	Min.		Drive Size	Recess Dia. Ref.	Key Eng. Min.								
												Dia. Max.	Length Min.			
M3 x 0.5	5.70	5.40	1.65	1.43	0.38	8IP	2.39	0.81	2	1.04	0.20	3.6	3.2	0.51	0.10	12
M4 x 0.7	7.60	7.24	2.20	1.95	0.38	15IP	3.35	1.14	2.5	1.30	0.30	4.7	4.4	0.60	0.20	20
M5 x 0.8	9.50	9.14	2.75	2.50	0.50	25IP	4.52	1.54	3	1.56	0.38	5.7	5.4	0.60	0.20	30
M6 x 1	10.50	10.07	3.30	3.00	0.80	27IP	5.08	1.73	4	2.08	0.74	6.8	6.5	0.68	0.25	30
M8 x 1.25	14.00	13.57	4.40	4.05	0.80	40IP	6.76	2.30	5	2.60	1.05	9.2	8.8	1.02	0.40	40
M10 x 1.5	17.50	17.07	5.50	5.20	0.80	45IP	7.92	2.69	6	3.12	1.45	11.2	10.8	1.02	0.40	40
M12 x 1.75	21.00	20.48	6.60	6.24	0.80	55IP	11.33	4.02	8	4.16	1.63	14.2	13.2	1.87	0.60	60

Mechanical and Application Data

Nominal Size x Thread Pitch	Tensile Strength Min.		Single Shear* Body Section		Suggested Seating Torque** Plain Finish	
	Kn	Lb	Kn	Lb	Nm	Lb-In
M3 x 0.5	4.93	1,108.3	4.9	1,095	1.4	12.5
M4 x 0.7	8.60	1,933.4	8.7	1,947	3.3	29.0
M5 x 0.8	13.90	3,124.8	13.5	3,043	6.7	59.0
M6 x 1	19.70	4,428.7	19.5	4,382	11.3	100.0
M8 x 1.25	35.90	8,070.6	34.6	7,781	27.5	244.0
M10 x 1.5	56.80	12,769.0	54.1	12,173	54.6	483.0
M12 x 1.75	82.60	18,569.0	78.0	17,530	95.1	842.0

* Based on 100 ksi shear strength

** Seating torques calculated to induce 65,000 psi tensile stress with a "K" factor of 0.21.

Technical and Torque Data – Metric Sizes

Camcar® Flat Countersunk Head Cap Screws

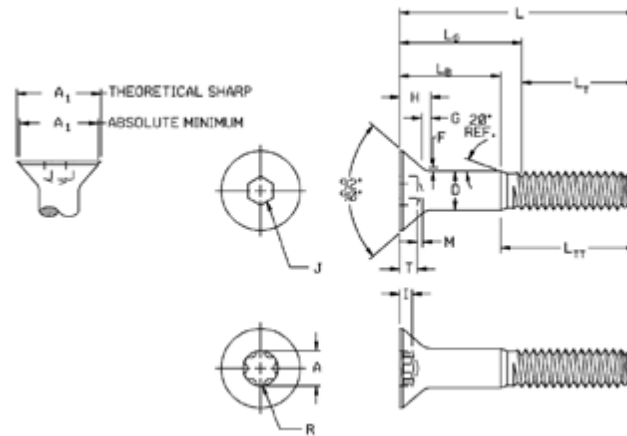

Dimensions of Hex and TORX PLUS® Metric Flat Countersunk Head Cap Screws

Nominal Size x Thread Pitch	D Body Diameter		A1 Head Dia.		H Head Height		R	A	I	J Hex Socket Size Min.	T Hex Key Engmt. Min.	G Wall Thickness Max.	F Fillet Extension Above D Max.	M Drill Allow.
	TORX PLUS													
	Max.	Min.	Theo- retical Sharp	Absol. Min.	Ref.	Flush Tol.	Drive Size Ref.	Recess Dim. Min.	Key Engmt. Nom.					
M3 x 0.5	3.00	2.86	6.72	5.35	1.86	0.30	10IP	2.82	0.96	2.0	1.1	0.25	0.25	0.3
M3 x 0.5	3.00	2.86	6.72	5.35	1.86	0.30	10IP	2.82	0.96	2.0	1.1	0.25	0.25	0.3
M4 x 0.7	4.00	3.82	8.96	7.80	2.48	0.30	20IP	3.94	1.34	2.5	1.5	0.45	0.35	0.4
M5 x 0.8	5.00	4.82	11.20	9.75	3.10	0.35	25IP	4.52	1.54	3.0	1.9	0.66	0.40	0.5
M6 x 1	6.00	5.82	13.44	11.70	3.72	0.35	30IP	5.61	1.91	4.0	2.2	0.70	0.50	0.6
M8 x 1.25	8.00	7.78	17.92	15.60	4.96	0.40	40IP	6.76	2.30	5.0	3.0	1.16	0.60	0.8
M10 x 1.5	10.00	9.78	22.40	19.50	6.20	0.50	50IP	8.94	3.04	6.0	3.6	1.62	0.80	0.9

Mechanical and Application Data

Nominal Size x Thread Pitch	Tensile Strength Min.		Single Shear* Body Section		Suggested Seating Torque** Plain Finish	
	Kn	Lb	Kn	Lb	Nm	Lb-In
M3 x 0.5	4.93	1,108.3	4.9	1,095	1.7	15.5
M4 x 0.7	8.60	1,933.4	8.7	1,947	4.1	36.0
M5 x 0.8	13.90	3,124.8	13.5	3,043	8.2	73.0
M6 x 1	19.70	4,428.7	19.5	4,382	14.0	124.0
M8 x 1.25	35.90	8,070.6	34.6	7,791	34.1	302.0
M10 x 1.5	56.80	12,769.0	54.1	12,173	67.5	598.0
M12 x 1.75	82.60	18,569.0	78.0	17,530	117.0	1,042.0
M16 x 2	155.00	34,845.0	138.0	31,164	293.0	2,591.0
M20 x 2.5	240.00	53,954.0	217.0	48,695	571.0	5,054.0

* Based on 100 ksi shear strength

** Seating torques calculated to induce 65,000 psi tensile stress with a "K" factor of 0.21.

WARRANTY

Infastech makes no warranty, express or implied, except that goods sold by description, sample or model shall substantially conform to the description, sample or model, and in such case, the responsibility of Infastech shall be limited to the replacement of nonconforming goods returned to Infastech within one month after delivery to Buyer (f.o.b. at point of delivery to carrier), provided that such goods have been solely used for the purpose for which manufactured. All replaced goods are to be returned to Infastech after receiving authorization from Infastech. This warranty does not apply when any physical or chemical change in the form of the product is made by the Buyer or any other party. There are no warranties which extend beyond the description stated herein. Infastech shall not otherwise be liable for any costs or expenses incurred in the replacement of any defective or nonconforming products and in no event shall Infastech be liable for incidental or consequential damages. The foregoing warranty and such other warranties made by Infastech, as are expressly stated herein, are specifically in lieu of any other warranties, express or implied, including the implied warranties of merchantability and fitness for a particular purpose.

The selection of this product for a particular application or use is the responsibility of the customer. The applications engineers at Decorah Operations are available to assist customers in selecting the appropriate product for a particular application or use. All warranties are void if the product is plated or modified in any manner by any person other than Infastech.

Infastech has strived for total accuracy throughout this catalog. However, Infastech shall not be liable or responsible for any typographical errors that may occur. If any questions arise as to the accuracy within this catalog, please contact the applications engineers at Decorah Operations.



Decorah Operations

1304 Kerr Drive • Decorah, IA 52101-2494

voice: 563.382.4216

fax: 563.387.3326

www.infastech.com

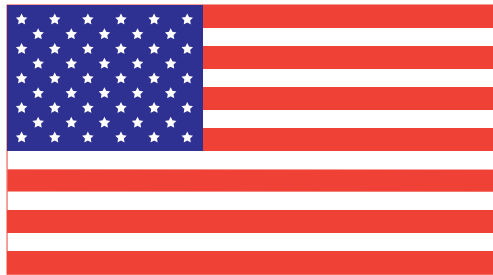

Made in the U.S.A.



Decorah Operations

1304 Kerr Drive • Decorah, IA 52101-2494

1-800-544-6117

www.infastech.com



Avdel

iForm

Elco®, iForm™ and Infastech™ are trademarks of Infastech Intellectual Properties, LLC.

Avdel® is a registered trademark of Avdel UK Ltd. Camcar®, TORX PLUS®, TORX® and TORXalign® are registered trademarks of Acument Intellectual Properties, LLC.

©2011 Infastech Intellectual Properties, LLC. All rights reserved.