

Job Title	Ref	Double C6x10.5 -	Chd
	By	Back to Back @ 8'-6"	
Client	File	o.c.	

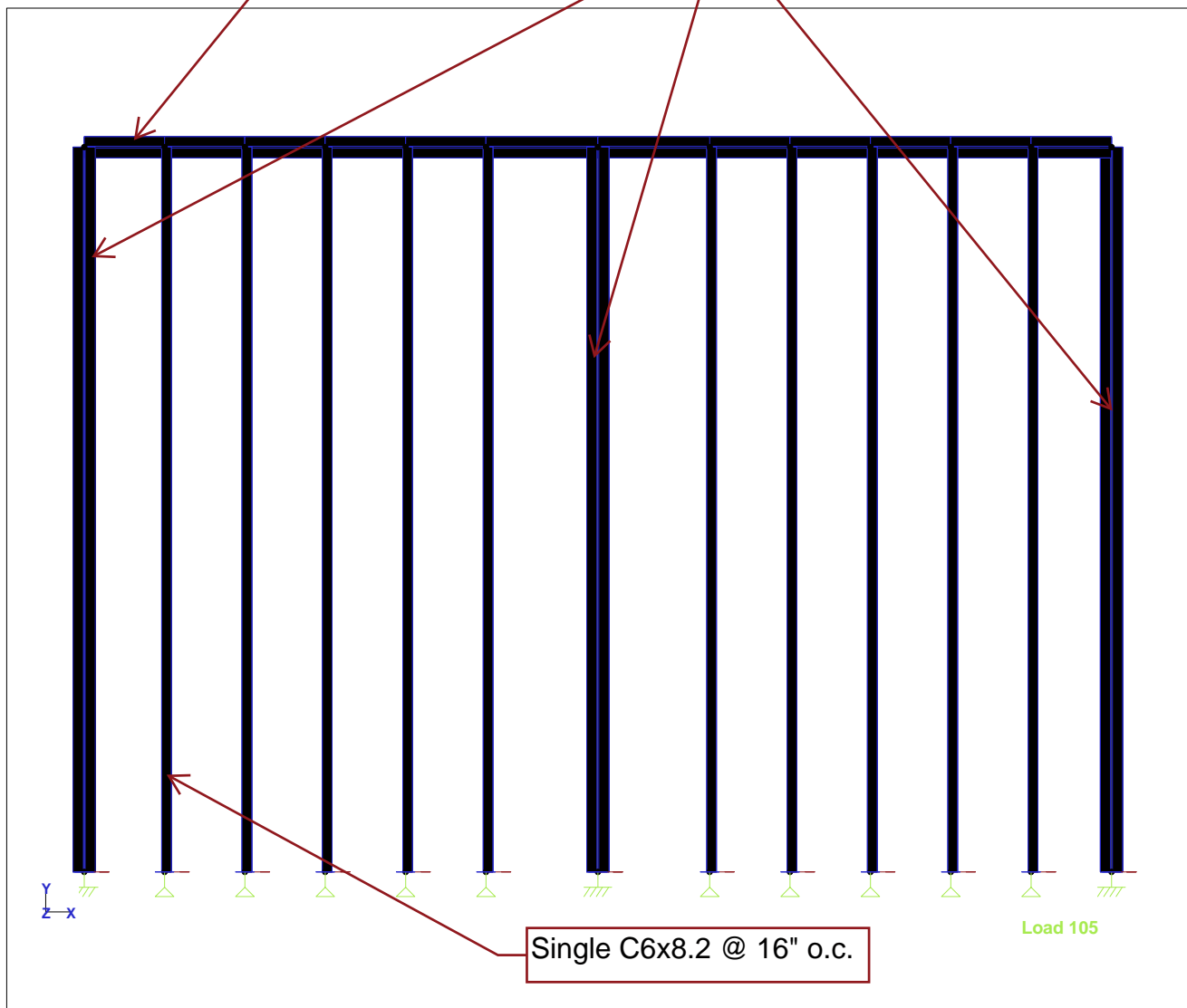

Whole Structure

$\frac{3}{4}" \phi$ HIT-HY 200 + HAS-E $\frac{1}{2}$
w/ 3.5in effective embedment
depth (TYP)

9"

$\frac{3}{4}"$ THK

9"

C6x10x5

C6x10.5

1'-0"

1'-0"

$\frac{3}{16}"$
(TYP)

