



LEARJET 24
ILLUSTRATED PARTS CATALOG

LIST OF EFFECTIVE PAGES

CHAPTER SECTION FIGURE	PAGE	DATE
57 EFF	1	OCT 10/00 R
57 CONT	1	OCT 10/00 R
57-02-02	0	OCT 10/00 R
57-02-02	1	OCT 10/00 R
57-02-02	2	OCT 10/00 R
57-02-02	3	OCT 10/00 R
57-02-02	4	OCT 10/00 R
57-02-02	5	OCT 10/00 R
57-02-02	6	OCT 10/00 R
57-20-10	0	DEC 23/99
57-20-10	1	DEC 23/99
57-20-20	0	DEC 23/99
57-20-20	1	DEC 23/99
57-20-20	2	DEC 23/99
57-20-20	3	DEC 23/99
57-30-10	0	DEC 23/99
57-30-10	1	DEC 23/99
57-30-10	2	DEC 23/99
57-30-10	3	DEC 23/99
57-41-05	0	DEC 23/99
57-41-05	1	DEC 23/99
57-41-05	2	DEC 23/99
57-42-10	0	DEC 23/99
57-42-10	1	DEC 23/99
57-42-10	2	DEC 23/99
57-42-10	3	DEC 23/99
57-42-10	4	DEC 23/99
57-42-10	5	DEC 23/99
57-42-10	6	DEC 23/99
57-42-10	7	DEC 23/99
57-43-05	0	DEC 23/99
57-43-05	1	DEC 23/99
57-43-05	2	DEC 23/99
57-44-05	0	OCT 10/00 R
57-44-05	1	OCT 10/00 R
57-44-05	2	OCT 10/00 R
57-45-05	0	DEC 23/99
57-45-05	1	DEC 23/99
57-46-05	0	DEC 23/99
57-46-05	1	DEC 23/99
57-46-05	2	DEC 23/99

CHAPTER SECTION FIGURE	PAGE	DATE
------------------------------	------	------

CHAPTER SECTION FIGURE	PAGE	DATE
------------------------------	------	------

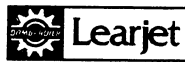

LEARJET 24
ILLUSTRATED PARTS CATALOG

CHAPTER 57

TABLE OF CONTENTS

C S
H E F
A C I
P T G

SUBJECT & EFFECTIVITY

57	WINGS
57-01	GENERAL
57-02-02	WING INSTALLATION 24-100 & SUBQ
57-20	AUXILIARY STRUCTURE
57-20-10	LEADING EDGE INSTL-WING LH & RH 24-100 THRU 328 EXCEPT A/C MOD BY A 2484038 KIT PER AAK76-4 INSTR
57-20-20	LEADING EDGE INSTL-WING LH & RH 24-329 & SUBQ & PREV A/C MOD BY A 2484038 KIT PER AAK76-4 INSTR
57-30	PLATES/SKIN
57-30-10	ACCESS COVERS INSTL-WING LH & RH 24-100 & SUBQ
57-40	ATTACH FITTINGS
57-41-05	FITTING INSTL-FUSELAGE ATTACH WING 24-100 & SUBQ
57-42-10	BRACKETS INSTL-FLAP CONTROLS WING LH & RH 24-100 & SUBQ
57-43-05	BRACKETS INSTL-SPOILER HINGE & CONTROLS SPRT WING LH & RH 24-100 & SUBQ
57-44-05	BRACKETS INSTL-AILERON HINGE & CONTROLS SPRT WING LH & RH 24-100 & SUBQ
57-45-05	FITTINGS INSTL-TIP TANK LH & RH 24-100 & SUBQ
57-46-05	SUPPORTS & BRACKETS INSTL-LANDING GEAR WING LH & RH 24-100 & SUBQ

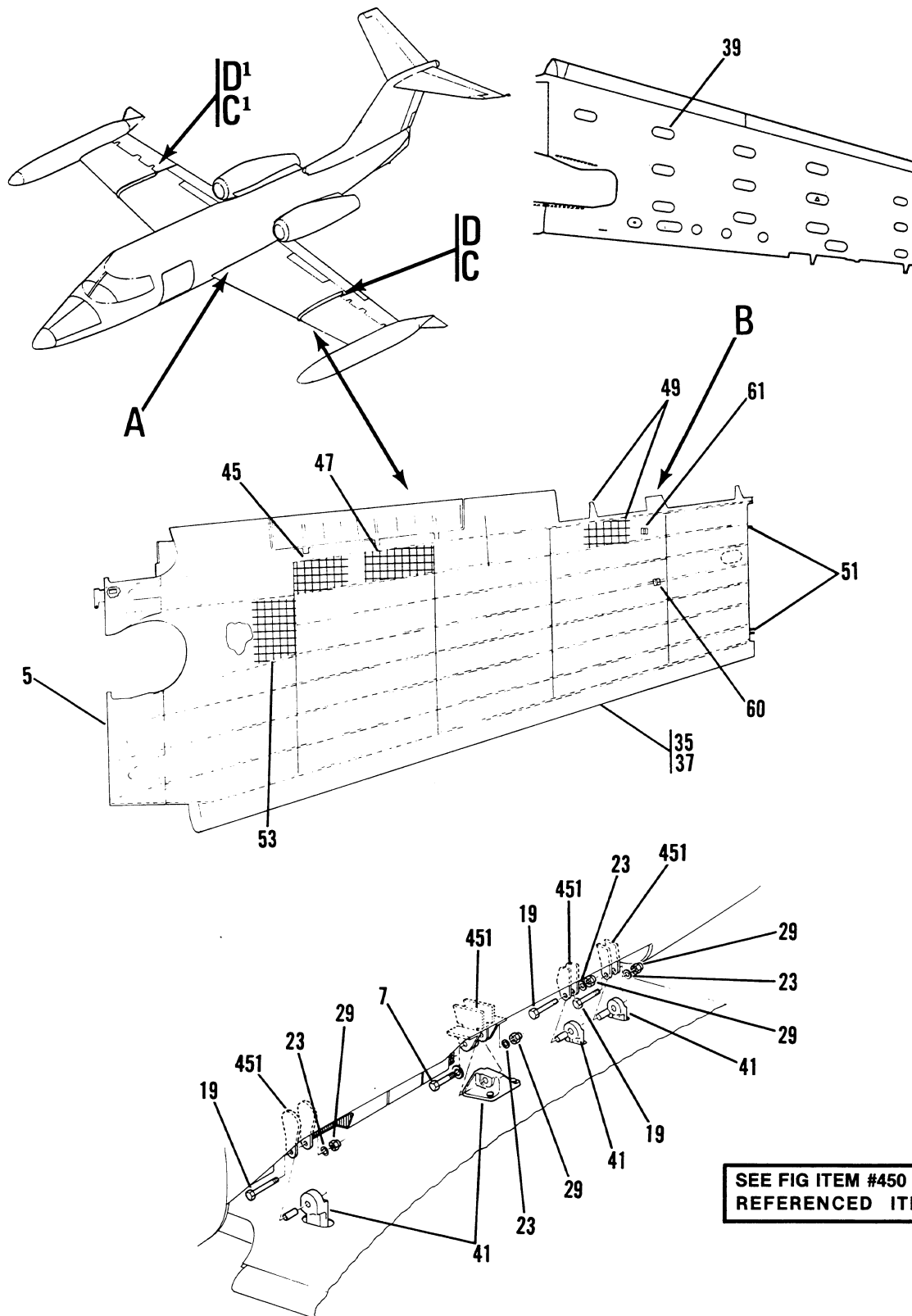

Detail A

4-28C
4-26C-1
A4-27B-1



LEARJET 24
ILLUSTRATED PARTS CATALOG

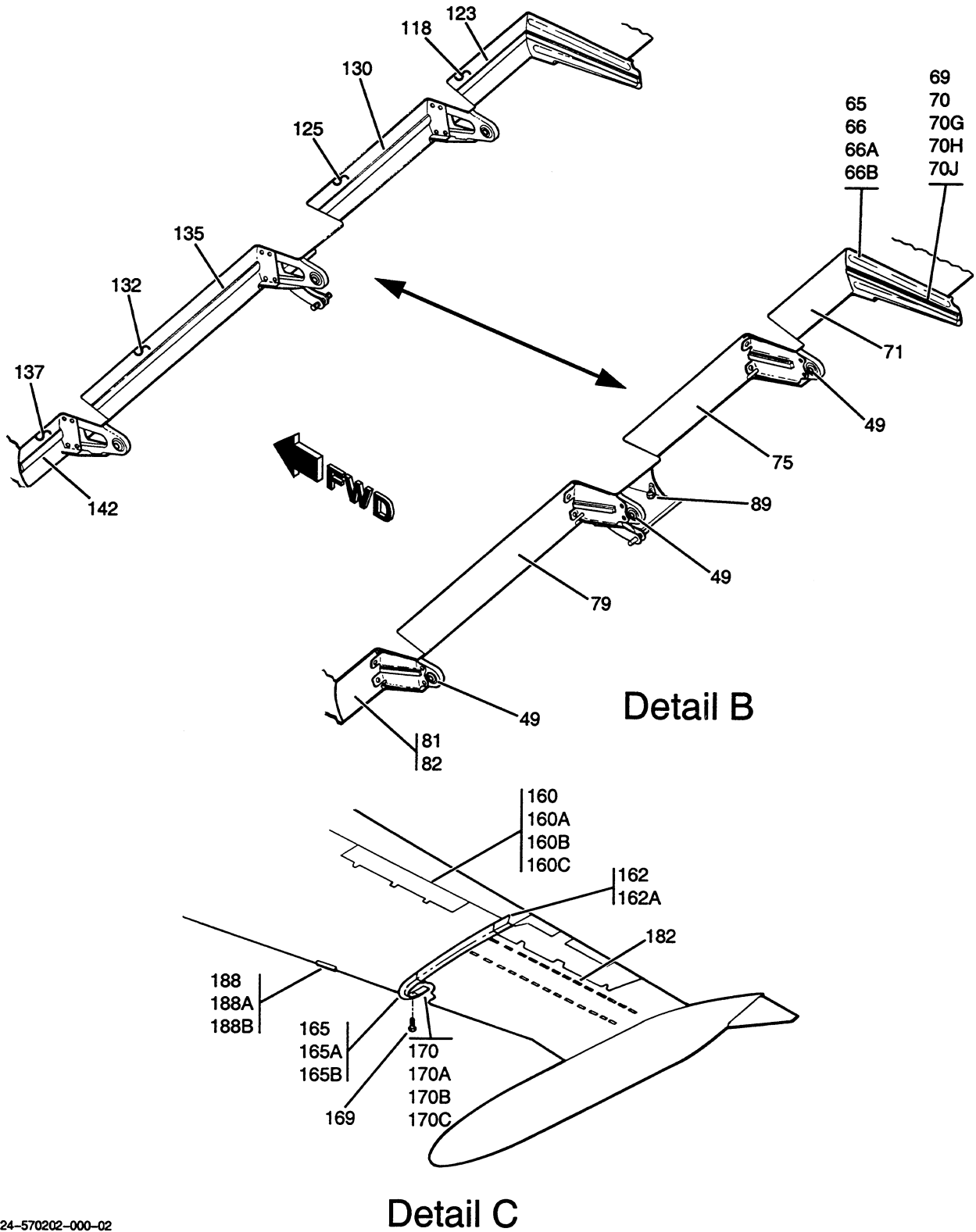

P24-570202-000-02



LEARJET 24
ILLUSTRATED PARTS CATALOG

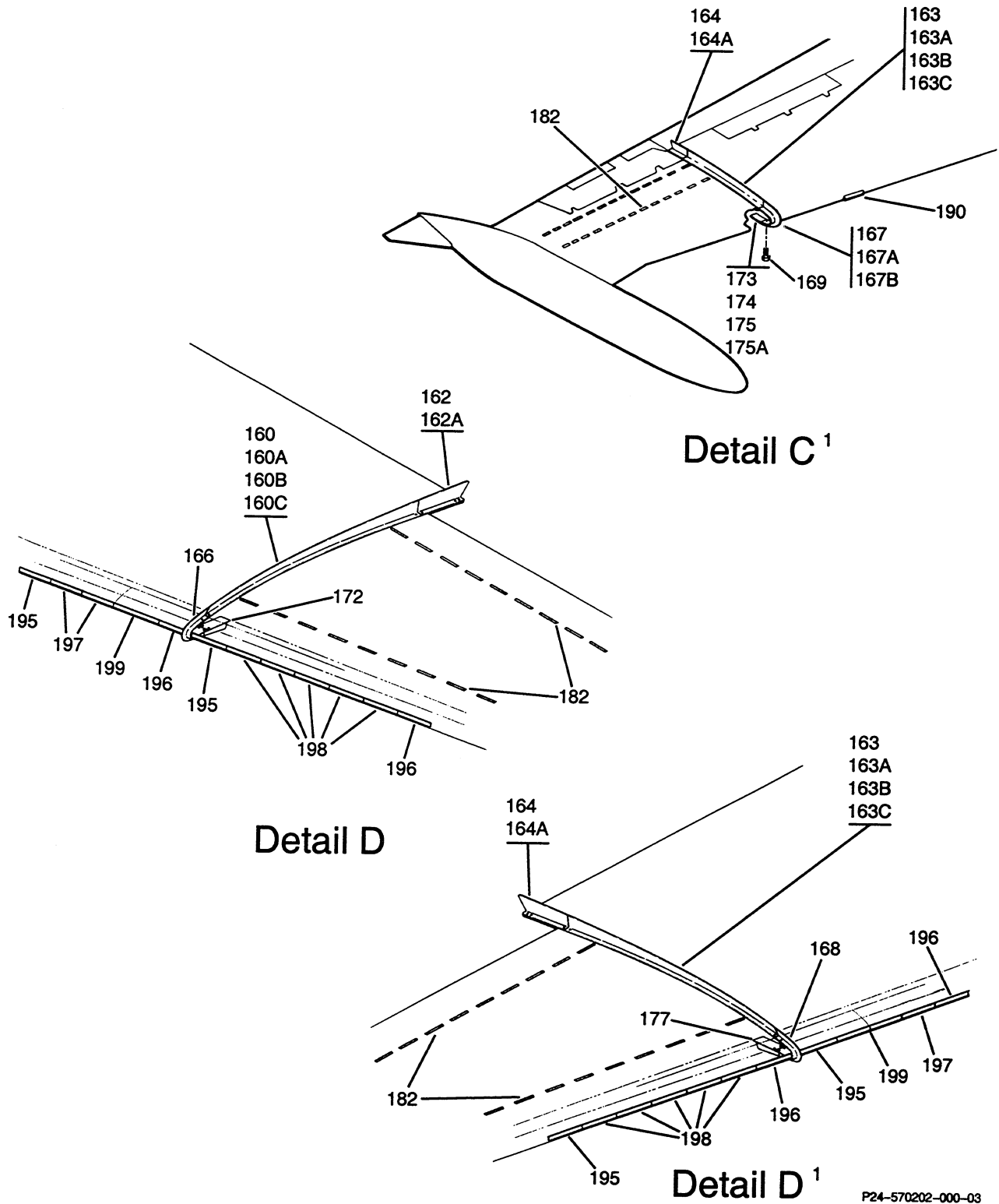

P24-570202-000-03

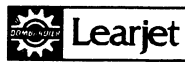

LEARJET 24
ILLUSTRATED PARTS CATALOG

FIG ITEM	PART NUMBER	SYMBOL	NOMENCLATURE								EFF CODE	UNITS PER ASSY
			1	2	3	4	5	6	7	8		
			VENDOR	
02 - 1			WING INSTALLATION - - - - -								A	1
5			. STRUCTURE ASSY-WING - - - - -								A	1
7	AN7-22A - - - - -	A	. BOLT - - - - -								A	2
19	AN7-17A - - - - -	A	. BOLT - - - - -								A	6
23	AN960-716L - - - - -	A	. WASHER - - - - -								A	6
29	MS20365-720 - - - - -	A	. NUT - - - - -								A	8
35	RF57-20-10 FOR DET		. . LEADING EDGE INSTL-WING LH & RH - - - - -								B	1
37	RF57-20-20 FOR DET		. . LEADING EDGE INSTL-WING LH & RH - - - - -								C	1
39	RF57-30-10 FOR DET		. . ACCESS COVERS INSTL-WING LH & RH - - - - -								A	1
41	RF57-41-05 FOR DET		. . FITTINGS INSTL-FUSELAGE ATTACH WING - - - - -								A	1
45	RF57-42-10 FOR DET		. . BRACKETS INSTL-FLAP CONTROLS WING LH & RH - - - - -								E	1
47	RF57-43-05 FOR DET		. . BRACKETS INSTL-SPOILER HINGE & CONTROLS SUPPORT WING LH & RH - - - - -								A	1
49	RF57-44-05 FOR DET		. . BRACKETS INSTL-AILERON HINGE & CONTROLS SUPPORT WING LH & RH - - - - -								A	1
51	RF57-45-05 FOR DET		. . FITTINGS INSTL-TIP TANK LH & RH - - - - -								A	1
53	RF57-46-05 FOR DET		. . SUPPORTS & BRACKETS INSTL-LANDING GEAR WING LH & RH - - - - -								A	1
60	2322555-3 - - - - -		. . BLADE-VORTEX GENERATOR FWD - - - - -								AC	AR
61	2322571-3 - - - - -		. . BLADE-VORTEX GENERATOR AFT - - - - -								F	AR
65	2322510-73 - - - - -		. . RIB ASSY-AILERON SLOT CLOSING LH FOR SPARES USE 2322510-249 - - - - -								Z	1
66	2322510-249 - - - - -		. . RIB ASSY-AILERON SLOT CLOSING LH WHEN EXHTD USE 2322510-263 - - - - -								Z	1
66A	2322510-263 - - - - -		. . RIB ASSY-AILERON SLOT CLOSING LH WHEN EXHTD USE 2322510-275 - - - - -								Z	1
66B	2322510-275 - - - - -		. . RIB ASSY-AILERON SLOT CLOSING LH - - - - -								A	1
- 67	2322510-74 - - - - -		. . RIB ASSY-AILERON SLOT CLOSING RH FOR SPARES USE 2322510-250 - - - - -								Z	1
- 68	2322510-250 - - - - -		. . RIB ASSY-AILERON SLOT CLOSING RH WHEN EXHTD USE 2322510-264 - - - - -								Z	1
- 68A	2322510-264 - - - - -		. . RIB ASSY-AILERON SLOT CLOSING RH WHEN EXHTD USE 2322510-276 - - - - -								Z	1
- 68B	2322510-276 - - - - -		. . RIB ASSY-AILERON SLOT CLOSING RH - - - - -								A	1
69	2322510-77 - - - - -		. . . SEAL-GAP CLOSURE - - - - -								G	1
70	2322510-268 - - - - -		. . . SEAL-GAP CLOSURE - - - - -								T	1
70G	2322510-92 - - - - -		. . . CHANNEL-SEAL RETAINER - - - - -								G	1
70H	2322510-267 - - - - -		. . . CHANNEL-SEAL RETAINER - - - - -								X	1
70J	2322510-274 - - - - -		. . . CHANNEL-SEAL RETAINER - - - - -								W	1
71	2322550-5 - - - - -		. . PANEL-GAP CLOSURE LH - - - - -								M	1
- 73	2322550-26 - - - - -		. . PANEL-GAP CLOSURE RH - - - - -								M	1
75	2322550-25 - - - - -		. . PANEL-GAP CLOSURE LH - - - - -								M	1
- 77	2322550-6 - - - - -		. . PANEL-GAP CLOSURE RH - - - - -								M	1
79	2322550-7 - - - - -		. . PANEL-GAP CLOSURE LH & RH - - - - -								M	2
81	2322550-19 - - - - -		. . PANEL-GAP CLOSURE LH - - - - -								H	1
82	2322550-33 - - - - -		. . PANEL-GAP CLOSURE LH - - - - -								J	1
- 84	2322550-20 - - - - -		. . PANEL-GAP CLOSURE RH - - - - -								H	1
- 85	2322550-34 - - - - -		. . PANEL-GAP CLOSURE RH - - - - -								J	1
89	2322550-21 - - - - -		. . RIB ASSY-CLOSURE LH - - - - -								A	1
- 91	2322550-22 - - - - -		. . RIB ASSY-CLOSURE RH - - - - -								A	1
-ITEM NOT ILLUSTRATED			A - - - ATTACHING PARTS									



LEARJET 24
ILLUSTRATED PARTS CATALOG

FIG ITEM	PART NUMBER	SYMBOL	NOMENCLATURE										EFF CODE	UNITS PER ASSY
			1	2	3	4	5	6	7	8	VENDOR			
					
O2 - 93	AN509-10R8	- - - -	A	.	.	SCREW	-	-	-	-	-	-	A	4
118	2322550-53	- - - -	.	.	.	PANEL ASSY-GAP CLOSURE	LH	-	-	-	-	-	L	1
-120	2322550-54	- - - -	.	.	.	PANEL ASSY-GAP CLOSURE	RH	-	-	-	-	-	L	1
123	2322550-63	- - - -	.	.	.	SEAL-GAP CLOSURE	-	-	-	-	-	-	N	1
125	2322550-55	- - - -	.	.	.	PANEL ASSY-GAP CLOSURE	LH	-	-	-	-	-	L	1
-127	2322550-56	- - - -	.	.	.	PANEL ASSY-GAP CLOSURE	RH	-	-	-	-	-	L	1
130	2322550-64	- - - -	.	.	.	SEAL-GAP CLOSURE	-	-	-	-	-	-	P	1
132	2322550-57	- - - -	.	.	.	PANEL ASSY-GAP CLOSURE	LH &							
						RH	-	-	-	-	-	-	L	2
135	2322550-65	- - - -	.	.	.	SEAL-GAP CLOSURE	-	-	-	-	-	-	Q	1
137	2322550-59	- - - -	.	.	.	PANEL ASSY-GAP CLOSURE	LH	-	-	-	-	-	L	1
-139	2322550-60	- - - -	.	.	.	PANEL ASSY-GAP CLOSURE	RH	-	-	-	-	-	L	1
142	2322550-66	- - - -	.	.	.	SEAL-GAP CLOSURE	-	-	-	-	-	-	R	1
160	2422086-3	- - - -	.	.	.	FENCE ASSY-STALL UPPER LH								
						FOR SPARES USE 2422086-27								
						& 2422086-29	-	-	-	-	-	-	Z	1
160A	2422086-4042-1	- -	.	.	.	FENCE ASSY-STALL UPPER LH								
						FOR SPARES USE 2422086-27	-	-	-				Z	1
160B	2422086-27	- - - -	.	.	.	FENCE ASSY-STALL UPPER LH								
						WHEN EXHTD USE 2422086-35	-	-	-				Z	1
160C	2422086-35	- - - -	.	.	.	FENCE ASSY-STALL UPPER LH	-	-	-				AA	1
162	2422086-4042-3	- -	.	.	.	FENCE ASSY-STALL UPPER AFT								
						LH FOR SPARES USE								
						2422086-29	-	-	-	-	-	-	Z	1
162A	2422086-29	- - - -	.	.	.	FENCE ASSY-STALL UPPER AFT								
						LH	-	-	-	-	-	-	AA	1
163	2422086-4	- - - -	.	.	.	FENCE ASSY-STALL UPPER RH								
						FOR SPARES USE 2422086-28								
						& 2422086-30	-	-	-	-	-	-	Z	1
163A	2422086-4042-2	- -	.	.	.	FENCE ASSY-STALL UPPER RH								
						FOR SPARES USE 2422086-28	-	-	-				Z	1
163B	2422086-28	- - - -	.	.	.	FENCE ASSY-STALL UPPER RH								
						WHEN EXHTD USE 2422086-36	-	-	-				Z	1
163C	2422086-36	- - - -	.	.	.	FENCE ASSY-STALL UPPER RH	-	-	-				AA	1
164	2422086-4042-4	- -	.	.	.	FENCE ASSY-STALL UPPER AFT								
						RH FOR SPARES USE								
						2422086-30	-	-	-	-	-	-	Z	1
164A	2422086-30	- - - -	.	.	.	FENCE ASSY-STALL UPPER AFT								
						RH	-	-	-	-	-	-	AA	1
165	2422086-5	- - - -	.	.	.	FENCE ASSY-STALL LEADING								
						EDGE LH								
						WHEN EXHTD USE 2422086-31	-	-	-				Z	1
165A	2422086-31	- - - -	.	.	.	FENCE ASSY-STALL LEADING								
						EDGE LH								
						WHEN EXHTD USE 2422086-37	-	-	-				Z	1
165B	2422086-37	- - - -	.	.	.	FENCE ASSY-STALL LEADING								
						EDGE LH	-	-	-	-	-	-	L	1
166	2384011-1	- - - -	.	.	.	FENCE ASSY-STALL LEADING								
						EDGE LH	-	-	-	-	-	-	AB	1
167	2422086-6	- - - -	.	.	.	FENCE ASSY-STALL LEADING								
						EDGE RH								
						WHEN EXHTD USE 2422086-32	-	-	-				Z	1
167A	2422086-32	- - - -	.	.	.	FENCE ASSY-STALL LEADING								
						EDGE RH								
						WHEN EXHTD USE 2422086-38	-	-	-				Z	1
167B	2422086-38	- - - -	.	.	.	FENCE ASSY-STALL LEADING								
						EDGE RH	-	-	-	-	-	-	L	1
168	2384011-2	- - - -	.	.	.	FENCE ASSY-STALL LEADING								
						EDGE RH	-	-	-	-	-	-	AB	1
169	MS24694C5	- - - -	A	.	.	SCREW	-	-	-	-	-	-	L	4
169D	2384011-2	- - - -	.	.	.	FENCE ASSY-STALL LEADING								
						EDGE RH	-	-	-	-	-	-	AB	1
170	2422086-7	- - - -	.	.	.	FENCE ASSY-STALL LOWER LH								
						WHEN EXHTD USE 2422086-23	-	-	-				Z	1
170A	2422086-19	- - - -	.	.	.	FENCE ASSY-STALL LOWER LH								
						ALT FOR 2422086-7								
						WHEN EXHTD USE 2422086-23	-	-	-				Z	1
-ITEM NOT ILLUSTRATED			A - - - ATTACHING PARTS											

-ITEM NOT ILLUSTRATED

A - - - ATTACHING PARTS



LEARJET 24
ILLUSTRATED PARTS CATALOG

FIG ITEM	PART NUMBER	SYMBOL	NOMENCLATURE								EFF CODE	UNITS PER ASSY
			1	2	3	4	5	6	7	8		
				
			VENDOR									
O2 170B	2422086-23 - - - -		.	.	FENCE ASSY-STALL	LOWER LH						
					WHEN EXHTD USE 2422086-33	- - -					Z	1
170C	2422086-33 - - - -		.	.	FENCE ASSY-STALL	LOWER LH	- - -				L	1
172	2384011-11 - - - -		.	.	FENCE ASSY-STALL	LOWER LH	- - -				AB	1
173	2422086-8 - - - -		.	.	FENCE ASSY-STALL	LOWER RH						
					WHEN EXHTD USE 2422086-24	- - -					Z	1
174	2422086-20 - - - -		.	.	FENCE ASSY-STALL	LOWER RH						
					ALT FOR 2422086-8							
					WHEN EXHTD USE 2422086-24	- - -					Z	1
175	2422086-24 - - - -		.	.	FENCE ASSY-STALL	LOWER RH						
					WHEN EXHTD USE 2422086-34	- - -					Z	1
175A	2422086-34 - - - -		.	.	FENCE ASSY-STALL	LOWER RH	- - -				L	1
177	2384011-12 - - - -		.	.	FENCE ASSY-STALL	LOWER RH	- - -				AB	1
182	2422088-1 - - - -		.	.	ENERGIZER-BOUNDARY LAYER	- - - -					L	36
186	2422089-11 - - - -		.	.	STRIP-STALL	LH	- - - -				L	1
190	2422089-12 - - - -		.	.	STRIP-STALL	RH	- - - -				L	1
195	2384012-11 - - - -		.	.	STRIP-STALL	LH & RH	- - - -				AB	4
196	2384012-12 - - - -		.	.	STRIP-STALL	LH & RH	- - - -				AB	4
197	2384012-13 - - - -		.	.	STRIP-STALL	LH & RH	- - - -				AB	4
198	2384012-14 - - - -		.	.	STRIP-STALL	LH & RH	- - - -				AB	10
199	2384012-15 - - - -		.	.	STRIP-STALL	LH & RH	- - - -				AB	2
-450			.	.	REFERENCED ITEMS							
451	RF53-40 FOR NHA - -		.	.	ATTACH FITTINGS INSTL							
					FUSELAGE	- - - -					Y	RF
		EFF CODES			INTERPRETATION							
		A			24-100 & SUBQ							
		B			24-100 THRU 328 EXCEPT A/C MOD BY							
					A 2484038 KIT PER AAK76-4 INSTR							
		C			24-329 & SUBQ & PREV A/C MOD BY A							
					2484038 KIT PER AAK76-4 INSTR							
		E			24-100 & SUBQ							
		F			24-100 THRU 357 EXCEPT A/C MOD BY							
					A 2484080 KIT PER AAK79-10 OR							
					AMK83-5 INSTRUCTIONS OR A							
					2384013 KIT PER AAK82-8 OR							
					AMK83-4 INSTRUCTIONS							
		G			PART OF FIG ITEM #65 & 66 LH & 67							
					& 68 RH RIB ASSYS							
		H			24-100 THRU 217, 219 THRU 229							
					EXCEPT A/C MOD BY A 2484080 KIT							
					PER AAK79-10 OR AMK83-5 INSTR							
		J			24-218, 230 THRU 357 EXCEPT A/C							
					MOD BY A 2484080 KIT PER							
					AAK79-10 OR AMK83-5 INSTR							
		L			24-358 & SUBQ & PREV A/C MOD BY A							
					2484080 KIT PER AAK79-10 OR							
					AMK83-5 INSTRUCTIONS OR A							
					2384013 KIT PER AAK82-8 OR							
					AMK83-4 INSTRUCTIONS							
		M			24-100 THRU 357 EXCEPT A/C MOD BY							
					A 2484080 KIT PER AAK79-10 OR							
					AMK83-5 INSTRUCTIONS							
		N			PART OF FIG ITEM #118 LH & 120 RH							
					PANEL ASSYS							
		P			PART OF FIG ITEM #125 LH & 127 RH							
					PANEL ASSYS							
		Q			PART OF FIG ITEM #132 LH & RH							
					PANEL ASSYS							
		R			PART OF FIG ITEM #137 LH & 139 RH							
					PANEL ASSYS							
		T			PART OF FIG ITEM #66A & SUBQ LH &							
					#68A & SUBQ RH RIB ASSYS							
		W			PART OF FIG ITEM #66B & SUBQ LH &							
					#68B & SUBQ RH RIB ASSYS							
		X			PART OF FIG ITEM #66A LH & #68A							
-ITEM NOT ILLUSTRATED			A - - - ATTACHING PARTS									



LEARJET 24
ILLUSTRATED PARTS CATALOG

FIG ITEM	PART NUMBER	SYMBOL	NOMENCLATURE								EFF CODE	UNITS PER ASSY
			1	2	3	4	5	6	7	8		
			VENDOR	
02			RH RIB ASSYS									
		Y	SEE TABLE OF CONTENTS OF REF									
			CHAPTER & SECTION FOR									
			APPLICABLE NHA FIGURE									
		Z	SUPERSEDED PART INACTIVE SPARE									
	AA		24-358 & SUBQ & PREV A/C MOD BY A									
			2484080 KIT PER AAK79-10 OR									
			AMK83-5 INSTRUCTIONS OR A									
			2384013 KIT PER AAK82-8 OR									
			AMK83-4 INSTRUCTIONS									
	AB		24-100 THRU 328 WHEN MOD BY A									
			2384013 KIT PER AAK82-8 OR									
			AMK83-4 INSTRUCTIONS									
	AC		24-100 THRU 357 EXCEPT A/C MOD BY									
			A 2484080 KIT PER AAK79-10 OR									
			AMK83-5 INSTRUCTIONS OR A									
			2384013 KIT PER AAK82-8 OR									
			AMK83-4 INSTRUCTIONS									
-ITEM NOT ILLUSTRATED			A - - - ATTACHING PARTS									



LEARJET 24
ILLUSTRATED PARTS CATALOG

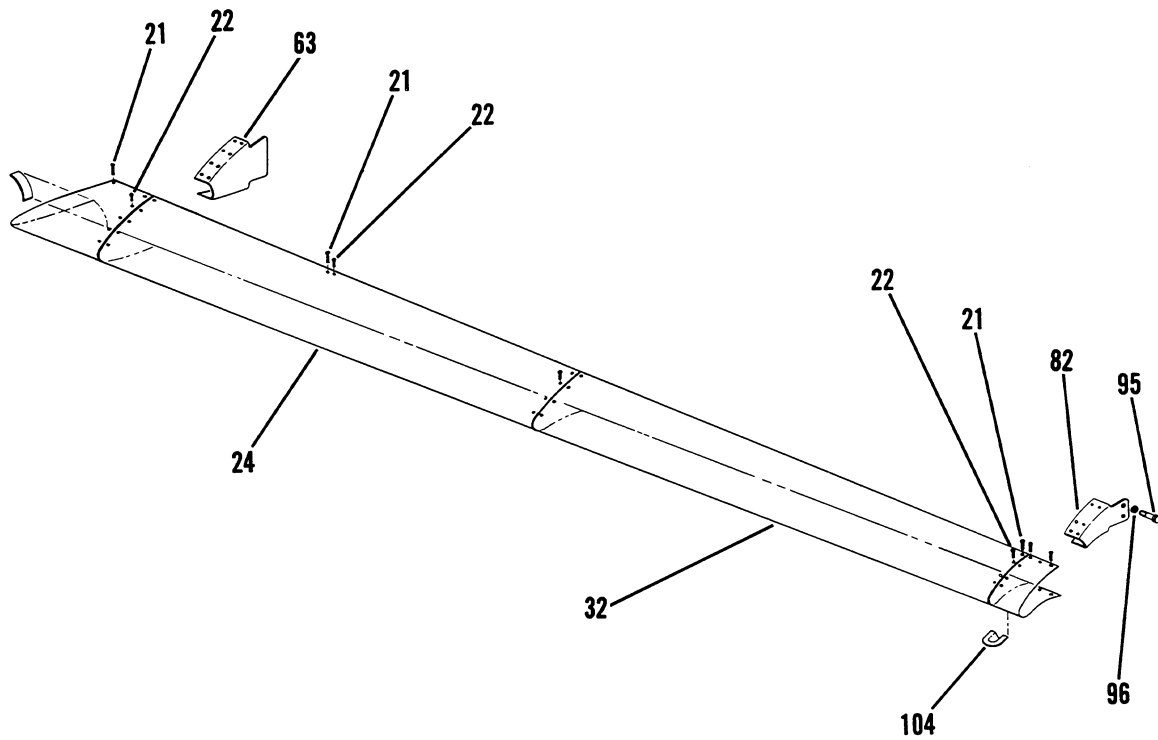

4-7C

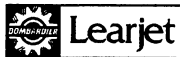

LEARJET 24
ILLUSTRATED PARTS CATALOG

FIG ITEM	PART NUMBER	SYMBOL	NOMENCLATURE								EFF CODE	UNITS PER ASSY			
			1	2	3	4	5	6	7	8			VENDOR		
								
10 - 1	RF57-02-02 FOR NHA														
- 5	2488028-3 - - - -		.									A	RF		
- 7	2488028-4 - - - -		.									C	1		
- 13	2522050-27 - - - -		.									C	1		
- 15	2522050-28 - - - -		.									D	1		
21	AN509C8R7 - - - -	A	.									D	1		
22	AN509C8R6 - - - -	A	.									A	AR		
24	2322377-5 - - - -		.	.								A	AR		
- 26	2322377-6 - - - -		.	.								E	1		
32	2322377-7 - - - -		.	.								H	1		
- 34	2322377-8 - - - -		.	.								G	1		
63	2322416-11 - - - -		.									K	1		
- 65	2322416-12 - - - -		.									L	1		
82	2322418-5 - - - -		.									L	1		
- 84	2322418-6 - - - -		.									L	1		
95	AN3-6A - - - -	A	.									L	1		
96	AN960PD10 - - - -	A	.									A	2		
104	2514304-1 - - - -		.									A	2		
-106	2514304-2 - - - -		.									A	1		
EFF CODES			INTERPRETATION												
A			24-100 THRU 328 EXCEPT A/C MOD BY A 2484038 KIT PER AAK76-4 INSTR												
C			24-100 THRU 155 EXCEPT A/C MOD BY A 2484038 KIT PER AAK76-4 INSTR												
D			24-156 THRU 328 EXCEPT A/C MOD BY A 2484038 KIT PER AAK76-4 INSTR												
E			PART OF FIG ITEM #5 WING LEADING EDGE ASSY LH												
G			PART OF FIG ITEM #5 & 13 WING LEADING EDGE ASSYS												
H			PART OF FIG ITEM #7 & 15 WING LEADING EDGE ASSYS												
K			PART OF FIG ITEM #7 & 15 WING LEADING EDGE ASSYS RH												
L			24-100 THRU 328 EXCEPT A/C MOD BY A 2484038 KIT PER AAK76-4 INSTR												
- ITEM NOT ILLUSTRATED A - - - ATTACHING PARTS															

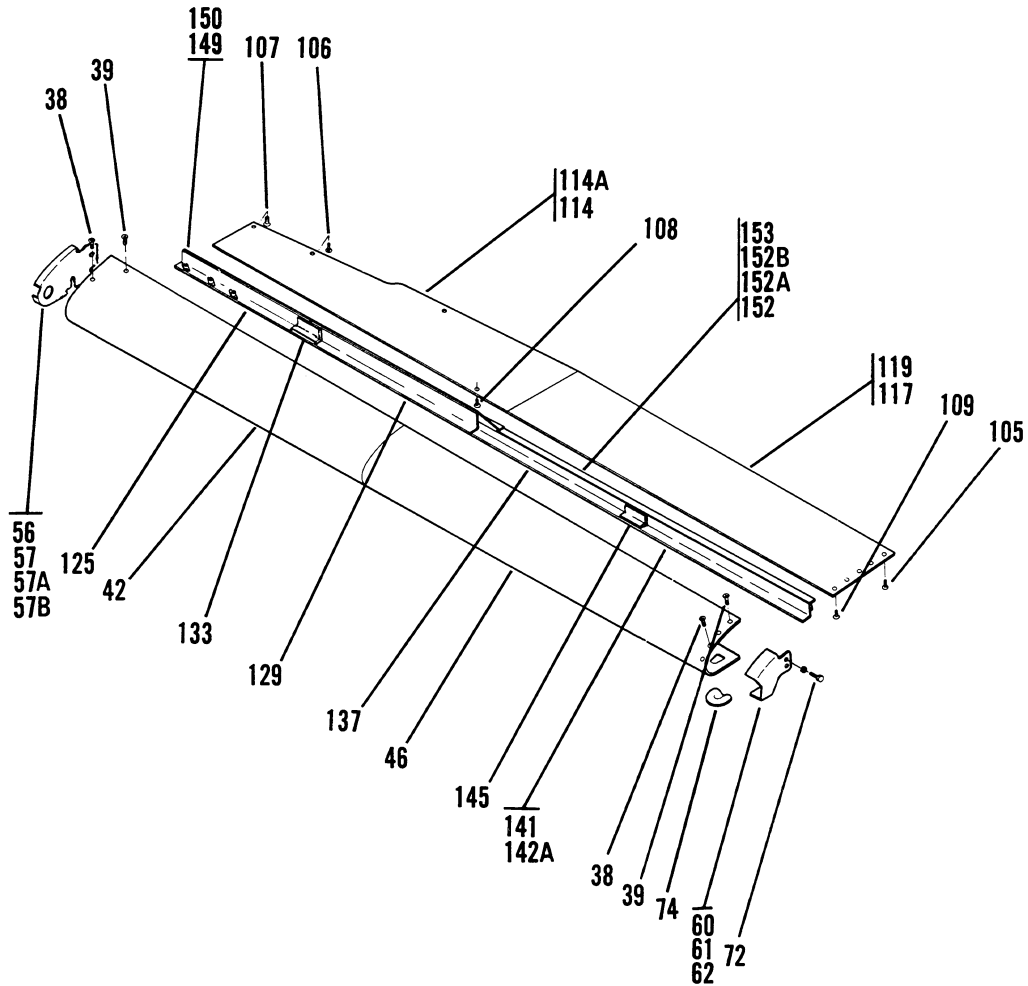

4-7C-2

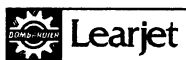

LEARJET 24
ILLUSTRATED PARTS CATALOG

FIG ITEM	PART NUMBER	SYMBOL	NOMENCLATURE								EFF CODE	UNITS PER ASSY
			1	2	3	4	5	6	7	8		
			VENDOR	
20 - 1	RF57-02-02 FOR NHA										A	RF
- 5	2422030-19 - - - -		.									
											Z	1
- 6	2422030-25 - - - -		.									
											Z	1
- 7	2422030-37 - - - -		.									
											Z	1
- 7A	2422030-47 - - - -		.									
											Z	1
- 7B	2422030-55 - - - -		.									
- 12	2422030-13 - - - -		.								C	1
- 13	2422030-31 - - - -		.								Z	1
- 13A	2422030-41 - - - -		.								Z	1
- 13B	2422030-49 - - - -		.								Z	1
- 25	2422030-20 - - - -		.								B	1
- 26	2422030-26 - - - -		.								Z	1
- 27	2422030-38 - - - -		.								Z	1
- 27A	2422030-48 - - - -		.								Z	1
- 27B	2422030-56 - - - -		.								Z	1
- 32	2422030-12 - - - -		.								C	1
- 33	2422030-32 - - - -		.								Z	1
- 33A	2422030-42 - - - -		.								Z	1
- 33B	2422030-50 - - - -		.								Z	1
38	MS24694C4 - - - -	A	.								B	1
39	MS24694C6 - - - -	A	.								A	AR
42	2422029-9 - - - -		.								A	AR
- 44	2422029-10 - - - -		.								D	1
46	2422029-7 - - - -		.								E	1
- 50	2422029-8 - - - -		.								D	1
56	2422082-5 - - - -		.								E	1
57	2422082-11 - - - -		.									
											Z	1
57A	2422082-15 - - - -		.									
											Z	1
57B	2422082-23 - - - -		.								Z	1
- 58	2422082-6 - - - -		.								A	1
- 59	2422082-12 - - - -		.								Z	1
- 59A	2422082-16 - - - -		.								Z	1
- 59B	2422082-20 - - - -		.								Z	1
- 59C	2422082-24 - - - -		.								Z	1
60	2422078-1 - - - -		.								A	1
61	2422078-9 - - - -		.								Z	1
62	2422078-15 - - - -		.									
- 66	2422078-2 - - - -		.								V	1
											W	1
- 67	2422078-10 - - - -		.									
- 68	2422078-16 - - - -		.								Z	1
72	AN3-5A - - - -	A	.								V	1
- 73	AN960PD10 - - - -	A	.								W	1
74	2422038-1 - - - -		.								A	2
- 87	2422039-69 - - - -		.								A	2
			.								A	2
			.									
			.									
			.									
			.									
			.									
			.									
			.									
			.									
			.									
			.									
			.									
			.									
			.									
			.									
			.									
			.									
			.									
			.									
			.									
			.									
			.									
			.									
			.									
			.									
			.									
			.									
			.									
			.									
			.									
			.									
			.									
			.									
			.									
			.									
			.									
			.									
			.									
			.									
			.									
			.									
			.									
			.									
			.									
			.									
			.									
			.									
			.									
			.									
			.									
			.									
			.									
			.									
			.									
			.									
			.									
			.									
			.									
			.									
			.									
			.									
			.									
			.									
			.									
			.					</				



LEARJET 24
ILLUSTRATED PARTS CATALOG

FIG ITEM	PART NUMBER	SYMBOL	NOMENCLATURE								EFF CODE	UNITS PER ASSY
			1	2	3	4	5	6	7	8		
			VENDOR	
20												
- 87A	2422039-53	- - - -									Z	1
- 88	2422039-77	- - - -									Z	1
- 88A	2422039-93	- - - -									Z	1
- 98	2422039-70	- - - -									A	1
- 98A	2422039-54	- - - -									Z	1
- 99	2422039-78	- - - -									Z	1
- 99A	2422039-92	- - - -									Z	1
105	MS24694C4	- - - -	A	.	SCREW	-	-	-	-	-	A	AR
106	MS24694S5	- - - -	A	.	SCREW	-	-	-	-	-	A	AR
107	MS24694S7	- - - -	A	.	SCREW	-	-	-	-	-	A	AR
108	MS24694C6	- - - -	A	.	SCREW	-	-	-	-	-	A	AR
109	NAS4703-3	- - - -	A	.	SCREW	-	-	-	-	-	A	AR
114	2422039-35	- - - -										
114A	2422039-73	- - - -									L	1
-115	2422039-36	- - - -									X	1
-116	2422039-74	- - - -									M	1
117	2422039-71	- - - -									AB	1
119	2422039-55	- - - -									N	1
-121	2422039-72	- - - -									AD	1
-123	2422039-56	- - - -									Q	1
125	2422041-63	- - - -									R	1
-127	2422041-64	- - - -										
129	2422041-65	- - - -									A	1
-131	2422041-66	- - - -									A	1
133	2422041-67	- - - -									A	1
-135	2422041-68	- - - -									A	2
137	2422041-55	- - - -									A	2
-139	2422041-56	- - - -									A	1
141	2422041-57	- - - -									A	1
142	2422041-73	- - - -									Z	1
142A	2422041-77	- - - -									A	1
-143	2422041-58	- - - -									A	1
-144	2422041-74	- - - -									Z	1
-144A	2422041-78	- - - -									A	1
145	2422041-59	- - - -									A	1
-147	2422041-60	- - - -									A	2
149	2422041-11	- - - -									A	2
150	2422041-103	- - - -									Z	1
-151	2422041-12	- - - -									A	1
-151A	2422041-104	- - - -									Z	1
152	2422041-27	- - - -									A	1
152A	2422041-33	- - - -									Z	1
152B	2422041-39	- - - -									Z	1
153	2422041-49	- - - -									Z	1
-154	2422041-28	- - - -									A	1
-154A	2422041-34	- - - -									Z	1
-154B	2422041-40	- - - -									Z	1
-155	2422041-50	- - - -									Z	1
											A	1

-ITEM NOT ILLUSTRATED

A - - - ATTACHING PARTS



LEARJET 24
ILLUSTRATED PARTS CATALOG

FIG ITEM	PART NUMBER	SYMBOL	NOMENCLATURE								EFF CODE	UNITS PER ASSY
			1	2	3	4	5	6	7	8		
			VENDOR	
20	EFF CODES		INTERPRETATION									
	A		24-329 & SUBQ & PREV A/C MOD BY A 2484038 KIT PER AAK76-4 INSTR									
	B		24-329 & SUBQ									
	C		24-100 THRU 328 WHEN MOD BY A 2484038 KIT PER AAK76-4 INSTR									
	D		PART OF FIG ITEM #5 & SUBQ LH WING LEADING EDGE ASSYS									
	E		PART OF FIG ITEM #25 & SUBQ RH WING LEADING EDGE ASSYS									
	L		PART OF FIG ITEM #87 & 87A LH LEADING EDGE FAIRING ASSYS									
	M		PART OF FIG ITEM #98 & 98A RH LEADING EDGE FAIRING ASSYS									
	N		PART OF FIG ITEM #87, 88 & SUBQ LH LEADING EDGE FAIRING ASSYS									
	Q		PART OF FIG ITEM #98, 99 & SUBQ RH LEADING EDGE FAIRING ASSYS									
	R		PART OF FIG ITEM #98A RH LEADING EDGE FAIRING ASSY									
	V		24-329 THRU 357 & PREV A/C MOD BY A 2484038 KIT PER AAK76-4 INSTR									
	W		24-358 & SUBQ									
	X		PART OF FIG ITEM #88 & SUBQ LH LEADING EDGE FAIRING ASSYS									
	Z		SUPERSEDED PART INACTIVE SPARE									
	AB		PART OF FIG ITEM #99 & SUBQ RH LEADING EDGE FAIRING ASSYS									
	AD		PART OF FIG ITEM #87A LH LEADING EDGE FAIRING ASSY									
-ITEM NOT ILLUSTRATED			A - - - ATTACHING PARTS									



LEARJET 24
ILLUSTRATED PARTS CATALOG

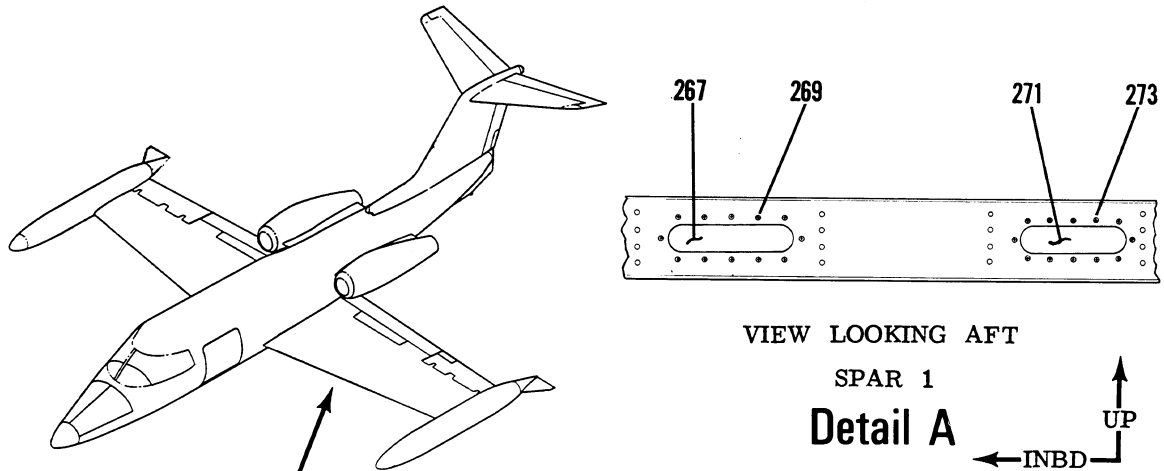

VIEW LOOKING AFT

SPAR 1

Detail A

SEE FIG ITEM #450 FOR
REFERENCED ITEMS

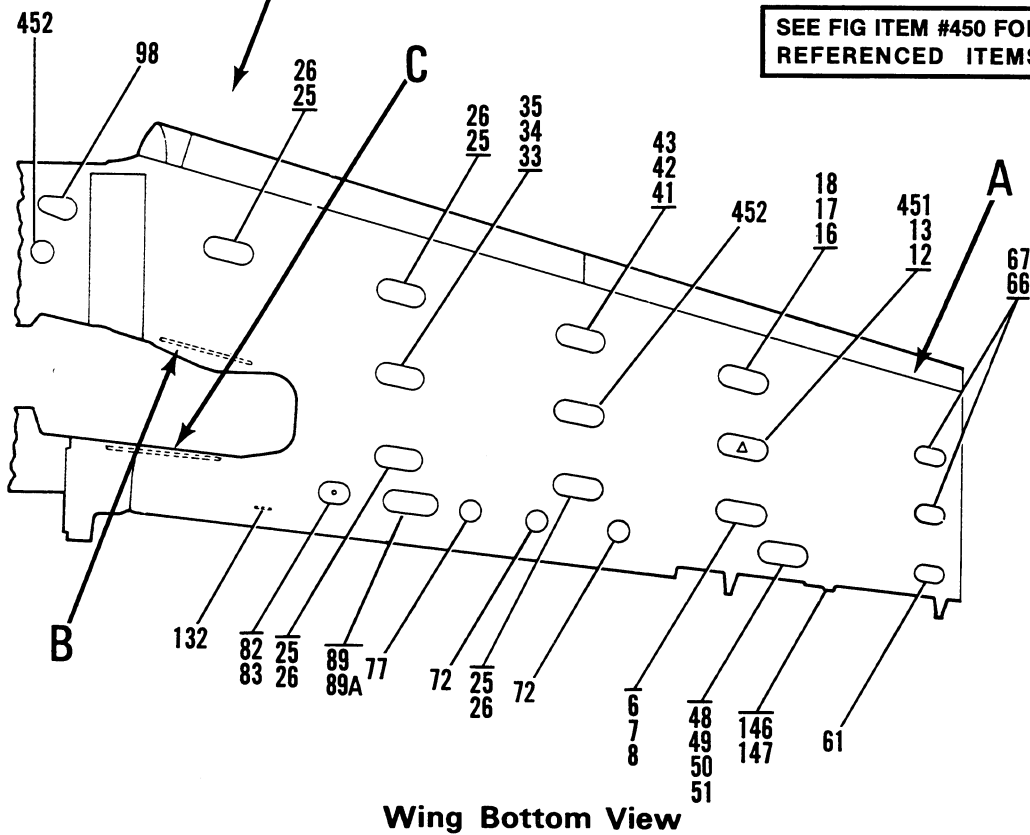

Wing Bottom View

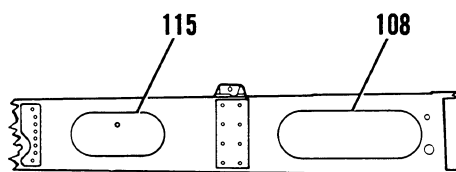

VIEW LOOKING FWD

SPAR 5

Detail B

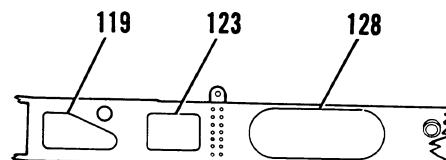

VIEW LOOKING AFT

SPAR 7

Detail C

4-28C
A4-28C-2
B4-28C
C4-28C



LEARJET 24
ILLUSTRATED PARTS CATALOG

FIG ITEM	PART NUMBER	SYMBOL	NOMENCLATURE								EFF CODE	UNITS PER ASSY
			1	2	3	4	5	6	7	8		
				
			VENDOR									
10 - 1	RF57-02-02 FOR NHA		ACCESS COVERS INSTL-WING LH & RH - - -								A	RF
6	2322259-23 - - - -		. DOOR ASSY - - - - -								C	2
7	2322259-5 - - - -		. DOOR-WING ACCESS - - - - -								D	2
8	2622387-1 - - - -		. DOOR-WING ACCESS - - - - -								E	2
- 11B	AN509-8R10 - - - -	A	. SCREW - - - - -								AS	48
- 11C	AN509-8R10 - - - -	A	. SCREW - - - - -								AT	14
- 11D	AN509-8R9 - - - -	A	. SCREW - - - - -								AT	30
- 11E	NAS1202-3 - - - -	A	. BOLT - - - - -								AT	4
- 11J	4600H-82 - - - -	A	. NUTPLATE - - - - - V80539								A	AR
- 11L	14600H-82 - - - -	A	. NUTPLATE - - - - - V80539									
			ALT FOR 4600H-82 - - - - -								A	AR
- 11Q	14620H-82 - - - -	A	. NUTPLATE - - - - - V80539								F	AR
- 11U	NAS463F-DD10 - - - -	A	. SHIM - - - - -								F	AR
12	2322259-23 - - - -		. DOOR ASSY - - - - -								C	2
13	2322259-5 - - - -		. DOOR-WING ACCESS - - - - -								G	2
- 13A	AN509-8R10 - - - -	A	. SCREW - - - - -								W	48
- 13C	4600H-82 - - - -	A	. NUTPLATE - - - - -								W	AR
- 13E	14600H-82 - - - -	A	. NUTPLATE - - - - -									
			ALT FOR 4600H-82 - - - - -								W	AR
16	2322259-24 - - - -		. DOOR ASSY - - - - -								C	2
17	2322259-8 - - - -		. DOOR-WING ACCESS - - - - -								D	2
18	2622387-2 - - - -		. DOOR-WING ACCESS - - - - -								E	2
- 21C	AN509-8R10 - - - -	A	. SCREW - - - - -								AS	48
- 21D	NAS1202-3 - - - -	A	. BOLT - - - - -								AT	48
- 21J	4600H-82 - - - -	A	. NUTPLATE - - - - - V80539								A	AR
- 21N	14600H-82 - - - -	A	. NUTPLATE - - - - -									
			ALT FOR 4600H-82 - - - - -								A	AR
- 21Q	NAS463W-DD10L - - - -	A	. SHIM - - - - -								F	28
- 21W	NAS463F-DD10 - - - -	A	. SHIM - - - - -								F	8
25	2322259-23 - - - -		. DOOR-WING ACCESS - - - - -								C	8
26	2322259-5 - - - -		. DOOR-WING ACCESS - - - - -								H	8
- 29C	AN509-8R10 - - - -	A	. SCREW - - - - -								AS	AR
- 29D	AN509-8R9 - - - -	A	. SCREW - - - - -								AT	AR
- 29J	4600H-82 - - - -	A	. NUTPLATE - - - - - V80539								A	AR
33	2322259-26 - - - -		. DOOR ASSY - - - - -								C	2
34	2322259-14 - - - -		. DOOR-WING ACCESS - - - - -								D	2
35	2622387-5 - - - -		. DOOR-WING ACCESS - - - - -								E	2
- 38C	AN509-8R10 - - - -	A	. SCREW - - - - -								AS	48
- 38D	NAS1202-3 - - - -	A	. BOLT - - - - -								AT	28
- 38E	AN509-8R9 - - - -	A	. SCREW - - - - -								AT	20
- 38J	4600H-82 - - - -	A	. NUTPLATE - - - - - V80539								A	AR
- 38L	14600H-82 - - - -	A	. NUTPLATE - - - - -								E	28
- 38Q	NAS463W-DD10L - - - -	A	. SHIM - - - - -								E	28
41	2322259-25 - - - -		. DOOR ASSY - - - - -								C	2
42	2322259-10 - - - -		. DOOR-WING ASSY - - - - -								D	2
43	2622387-3 - - - -		. DOOR-WING ASSY - - - - -								E	2
- 45C	AN509-8R10 - - - -	A	. SCREW - - - - -								AS	48
- 45D	NAS1202-3 - - - -	A	. BOLT - - - - -								AT	32
- 45E	AN509-8R9 - - - -	A	. SCREW - - - - -								AT	16
- 45J	4600H-82 - - - -	A	. NUTPLATE - - - - - V80539								A	AR
- 45L	14600H-82 - - - -	A	. NUTPLATE - - - - - V80539								A	AR
- 45S	NAS463F-DD10 - - - -	A	. SHIM - - - - -								E	4
48	2322259-23 - - - -		. DOOR ASSY - - - - -								C	2
49	2322259-5 - - - -		. DOOR-WING ACCESS - - - - -								J	2
50	2622387-1 - - - -		. DOOR-WING ACCESS - - - - -								K	2
51	2622387-6 - - - -		. DOOR-WING ACCESS - - - - -								L	2
- 53C	AN509-8R10 - - - -	A	. SCREW - - - - -								AS	48
- 53D	NAS1202-3 - - - -	A	. BOLT - - - - -								AT	48
- 53J	4600-82 - - - -	A	. NUTPLATE - - - - - V80539								M	48
- 53L	NAS680A08 - - - -	A	. NUTPLATE - - - - -								E	44
- 53N	NAS684A08 - - - -	A	. NUTPLATE - - - - -								E	4
61	2322259-21 - - - -		. DOOR-WING ACCESS - - - - -								Q	2
- 63A	AN509-8R10 - - - -	A	. SCREW - - - - -								AS	AR
- 63B	AN509-8R9 - - - -	A	. SCREW - - - - -								AT	AR
- 63E	NAS680A08 - - - -	A	. NUTPLATE - - - - -								Q	AR
- 63G	NAS697A08 - - - -	A	. NUTPLATE - - - - -								Q	4
66	2322259-22 - - - -		. DOOR-WING ACCESS - - - - -								C	4
-ITEM NOT ILLUSTRATED			A - - - ATTACHING PARTS									



LEARJET 24
ILLUSTRATED PARTS CATALOG

FIG ITEM	PART NUMBER	SYMBOL	NOMENCLATURE								EFF CODE	UNITS PER ASSY
			1	2	3	4	5	6	7	8		
				
10 67	2322259-3	- - - -	.	DOOR-WING ACCESS	-	-	-	-	-	-	H	4
- 69A	AN509-8R10	- - - -	A	SCREW	-	-	-	-	-	-	AS	64
- 69B	AN509-8R9	- - - -	A	SCREW	-	-	-	-	-	-	AT	64
- 69G	4600H-82	- - - -	A	NUTPLATE	-	-	-	-	-	-	Q	64
72	2322259-15	- - - -	.	DOOR-WING ACCESS	-	-	-	-	-	-	Q	4
- 74A	AN509-8R9	- - - -	A	SCREW	-	-	-	-	-	-	AP	48
- 74B	AN509-8R10	- - - -	A	SCREW	-	-	-	-	-	-	AQ	48
- 74C	AN509-8R9	- - - -	A	SCREW	-	-	-	-	-	-	AR	48
- 74E	NAS680A08	- - - -	A	NUTPLATE	-	-	-	-	-	-	AN	48
77	2322259-31	- - - -	.	DOOR-WING ACCESS	-	-	-	-	-	-	S	2
- 79A	AN509-8R9	- - - -	A	SCREW	-	-	-	-	-	-	AP	26
- 79C	AN509-8R10	- - - -	A	SCREW	-	-	-	-	-	-	AQ	26
- 79E	NAS1202-3	- - - -	A	SCREW	-	-	-	-	-	-	AR	26
- 79J	NAS680A08	- - - -	A	NUTPLATE	-	-	-	-	-	-	S	26
82	2322259-16	- - - -	.	DOOR-WING ACCESS	-	-	-	-	-	-	T	2
83	2322259-55	- - - -	.	DOOR-WING ACCESS WITH DRAIN SEAL	-	-	-	-	-	-	U	2
- 85A	AN509-8R9	- - - -	A	SCREW	-	-	-	-	-	-	AP	32
- 85C	AN509-8R10	- - - -	A	SCREW	-	-	-	-	-	-	AQ	32
- 85E	AN509-8R9	- - - -	A	SCREW	-	-	-	-	-	-	AR	32
- 85J	NAS680A08	- - - -	A	NUTPLATE	-	-	-	-	-	-	Q	32
89	2322516-133	- - - -	.	DOOR-WING ACCESS LH WHEN EXHTD USE 2322516-203	-	-	-	-	-	-	Z	1
89A	2322516-203	- - - -	.	DOOR-WING ACCESS LH	-	-	-	-	-	-	Q	1
- 93	2322516-134	- - - -	.	DOOR-WING ACCESS RH WHEN EXHTD USE 2322516-204	-	-	-	-	-	-	Z	1
- 93A	2322516-204	- - - -	.	DOOR-WING ACCESS RH	-	-	-	-	-	-	Q	1
- 95	AN509-10R8	- - - -	A	SCREW	-	-	-	-	-	-	A	48
- 95C	NAS680A3	- - - -	A	NUTPLATE	-	-	-	-	-	-	Q	4
- 95E	NAS697A3	- - - -	A	NUTPLATE	-	-	-	-	-	-	Q	4
98	2322259-17	- - - -	.	DOOR ASSY-ACCESS LH	-	-	-	-	-	-	V	1
-102	2322259-51	- - - -	.	DOOR ASSY-ACCESS RH	-	-	-	-	-	-	V	1
-105	NAS221-13	- - - -	A	SCREW	-	-	-	-	-	-	A	58
-105K	AN960PD10L	- - - -	A	WASHER	-	-	-	-	-	-	A	58
-105L	4600H-02	- - - -	A	NUTPLATE	-	-	-	-	-	-	A	58
108	2322140-70	- - - -	.	DOOR-WHEEL WELL SPAR #5 LH	-	-	-	-	-	-	Q	1
-109	2322140-70	- - - -	.	DOOR-WHEEL WELL SPAR #5 RH	-	-	-	-	-	-	X	1
-110	2322140-74	- - - -	.	DOOR-WHEEL WELL SPAR #5 RH	-	-	-	-	-	-	AA	1
-111	2322140-79	- - - -	.	DOOR-WHEEL WELL SPAR #5 RH	-	-	-	-	-	-	AY	1
-112	AN4-6A	- - - -	A	BOLT	-	-	-	-	-	-	A	32
-112A	AN960PD416	- - - -	A	WASHER	-	-	-	-	-	-	A	32
-112C	14600H-048	- - - -	A	NUTPLATE	-	-	-	-	-	-	A	32
-112E	2322140-64	- - - -	A	GASKET	-	-	-	-	-	-	A	2
115	2322140-69	- - - -	.	DOOR-WHEEL WELL SPAR #5 LH & RH	-	-	-	-	-	-	AC	2
-117	AN4-6A	- - - -	A	BOLT	-	-	-	-	-	-	A	72
-117A	AN960PD416	- - - -	A	WASHER	-	-	-	-	-	-	A	72
-117C	14600H-048	- - - -	A	NUTPLATE	-	-	-	-	-	-	A	72
-117E	2322140-65	- - - -	A	GASKET	-	-	-	-	-	-	A	2
119	2322203-11	- - - -	.	DOOR-WING ACCESS SPAR #7	-	-	-	-	-	-	A	2
-121	AN3-5A	- - - -	A	BOLT	-	-	-	-	-	-	A	6
-121A	AN960D10L	- - - -	A	WASHER	-	-	-	-	-	-	A	6
-121C	NAS680A3	- - - -	A	NUTPLATE	-	-	-	-	-	-	A	6
123	2322203-12	- - - -	.	DOOR-WING ACCESS SPAR #7	-	-	-	-	-	-	A	2
-127	AN3-5A	- - - -	A	BOLT	-	-	-	-	-	-	A	8
-127A	AN960D10L	- - - -	A	WASHER	-	-	-	-	-	-	A	8
-127C	NAS680A3	- - - -	A	NUTPLATE	-	-	-	-	-	-	A	8
128	2322203-31	- - - -	.	DOOR-WING ACCESS SPAR #7	-	-	-	-	-	-	A	2
-130	AN4-7A	- - - -	A	BOLT	-	-	-	-	-	-	A	38
-130A	AN960-416	- - - -	A	WASHER	-	-	-	-	-	-	A	38
-130C	NAS680A4	- - - -	A	NUTPLATE	-	-	-	-	-	-	A	38
-130E	NAS463WD416H	- - - -	A	SHIM	-	-	-	-	-	-	A	12
132	2322212-25	- - - -	.	DOOR-WING ACCESS SPAR #8	-	-	-	-	-	-	AD	2
-134	NAS220-6	- - - -	A	SCREW	-	-	-	-	-	-	AD	24
-134A	AN960PD8L	- - - -	A	WASHER	-	-	-	-	-	-	AD	24
-134C	NAS697A08	- - - -	A	NUTPLATE	-	-	-	-	-	-	AD	24
146	2322550-27	- - - -	.	DOOR-LH	-	-	-	-	-	-	AU	1
147	2322550-39	- - - -	.	DOOR-LH	-	-	-	-	-	-	AV	1
-ITEM NOT ILLUSTRATED			A - - - ATTACHING PARTS									



LEARJET 24
ILLUSTRATED PARTS CATALOG

FIG ITEM	PART NUMBER	S Y M B O L	1 2 3 4 5 6 7 8 • • • • • • • •	NOMENCLATURE VENDOR	EFF CODE	UNITS PER ASSY
10 -150	2322550-28 - - - -		.	DOOR-RH - - - - -	AU	1
-151	2322550-40 - - - -		.	DOOR-RH - - - - -	AV	1
-153	AN509-10R8 - - - -	A	.	SCREW - - - - -	A	8
267	2484039-12 - - - -	.	.	COVER ASSY-WING ACCESS SPAR #1 - - -	AM	2
269	NAS220-8 - - - -	A	.	SCREW - - - - -	AM	24
-270	M14600H82 - - - -	.	.	NUTPLATE - - - - - V80539	BV	12
271	2484039-14 - - - -	.	.	COVER ASSY-WING ACCESS SPAR #1 - - -	AM	2
273	NAS220-9 - - - -	A	.	SCREW - - - - -	AM	24
-274	M14600H82 - - - -	.	.	NUTPLATE - - - - - V80539	BW	12
-450			.	REFERENCED ITEMS		
451	RF28-13 FOR NHA - -	.	.	VENT SYS INSTL-FUEL - - - - -	Y	RF
452	RF28-40 FOR NHA - -	.	.	PROBE INSTL-FUEL WING & TIP TANK - - - - -	Y	RF
	EFF CODES			INTERPRETATION		
	A			24-100 & SUBQ		
	C			24-100 THRU 149		
	D			24-150 THRU 285		
	E			24-286 & SUBQ		
	F			24-286 & SUBQ		
	G			24-150 THRU 229 EXCEPT 218		
	H			24-150 & SUBQ		
	J			24-150 THRU 285		
	K			24-286 THRU 290		
	L			24-291 & SUBQ		
	M			24-100 THRU 285		
	Q			24-100 & SUBQ		
	S			24-100 & SUBQ		
	T			24-100 THRU 299 EXCEPT 218		
	U			24-218, 230 & SUBQ		
	V			24-100 & SUBQ		
	W			24-100 THRU 229 EXCEPT 218		
	X			24-100 THRU 240		
	Y			SEE TABLE OF CONTENTS OF REF CHAPTER & SECTION FOR APPLICABLE NHA FIGURE		
	Z			SUPERSEDED PART INACTIVE SPARE		
	AA			24-241 THRU 357		
	AC			24-100 & SUBQ		
	AD			24-198 & SUBQ		
	AM			24-358 & SUBQ & PREV A/C MOD BY A 2484038 KIT PER AAK76-4 INSTR		
	AN			24-100 & SUBQ		
	AP			24-100 THRU 285		
	AQ			24-286 THRU 357		
	AR			24-358 & SUBQ		
	AS			24-100 THRU 357		
	AT			24-358 & SUBQ		
	AU			24-230 THRU 282		
	AV			24-283 & SUBQ		
	AY			24-358 & SUBQ		
	BV			PART OF FIG ITEM #267 & SUBQ WING ACCESS COVER ASSYS		
	BW			PART OF FIG ITEM #271 & SUBQ WING ACCESS COVER ASSYS		
-ITEM NOT ILLUSTRATED			A - - - ATTACHING PARTS			

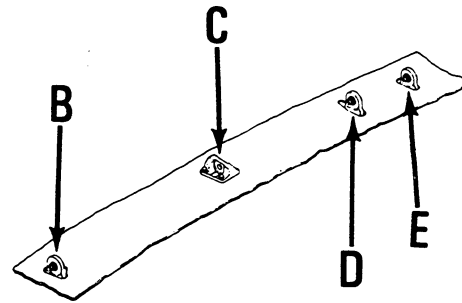
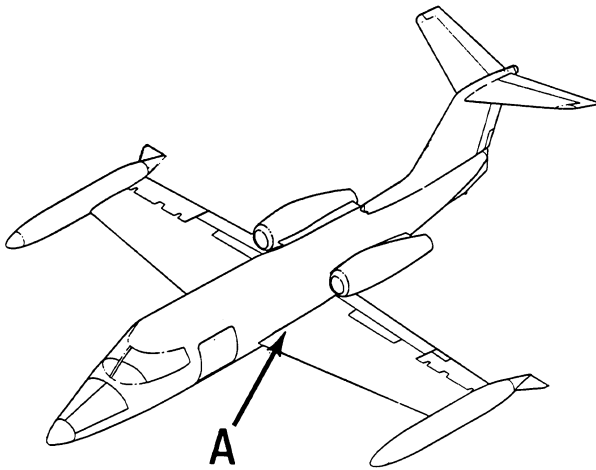

Detail A

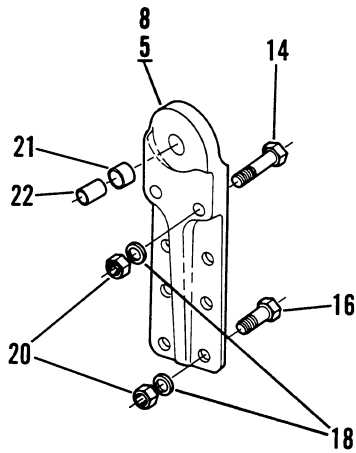

Detail B

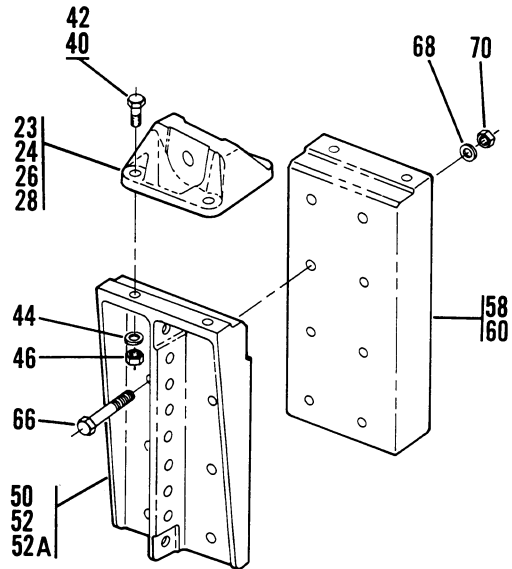

Detail C

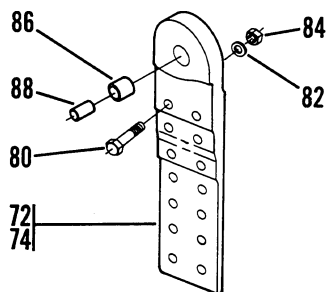

Detail D

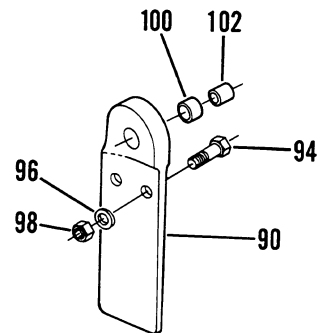

Detail E

A4-27B
B4-35C
C4-35C
D4-35C
E4-35C



LEARJET 24
ILLUSTRATED PARTS CATALOG

FIG ITEM		PART NUMBER	S Y M B O L	1 2 3 4 5 6 7 8 • • • • • • • •		NOMENCLATURE VENDOR	EFF CODE	UNITS PER ASSY
05 - 1		RF57-02-02 FOR NHA				FITTING INSTL-FUSELAGE ATTACH WING - - - - -	A	RF
5		2322275-1 - - - - -				. FITTING-WING ATCH #2 SPAR LH FOR SPARES USE 2322275-3 - - - - -	Z	1
8		2322275-3 - - - - -				. FITTING-WING ATCH #2 SPAR LH - - - - -	A	1
- 10		2322275-2 - - - - -				. FITTING-WING ATCH #2 SPAR RH FOR SPARES USE 2322275-4 - - - - -	Z	1
- 12		2322275-4 - - - - -				. FITTING WING ATCH #2 SPAR RH - - - - -	A	1
14		AN4-13A - - - - -	A			. BOLT - - - - -	A	2
16		AN4-7A - - - - -	A			. BOLT - - - - -	A	6
18		AN960-416 - - - - -	A			. WASHER - - - - -	A	8
20		MS20365-428 - - - - -	A			. NUT - - - - -	A	8
21		NAS75-9-016 - - - - -				. BUSHING - - - - -	A	2
22		NAS75-7-026 - - - - -				. BUSHING - - - - -	A	2
23		2322278-3 - - - - -				. FITTING-WING ATCH #5 SPAR LH - - - - -	B	1
24		2322278-5 - - - - -				. FITTING-WING ATCH #5 SPAR LH - - - - -	C	1
26		2322278-9 - - - - -				. FITTING-WING ATCH #5 SPAR LH - - - - -	D	1
28		2322278-11 - - - - -				. FITTING-WING ATCH #5 SPAR LH - - - - -	E	1
- 30		2322278-4 - - - - -				. FITTING-WING ATCH #5 SPAR RH - - - - -	B	1
- 32		2322278-6 - - - - -				. FITTING-WING ATCH #5 SPAR RH - - - - -	C	1
- 34		2322278-10 - - - - -				. FITTING-WING ATCH #5 SPAR RH - - - - -	D	1
- 36		2322278-12 - - - - -				. FITTING-WING ATCH #5 SPAR RH - - - - -	E	1
40		AN176-14A - - - - -	A			. BOLT - - - - -	F	4
42		NAS1306-15 - - - - -	A			. BOLT - - - - -	G	4
44		AN960PD616 - - - - -	A			. WASHER - - - - -	A	4
46		MS20365-624 - - - - -	A			. NUT - - - - -	A	4
50		2322291-1 - - - - -				. SUPPORT-WING FTG #5 SPAR LH - - - - -	H	1
52		2322291-3 - - - - -				. SUPPORT-WING FTG #5 SPAR LH WHEN EXHTD USE 2322291-5 - - - - -	Z	1
52A		2322291-5 - - - - -				. SUPPORT-WING FTG #5 SPAR LH - - - - -	J	1
- 54		2322291-2 - - - - -				. SUPPORT-WING FTG #5 SPAR RH - - - - -	H	1
- 56		2322291-4 - - - - -				. SUPPORT-WING FTG #5 SPAR RH WHEN EXHTD USE 2322291-6 - - - - -	Z	1
- 56A		2322291-6 - - - - -				. SUPPORT-WING FTG #5 SPAR RH - - - - -	J	1
58		2322292-1 - - - - -				. SUPPORT-WING FTG #5 SPAR LH - - - - -	H	1
60		2322292-3 - - - - -				. SUPPORT-WING FTG #5 SPAR LH - - - - -	J	1
- 62		2322292-2 - - - - -				. SUPPORT-WING FTG #5 SPAR RH - - - - -	H	1
- 64		2322292-4 - - - - -				. SUPPORT-WING FTG #5 SPAR RH - - - - -	J	1
66		AN4-12A - - - - -	A			. BOLT - - - - -	A	8
68		AN960-416 - - - - -	A			. WASHER - - - - -	A	8
70		MS20365-428 - - - - -	A			. NUT - - - - -	A	8
72		2322282-1 - - - - -				. FITTING-WING ATCH #7 SPAR LH FOR SPARES USE 2322282-3 - - - - -	Z	1
74		2322282-3 - - - - -				. FITTING-WING ATCH #7 SPAR LH - - - - -	A	1
- 76		2322282-2 - - - - -				. FITTING-WING ATCH #7 SPAR RH FOR SPARES USE 2322282-4 - - - - -	Z	1
- 78		2322282-4 - - - - -				. FITTING WING ATCH #7 SPAR RH - - - - -	A	1
80		AN174-12A - - - - -	A			. BOLT - - - - -	A	2
82		AN960-416 - - - - -	A			. WASHER - - - - -	A	2
84		MS20365-428 - - - - -	A			. NUT - - - - -	A	2
86		NAS75-9-016 - - - - -				. BUSHING - - - - -	A	2
88		NAS75-7-021 - - - - -				. BUSHING - - - - -	A	2
90		2322281-1 - - - - -				. FITTING-WING ATCH #8 SPAR LH - - - - -	A	1
- 92		2322281-2 - - - - -				. FITTING-WING ATCH #8 SPAR RH - - - - -	A	1
94		AN174-12A - - - - -	A			. BOLT - - - - -	A	2
96		AN960-416 - - - - -	A			. WASHER - - - - -	A	2
98		MS20365-428 - - - - -	A			. NUT - - - - -	A	2
100		NAS75-9-016 - - - - -				. BUSHING - - - - -	A	2
102		NAS75-7-021 - - - - -				. BUSHING - - - - -	A	2
EFF CODES		INTERPRETATION						
A		24-100 & SUBQ						
B		24-100 THRU 171						
C		24-172 THRU 253						
D		24-254 THRU 299						
E		24-300 & SUBQ						
F		24-100 THRU 189						
-ITEM NOT ILLUSTRATED			A - - - ATTACHING PARTS					

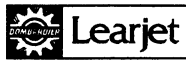

LEARJET 24
ILLUSTRATED PARTS CATALOG

FIG ITEM	PART NUMBER	SYMBOL	NOMENCLATURE								EFF CODE	UNITS PER ASSY		
			1	2	3	4	5	6	7	8				
			VENDOR				
05		G	24-190 & SUBQ											
		H	24-100 THRU 231											
		J	24-232 & SUBQ											
		Z	SUPERSEDED PART INACTIVE SPARE											
-ITEM NOT ILLUSTRATED														
A - - - ATTACHING PARTS														

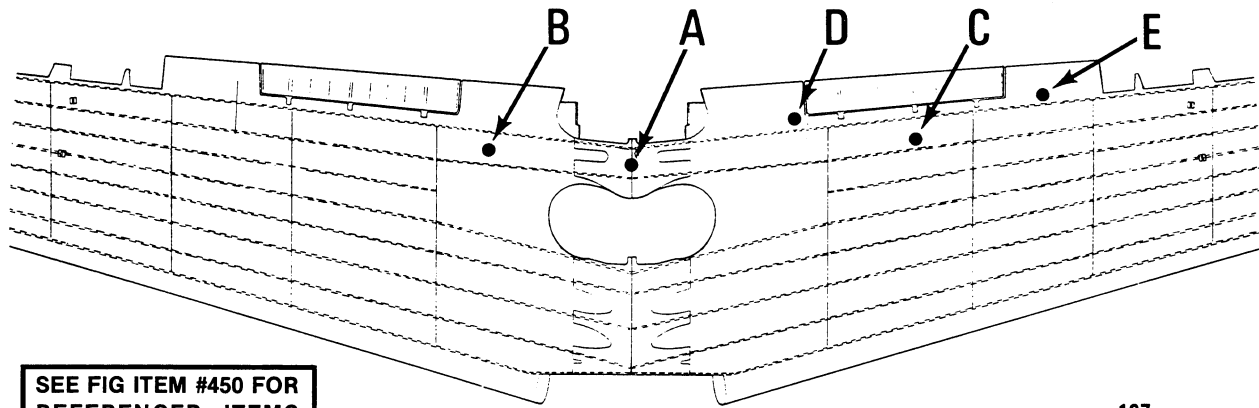

SEE FIG ITEM #450 FOR
REFERENCED ITEMS

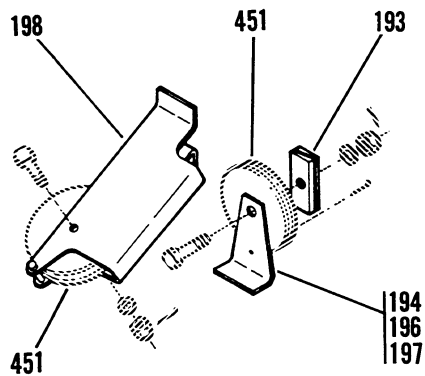

Detail A

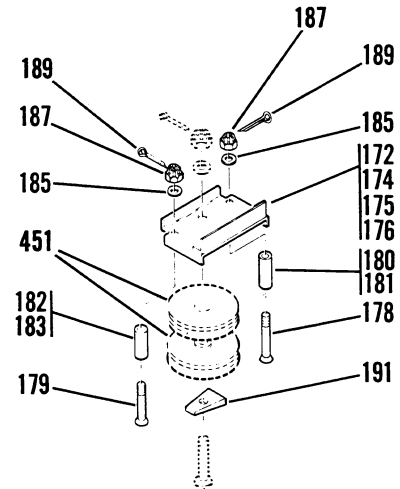

Detail B

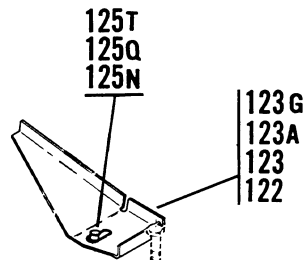

Detail C

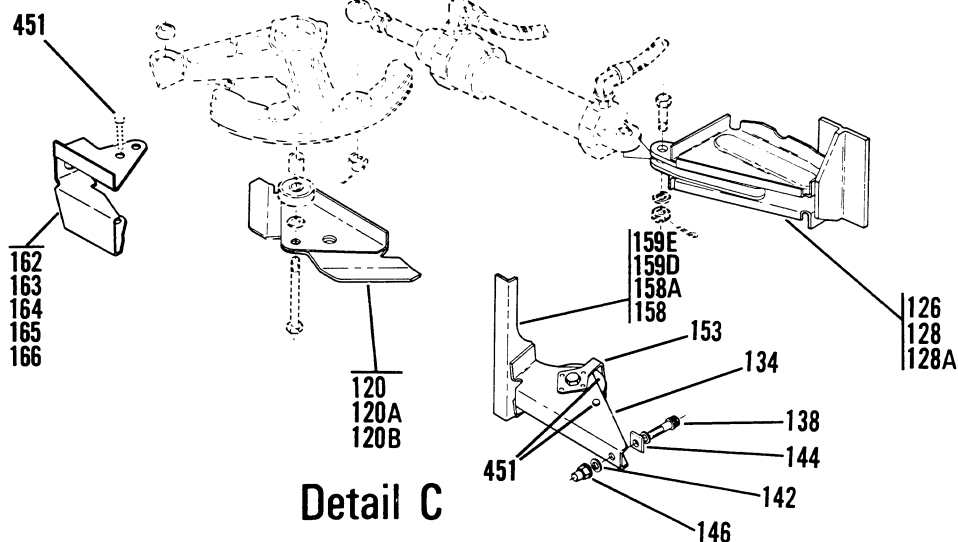

4-26C-1
A8-85A
B8-33C
C8-6C-2



LEARJET 24
ILLUSTRATED PARTS CATALOG

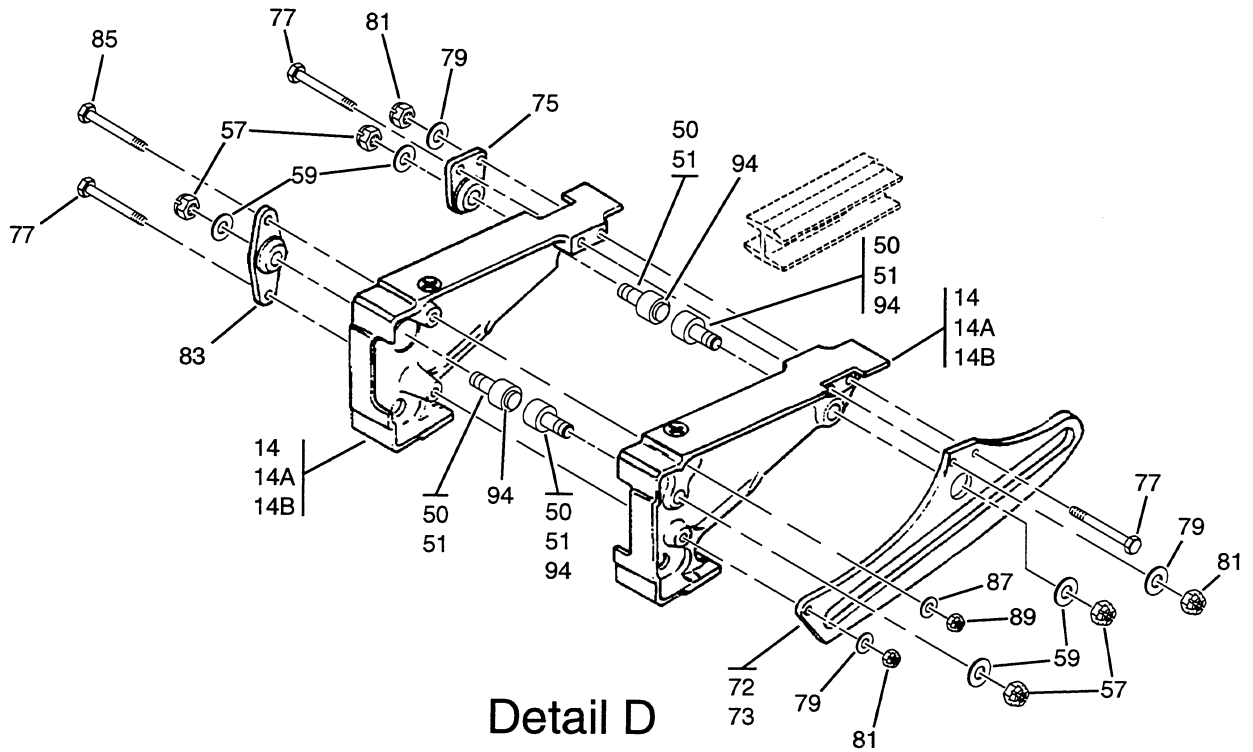

Detail D

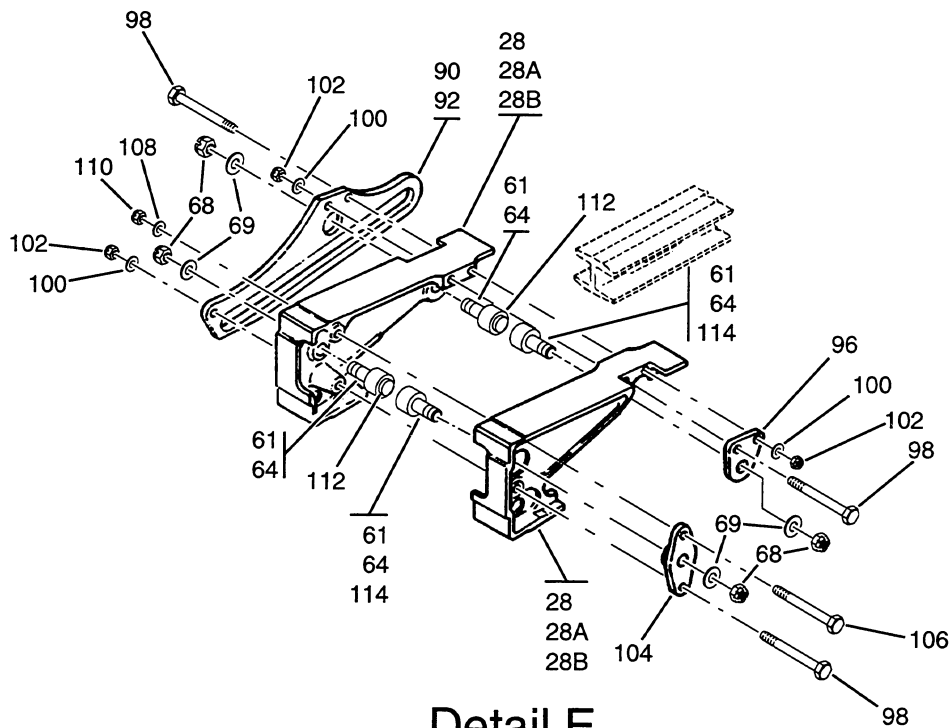

Detail E

P24-574210-000-02



LEARJET 24
ILLUSTRATED PARTS CATALOG

FIG ITEM	PART NUMBER	SYM BO L	NOMENCLATURE								EFF CODE	UNITS PER ASSY
			1	2	3	4	5	6	7	8		
			VENDOR	
10 - 1	RF57-02-02 FOR NHA		BRACKETS INSTL-FLAP CONTROLS									
14	CONFIGURATION A - -		WING LH & RH - - - - -								A	RF
			. SUPPORT ASSY-INBD TRACK LH									
			WING MATCHED SET ORDER									
			ALL DETAIL PARTS									
			FOR SPARES USE									
14A	CONFIGURATION B - -		CONFIGURATION B - - - - -								Z	1
			. SUPPORT ASSY-INBD TRACK LH									
			WING MATCHED SET ORDER									
			ALL DETAIL PARTS									
			FOR SPARES USE									
14B	CONFIGURATION C - -		CONFIGURATION C - - - - -								Z	1
			. SUPPORT ASSY-INBD TRACK LH									
			WING MATCHED SET ORDER									
			ALL DETAIL PARTS - - - - -								A	1
- 15	2322511-31 - - - -		. . SUPPORT-INNER INBD TRACK									
			WING LH - - - - -								R	1
- 15A	2322511-41 - - - -		. . SUPPORT-INNER INBD TRACK									
			WING LH - - - - -								AX	1
- 15B	2322511-55 - - - -		. . SUPPORT-INNER INBD TRACK									
			WING LH - - - - -								BD	1
- 16	2322511-29 - - - -		. . SUPPORT-OUTER INBD TRACK									
			WING LH - - - - -								R	1
- 16A	2322511-39 - - - -		. . SUPPORT-OUTER INBD TRACK									
			WING LH - - - - -								AX	1
- 16B	2322511-53 - - - -		. . SUPPORT-OUTER INBD TRACK									
			WING LH - - - - -								BD	1
- 20	CONFIGURATION A - -		. SUPPORT ASSY-INBD TRACK RH									
			WING MATCHED SET ORDER									
			ALL DETAIL PARTS									
			FOR SPARES USE									
			CONFIGURATION B - - - - -								Z	1
- 20A	CONFIGURATION B - -		. SUPPORT ASSY-INBD TRACK RH									
			WING MATCHED SET ORDER									
			ALL DETAIL PARTS									
			FOR SPARES USE									
			CONFIGURATION C - - - - -								Z	1
- 20B	CONFIGURATION C - -		. SUPPORT ASSY-INBD TRACK RH									
			WING MATCHED SET ORDER									
			ALL DETAIL PARTS - - - - -								A	1
- 21	2322511-30 - - - -		. . SUPPORT-INNER INBD TRACK									
			WING RH - - - - -								S	1
- 21A	2322511-42 - - - -		. . SUPPORT-INNER INBD TRACK									
			WING RH - - - - -								AY	1
- 21B	2322511-56 - - - -		. . SUPPORT-INNER INBD TRACK									
			WING RH - - - - -								BE	1
- 22	2322511-28 - - - -		. . SUPPORT-OUTER INBD TRACK									
			WING RH - - - - -								S	1
- 22A	2322511-40 - - - -		. . SUPPORT-OUTER INBD TRACK									
			WING RH - - - - -								AY	1
- 22B	2322511-54 - - - -		. . SUPPORT-OUTER INBD TRACK									
			WING RH - - - - -								BE	1
28	CONFIGURATION A - -		. SUPPORT ASSY-OUTBD TRACK LH									
			WING MATCHED SET ORDER									
			ALL DETAIL PARTS									
			FOR SPARES USE									
			CONFIGURATION B - - - - -								Z	1
28A	CONFIGURATION B - -		. SUPPORT ASSY-OUTBD TRACK LH									
			WING MATCHED SET ORDER									
			ALL DETAIL PARTS									
			FOR SPARES USE									
			CONFIGURATION C - - - - -								Z	1
28B	CONFIGURATION C - -		. SUPPORT ASSY-OUTBD TRACK LH									
			WING MATCHED SET ORDER									
			ALL DETAIL PARTS - - - - -								A	1
- 29	2322512-17 - - - -		. . SUPPORT-INNER OUTBD TRACK									
			WING LH - - - - -								T	1
- ITEM NOT ILLUSTRATED			A - - - ATTACHING PARTS									



LEARJET 24

ILLUSTRATED PARTS CATALOG

FIG
57-42-10
PAGE 3
DEC 23/99



LEARJET 24
ILLUSTRATED PARTS CATALOG

FIG ITEM	PART NUMBER	SYM BOL	NOMENCLATURE								EFF CODE	UNITS PER ASSY
			1	2	3	4	5	6	7	8		
			VENDOR	
10 - 66	CTA-27X-41 - - - -		.	FOLLOWER-CAM						VO7484		
- 67	CR-7/8-27X-41 - - -		.	ALT FOR CF-7/8-S-CP - - - -							A	8
			.	FOLLOWER-CAM						VO7484		
- 67A	CR-7/8-X-41 - - - -		.	ALT FOR CF-7/8-S-CP - - - -							A	8
			.	FOLLOWER-CAM						VO7484		
68	MS20364-624 - - - -	A	.	ALT FOR CF-7/8-S-CP - - - -							A	8
69	AN960-616 - - - -	A	.	NUT - - - - -							A	8
72	2322511-7 - - - -		.	WASHER - - - - -							A	8
			.	TRACK-NOSE ROLLER INBD TRACK								
				WHEN EXHTD USE 2322511-27 - - - -							Z	2
73	2322511-27 - - - -		.	TRACK-NOSE ROLLER INBD TRACK - - - -							A	2
75	2322511-8 - - - -		.	CAP-AFT INBD TRACK - - - - -							A	2
77	AN4-36A - - - -		.	BOLT - - - - -							A	6
79	AN960-416 - - - -		.	WASHER - - - - -							A	6
81	MS20365-428 - - - -		.	NUT - - - - -							A	6
83	2322511-9 - - - -		.	CAP-FORWARD - - - - -							A	2
85	AN4-33A - - - -		.	BOLT - - - - -							A	2
87	AN960-416 - - - -		.	WASHER - - - - -							A	2
89	MS20365-428 - - - -		.	NUT - - - - -							A	2
90	2322512-7 - - - -		.	TRACK-NOSE ROLLER OUTBD TRACK								
				WHEN EXHTD USE 2322512-13 - - - -							Z	2
92	2322512-13 - - - -		.	TRACK-NOSE ROLLER OUTBD TRACK - - - -							A	2
94	2322513-2 - - - -		.	BUTTON - - - - -							A	8
96	2322512-8 - - - -		.	CAP-AFT - - - - -							A	2
98	AN4-34A - - - -		.	BOLT - - - - -							A	6
100	AN960-416 - - - -		.	WASHER - - - - -							A	6
102	MS20365-428 - - - -		.	NUT - - - - -							A	6
104	2322512-9 - - - -		.	CAP-FORWARD - - - - -							A	2
106	AN4-30A - - - -		.	BOLT - - - - -							A	2
108	AN960-416 - - - -		.	WASHER - - - - -							A	2
110	MS20365-428 - - - -		.	NUT - - - - -							A	2
112	2322513-2 - - - -		.	BUTTON INBD SIDE OF OUTBD FLAP								
				TRACK NOTE 2322513-1 MAY								
				BE USED IN LIEU OF								
				2322513-2 TO CONTROL END								
				PLAY - - - - -							A	4
-113	2322513-1 - - - -		.	BUTTON INBD SIDE OF OUTBD FLAP								
				TRACK ALT FOR 2322513-2 - - - -							A	4
114	2322513-2 - - - -		.	BUTTON OUTBD SIDE OF OUTBD								
				FLAP TRACK - - - - -							A	4
120	2322516-5 - - - -		.	BRACKET ASSY-FLAP SECTOR LOWER								
				LH								
				FOR SPARES USE 2322516-145 - - - -							Z	1
120A	2322516-145 - - - -		.	BRACKET ASSY-FLAP SECTOR LOWER								
				LH								
				FOR SPARES USE 2322516-181 - - - -							Z	1
120B	2322516-181 - - - -		.	BRACKET ASSY-FLAP SECTOR LOWER								
				LH - - - - -							A	1
-121	2322516-5 - - - -		.	BRACKET ASSY-FLAP SECTOR LOWER								
				RH								
				FOR SPARES USE 2322516-145 - - - -							Z	1
-121A	2322516-145 - - - -		.	BRACKET ASSY-FLAP SECTOR LOWER								
				RH								
				FOR SPARES USE 2322516-182 - - - -							Z	1
-121B	2322516-182 - - - -		.	BRACKET ASSY-FLAP SECTOR LOWER								
				RH - - - - -							A	1
122	2322516-213 - - - -		.	WELDMENT ASSY-FLAP SECTOR								
				BRACKET UPPER LH								
				WHEN EXHTD USE 2322516-219 - - - -							Z	1
123	2322516-219 - - - -		.	WELDMENT ASSY-FLAP SECTOR								
				BRACKET UPPER LH								
				WHEN EXHTD USE 2322516-257 - - - -							Z	1
123A	2322516-257 - - - -		.	WELDMENT ASSY-FLAP SECTOR								
				BRACKET UPPER LH - - - - -							BU	1
123B	6022511-801 - - - -		.	BRACKET ASSY-FLAP SECTOR UPPER								
				LH - - - - -							BL	1
-124	2322516-214 - - - -		.	WELDMENT ASSY-FLAP SECTOR								

-ITEM NOT ILLUSTRATED

A - - - ATTACHING PARTS



LEARJET 24
ILLUSTRATED PARTS CATALOG

FIG ITEM	PART NUMBER	SYMBOL	NOMENCLATURE								EFF CODE	UNITS PER ASSY	
			1	2	3	4	5	6	7	8			
			VENDOR		
10													
-125	2322516-218 - - - -										Z	1	
-125A	2322516-256 - - - -										Z	1	
-125B	6022511-802 - - - -										BU	1	
125N	NAS696A5 - - - - -										BL	1	
-125P	NAS697A5 - - - - -										BU	2	
125Q	MS21072L5 - - - - -										BU	2	
125T	2381440-801 - - - -										BR	2	
126	2325079-3 - - - - -										BQ	2	
128	2325079-11 - - - -										Z	1	
128A	2325079-17 - - - -										Z	1	
-130	2325079-4 - - - - -										A	1	
-132	2325079-12 - - - -										Z	1	
-132A	2325079-18 - - - -										Z	1	
-133	HL18-5-5 - - - - -										A	1	
-133C	HL70-5 - - - - -										BL	8	
134	2325080-11 - - - -										BL	8	
-136	2325080-14 - - - -										V	1	
-137	2425081-1 - - - - -												
138	MS20004-5 - - - - -										F	1	
-139	MS20004H5 - - - - -										AA	1	
-140	NAS464P3A3 - - - -										AA	1	
-141	NAS464P3A4 - - - -										A	1	
142	AN960D416L - - - -										A	1	
-143	AN960D10 - - - - -										A	1	
144	NAS1598-4R - - - -										A	2	
-145	NAS1598-3R - - - -										A	1	
146	MS21042-4 - - - - -										A	2	
-147	MS21042-3 - - - - -										A	1	
-150	2325080-12 - - - -										A	2	
-151	2325040-43 - - - -										G	1	
-152	2425081-2 - - - - -										H	1	
153	2325080-13 - - - -										J	1	
-154	2325080-15 - - - -										G	1	
-155	2425081-4 - - - - -										H	1	
-156	2325068-1 - - - - -										J	1	
-157	2425081-3 - - - - -										H	1	
158	2325040-41 - - - -										J	1	
158A	2325040-53 - - - -										E	1	
159D	2325040-69 - - - -										Z	1	
159E	2325040-71 - - - -										Z	1	
162	2325080-31 - - - -										BH	1	
163	2325080-41 - - - -										K	1	
164	2625027-1 - - - - -										Z	1	
165	2625027-5 - - - - -										Z	1	
166	2625027-7 - - - - -										Z	1	
-168	2325080-32 - - - -										L	1	
-170	2325080-43 - - - -										K	1	
											L	1	

-ITEM NOT ILLUSTRATED

A - - - ATTACHING PARTS

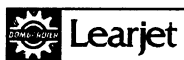

LEARJET 24
ILLUSTRATED PARTS CATALOG

FIG ITEM	PART NUMBER	SYMBOL	NOMENCLATURE								EFF CODE	UNITS PER ASSY
			1	2	3	4	5	6	7	8		
				
10 172	2325040-19 - - - -		.	BRACKET ASSY								
				FOR SPARES USE 2625038-1 &								
				ATTACHING PARTS NAS464P3A4								
				BOLT, AN960D10 WASHER &								
				MS21042-3 NUT - - - - -							Z	1
174	2325040-57 - - - -		.	BRACKET ASSY								
				FOR SPARES USE 2625038-1 &								
				ATTACHING PARTS NAS464P3A4								
				BOLT, AN960D10 WASHER &								
				MS21042-3 NUT - - - - -							Z	1
175	2625038-1 - - - -		.	BRACKET ASSY								
				FOR SPARES USE 2625038-2 - - - -							Z	1
176	2625038-2 - - - -		.	BRACKET ASSY							A	1
178	NAS333CP21 - - - -		A	SCREW - - - - -							A	1
179	NAS333CP17 - - - -		A	SCREW - - - - -							A	1
180	2325080-17 - - - -		A	SPACER - - - - -							D	1
181	2325080-35 - - - -		A	SPACER - - - - -							N	1
182	2325080-16 - - - -		A	SPACER - - - - -							D	1
183	2325080-34 - - - -		A	SPACER - - - - -							N	1
185	AN960D10 - - - -		A	WASHER - - - - -							A	2
187	AN310-3 - - - -		A	NUT - - - - -							A	2
189	MS24665-132 - - - -		A	PIN-COTTER - - - - -							A	2
191	2325040-50 - - - -		A	FILLER - - - - -							A	1
-192	NAS464P3A4 - - - -		A	BOLT - - - - -							AC	3
-192A	NAS464P3A4 - - - -		A	BOLT - - - - -							AD	2
-192G	AN960D10 - - - -		A	WASHER - - - - -							AC	3
-192H	AN960D10 - - - -		A	WASHER - - - - -							AD	2
-192R	MS21042-3 - - - -		A	NUT - - - - -							AC	3
-192S	MS21042-3 - - - -		A	NUT - - - - -							AD	2
193	2325080-21 - - - -		.	PLATE-PULLEY CTR SECTION LH - - - -							A	2
194	2325080-20 - - - -		.	ANGLE-PULLEY CTR SECTION LH - - - -							P	1
196	2325080-44 - - - -		.	ANGLE-PULLEY CTR SECTION LH								
				WHEN EXHTD USE 2325080-52 - - - -							Z	1
197	2325080-52 - - - -		.	ANGLE-PULLEY CTR SECTION LH - - - -							Q	1
198	2325080-19 - - - -		.	BRACKET-PULLEY CTR SECTION RH - - - -							A	1
-200	NAS464P4A5 - - - -		A	BOLT - - - - -							A	1
-201	AN960D416 - - - -		A	WASHER - - - - -							A	1
-202	2325040-42 - - - -		A	FILLER - - - - -							A	1
-203	MS20365-428 - - - -		A	NUT - - - - -							A	1
-450			.	REFERENCED ITEMS								
451	RF27-52 FOR NHA - -		.	CONTROL CABLES INSTL-WING								
				FLAP INTERCONNECT - - - - -							Y	RF
		EFF CODES		INTERPRETATION								
		A		24-100 & SUBQ								
		D		24-100 THRU 194								
		E		24-100 THRU 193								
		F		24-194 & SUBQ								
		G		PART OF FIG ITEM #134 & SUBQ LH								
				OUTBD FLAP CABLE BRACKET ASSYS								
		H		PART OF FIG ITEM #136 RH OUTBD								
				FLAP CABLE BRACKET ASSY								
		J		PART OF FIG ITEM #137 & SUBQ RH								
				OUTBD FLAP CABLE BRACKET ASSYS								
		K		24-100 THRU 328								
		L		24-329 & SUBQ								
		N		24-195 & SUBQ								
		P		24-100 THRU 328								
		Q		24-329 & SUBQ								
		R		PART OF FIG ITEM #14 SUPPORT ASSY								
		S		PART OF FIG ITEM #20 SUPPORT ASSY								
		T		PART OF FIG ITEM #28 SUPPORT ASSY								
		U		PART OF FIG ITEM #38 SUPPORT ASSY								
		V		24-100 & SUBQ								
-ITEM NOT ILLUSTRATED			A - - - ATTACHING PARTS									



LEARJET 24
ILLUSTRATED PARTS CATALOG

FIG ITEM	PART NUMBER	SYMBOL	NOMENCLATURE								EFF CODE	UNITS PER ASSY
			1	2	3	4	5	6	7	8		
			VENDOR	
10	Y		SEE TABLE OF CONTENTS OF REF									
			CHAPTER & SECTION FOR									
			APPLICABLE NHA FIGURE									
	Z		SUPERSEDED PART INACTIVE SPARE									
	AA		24-100 & SUBQ									
	AC		USE WITH 2625038-1 BRACKET ASSY									
	AD		USE WITH 2625038-2 BRACKET ASSY									
	AV		PART OF FIG ITEM #28A SUPPORT									
			ASSY									
	AW		PART OF FIG ITEM #38A SUPPORT									
			ASSY									
	AX		PART OF FIG ITEM #14A SUPPORT									
			ASSY									
	AY		PART OF FIG ITEM #20A SUPPORT									
			ASSY									
	BD		PART OF FIG ITEM #14B SUPPORT									
			ASSY									
	BE		PART OF FIG ITEM #20B SUPPORT									
			ASSY									
	BF		PART OF FIG ITEM #28B SUPPORT									
			ASSY									
	BG		PART OF FIG ITEM #38B SUPPORT									
			ASSY									
	BH		24-194 & SUBQ									
	BJ		24-100 THRU 357 EXCEPT A/C MOD BY									
			A 2392018 KIT PER									
			SB 23/24/25-57-1 INSTRUCTIONS									
	BL		24-100 & SUBQ WHEN MOD BY A									
			2392018 KIT PER SB 23/24/25-57									
			-1 INSTRUCTIONS									
	BQ		24-100 & SUBQ WHEN MOD BY 2392018									
			-804 KIT PER SB 23/24/25-57-1									
			INSTR OR MOD BY A 2381439 KIT									
			PER SB 23/24/25-27-10 INSTR									
	BR		24-100 & SUBQ WHEN MOD BY A									
			2392018 KIT PER SB 23/24/25-57									
			-1 INSTRUCTIONS									
-ITEM NOT ILLUSTRATED			A - - - ATTACHING PARTS									

R
R
R
R
R
R
R
R
R
R
R



LEARJET 24
ILLUSTRATED PARTS CATALOG

SEE FIG ITEM #450 FOR
REFERENCED ITEMS

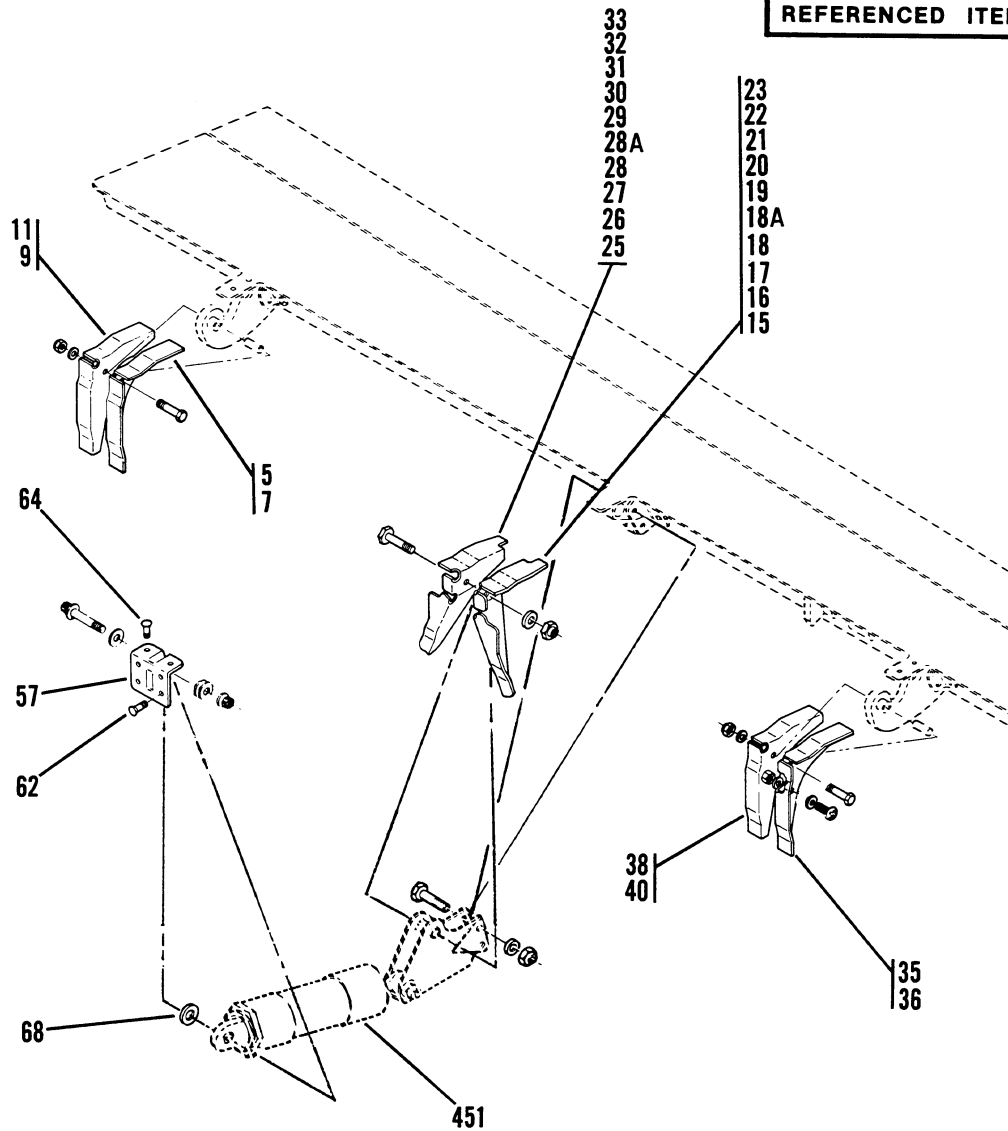

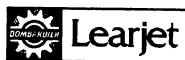

LEARJET 24
ILLUSTRATED PARTS CATALOG

FIG ITEM	PART NUMBER	SYMBOL	NOMENCLATURE								EFF CODE	UNITS PER ASSY
			1	2	3	4	5	6	7	8		
			VENDOR	
05 - 1	RF57-02-02 FOR NHA		BRACKETS INSTL-SPOILER HINGE & CONTROLS SPRT WING LH & RH - - -								A	RF
5	2322514-5 - - - -		. BRACKET-HINGE INBD LH OUTBD & RH INBD FOR SPARES USE 2322514-11 - - - -								Z	2
7	2322514-11 - - - -		. BRACKET-HINGE INBD LH OUTBD & RH INBD - - - - -								A	2
9	2322514-6 - - - -		. BRACKET-HINGE INBD LH INBD & RH OUTBD FOR SPARES USE 2322514-12 - - - -								Z	2
11	2322514-12 - - - -		. BRACKET-HINGE INBD LH INBD & RH OUTBD - - - - -								A	2
15	2322514-3 - - - -		. BRACKET-HINGE MIDDLE LH OUTBD & RH INBD FOR SPARES USE 2481131-1 RF ITEM #400 - - - -								Z	2
16	2322514-9 - - - -		. BRACKET-HINGE MIDDLE LH OUTBD & RH INBD FOR SPARES USE 2481131-1 RF ITEM #400 - - - -								Z	2
17	2422514-1 - - - -		. BRACKET-HINGE MIDDLE LH OUTBD & RH INBD FOR SPARES USE 2422514-29 - - - -								Z	2
18	2422514-15 - - - -		. BRACKET-HINGE MIDDLE LH OUTBD & RH INBD FOR SPARES USE 2422514-29 - - - -								Z	2
18A	2422514-29 - - - -		. BRACKET-HINGE MIDDLE LH OUTBD & RH INBD - - - - -								C	2
19	2422514-11 - - - -		. BRACKET-HINGE MIDDLE LH OUTBD & RH INBD FOR SPARES USE 2422514-25 - - - -								Z	2
20	2422514-25 - - - -		. BRACKET-HINGE MIDDLE LH OUTBD & RH INBD FOR SPARES USE 2422514-33 - - - -								Z	2
21	2422514-33 - - - -		. BRACKET-HINGE MIDDLE LH OUTBD & RH INBD FOR SPARES USE 2422514-39 - - - -								Z	2
22	2422514-39 - - - -		. BRACKET-HINGE MIDDLE LH OUTBD & RH INBD FOR SPARES USE 2422514-43 - - - -								Z	2
23	2422514-43 - - - -		. BRACKET-HINGE MIDDLE LH OUTBD & RH INBD - - - - -								K	2
25	2322514-4 - - - -		. BRACKET-HINGE MIDDLE LH INBD & RH OUTBD FOR SPARES USE 2481131-1 RF ITEM #400 - - - -								Z	2
26	2322514-10 - - - -		. BRACKET-HINGE MIDDLE LH INBD & RH OUTBD FOR SPARES USE 2481131-1 RF ITEM #400 - - - -								Z	2
27	2422514-2 - - - -		. BRACKET-HINGE MIDDLE LH INBD & RH OUTBD FOR SPARES USE 2422514-30 - - - -								Z	2
28	2422514-16 - - - -		. BRACKET-HINGE MIDDLE LH INBD & RH OUTBD FOR SPARES USE 2422514-30 - - - -								Z	2
28A	2422514-30 - - - -		. BRACKET-HINGE MIDDLE LH INBD & RH OUTBD - - - - -								C	2
29	2422514-12 - - - -		. BRACKET-HINGE MIDDLE LH INBD & RH OUTBD FOR SPARES USE 2422514-26 - - - -								Z	2
30	2422514-26 - - - -		. BRACKET-HINGE MIDDLE LH INBD & RH OUTBD FOR SPARES USE 2422514-34 - - - -								Z	2
31	2422514-34 - - - -		. BRACKET-HINGE MIDDLE LH INBD & RH INBD FOR SPARES USE 2422514-40 - - - -								Z	2
32	2422514-40 - - - -		. BRACKET-HINGE MIDDLE LH INBD & RH OUTBD FOR SPARES USE 2422514-44 - - - -								Z	2
33	2422514-44 - - - -		. BRACKET-HINGE MIDDLE LH INBD									
-ITEM NOT ILLUSTRATED			A - - - ATTACHING PARTS									

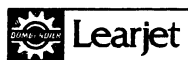

LEARJET 24
ILLUSTRATED PARTS CATALOG

FIG ITEM	PART NUMBER	SYM BOL	NOMENCLATURE								EFF CODE	UNITS PER ASSY	
			1	2	3	4	5	6	7	8			
			VENDOR			
O5	35	2322514-1 - - - -	& RH OUTBD - - - - -	K	2
			BRACKET-HINGE OUTBD LH OUTBD		
			& RH INBD		
			FOR SPARES USE 2322514-7 - - - -	Z	2
	36	2322514-7 - - - -	BRACKET-HINGE OUTBD LH OUTBD		
			& RH INBD - - - - -	A	2
	38	2322514-2 - - - -	BRACKET-HINGE OUTBD LH INBD		
			& RH OUTBD		
			FOR SPARES USE 2322514-8 - - - -	Z	2
	40	2322514-8 - - - -	BRACKET-HINGE OUTBD LH INBD		
			& RH OUTBD - - - - -	A	2
	57	2422513-1 - - - -	FITTING ASSY-SPOILER ACTUATOR		
			FORWARD ATTACH LH & RH - - - -	G	2
	62	HL20-6-5 - - - -	A	PIN- HI-LOK - - - - - V73197	G	8
	64	HL21-6-6 - - - -	A	PIN- HI-LOK - - - - - V73197	G	4
- 66	HL86-6 - - - -	A	COLLAR- HI-LOK - - - - - V73197	G	12	
68	NAS77-4-06 - - - -	BUSHING - - - - -	J	1	
-400	2481131-1 - - - -	KIT-REPLACEMENT FOR SPOILER			
		CENTER HINGE BRACKET RF			
		AMK75-3 - - - - -	H	1	
-450			REFERENCED ITEMS		
451	RF27-62 FOR NHA - -	ACTUATOR INSTL-WING SPOILER		
		LH & RH - - - - -	Y	RF
EFF CODES			INTERPRETATION										
		A	24-100 & SUBQ										
		C	24-303 THRU 306, 318 THRU 322 & A/C MOD BY 2481131-1 KIT PER AMK75-3 INSTR										
		G	24-178 & SUBQ & PREV A/C THAT HAVE A 2397002 SPEC SPARE KIT INSTLD PER SSK955 INSTR										
		H	24-100 THRU 302 & 309 THRU 317										
		J	PART OF FIG ITEM #57 & SUBQ FITTING ASSYS										
		K	24-307, 308, 323 & SUBQ										
		Y	SEE TABLE OF CONTENTS OF REF CHAPTER & SECTION FOR APPLICABLE NHA FIGURE										
		Z	SUPERSEDED PART INACTIVE SPARE										
-ITEM NOT ILLUSTRATED			A - - - ATTACHING PARTS										

SEE FIG ITEM #450 FOR
REFERENCED ITEMS

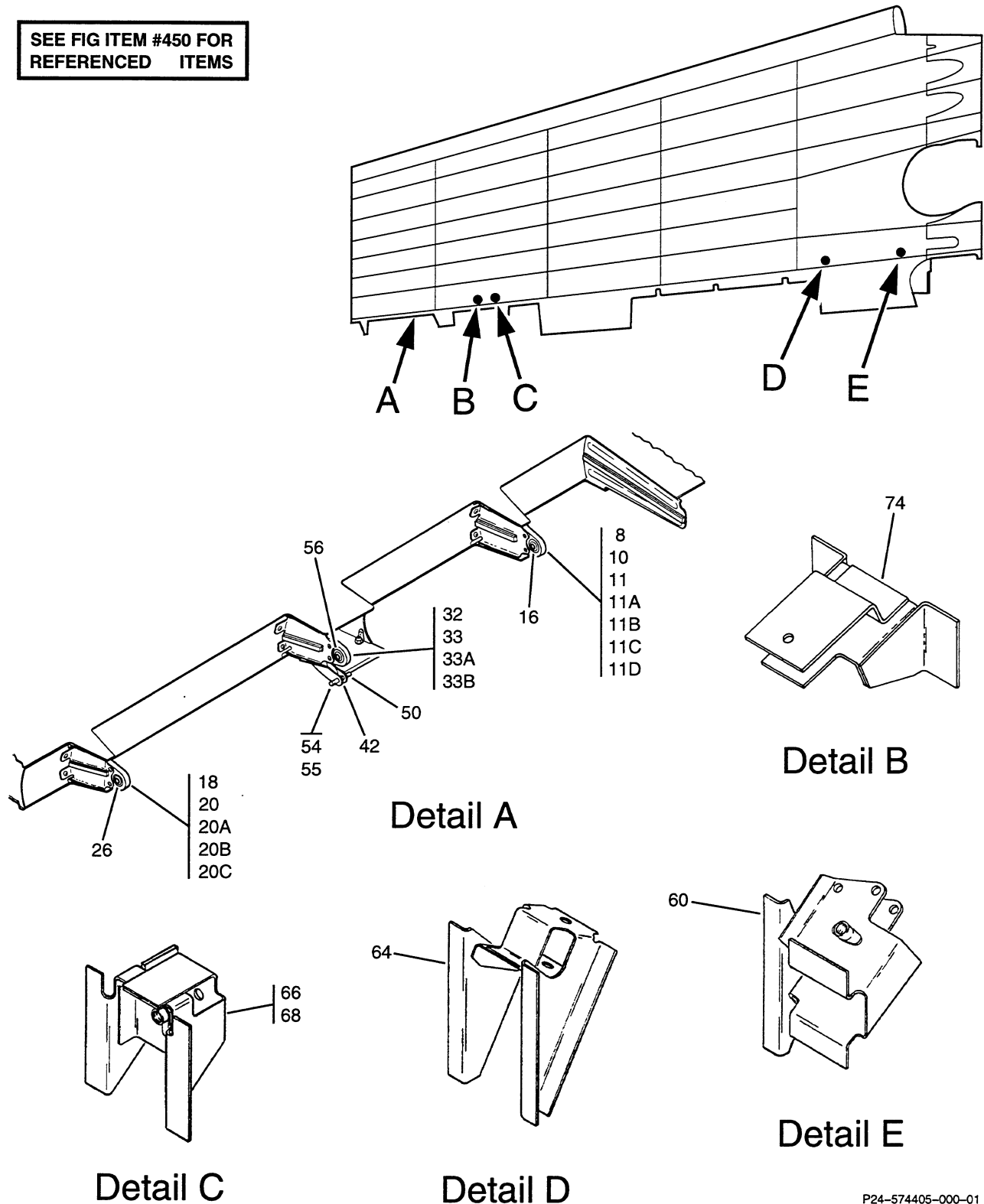



LEARJET 24
ILLUSTRATED PARTS CATALOG

FIG ITEM	PART NUMBER	SYMBOL	NOMENCLATURE								EFF CODE	UNITS PER ASSY
			1	2	3	4	5	6	7	8		
			VENDOR									
05 - 1	RF57-02-02 FOR NHA		BRACKETS INSTL-AILERON HINGE & CONTROLS SPRT WING LH & RH - - -								A	RF
8	2322530-3 - - - -		. BRACKET ASSY-HNG INBD LH & RH WHEN EXHTD USE 2322530-39 LH OR 2322530-40 RH - - - -								Z	2
10	2322530-39 - - - -		. BRACKET ASSY-HINGE INBD LH WHEN EXHTD USE 2322530-55 - - - -								Z	1
11	2322530-55 - - - -		. BRACKET ASSY-HINGE INBD LH WHEN EXHTD USE 2322530-59 - - - -								Z	1
11A	2322530-59 - - - -		. BRACKET ASSY-HINGE INBD LH WHEN EXHTD USE 2322530-67 - - - -								Z	1
11B	2322530-67 - - - -		. BRACKET ASSY-HINGE INBD LH WHEN EXHTD USE 2322530-81 - - - -								Z	1
11C	2322530-81 - - - -		. BRACKET ASSY-HINGE INBD LH FOR SPARES USE 2322530-805 - - - -								Z	1
11D	2322530-805 - - - -		. BRACKET ASSY-HINGE INBD LH - - - -								A	1
- 12	2322530-40 - - - -		. BRACKET ASSY-HINGE INBD RH WHEN EXHTD USE 2322530-56 - - - -								Z	1
- 13	2322530-56 - - - -		. BRACKET ASSY-HINGE INBD RH WHEN EXHTD USE 2322530-60 - - - -								Z	1
- 13A	2322530-60 - - - -		. BRACKET ASSY-HINGE INBD RH WHEN EXHTD USE 2322530-68 - - - -								Z	1
- 13B	2322530-68 - - - -		. BRACKET ASSY-HINGE INBD RH WHEN EXHTD USE 2322530-82 - - - -								Z	1
- 13C	2322530-82 - - - -		. BRACKET ASSY-HINGE INBD RH FOR SPARES USE 2322530-806 - - - -								Z	1
- 13D	2322530-806 - - - -		. BRACKET ASSY-HINGE INBD RH - - - -								A	1
- 14	6950-S-04-6 - - - -	A	. PIN-DRIVE - - - - - V97928								A	2
16	MS27645-4 - - - -		. . BEARING - - - - -								L	1
- 17	MS27645-4G - - - -		. . BEARING - - - - -								L	1
18	2322530-4 - - - -		. BRACKET ASSY-HNG OUTBD LH & RH WHEN EXHTD USE 2322530-41 LH OR 2322530-42 RH - - - -								Z	2
20	2322530-41 - - - -		. BRACKET ASSY-HINGE OUTBD LH FOR SPARES USE 2322530-63 - - - -								Z	1
20A	2322530-63 - - - -		. BRACKET ASSY-HINGE OUTBD LH WHEN EXHTD USE 2322530-75 - - - -								Z	1
20B	2322530-75 - - - -		. BRACKET ASSY-HINGE OUTBD LH WHEN EXHTD USE 2322530-801 - - - -								Z	1
20C	2322530-801 - - - -		. BRACKET ASSY-HINGE OUTBD LH - - - -								A	1
- 22	2322530-42 - - - -		. BRACKET ASSY-HINGE OUTBD RH FOR SPARES USE 2322530-64 - - - -								Z	1
- 22A	2322530-64 - - - -		. BRACKET ASSY-HINGE OUTBD RH WHEN EXHTD USE 2322530-76 - - - -								Z	1
- 22B	2322530-76 - - - -		. BRACKET ASSY-HINGE OUTBD RH WHEN EXHTD USE 2322530-802 - - - -								Z	1
- 22C	2322530-802 - - - -		. BRACKET ASSY-HINGE OUTBD RH - - - -								A	1
- 24	6950-S-04-6 - - - -	A	. PIN-DRIVE - - - - - V97928								A	2
26	MS27645-4 - - - -		. . BEARING - - - - -								M	1
- 27	MS27645-4G - - - -		. . BEARING - - - - -								M	1
32	2322530-27 - - - -		. BRACKET ASSY-HINGE MIDDLE LH WHEN EXHTD USE 2322530-51 - - - -								Z	1
33	2322530-51 - - - -		. BRACKET ASSY-HINGE MIDDLE LH WHEN EXHTD USE 2322530-89 - - - -								Z	1
33A	2322530-89 - - - -		. BRACKET ASSY-HINGE MIDDLE LH FOR SPARES USE 2322530-807 - - - -								Z	1
33B	2322530-807 - - - -		. BRACKET ASSY-HINGE MIDDLE LH - - - -								C	1
- 36	2322530-28 - - - -		. BRACKET ASSY-HINGE MIDDLE RH WHEN EXHTD USE 2322530-52 - - - -								Z	1
- 37	2322530-52 - - - -		. BRACKET ASSY-HINGE MIDDLE RH WHEN EXHTD USE 2322530-90 - - - -								Z	1
- 37A	2322530-90 - - - -		. BRACKET ASSY-HINGE MIDDLE RH FOR SPARES USE 2322530-808 - - - -								Z	1
- 37B	2322530-808 - - - -		. BRACKET ASSY-HINGE MIDDLE RH - - - -								C	1
- 38	6950-S-04-6 - - - -	A	. PIN-DRIVE - - - - - V97928								A	2
-ITEM NOT ILLUSTRATED			A - - - ATTACHING PARTS									

-ITEM NOT ILLUSTRATED

A - - - ATTACHING PARTS

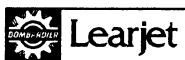

LEARJET 24
ILLUSTRATED PARTS CATALOG

FIG ITEM	PART NUMBER	SYMBOL	NOMENCLATURE								EFF CODE	UNITS PER ASSY
			1	2	3	4	5	6	7	8		
				
05 42	2322530-29 - - - -		.	.	ANGLE	LH	-	-	-	-	E	1
- 46	2322530-30 - - - -		.	.	ANGLE	RH	-	-	-	-	F	1
50	2322530-31 - - - -		.	.	PLATE	LH	-	-	-	-	E	1
- 52	2322530-32 - - - -		.	.	PLATE	RH	-	-	-	-	F	1
54	2322530-33 - - - -		.	.	STUD							
					WHEN EXHTD USE 2322530-53						Z	1
55	2322530-53 - - - -		.	.	STUD						H	1
56	MS27645-4 - - - -		.	.	BEARING						J	1
- 57	MS27645-4G - - - -		.	.	BEARING							
					ALT FOR MS27645-4						J	1
60	2324505-23 - - - -		.		BRACKET ASSY-AILERON PULLEY						V	1
- 62	2324505-24 - - - -		.		BRACKET ASSY-AILERON PULLEY						V	1
64	2324505-6 - - - -		.		BRACKET ASSY-AILERON PULLEY						V	2
66	2324505-29 - - - -		.		BRACKET ASSY-AILERON PULLEY							
					CABLE LH						Z	1
					WHEN EXHTD USE 2324505-39							
68	2324505-39 - - - -		.		BRACKET ASSY-AILERON PULLEY						V	1
- 70	2324505-30 - - - -		.		BRACKET ASSY-AILERON PULLEY							
					CABLE RH							
					WHEN EXHTD USE 2324505-40						Z	1
- 72	2324505-40 - - - -		.		BRACKET ASSY-AILERON PULLEY						V	1
74	2424034-1 - - - -		.		BRACKET ASSY-AILERON PULLEY						N	2
					CABLE LH & RH							
-450			.		REFERENCED ITEMS							
-452	RF27-13 FOR NHA - -		.	.	CONTROL CABLES INSTL-AILERON						Y	RF
EFF CODES			INTERPRETATION									
		A	24-100 & SUBQ									
		C	24-100 & SUBQ									
		E	PART OF FIG ITEM #32 & SUBQ LH									
			MIDDLE BRACKET ASSYS									
		F	PART OF FIG ITEM #36 & SUBQ RH									
			MIDDLE BRACKET ASSYS									
		H	PART OF FIG ITEM #32 & SUBQ LH &									
			#36 & SUBQ RH MIDDLE BRACKET									
			ASSYS									
		J	PART OF FIG ITEM #32 & SUBQ LH &									
			#36 & SUBQ RH MIDDLE BRACKET									
			ASSYS									
		L	PART OF FIG ITEM #8 & SUBQ LH &									
			RH INBD HINGE BRACKET ASSYS									
		M	PART OF FIG ITEM #18 & SUBQ LH &									
			RH OUTBD HINGE BRACKET ASSYS									
		N	24-349 & SUBQ & PREV A/C MOD BY									
			2381405-1 KIT PER AMK77-1 INSTR									
		Y	SEE TABLE OF CONTENTS OF REF									
			CHAPTER & SECTION FOR									
			APPLICABLE NHA FIGURE									
		Z	SUPERSEDED PART INACTIVE SPARE									
-ITEM NOT ILLUSTRATED			A - - - ATTACHING PARTS									

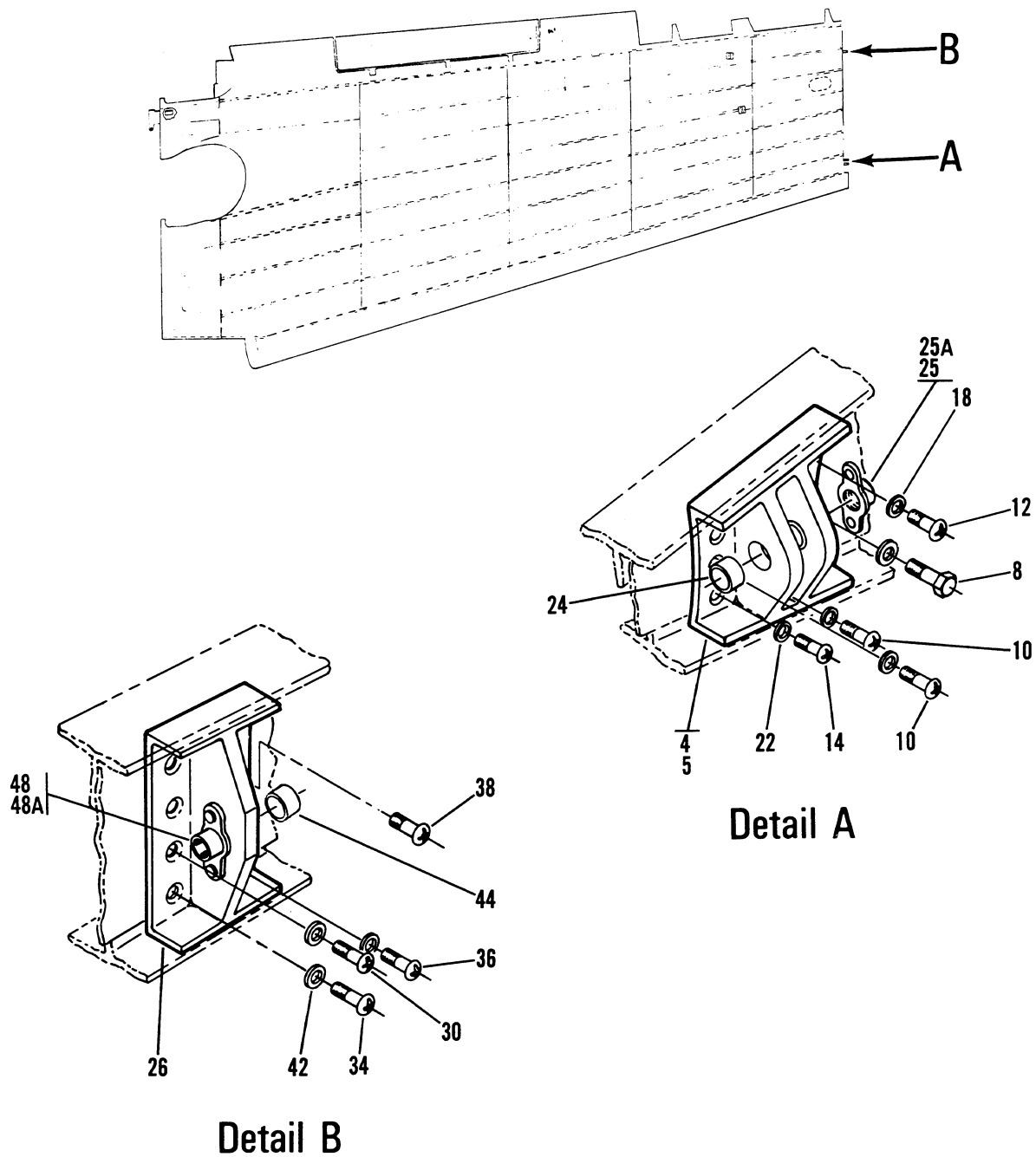

4-26C-1
A4-34C
B4-34C

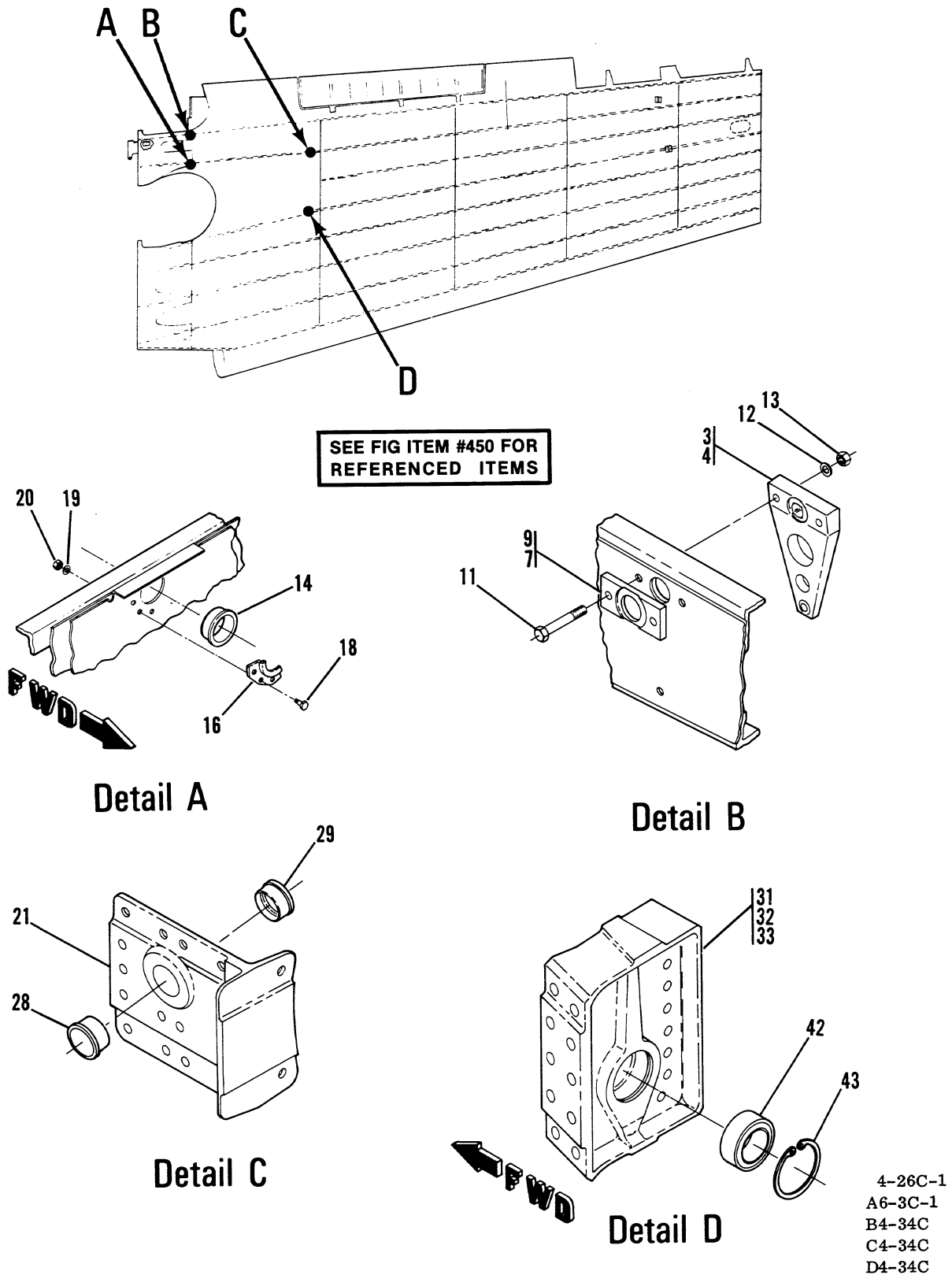



LEARJET 24
ILLUSTRATED PARTS CATALOG

FIG ITEM	PART NUMBER	SYMBOL	NOMENCLATURE								EFF CODE	UNITS PER ASSY
			1	2	3	4	5	6	7	8		
			VENDOR	
05 - 1	RF57-02-02 FOR NHA		SUPPORTS & BRACKETS INSTL-LANDING									
			GEAR WING LH & RH - - - - -								A	RF
3	2322221-1 - - - - -		. SUPPORT-MAIN GEAR ACTUATOR									
			PILLAR AFT LH									
			FOR SPARES USE 2322221-3 - - - - -								Z	1
4	2322221-3 - - - - -		. SUPPORT-MAIN GEAR ACTUATOR									
			PILLAR AFT LH - - - - -								E	1
- 5	2322221-2 - - - - -		. SUPPORT-MAIN GEAR ACTUATOR									
			PILLAR AFT RH									
			FOR SPARES USE 2322221-4 - - - - -								Z	1
- 6	2322221-4 - - - - -		. SUPPORT-MAIN GEAR ACTUATOR									
			PILLAR AFT RH - - - - -								E	1
7	2322222-1 - - - - -		. PLATE-BEARING MAIN GEAR									
			ACTUATOR PILLAR FWD LH - - - - -								B	1
9	2441007-2 - - - - -		. PLATE-BEARING MAIN GEAR									
			ACTUATOR PILLAR FWD LH - - - - -								C	1
- 10	2322222-1 - - - - -		. PLATE-BEARING MAIN GEAR									
			ACTUATOR PILLAR FWD RH - - - - -								B	1
- 10A	2441007-2 - - - - -		. PLATE-BEARING MAIN GEAR									
			ACTUATOR PILLAR FWD RH - - - - -								C	1
11	AN174-14A - - - - -	A	. BOLT - - - - -								A	3
12	AN960-416 - - - - -	A	. WASHER - - - - -								A	3
13	MS20365-428 - - - - -	A	. NUT - - - - -								A	3
14	2322187-1 - - - - -		. BUSHING-M G ACTUATOR PILLAR - - - - -								A	1
16	2422101-1 - - - - -		. COLLAR-BUSHING RETAINER - - - - -								A	1
18	AN4-10A - - - - -	A	. BOLT - - - - -								A	3
19	AN960PD416 - - - - -	A	. WASHER - - - - -								A	3
20	MS20365-428 - - - - -	A	. NUT - - - - -								A	3
21	2322204-1 - - - - -		. SUPPORT ASSY-MAIN GEAR AFT LH - - - - -								A	1
- 23	2322204-2 - - - - -		. SUPPORT ASSY-MAIN GEAR AFT RH - - - - -								A	1
- 25	AN175-10A - - - - -	A	. BOLT - - - - -								A	5
- 25C	AN175-7A - - - - -	A	. BOLT - - - - -								A	2
- 25E	AN175-11A - - - - -	A	. BOLT - - - - -								A	2
- 26	AN960PD516 - - - - -	A	. WASHER - - - - -								A	16
- 27	MS20365-524 - - - - -	A	. NUT - - - - -								A	9
- 27C	NAS1468-10 - - - - -	A	. LOCKBOLT - - - - -								A	8
- 27F	LC-CB - - - - -	A	. COLLAR - - - - - V29666								A	8
- 27J	S3LPDT-8-6 - - - - -	A	. LOCKBOLT - - - - - V29666								A	7
- 27M	6DCC8 - - - - -	A	. COLLAR - - - - - V29666								A	7
28	2322197-1 - - - - -		. . BUSHING-FWD FOR OVERSIZE									
			BUSHING REF FIG ITEM #400 - - - - -								D	1
29	2322198-1 - - - - -		. . BUSHING-AFT FOR OVERSIZE									
			BUSHING REF FIG ITEM #401 - - - - -								D	1
31	2322146-1 - - - - -		. FITTING-MAIN GEAR FWD LH									
			FOR SPARES USE 2322146-3 - - - - -								Z	1
32	2322146-3 - - - - - *		. FITTING-MAIN GEAR FWD LH									
			WHEN EXHTD USE 2322146-5 - - - - -								Z	1
33	2322146-5 - - - - - *		. FITTING-MAIN GEAR FWD LH - - - - -								G	1
- 35	2322146-2 - - - - -		. FITTING-MAIN GEAR FWD RH									
			FOR SPARES USE 2322146-4 - - - - -								Z	1
- 36	2322146-4 - - - - - *		. FITTING-MAIN GEAR FWD RH									
			WHEN EXHTD USE 2322146-6 - - - - -								Z	1
- 37	2322146-6 - - - - - *		. FITTING-MAIN GEAR FWD RH - - - - -								G	1
- 39	AN174-10A - - - - -	A	. BOLT - - - - -								A	8
- 40	AN960PD416 - - - - -	A	. WASHER - - - - -								A	8
- 41	MS20365-428 - - - - -	A	. NUT - - - - -								A	8
42	BLS-32 - - - - -		. BEARING TECHNOMAG AG, BERN,									
			SWITZERLAND - - - - -								A	1
- 42A	VTB08160 - - - - -		. BEARING ASSY - - - - - V06710									
			ALT FOR BLS-32 - - - - -								A	1
- 42B	16-577 - - - - -		. BEARING ASSY BRERNSTECHNIK AG,									
			3000 BERN 5									
			FISCHERMATTELSTRASSE									
			ALT FOR BLS-32 - - - - -								A	1
43	NAS669-200 - - - - -		. RING-INTERNAL RETAINER - - - - -								A	1
-400	2384027-2 - - - - -		. BUSHING-FWD OVERSIZE SPECIAL									
			SPARE CONTACT FIELD									
-ITEM NOT ILLUSTRATED			A - - - ATTACHING PARTS									



LEARJET 24
ILLUSTRATED PARTS CATALOG

FIG ITEM	PART NUMBER	SYMBOL	NOMENCLATURE								EFF CODE	UNITS PER ASSY
			1	2	3	4	5	6	7	8		
			VENDOR									
05												
-401	2384027-1 - - - - -		SERVICE WHEN ORDERING - - - - -								A	1
			. BUSHING-AFT OVERSIZE SPECIAL									
			SPARE CONTACT FIELD									
			SERVICE WHEN ORDERING - - - - -								A	1
-450			. REFERENCED ITEMS									
-451	RF32-33 FOR NHA - -		. . DOOR UPLATCH INSTL-MAIN GEAR									
			INBD LH & RH - - - - -								Y	RF