

## INDIVIDUAL PROJECT 2

Assignment Date : 31 October, 2012

Due Date : 09 November, 2012

### ASSIGNMENT ON USING FINITE ELEMENT SOFTWARE (TO BE DONE INDIVIDUALLY)

This project is concerned with design of a bicycle frame using aluminum tubes. The schematic dimensions of the bicycle are shown below. The following two load cases should be considered.

- (a) **Vertical loads:** When an adult rides the bike, the nominal load is estimated as a downward load of 900N at the seat position and a load of 300N at the pedal crank location. When a dynamic environment is simulated using the static analysis, the static loads are often multiplied by a dynamic load factor  $G$ . In this design project, use  $G = 2$ . Use ball-joint boundary conditions for the front dropout (location 1) and sliding boundary conditions for the rear dropouts (location 5 and 6).
- (b) **Horizontal impact:** The frame should be able to withstand a horizontal load of 1000N applied to the front dropout with rear dropouts constrained from any translational motion. For this load case, assume the front dropout can only move in the horizontal direction. Use  $G = 2$ .

Choose aluminum tubes of various diameters for the various members of the frame shown in the figure such that the bicycle is as light as possible. The minimum outside diameter is 12mm and the wall thickness is 2mm. In addition to the dynamic load factor, use a safety factor of 1.5. Use von Mises failure stress criterion for yielding.

In your report, you must include the following for each load case:

1. For each member of the frame the maximum combined stress and the safety factor.
2. Nodal deflections at each joint should be given.
3. The weight of your frame.

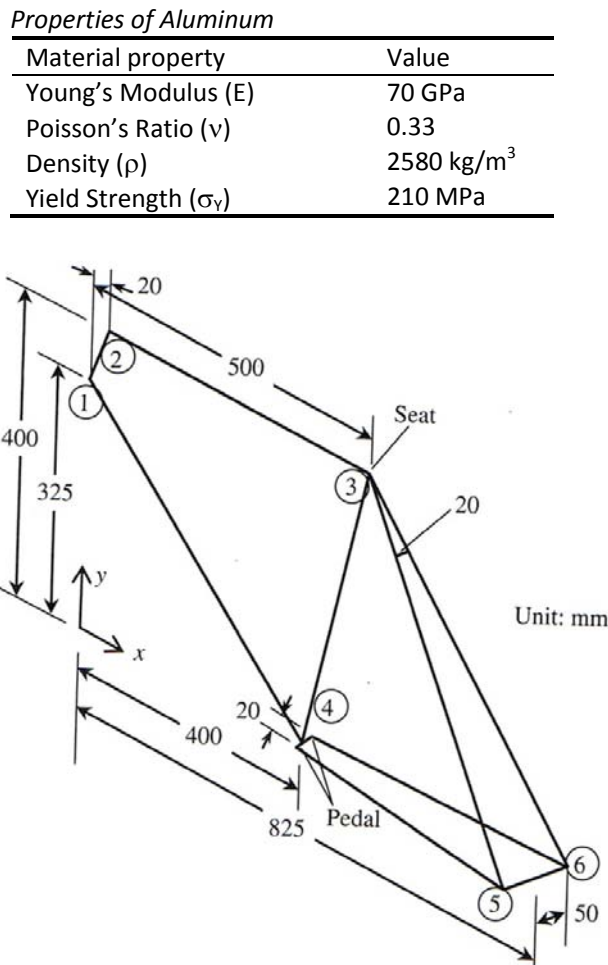



**PARKER STEEL COMPANY**  
METRIC SIZE METALS ONLY

Call for a quote or order  
**1-800-333-4140**

[Home](#)
[Products](#)
[About Us](#)
[Reference Guide](#)
[Resources](#)
[Request A Quote](#)
[Contact Us](#)
[Español](#)

## Metric Aluminum Round Tubing

### ALUMINUM

6060 T-6 (Extruded) EN 573-3, EN755-2, EN755-1, EN 755-9, DIN 1725, DIN 1746, DIN 1748



*\* All Round Tubing is Quoted OD x Wall.*

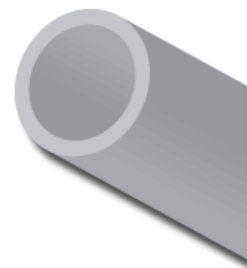

SIZE mm	WEIGHT kg/m	EST. LBS. PER FT.
8 x 1	0.060	0.040
8 x 2.5	0.119	0.080
10 x 1	0.078	0.052
10 x 2	0.138	0.093
12 x 1	0.095	0.064
12 x 1.5	0.136	0.915
12 x 2	0.173	0.116
14 x 2	0.207	0.139
15 x 1	0.121	0.081
15 x 1.5	0.175	0.118
15 x 2	0.225	0.151
16 x 1	0.130	0.087
16 x 1.5	0.188	0.127
16 x 2	0.242	0.163
16 x 3	0.337	0.227
18 x 1	0.147	0.099
18 x 1.5	0.214	0.144
18 x 2	0.276	0.186
20 x 1	0.164	0.110
20 x 1.5	0.240	0.162
20 x 2	0.311	0.209

SIZE mm	WEIGHT kg/m	EST. LBS. PER FT.
48 x 3	1.166	0.785
48 x 4	1.520	1.023
50 x 1.5	0.628	0.423
50 x 2	0.829	0.558
50 x 2.5	1.025	0.690
50 x 3	1.218	0.820
50 x 4	1.589	1.069
50 x 5	1.943	1.308
50 x 10	3.454	2.325
54 x 2	0.898	0.604
55 x 2.5	1.133	0.763
55 x 5	2.159	1.453
60 x 1.5	0.758	0.510
60 x 2	1.002	0.674
60 x 2.5	1.241	0.835
60 x 3	1.477	0.994
60 x 4	1.934	1.302
60 x 5	2.375	1.598
60 x 6	2.798	1.883
60 x 10	4.318	2.906
65 x 2	1.088	0.732

20 x 2.5	0.378	0.254	65 x 2.5	1.349	0.908
20 x 3	0.440	0.296	65 x 5	2.591	1.744
20 x 5	0.648	0.436	70 x 2	1.174	0.790
22 x 1.5	0.266	0.179	70 x 3	1.736	1.168
22 x 2	0.345	0.232	70 x 4	2.280	1.534
25 x 1.5	0.304	0.205	70 x 5	2.806	1.888
25 x 2	0.397	0.267	70 x 10	5.181	3.487
25 x 2.5	0.486	0.327	75 x 2.5	1.565	1.053
25 x 3	0.570	0.384	75 x 5	3.022	2.034
25 x 5	0.864	0.581	76 x 2.5	1.587	1.068
28 x 1.5	0.343	0.231	76 x 3	1.891	1.273
28 x 2	0.449	0.302	80 x 2	1.347	0.907
28 x 2.5	0.550	0.370	80 x 2.5	1.673	1.126
28 x 4	0.829	0.558	80 x 3	1.995	1.343
30 x 1.5	0.369	0.248	80 x 4	2.625	1.767
30 x 2	0.484	0.326	80 x 5	3.238	2.179
30 x 2.5	0.594	0.400	80 x 10	6.045	4.068
30 x 3	0.699	0.470	84 x 2	1.416	0.953
30 x 4	0.898	0.604	86 x 3	2.150	1.447
30 x 5	1.079	0.726	90 x 2	1.520	1.023
32 x 1.5	0.395	0.266	90 x 3	2.254	1.517
32 x 2	0.518	0.349	90 x 5	3.670	2.470
32 x 3	0.751	0.505	100 x 2	1.692	1.139
35 x 1.5	0.434	0.292	100 x 2.5	2.105	1.417
35 x 2	0.570	0.384	100 x 3	2.513	1.691
35 x 2.5	0.702	0.472	100 x 4	3.316	2.232
35 x 3	0.829	0.558	100 x 5	4.102	2.761
35 x 4	1.071	0.721	100 x 10	7.772	5.231
35 x 5	1.295	0.872	106 x 3	2.668	1.796
38 x 1.5	0.473	0.318	108 x 3	2.720	1.831
38 x 2	0.622	0.419	108 x 4	3.592	2.417
38 x 3	0.907	0.610	110 x 3	2.772	1.866
38 x 4	1.174	0.790	110 x 5	4.533	3.051
40 x 1.5	0.499	0.336	115 x 5	4.749	3.196
40 x 2	0.656	0.441	120 x 3	3.031	2.040
40 x 2.5	0.810	0.545	120 x 5	4.965	3.341
40 x 3	0.958	0.645	120 x 10	9.499	6.393
40 x 4	1.243	0.837	125 x 5	5.181	3.487

40 x 5	1.511	1.017
40 x 8	2.211	1.488
40 x 10	2.591	1.744
42 x 2	0.691	0.465
42 x 3	1.010	0.680
45 x 1.5	0.563	0.379
45 x 2	0.743	0.500
45 x 2.5	0.917	0.617
45 x 3	1.088	0.732
45 x 4	1.416	0.953
45 x 5	1.727	1.162
48 x 2	0.794	0.534
48 x 2.5	0.982	0.661

130 x 3	3.290	2.214
130 x 5	5.397	3.632
140 x 5	5.829	3.923
150 x 3	3.808	2.563
150 x 5	6.260	4.213
150 x 10	12.089	8.136
156 x 3	3.963	2.667
160 x 3	4.067	2.737
160 x 5	6.692	4.504
180 x 5	7.556	5.085
200 x 5	8.419	5.665
200 x 10	16.407	11.042
250 x 5	10.578	7.119

## Navigation

[Home](#)  
[New Products](#)  
[About Us](#)  
[Services](#)  
[Locations](#)  
[Request a Quote](#)  
[Contact Us](#)  
[Español](#)  
[Site Map](#)

## Follow Us



## Resources

[Purchasing](#)  
[Free Metric Ruler](#)  
[Free Metric Conversion App](#)  
[Metric Conversion Tables](#)  
[Conversion Calculators](#)  
[Industry Links](#)  
[Industry News](#)  
[Glossary](#)  
[The Metric System](#)  
[ISO Certification](#)  
[Reference Guide](#)  
[Newsletter](#)

## Legal

[View Privacy Policy](#)  
[View Copyright Statement](#)

## Products

[New Products](#)  
[Metric Round Bars](#)  
[Metric Hexagon Bars](#)  
[Metric Square Bars](#)  
[Metric Rectangular Bars](#)  
[Metric Threaded Rods](#)  
[Metric Round Tubes](#)  
[Metric Square Tubes](#)  
[Metric Rectangular Tubes](#)  
[Metric Equal Angles](#)  
[Metric Unequal Angles](#)  
[Metric Beams](#)  
[Metric Channels](#)  
[Metric Tees](#)  
[Metric Sheets And Plates](#)  
[Metric Shims](#)  
[Request a Quote](#)

## Contact Us

Parker Steel Company  
 4239 Monroe Street  
 Toledo, Ohio 43606 U.S.A.

Phone: 1+419-473-2481  
 Toll Free: 1-800-333-4140  
 Fax: 1+419-471-2655  
[sales@metricmetal.com](mailto:sales@metricmetal.com)

## Newsletter

Sign up for our email newsletter