

8 - 10 ton

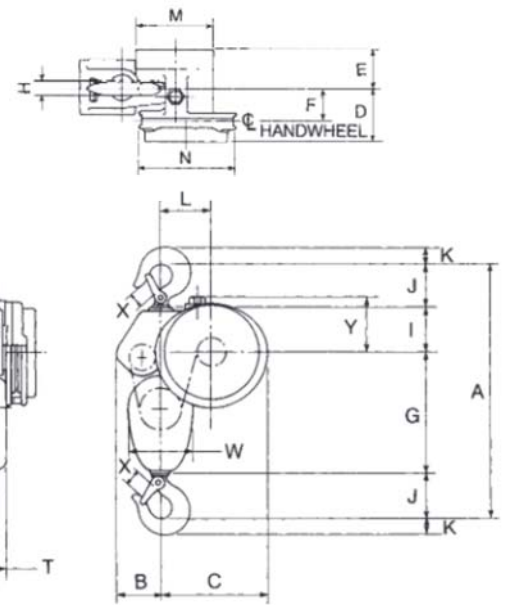

5 - 6 ton

Specifications

Rated Capacity C (tons) G	Product Code C	Standard Lift [†] (ft.) G	Reeving C	Minimum G Distance Between Hooks (in.) G	Chain Overhaul G to Lift Load One Foot (ft.) G	Chain Pull to Lift Full Load (lbs.) G	Shipping Weight (lbs.) G
$\frac{1}{4}$	924-02100G	8	1	$12\frac{7}{8}$	$22\frac{1}{2}$	23G	37G
$\frac{1}{2}$	924-03100G	8	1	$12\frac{7}{8}$	$22\frac{1}{2}$	46G	37G
1	924-05100G	8	1	14G	30G	69G	40G
$1\frac{1}{4}$	924-06100G	8	1	$17\frac{5}{8}$ G	$40\frac{1}{2}$	80G	65G
2	924-07100G	8	1	$17\frac{5}{8}$ G	52G	83G	64G
3	924-09100G	8	2	$21\frac{1}{4}$	81G	85G	96G
4	924-11100G	8	2	$21\frac{1}{4}$	104G	88G	96G
5	924-13100G	8	3	$24\frac{1}{4}$	156G	75G	128G
6	924-14100G	8	3	$25\frac{1}{4}$	156G	90G	132G
8	924-16100G	8	4	$34\frac{1}{4}$	208G	89G	235G
10G	924-17100G	8	5	$35\frac{1}{4}$	260G	95G	249

[†] Can be supplied with larger lifts.

Clearance Dimensions (in.)

Rated Capacity* (tons)									
Dimension C	$\frac{1}{4}$	$\frac{1}{2}$	1	$1\frac{1}{2}$ & 2	3 & 4	5	6	8	10c
A	$12\frac{7}{8}$	$12\frac{7}{8}$	14G	$17\frac{5}{8}$ G	$21\frac{1}{4}$	$24\frac{1}{4}$	25G	$34\frac{1}{4}$	$35\frac{1}{4}$
B	$3\frac{11}{16}$ G	$3\frac{11}{16}$ G	$3\frac{11}{16}$ G	$4\frac{3}{8}$ G	$3\frac{5}{8}$ G	$4\frac{3}{8}$ G	$4\frac{3}{8}$ G	$4\frac{3}{8}$	$4\frac{3}{8}$
C	$7\frac{3}{8}$ G	$7\frac{3}{8}$ G	$7\frac{3}{8}$ G	$6\frac{11}{16}$ G	$8\frac{15}{16}$ G	$10\frac{5}{8}$ G	$10\frac{5}{8}$ G	$12\frac{3}{4}$	$12\frac{3}{4}$
D	$4\frac{1}{4}$	$4\frac{1}{4}$	$4\frac{1}{4}$	$5\frac{1}{4}$ G	$5\frac{1}{4}$ G	$4\frac{7}{8}$	$4\frac{7}{8}$	$5\frac{13}{16}$ G	$5\frac{13}{16}$ G
E	$3\frac{1}{4}$	$3\frac{1}{4}$	$3\frac{1}{4}$	$4\frac{13}{16}$ G	$4\frac{13}{16}$ G	5	5	$4\frac{1}{4}$ G	$4\frac{1}{4}$ G
F	$2\frac{7}{8}$ G	$2\frac{7}{8}$ G	$2\frac{7}{8}$ G	$3\frac{1}{4}$	3	$2\frac{15}{16}$ G	$2\frac{15}{16}$ G	$3\frac{3}{4}$	$3\frac{3}{4}$
G	$3\frac{3}{8}$	$3\frac{3}{8}$	$3\frac{3}{8}$	$5\frac{3}{8}$ G	$8\frac{1}{4}$	$11\frac{13}{16}$ G	$11\frac{13}{16}$ G	$17\frac{3}{8}$ G	$17\frac{3}{8}$ G
H	$1\frac{1}{4}$ G	$1\frac{1}{4}$ G	$1\frac{3}{8}$ G	$1\frac{1}{4}$	$1\frac{1}{4}$	$1\frac{1}{4}$	$1\frac{3}{8}$	$1\frac{11}{16}$ G	$1\frac{13}{16}$ G
I	$3\frac{3}{4}$	$3\frac{3}{4}$	$3\frac{3}{4}$	$4\frac{13}{16}$ G	$4\frac{1}{4}$	$4\frac{3}{8}$ G	$4\frac{3}{8}$ G	$6\frac{1}{8}$ G	$6\frac{1}{8}$ G
J	$2\frac{5}{8}$	$2\frac{5}{8}$	$2\frac{15}{16}$ G	$3\frac{5}{8}$	$4\frac{1}{4}$	$4\frac{1}{4}$	$4\frac{1}{4}$	$5\frac{5}{8}$	$6\frac{1}{4}$
JJG	$2\frac{5}{8}$	$2\frac{5}{8}$	$3\frac{9}{16}$ G	$3\frac{11}{16}$ G	$4\frac{1}{4}$	---	---	---	---
K	$1\frac{15}{16}$ G	$1\frac{15}{16}$ G	$1\frac{1}{4}$	$1\frac{1}{4}$	$1\frac{11}{16}$ G	$1\frac{11}{16}$ G	$1\frac{7}{8}$	$2\frac{1}{4}$	$2\frac{9}{16}$ G
L	$1\frac{1}{4}$	$1\frac{1}{4}$	$1\frac{3}{4}$	$1\frac{1}{4}$	$3\frac{1}{4}$	$4\frac{1}{4}$	$4\frac{1}{4}$	$7\frac{5}{8}$ G	$7\frac{5}{8}$ G
M	$7\frac{1}{4}$ G	$7\frac{1}{4}$ G	$7\frac{1}{4}$ G	$8\frac{5}{8}$	$8\frac{5}{8}$	$8\frac{5}{8}$	$8\frac{5}{8}$	$8\frac{5}{8}$	$8\frac{5}{8}$
N	---G	---G	---	---	$10\frac{7}{8}$	$10\frac{7}{8}$	$10\frac{7}{8}$	$10\frac{7}{8}$	$10\frac{7}{8}$
R	$5\frac{7}{8}$ G	$5\frac{7}{8}$ G	$5\frac{7}{8}$ G	$5\frac{7}{8}$ G	---G	---	---	---	---
S	$4\frac{11}{16}$ G	$4\frac{11}{16}$ G	$4\frac{11}{16}$ G	$4\frac{11}{16}$ G	---G	---	---	---	---
T	---G	---	---G	---G	$3\frac{7}{8}$	4	4	$6\frac{3}{8}$	$6\frac{3}{8}$
W	---G	---	---G	---G	$4\frac{1}{4}$	$6\frac{1}{4}$	$6\frac{1}{4}$	$6\frac{7}{8}$ G	$6\frac{7}{8}$ G
X	$1\frac{1}{2}$ G	$1\frac{1}{2}$ G	$1\frac{1}{4}$	$1\frac{15}{16}$ G	$1\frac{5}{8}$	$1\frac{5}{8}$	$1\frac{1}{4}$	$2\frac{1}{8}$ G	$2\frac{5}{8}$ G
Y	---G	---	---G	---G	$5\frac{1}{4}$	$5\frac{7}{8}$	$5\frac{7}{8}$	$5\frac{9}{16}$ G	$5\frac{9}{16}$