

Rivetless Chain

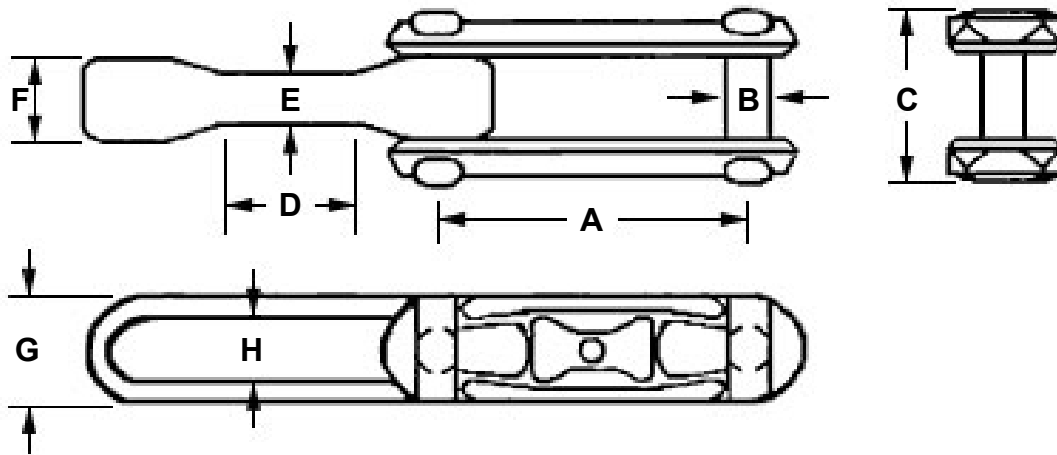

CHAIN	MATERIAL	AVG. ULT. STRENGTH	A	B	C	D	E	F	G	H
X-348	CARBON PLUS	26,000 LBS	3	.50	1.84	1.63	.50	.75	1.09	.562
X-348	MICROTUFF 15	40,000 LBS *	3	.50	1.84	1.63	.50	.75	1.09	.562
X-458	CARBON PLUS	52,000 LBS	4	.625	2.25	2.25	.625	1.0	1.41	.687
X-458	MICROTUFF 15	68,000 LBS *	4	.625	2.25	2.25	.625	1.0	1.41	.687
X-458	HIGH ALLOY	60,000 LBS	4	.625	2.25	2.25	.625	1.0	1.41	.687
X-678	CARBON PLUS	100,000 LBS	6	.875	3.13	3.38	.812	1.28	2.0	.969
X-678	MICROTUFF 15	125,000 LBS *	6	.875	3.13	3.38	.812	1.28	2.0	.969
X-678	HIGH ALLOY	120,000 LBS	6	.875	3.13	3.38	.812	1.28	2.0	.969
698	CARBON PLUS	160,000 LBS	6	1.12	3.75	3.5	1.0	1.55	2.75	1.25
698	MICROTUFF 15	176,000 LBS	6	1.12	3.75	3.5	1.0	1.55	2.75	1.25

CHAIN AVAILABLE IN SILVER ZINC PLATE OR YELLOW ZINC PLATE



1765 Michigan Ave.
 Marysville, MI 48040
 Phone: (810) 364-6170
 Fax: (810) 364-8531
 www.bluewatermfg.com

MATERIAL

	CARBON PLUS	MICROTUFF 15	HIGH ALLOY
PIN	4140	MT-15	8642
CENTER LINK	1048/1053	MT-15	8642
SIDE LINK	1048/1053	MT-15	8642

HEAT TREAT

	CARBON PLUS	MICROTUFF 15	HIGH ALLOY
PIN	375 - 429	375 - 429	429 - 477
CENTER LINK	341 - 390	375 - 429	429 - 477
SIDE LINK	301 - 344	375 - 429	429 - 477

The Above Readings Are In Brinell

Standard Rivetless Chain:

The rivetless chain shall be clean and free from dirt, slag, scale, and flash extension per ASTM A521.

The center links shall have smooth pin bearing surfaces. The center link pin bearing surfaces shall have a 75% average bearing area.

All chain components shall be protected from corrosion prior to shipping.

MT-15 Steel to be per ASTM A-909

The overall length of a new chain 10'-0" nominal segment is 121" 1/2" Chain is considered worn out when a 10'-0" nominal segment is 125"

Dimensions are per ANSI B29.22M - 1980.

Note:

All chain can be pre-stressed or proof loaded at 33% of its ultimate strength prior to shipping

* Average ultimate strength values are arithmetical averages determined from current tensile test data