

# WORMS AND WORM GEARS

## 8 DIAMETRAL PITCH

### BRONZE AND CAST IRON WORM GEARS

### STEEL WORMS – UNHARDENED AND HARDENED

PRESSURE ANGLE – 14½°

RATIO = Gear Teeth ÷ Worm Threads  
RH = RIGHT HAND — LH = LEFT HAND  
All others stocked RIGHT HAND ONLY.

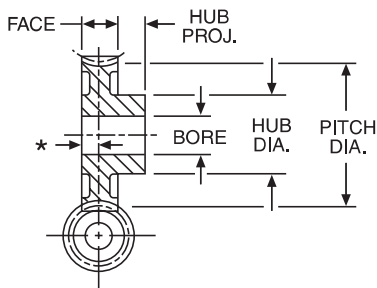

#### STANDARD TOLERANCES

DIMENSION		TOLERANCE
BORE	All	±.0005

#### WORM LEAD and LEAD ANGLE

	SINGLE	DOUBLE	QUAD
LEAD	.3927"	.7854"	1.5708"
LEAD ANGLE	4°46'	9°28'	18°26'

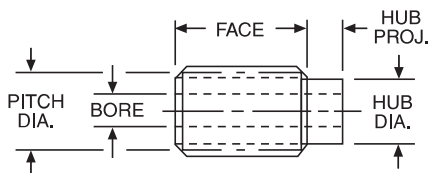

#### REFERENCE PAGES

Alterations — 149  
Horsepower Ratings — 85, 86  
Lubrication — 149  
Materials — 150  
Selection Procedure — 84

ALL DIMENSIONS IN INCHES  
ORDER BY CATALOG NUMBER OR ITEM CODE

8 DIAMETRAL PITCH		WORM GEARS				FACE = .750" *CENTER LINE WORM TO FLUSH END = .375"					
No. of Teeth	Pitch Dia.	Bore	Hub		Style See Page 150	SINGLE Thread		DOUBLE Thread		QUAD Thread	
			Dia.	Proj.		Catalog Number	Item Code	Catalog Number	Item Code	Catalog Number	Item Code
<b>BRONZE</b>											
8	1,000	.500	1.12	.88	A	—	—	—	—	QB808†	13790
12	1,500	.750	1.50	.88		—	—	—	—	QB812†	13792
16	2,000	1,000	2.00	.88		—	—	—	—	QB816†	13794
20	2,500	.750	1.75	.75	B	GB1070	13654	—	—	—	—
		1,000	1.75	.75		—	—	DB1420A	13740	DB1620A	13796
30	3,750	.750	1.69	.75	B	GB1071	13656	—	—	—	—
		1,000	1.69	.75		—	—	DB1421A	13742	DB1621A	13798
40	5,000	1,000	2.19	.75	B	GB1072A	13658	DB1422	13744	DB1622	13800
48	6,000	1,000	2.38	.88	B	GB1073	13660	—	—	—	—
50	6,250	1,000	2.31	.88	B	GB850RH	13662	DB1423A	13746	DB1623A	13802
60	7,500	1,000	2.44	.88	C	GB860	13664	DB860A	13748	—	—
80	10,000	1,250	2.75	.88	D	GB1074A	13666	—	—	—	—
100	12,500	1,250	3.00	1.00	C	GB8100	13668	—	—	—	—
<b>CAST IRON</b>											
20	2,500	.750	1.75	.75	A	G1070RH	13160	—	—	—	—
		1,000	1.75	.75		G1070LH	13162	—	—	—	—
30	3,750	.750	1.69	.75	B	G1071RH	13164	—	—	—	—
		1,000	1.69	.75		G1071LH	13166	—	—	—	—
40	5,000	1,000	1.69	.75	B	G1072ARH	13168	D1421ARH	13308	D1621A	13382
		1,000	1.69	.75		G1072ALH	13170	D1421ALH	13310	D1621A	13382
48	6,000	1,000	2.38	.88	B	G1073RH	13174	D1422ARH	13312	D1622A	13384
		1,000	2.38	.88		G1073LH	13172	D1422ALH	13314	D1622A	13384
50	6,250	1,000	2.31	.88	B	G850RH	13176	—	—	—	—
		1,000	2.31	.88		G850LH	13178	D1423A	13316	D1623A	13386
60	7,500	1,000	2.44	.88	C	G860	13180	D860A	13320	Q860A	13388
		1,000	2.44	.88	D	—	—	D1424A	13322	D1624A	13390
80	10,000	1,250	2.69	.88	D	G1074ARH	13182	—	—	—	—
		1,250	2.69	.88	D	G1075	13186	—	—	—	—
96	12,000	1,250	3.00	1.00	C	G1075	13186	—	—	—	—
100	12,500	1,250	2.69	1.00	C	G8100A	13188	—	—	—	—

8 DIAMETRAL PITCH		WORMS FOR ABOVE GEARS									
Pitch Dia.	Face	Bore	Hub		SINGLE Thread		DOUBLE Thread		QUAD Thread		
			Dia.	Proj.	Catalog Number	Item Code	Catalog Number	Item Code	Catalog Number	Item Code	
<b>UNHARDENED – STEEL</b>											
1,500	1,750	.875	—	—	—	—	D1427KRH‡	12814	D1627KRH‡	12830	
	2,500	.875	—	—	—	—	D1427KLH‡	12816	D1627KLH‡	12832	
		.750	—	—	L1076‡	12904	—	—	—	—	
	1,750	.750	—	—	G1076KRH‡	12868	—	—	—	—	
.750		1.18	.62	G1076KLH‡	12870	—	—	—	—		
1,500	1,750	.750	—	—	—	—	GH1076RH	12892	DH1427RH	12846	
							GH1076LH	12894	DH1427LH	12848	DH1627
<b>HARDENED STEEL</b>											
1,500	1,750	.875	—	—	—	—	H1427RH‡	12990	H1627‡	13000	
	2,500	.875	—	—	—	—	H1427LH‡	12988	—	—	
		.750	—	—	—	—	HL1427‡	13022	—	—	
	1,750	.750	—	—	HL1076‡	13010	—	—	—	—	
1,500	1,750	.750	—	—	—	—	H1076RH‡	12970	—	—	
							H1076LH‡	12968	—	—	—

†1,000" Face, Center Line Worm to Flush End = .500"

‡Furnished with .188" Keyway.

Hardened Worms have ground and polished threads.