

Adapter Piece (Custom Machined item – For housing Shaft seal and a Ball bearing)

Deep Groove Ball Bearing – Sealed Housing Unit

GearBox

Generator

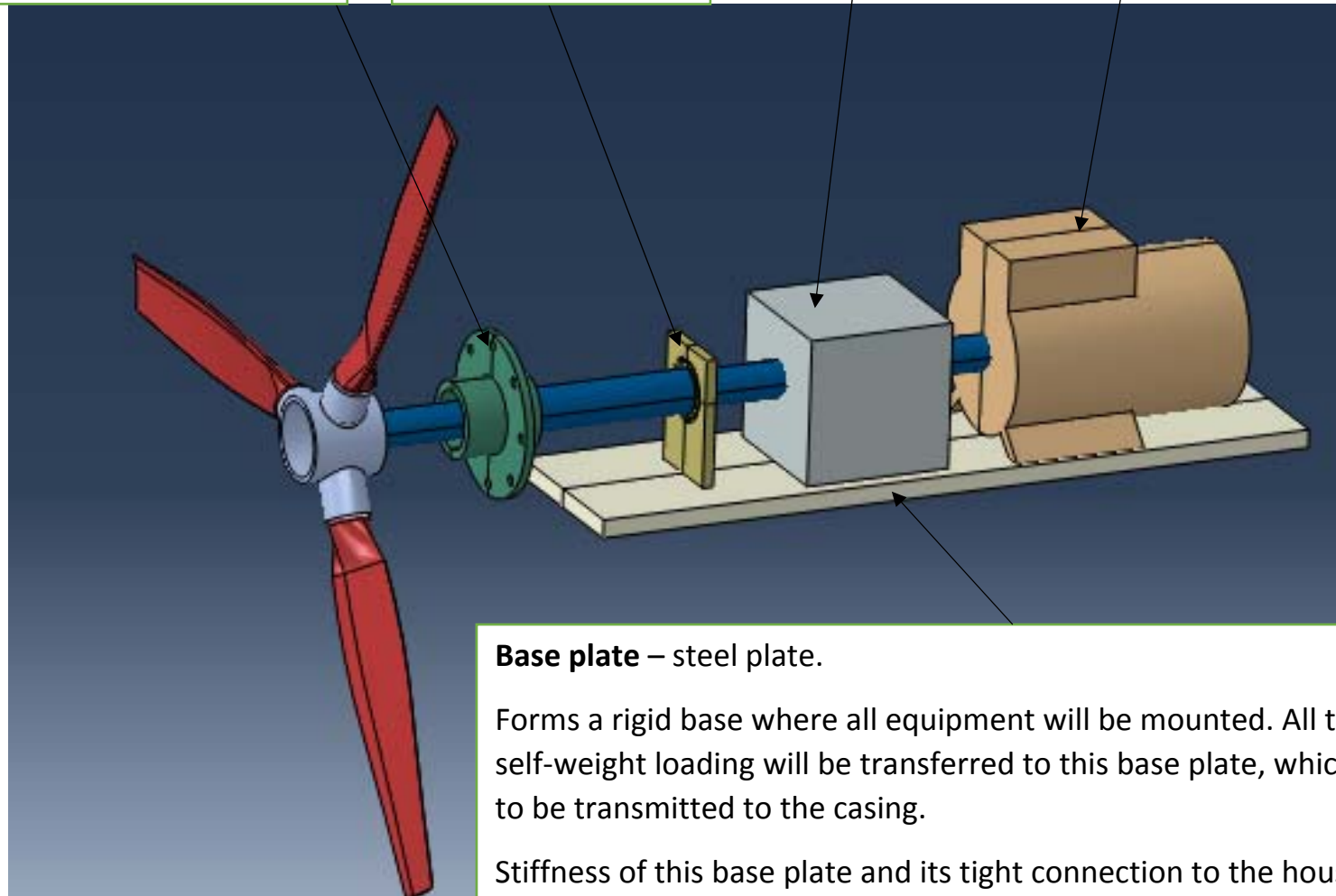

Base plate – steel plate.

Forms a rigid base where all equipment will be mounted. All torque and self-weight loading will be transferred to this base plate, which then need to be transmitted to the casing.

Stiffness of this base plate and its tight connection to the housing ensures minimal vibrations of the equipment.

This base plate to be bolted to the Casing structure at 4 corners.

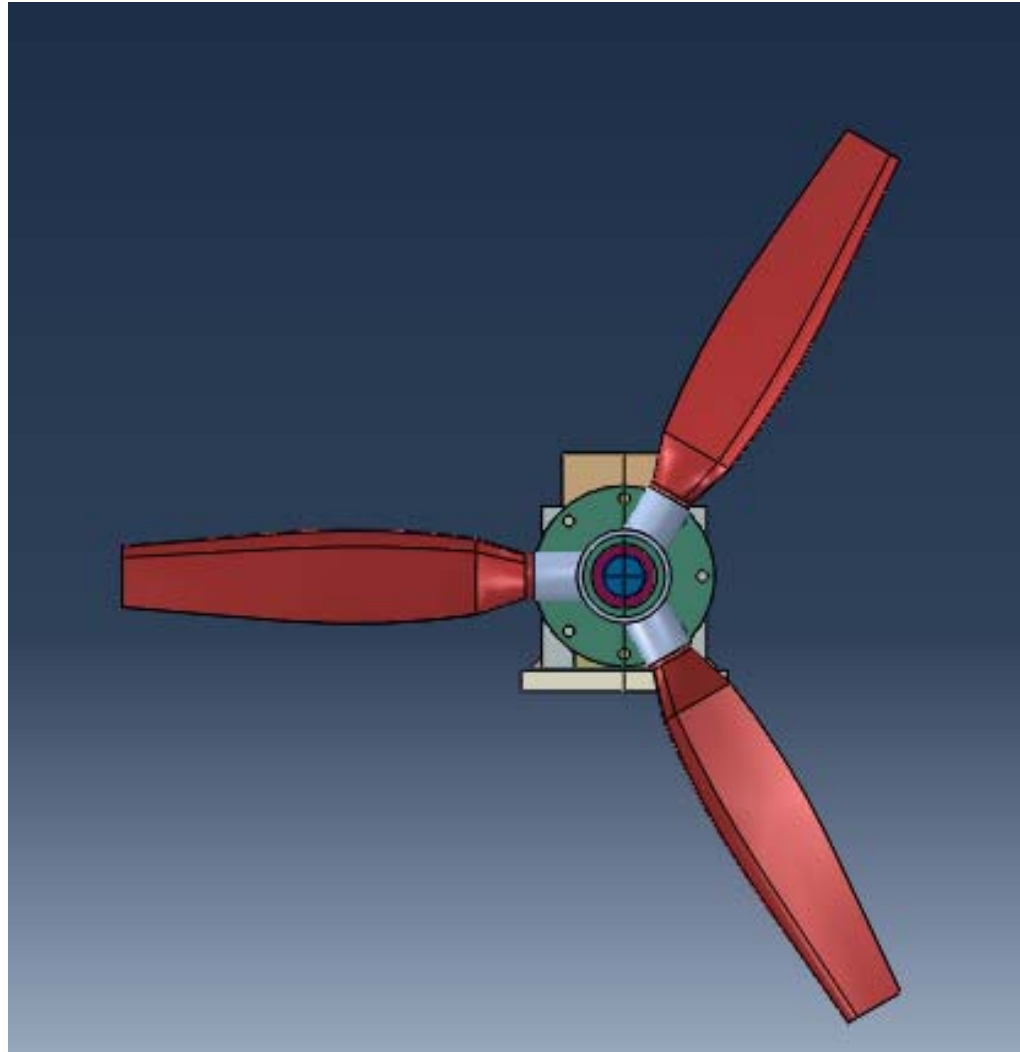

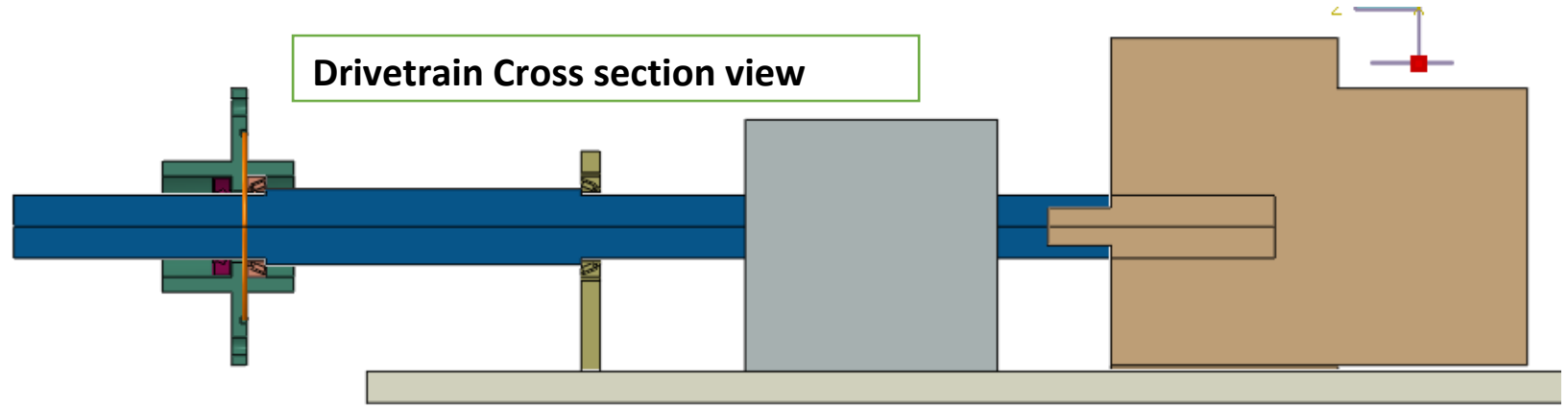

Radial Shaft seal –
NBR material, Lip
Seal

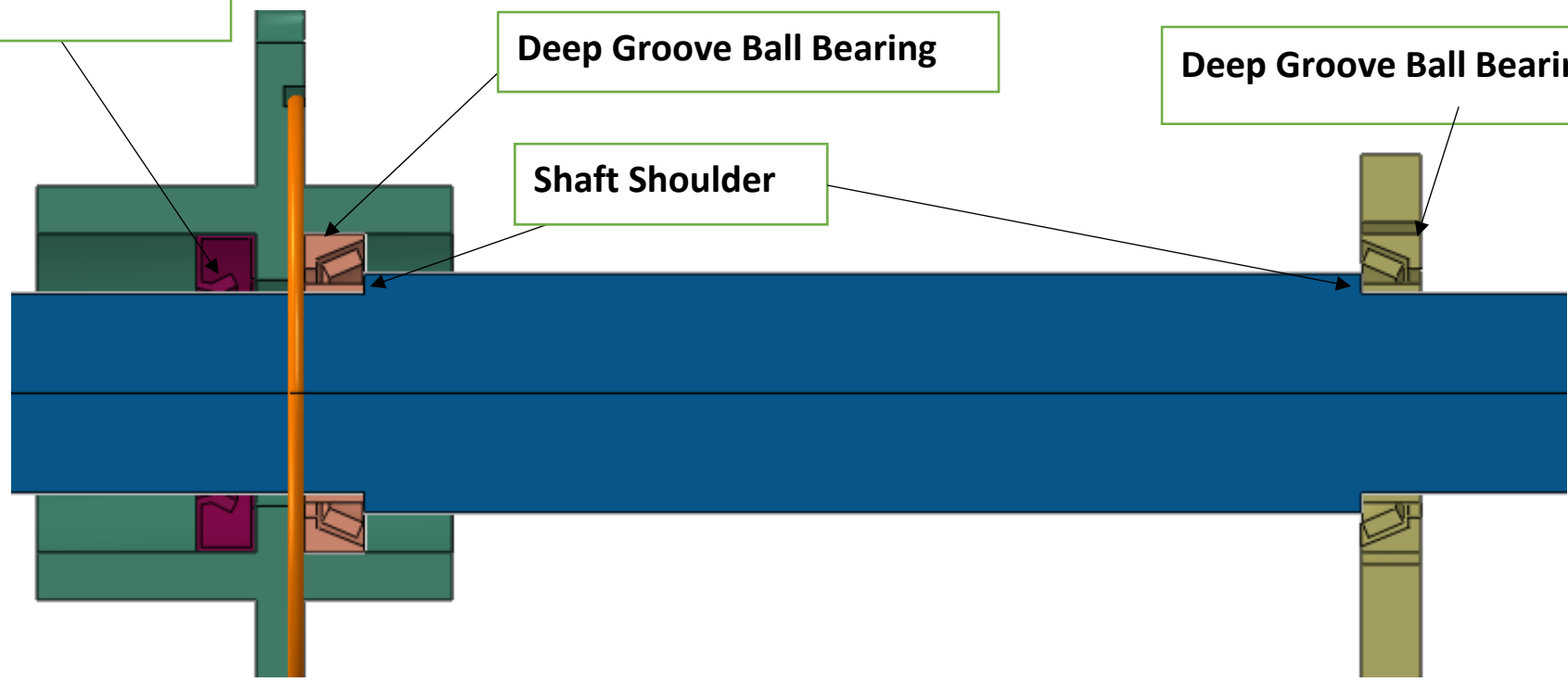

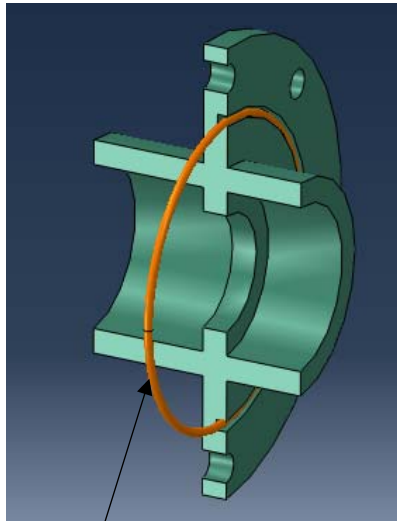
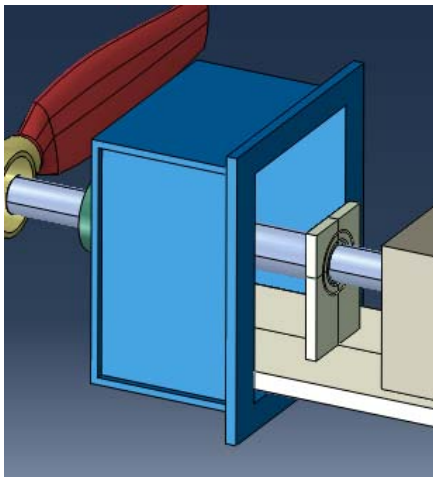

O-ring

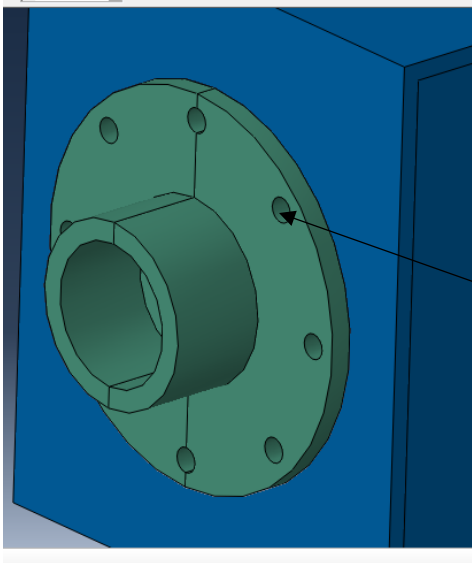

Bolted to the Housing

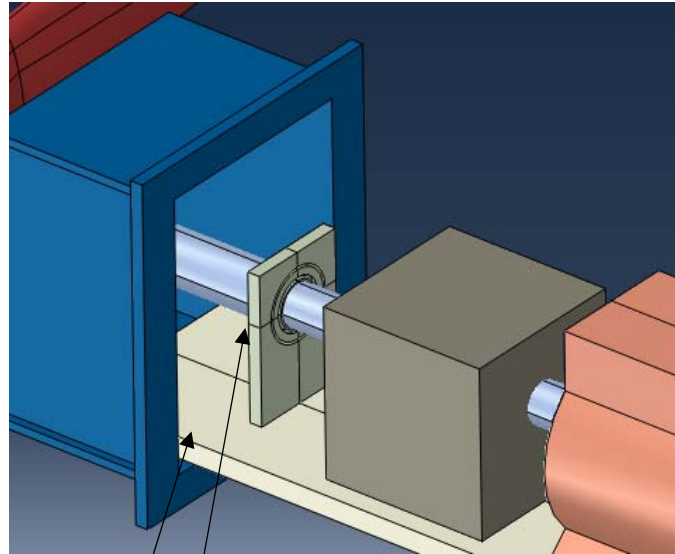
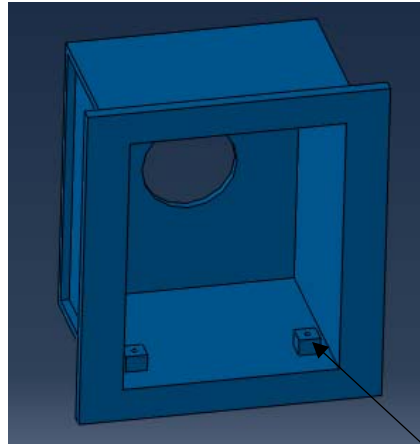

Bolted Connection – Base Plate to Housing

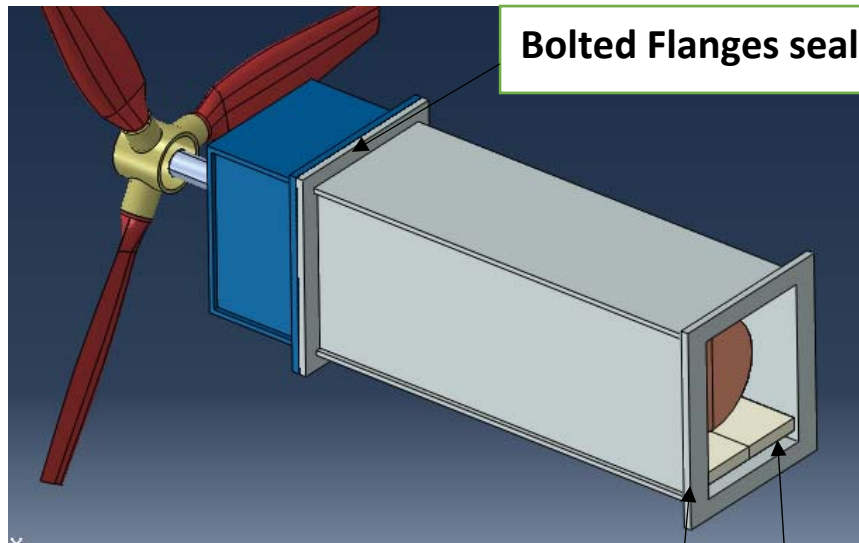

Bolted Flanges sealed by O-rings

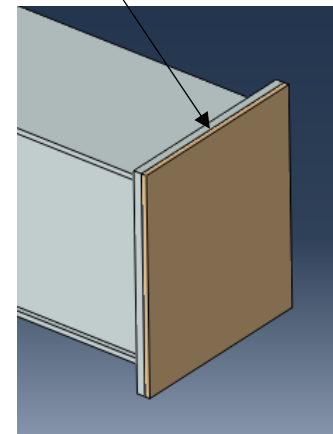

Bolted Connection – Base Plate to Housing

