

PROJECT:	DATE:	DOCUMENT No.
----------	-------	--------------

LATERAL PRESSURES FOR WALL FORMWORK TO ACI 347R-14

CONCRETE WALL HEIGHT:	H =	15	ft	
POUR RATE:	R =	7	ft/hr	Eq. 2.3 GOVERNS
POUR TEMPERATURE:	T =	75	°F	
CONCRETE UNIT WEIGHT:	ρ =	150	lb/ft ³	==> OK
CEMENT TYPE:		I		==> OK
SET RETARDER:		YES		==> OK
SLAG:		0%		
FLY ASH:		0%		
CONCRETE UNIT WEIGHT CO-EFFICIENT:	C_w =	1.00		
CONCRETE CHEMISTRY CO-EFFICIENT:	C_c =	1.2		

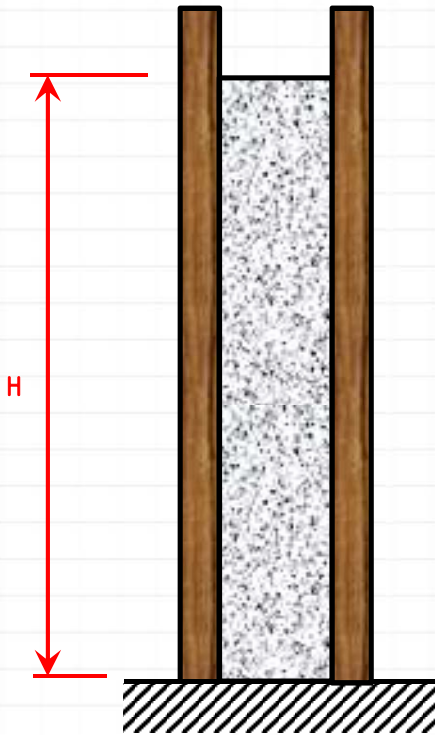

CONCRETE WALL HEIGHT H (ft)	ACI 347R-14 EQUATIONS			HYDROSTATIC PRESSURE, ρH ρ (psf)
	EQN 2.2a OR 2.3 ρ (psf)	MIN. ρ (psf)	MAX. ρ (psf)	
0.0	990	600	2000	0
1.0	990	600	2000	150
2.0	990	600	2000	300
3.0	990	600	2000	450
4.0	990	600	2000	600
5.0	990	600	2000	750
6.0	990	600	2000	900
7.0	990	600	2000	1050
8.0	990	600	2000	1200
9.0	990	600	2000	1350
10.0	990	600	2000	1500
11.0	990	600	2000	1650
12.0	990	600	2000	1800
13.0	990	600	2000	1950
14.0	990	600	2000	2100
15.0	990	600	2000	2250

DEPTH TO MAX PRESSURE: 6.6 ft