

**DETAIL**  
SCALE 1:1 **1**

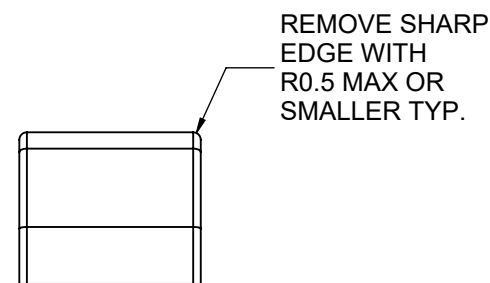

**DETAIL**  
SCALE 2:1 **2**

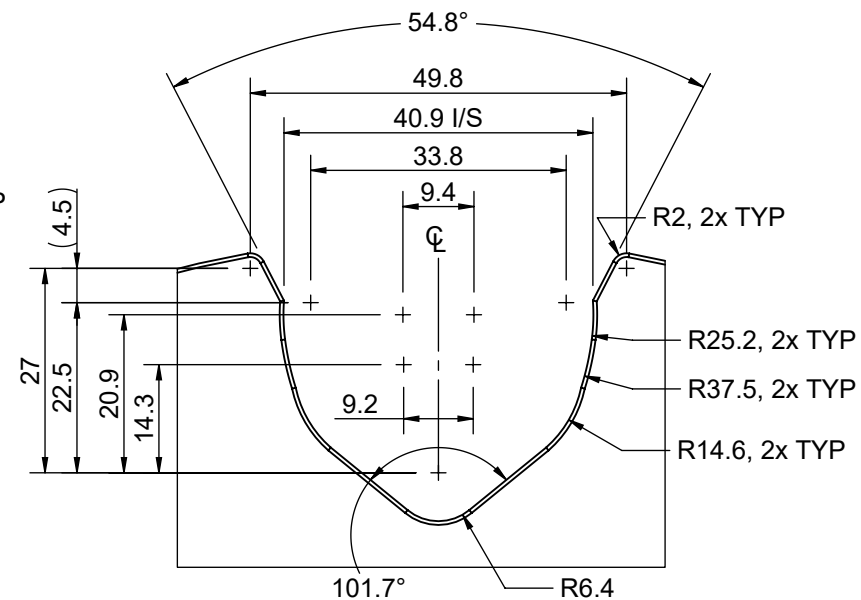

**DETAIL**  
SCALE 1:1 **4**

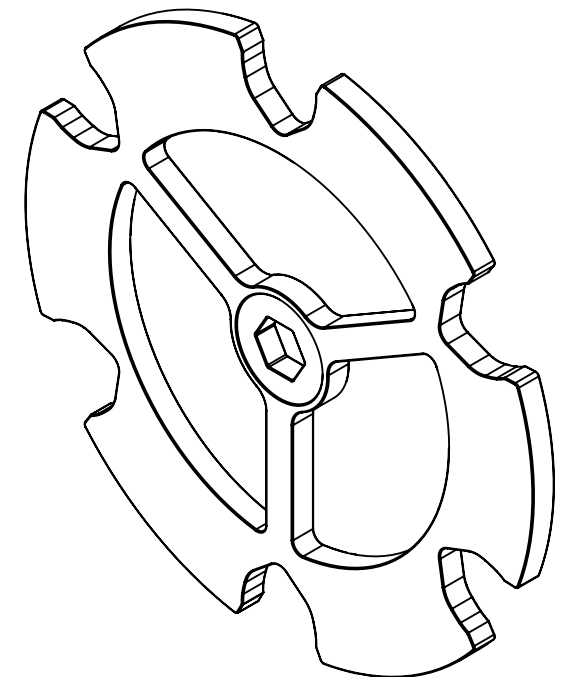

ISO VIEW  
SCALE : 1:3

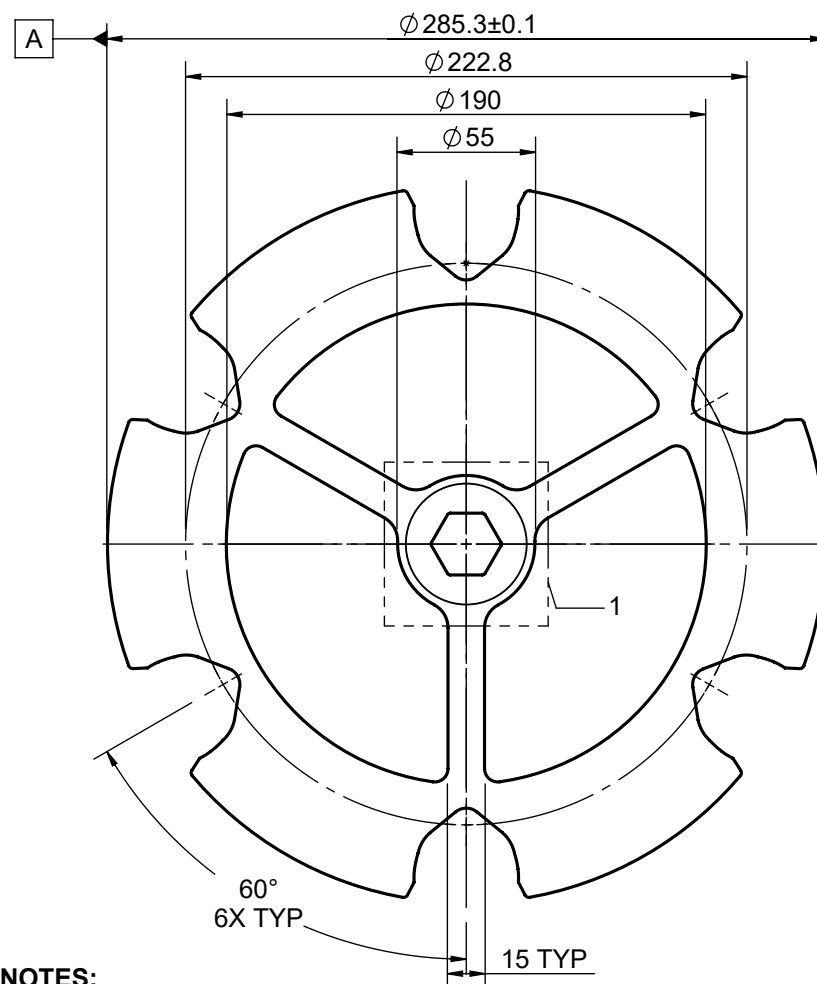

- NOTES:**
1. ALL SURFACES  $\nabla_{N6}$  OR BETTER.
  2. DEBURR/BREAK ALL SHARP EDGES

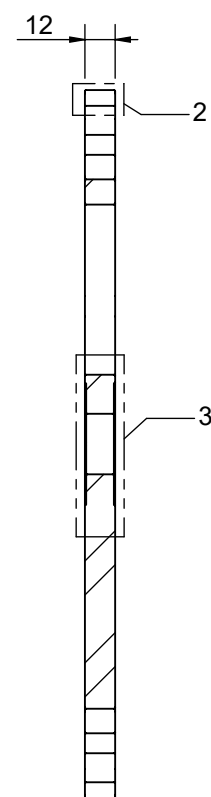

**SECTION**  
SCALE 1:3 **A**

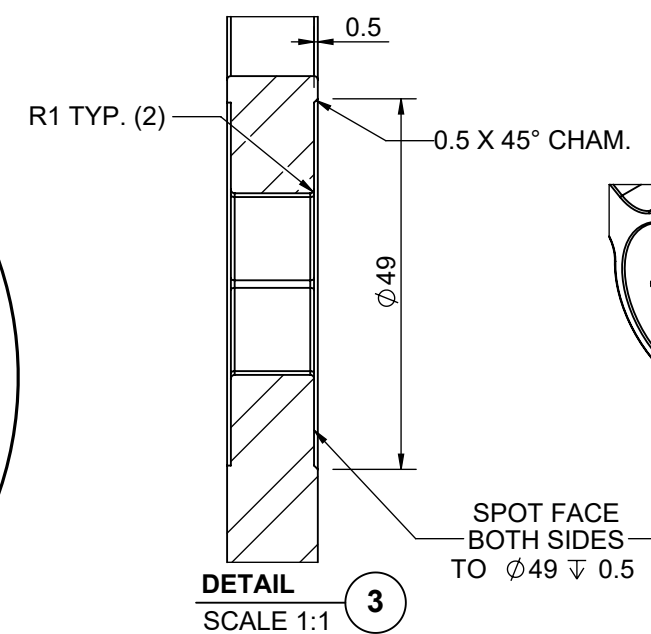
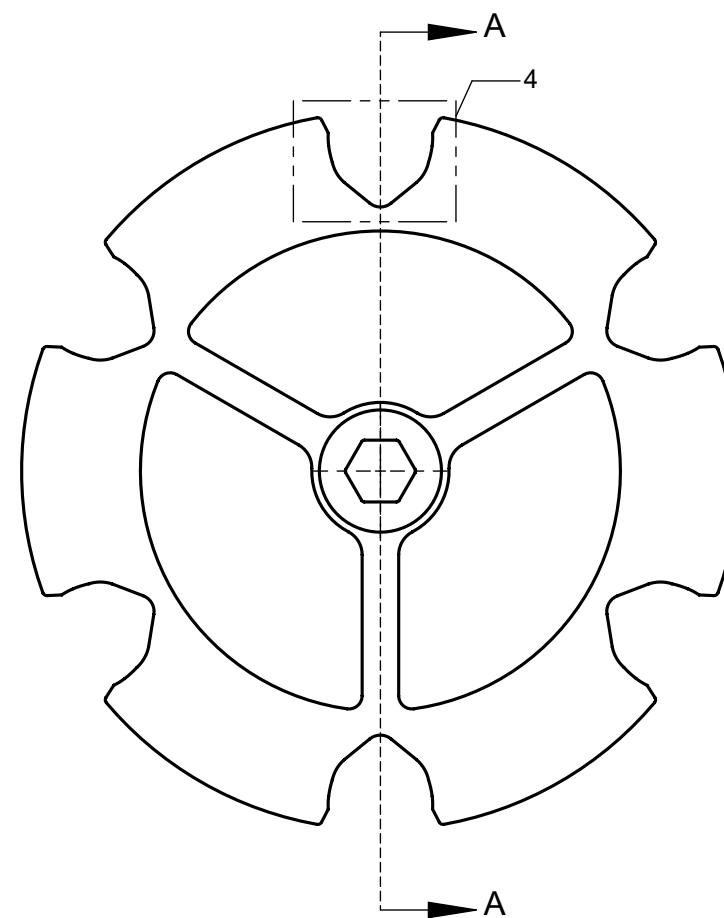

**DETAIL**  
SCALE 1:1 **3**

