

ELEVATION

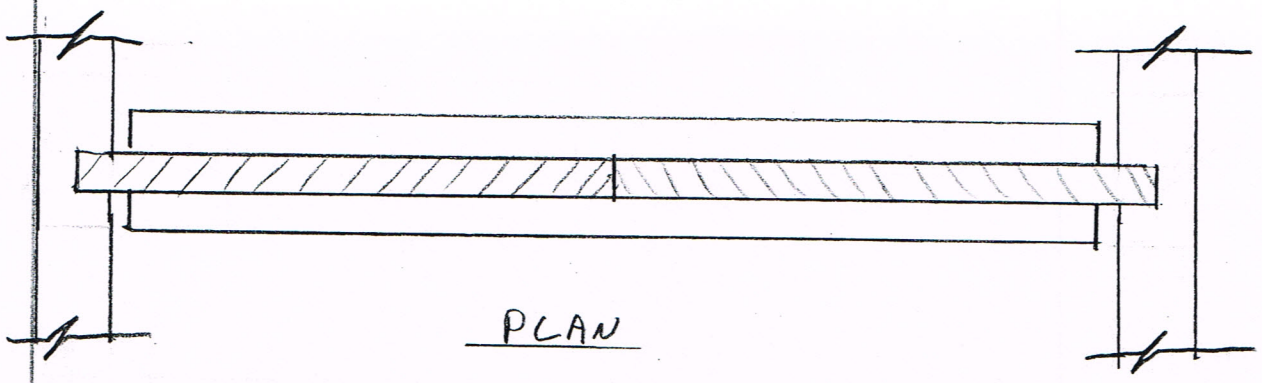

PLAN

1<sup>ST</sup> PROPOSE ANALYSIS

SISTER MEMBERS CARRY APPLIED MOMENT & APPLY Vertical Shear TO SPLICED MEMBER RESOLVE T/C AT "B" DUE TO Shear  $V_A$  NEAR SUPPORT

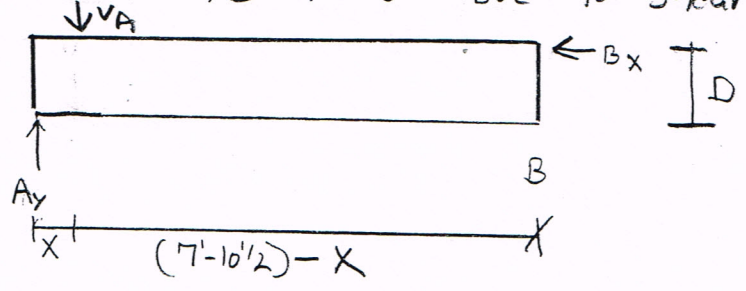

$$\sum M_A = (V_A)(X) - (B_x)(D)$$

## 2nd PROPOSED Analysis

ASSUME SISTER MEMBERS ARE A BEAM SPLICE  
AND DESIGN CONNECTION FOR "MB" @ SPLICE

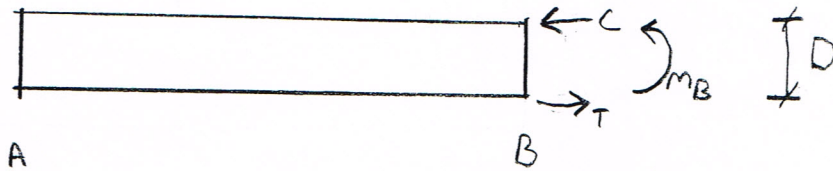

$$T/C = \frac{M}{D}$$

DESIGN CONNECTION FOR TC.

\* 2nd analysis produces a larger force  
TO RESOLVE IN THE CONNECTION