

Qty.	Description
------	-------------

1	DWK.O.13.150.75.6.0D
---	----------------------



Note! Product picture may differ from actual product

Product No.: [96922699](#)

Submersible Contractor Pump

Grundfos DWK pump is a submersible pump for dewatering and drainage applications.

The pump is suitable for pumping

- large quantities of underground and surface water

- drainage water at high head

- water with dirt from drainage pits

The compact design makes the pump suitable for both temporary and permanent installation.

The pump is cast iron, with vertical discharge port and integrated submersible 3-phase totally enclosed motor in insulation class F (155°C).

The pump has a rise pipe, a double mechanical seal and semi-open impeller type

The pump is equipped with a temperature Bi-metal sensor for motor protection in case of overheating and electrode seal sensor to detect water penetration in to the motor housing.

The pump is fitted with suction strainer, lifting handle and 10 m cable.

Controls:

Water-in-oil sensor: without water-in-oil sensor

Seal sensor: Y

Liquid:

Liquid temperature range: 0 .. 40 °C

Density: 998.2 kg/m³

Technical:

Max flow: 24.6 l/s

Actual impeller diameter: 146 mm

Type of impeller: O

Maximum particle size: 13 mm

Primary shaft seal: SIC-SIC

Max. hydraulic efficiency: 49 %

Curve tolerance: ISO9906:2012 3B2

Materials:

Pump housing: Cast iron
EN 1561 EN-GJL-200

Impeller: Ductile cast iron
EN1563 EN-GJS-450-10

Motor: Cast iron

Qty.	Description
1	<p>EN-GJL-250</p> <p>Installation:</p> <p>t max amb: 40 °C</p> <p>Pump outlet: DN 150</p> <p>Maximum installation depth: 25 m</p> <p>Electrical data:</p> <p>Rated power - P2: 7.5 kW</p> <p>Mains frequency: 60 Hz</p> <p>Rated voltage [V]: 3 x 380-415 V</p> <p>Voltage tolerance: +5/-5 %</p> <p>Max starts per. hour: 30</p> <p>Rated current: 14 A</p> <p>Rated current at 3/4 load: 10.6 A</p> <p>Rated current at 1/2 load: 12.8 A</p> <p>Maximum current consumption: 14 A</p> <p>Cos phi - power factor: 0.92</p> <p>Cos phi - p.f. at 3/4 load: 0.9</p> <p>Cos phi - p.f. at 1/2 load: 0.87</p> <p>Rated speed: 3450 rpm</p> <p>Motor efficiency at full load: 89.1 %</p> <p>Motor efficiency at 3/4 load: 90.1 %</p> <p>Motor efficiency at 1/2 load: 89.5 %</p> <p>Number of poles: 2</p> <p>Start. method: direct-on-line</p> <p>Enclosure class (IEC 34-5): IP68</p> <p>Insulation class (IEC 85): F</p> <p>Explosion proof: no</p> <p>Length of cable: 10 m</p> <p>Cable type: PNCT</p> <p>Others:</p> <p>Net weight: 156 kg</p>

96922699 DWK.O.13.150.75.6.0D 60 Hz

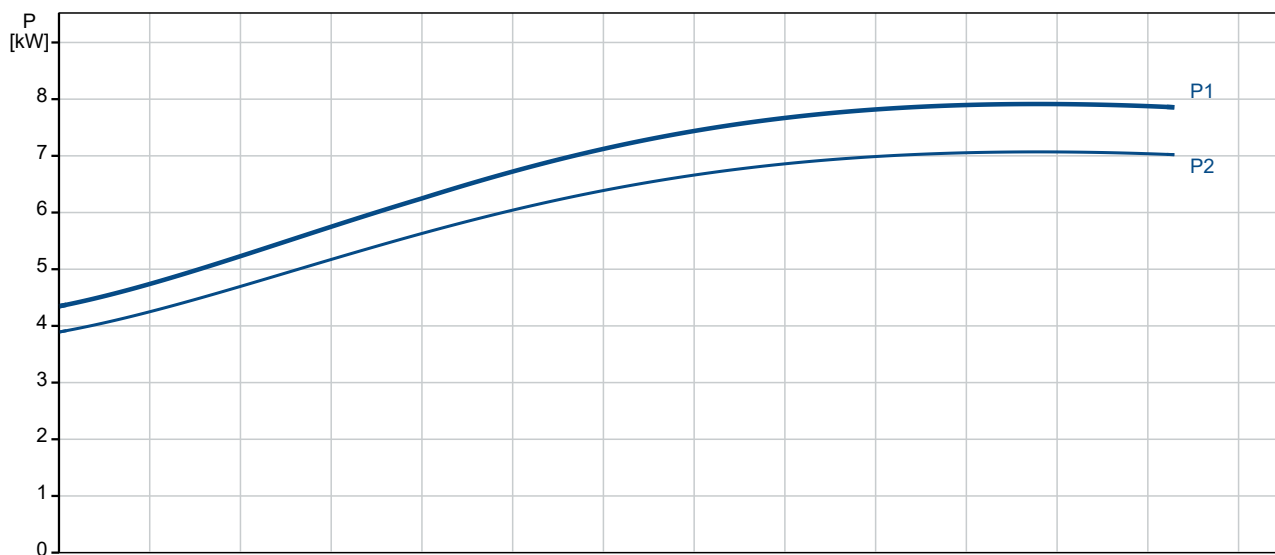
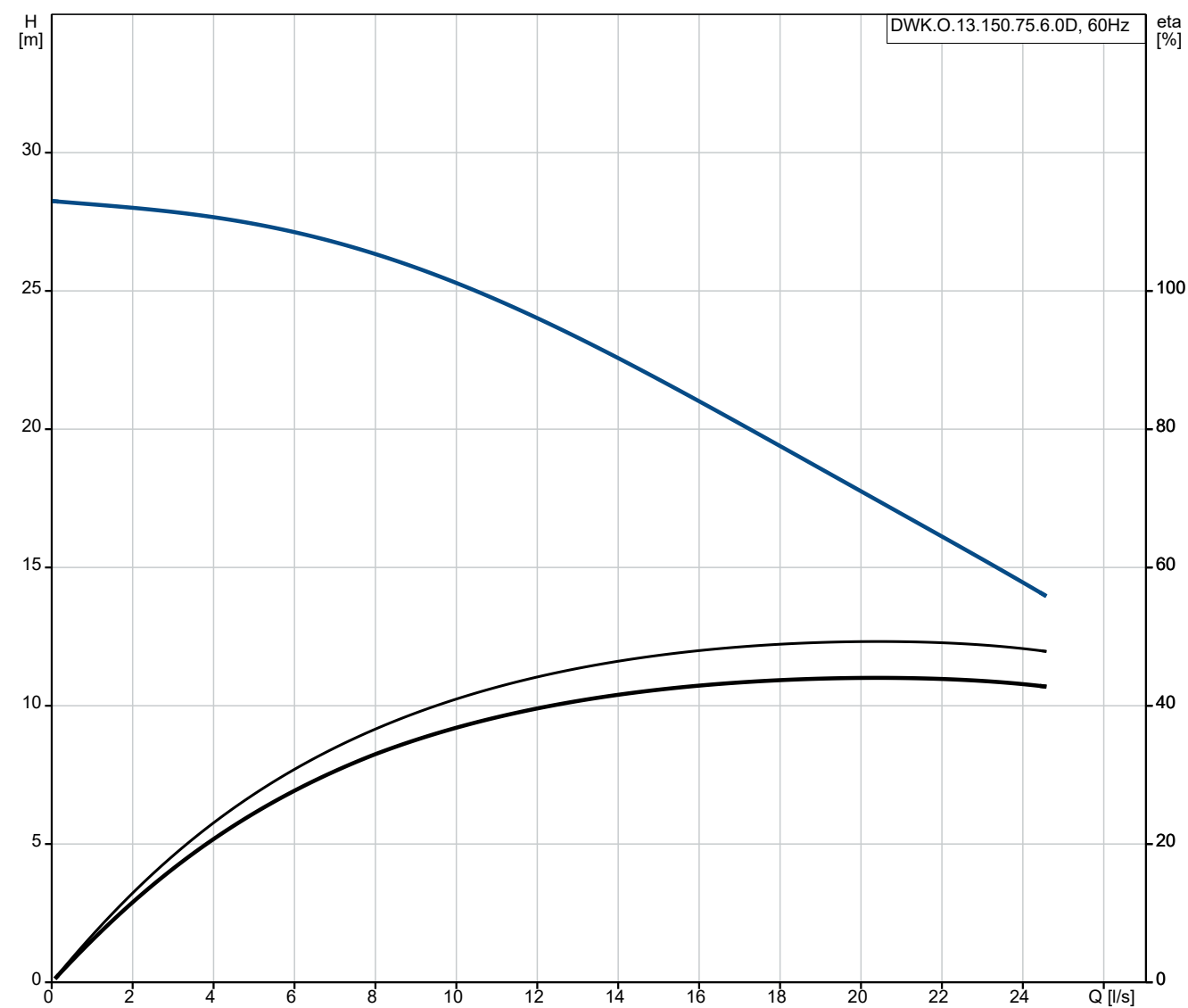

Description	Value
General information:	
Product name:	DWK.O.13.150.75.6.0D
Product No:	96922699
EAN number:	5700313724871
Technical:	
Max flow:	24.6 l/s
Head min:	13.8 m
Head max:	28.3 m
Actual impeller diameter:	146 mm
Type of impeller:	O
Maximum particle size:	13 mm
Primary shaft seal:	SIC-SIC
Max. hydraulic efficiency:	49 %
Curve tolerance:	ISO9906:2012 3B2
Materials:	
Pump housing:	Cast iron
Pump housing:	EN 1561 EN-GJL-200
Impeller:	Ductile cast iron
Impeller:	EN1563 EN-GJS-450-10
Motor:	Cast iron
Motor:	EN-GJL-250
Installation:	
t max amb:	40 °C
Pump outlet:	DN 150
Maximum installation depth:	25 m
Liquid:	
Liquid temperature range:	0 .. 40 °C
Density:	998.2 kg/m ³
Min. pH-value:	4
Electrical data:	
Rated power - P2:	7.5 kW
Mains frequency:	60 Hz
Rated voltage [V]:	3 x 380-415 V
Voltage tolerance:	+5/-5 %
Max starts per. hour:	30
Rated current:	14 A
Rated current at 3/4 load:	10.6 A
Rated current at 1/2 load:	12.8 A
Maximum current consumption:	14 A
Cos phi - power factor:	0.92
Cos phi - p.f. at 3/4 load:	0.9
Cos phi - p.f. at 1/2 load:	0.87
Rated speed:	3450 rpm
Motor efficiency at full load:	89.1 %
Motor efficiency at 3/4 load:	90.1 %
Motor efficiency at 1/2 load:	89.5 %
Number of poles:	2
Start. method:	direct-on-line
Enclosure class (IEC 34-5):	IP68
Insulation class (IEC 85):	F
Explosion proof:	no
Length of cable:	10 m
Cable type:	PNCT
Cable size:	4X4MM2+4X1MM2
Controls:	
Water-in-oil sensor:	without water-in-oil sensor
Seal sensor:	Y
Others:	

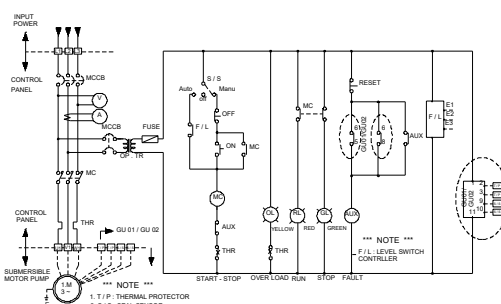
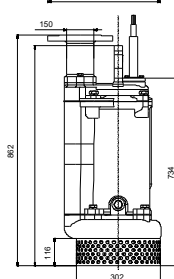
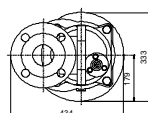
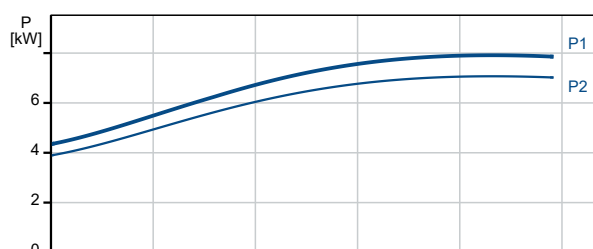
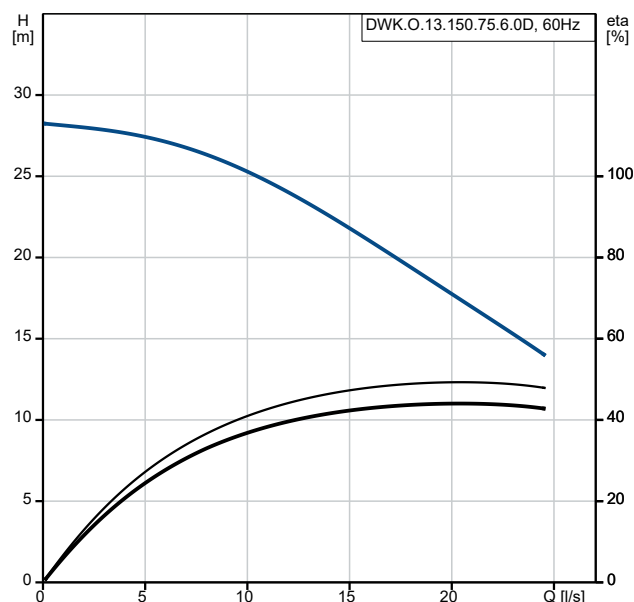



Company name:

Created by:

Phone:

Date:

13/10/2022

Description	Value
Net weight:	156 kg

96922699 DWK.O.13.150.75.6.0D 60 Hz

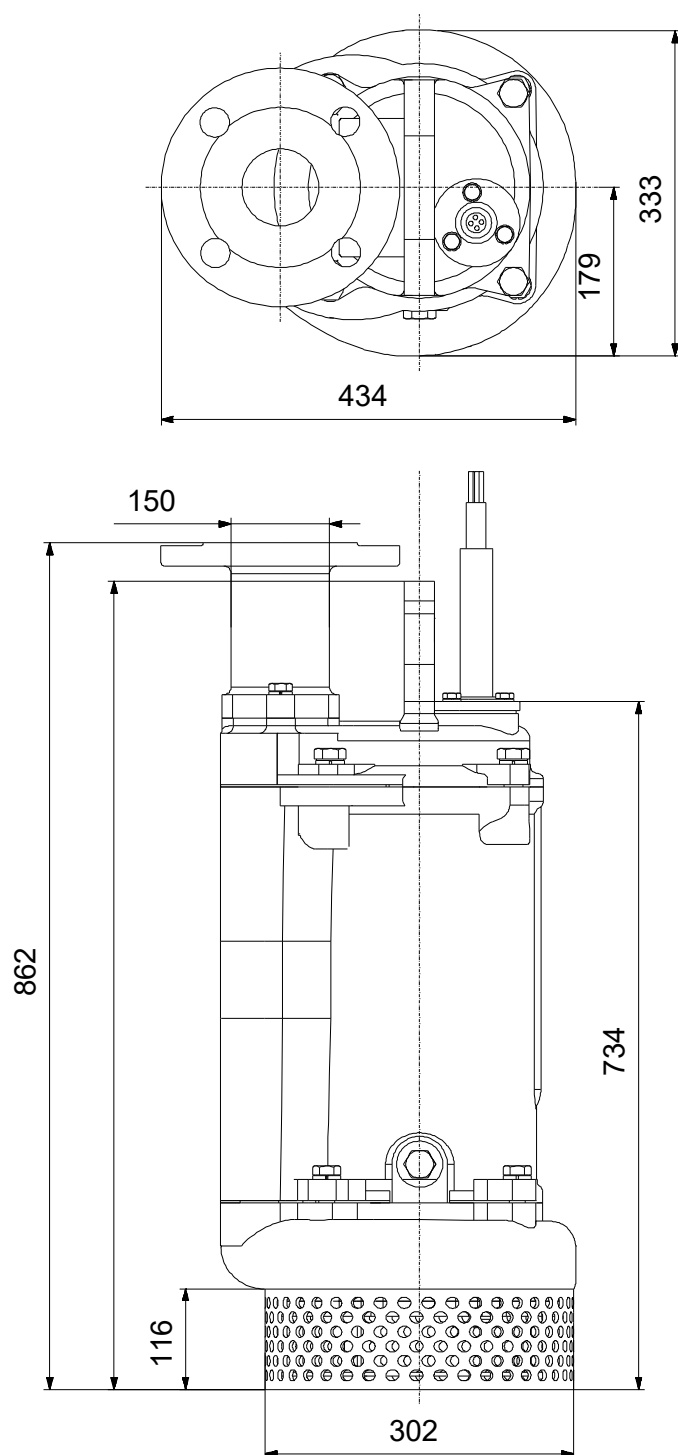

Note! All units are in [mm] unless others are stated.

Disclaimer: This simplified dimensional drawing does not show all details.

96922699 DWK.O.13.150.75.6.0D 60 Hz

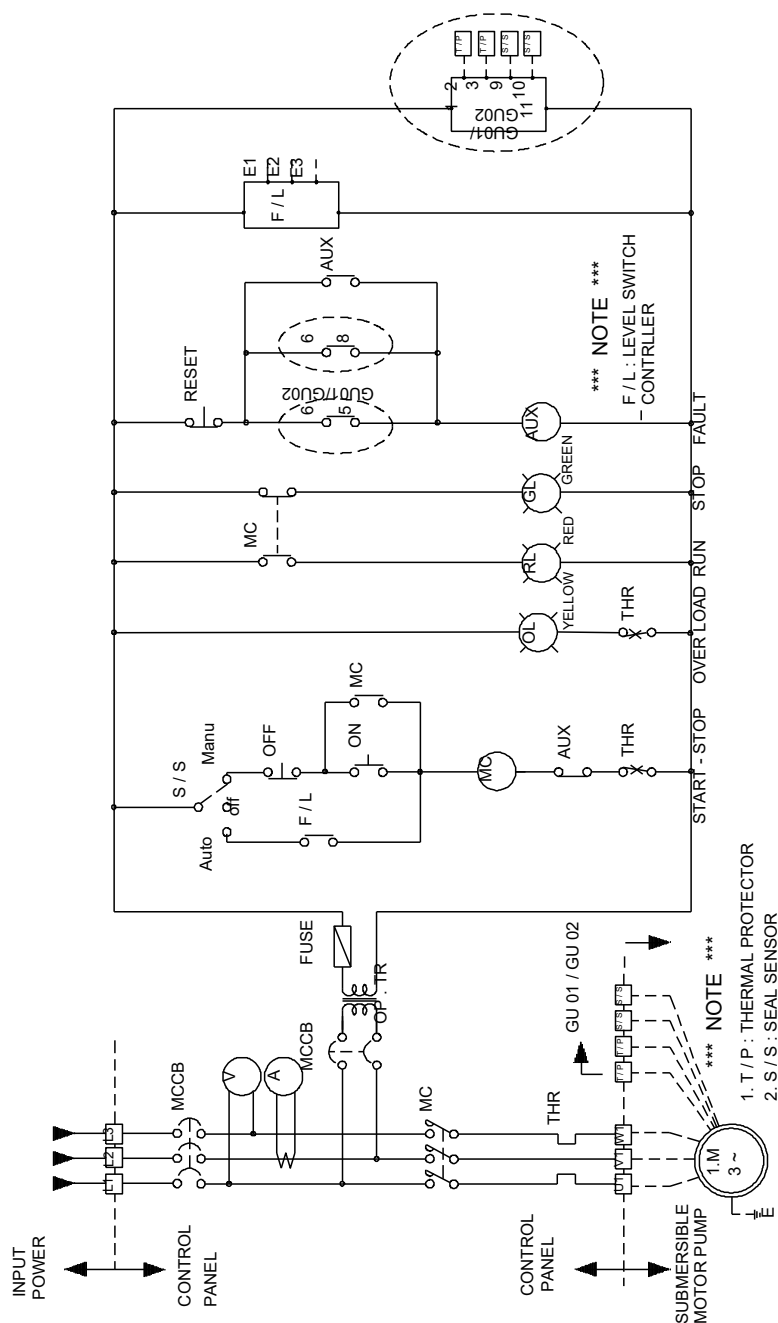

Note! All units are in [mm] unless others are stated.

(TM044577 1809)

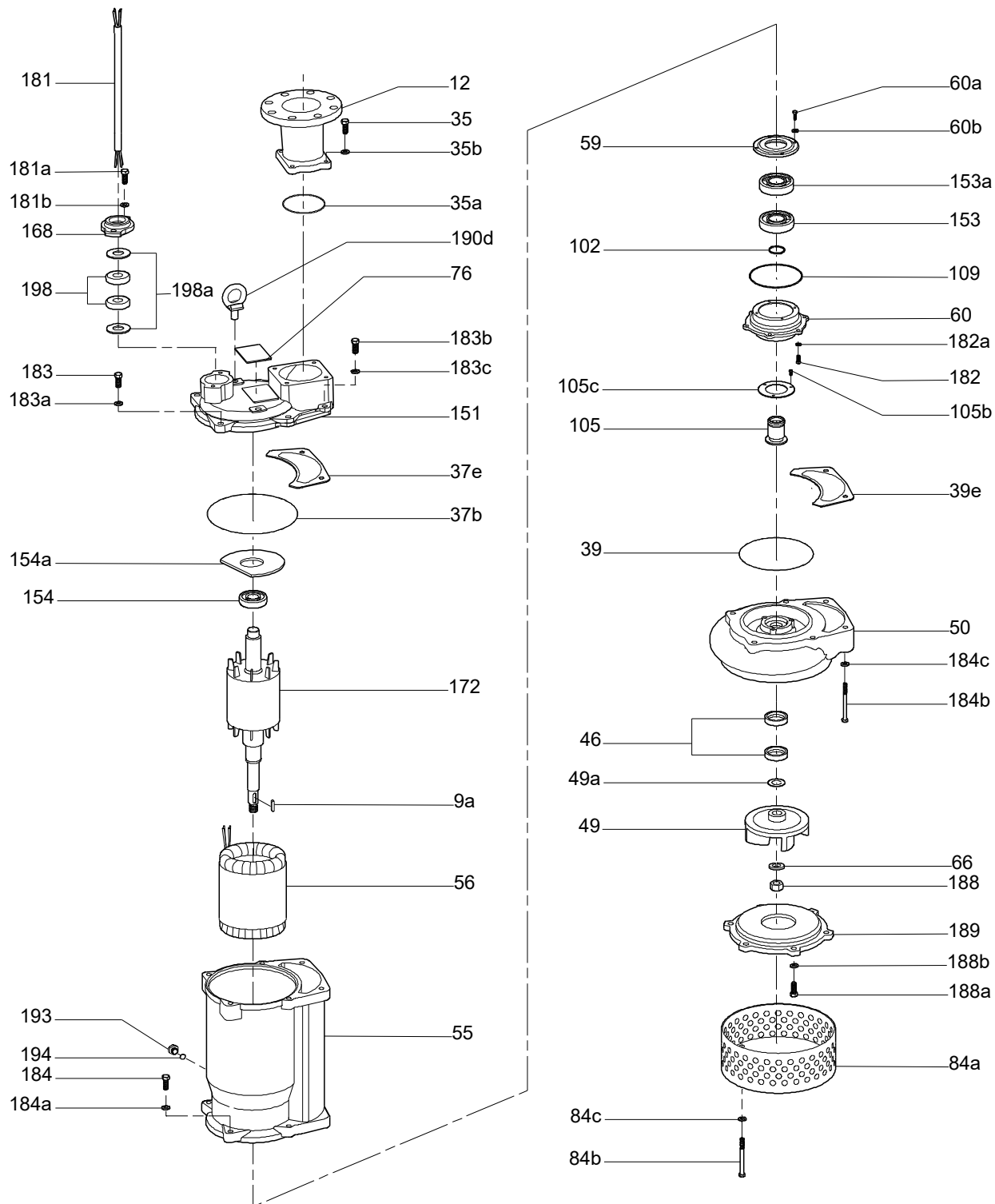

(TM044702 1809)

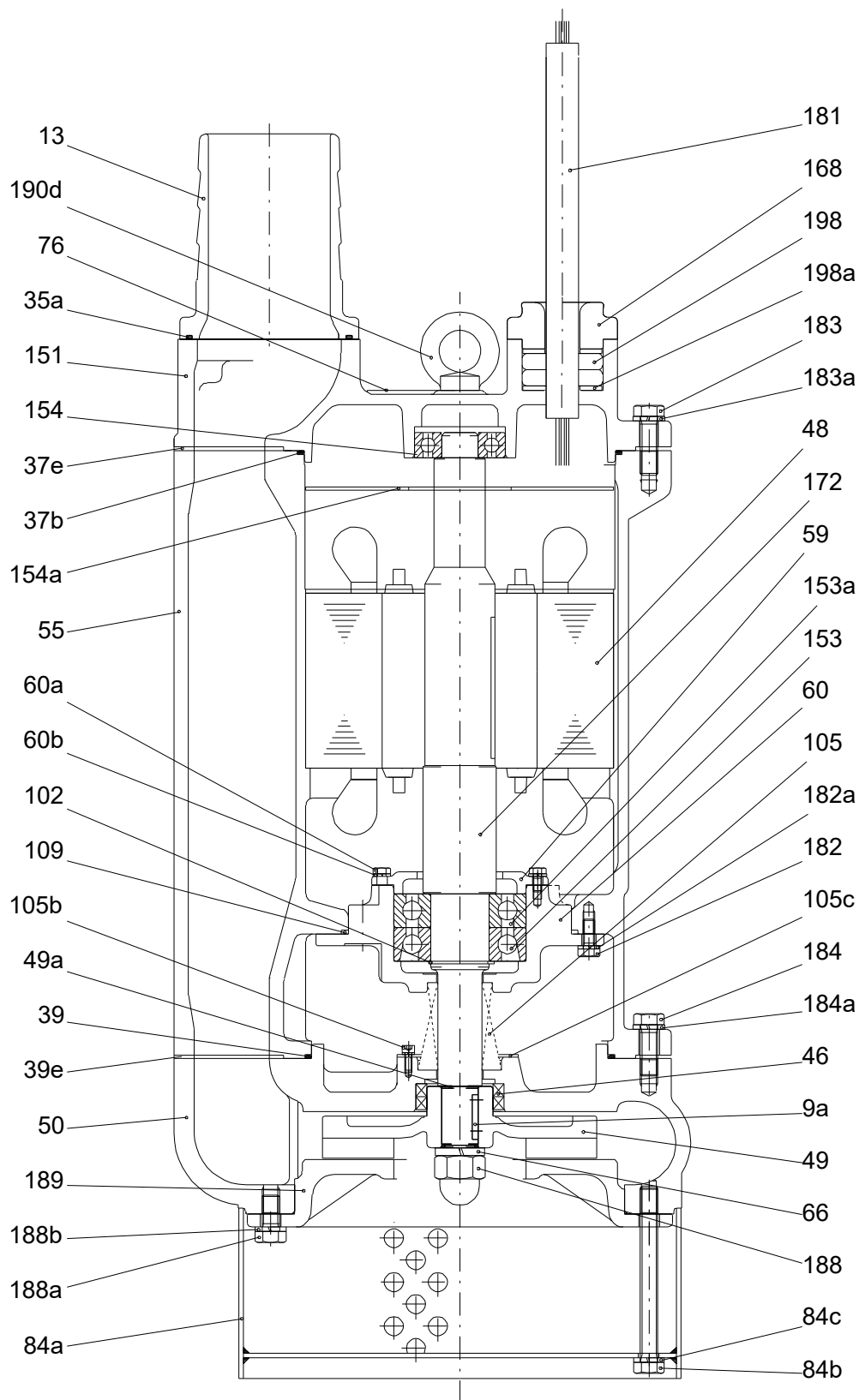

Spare parts DWK.O.13.150.75.6.0D, Product No. 96922699

Produced After 0918 (production year and week number)

Pos	Description	Annotation	Classification Data	Part no.	Qty.	Unit
-	Kit, Bearing			96884156	1	pcs
102	Stop ring				1	
153a	Ball bearing				1	
153	Angular-contact bearing				1	
154	Ball bearing				1	
-	Kit, Cable			97793013	1	pcs
181	Power cable				1	
198	Rubber bush				2	
-	Kit, Cable entry			96884227	1	pcs
168	Cable gland				1	
181b	Spring lock washer				2	
181a	Hex head bolt				2	
198a	Washer				2	
198	Rubber bush				2	
524	Cable sleeve				4	
524	Cable sleeve				4	
525	Heat-shrink sleeving				4	
525	Heat-shrink sleeving				4	
526	Tape				1	
-	Kit, Cable gland			99948145	1	pcs
	Rubber bush				1	
168	Cable gland				1	
198b	Rubber bush				1	
-	Kit, Impeller			96884241	1	pcs
9a	Key				1	
46	Sealing part				1	
49a	Washer				2	
49	Impeller				1	
66	Washer				1	
188	Cap nut				1	
-	Kit, Repair			96884265	1	pcs
-	O-ring				1	
35a	O-ring					
37c	Rubber					
37c	Rubber					
37b	O-ring					
39	O-ring					
109	O-ring					
193	Plug				1	
-	Kit, Shaft seal			96884176	1	pcs
105b	Pan head screw				3	
105	Mechanical seal				1	
-	Kit, Stator, shaft w/rotor			99788586	1	pcs
48	Stator				1	
172	Shaft				1	
-	Kit, Suction cover			96884260	1	pcs
188b	Spring lock washer				3	
188a	Hex head screw				3	
189	Suction cover				1	
	Sensor			99736062	1	pcs
48	Stator			99788633	1	pcs
50	Pump housing			96961307	1	pcs
60	Bearing housing			96958074	1	pcs



Company name:

Created by:

Phone:

Date:

13/10/2022

Pos	Description	Annotation	Classification Data	Part no.	Qty.	Unit
66	Washer			99212865	1	pcs
84a	Strainer			96961310	1	pcs
151	Bracket			96961268	1	pcs
154a	Insulation			99516900	1	pcs
172	Shaft			96957835	1	pcs
183a	Spring lock washer			99561430	4	pcs
183a	Spring lock washer			99833361	4	pcs
183	Hex head screw			99850476	4	pcs