

A

B

C

D

E

F

A

B

C

D

E

F

11/15/2022 11:30:03 AM

File Path

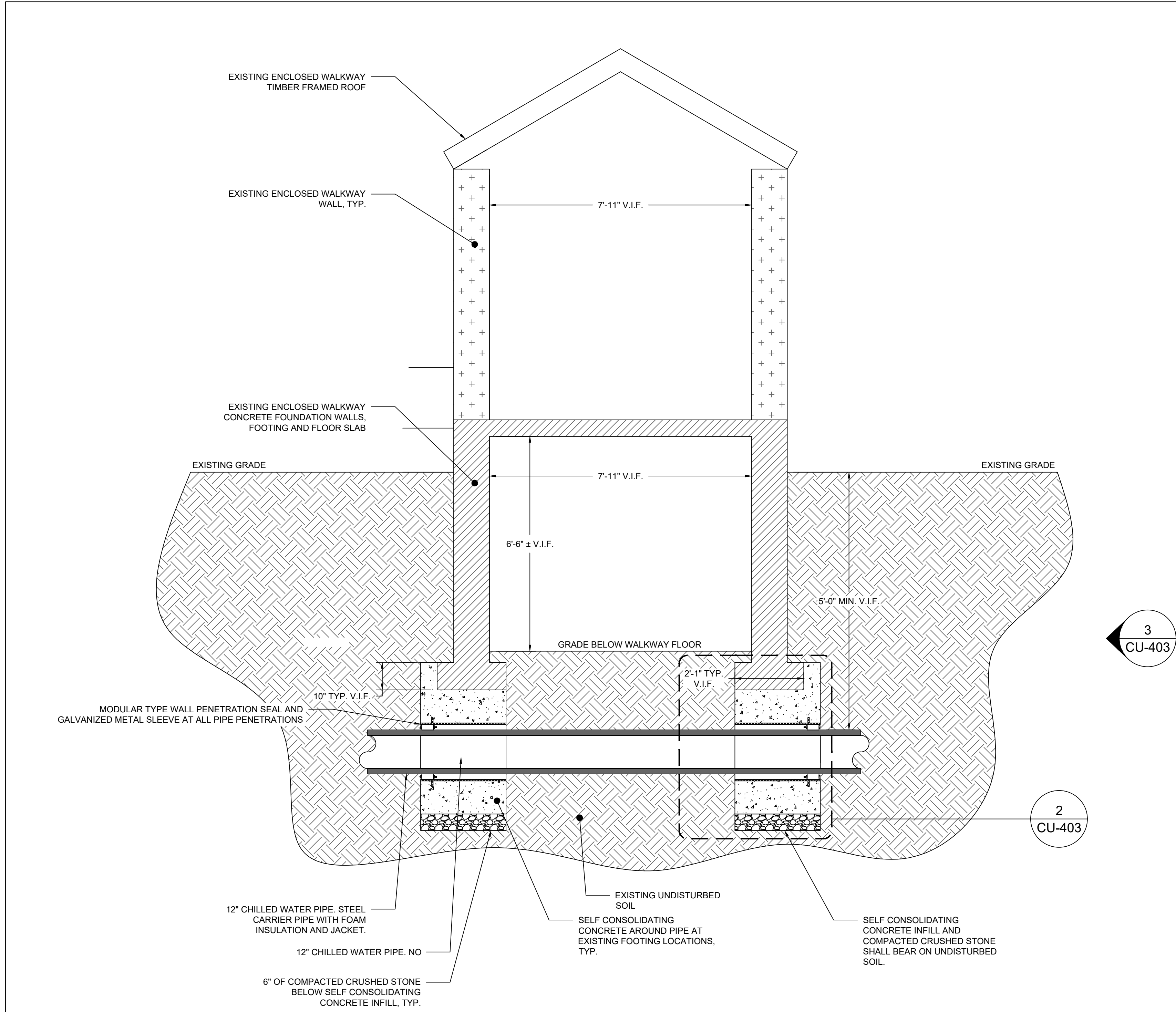

1 PIPE UNDER ENCLOSED WALKWAY - SECTION VIEW
NTS

NOTES:

1. THE CONTRACTOR SHALL BE SOLELY RESPONSIBLE FOR DESIGN, INSTALLATION AND MAINTENANCE OF ALL TEMPORARY SHORING AND SUPPORT SYSTEMS REQUIRED DURING THE UNDERPINNING PROCESS. THIS INCLUDES ENSURING SAFETY AND STABILITY OF TEMPORARY WORKS IN ACCORDANCE WITH RELEVANT CODES AND STANDARDS.
2. DO NOT BEGIN INSTALLING PIPE BELOW ENCLOSED WALKWAYS UNTIL PIPE ALIGNMENT AND PROFILE SHOP DRAWINGS ARE APPROVED.
3. THE CONTRACTOR MUST PROVIDE ADEQUATE TEMPORARY SHORING TO SUPPORT THE EXISTING STRUCTURE AND PROTECT IT FROM SETTLEMENT, COLLAPSE, OR ANY OTHER FORM OS STRUCTURAL DISTRESS. THE DESIGN AND INSTALLATION OF SUCH SHORING MUST BE CARRIED OUT BY QUALIFIED PERSONNEL AND MUST ADHERE TO INDUSTRY STANDARDS AND BEST PRACTICES.
4. THE CONTRACTOR IS RESPONSIBLE FOR ONGOING MONITORING AND MAINTENANCE OF TEMPORARY SHORING THROUGHOUT THE UNDERPINNING PROCESS.
5. THE CONTRACTOR MUST SUBMIT TO THE ENGINEER THE PROPOSED SELF CONSOLIDATING CONCRETE MIX DESIGN. OPERATIONS TO INSTALL PIPE BELOW ENCLOSED WALKWAYS SHALL NOT BEGIN UNTIL THE MIX DESIGN IS APPROVED.
6. THE CONTRACTOR MUST BLOCK THE WALKWAY FROM PEDESTRIAN USE BEFORE WORK BEGINS AND THROUGHOUT UNDERPINNING OPERATIONS.
7. PRIOR TO COMMENCING UNDERPINNING WORK, THE CONTRACTOR SHALL SUBMIT DETAILED PLANS AND CALCULATIONS FOR TEMPORARY SHORING TO THE STRUCTURAL ENGINEER FOR REVIEW.
8. THE CONTRACTOR SHALL COORDINATE TEMPORARY SHORING SYSTEM WITH OTHER ONGOING CONSTRUCTION OR UNDERPINNING ACTIVITIES TO ENSURE THERE ARE NO CONFLICTS OR SAFETY HAZARDS. ANY CONFLICTS MUST BE RESOLVED PROMPTLY.
9. THE CONTRACTOR MUST COMPLY WITH ALL LOCAL BUILDING CODES, SAFETY REGULATIONS AND INDUSTRY STANDARDS PERTAINING TO TEMPORARY SHORING AND UNDERPINNING WORK.
10. IN THE EVENT OF AN EMERGENCY INVOLVING THE TEMPORARY SHORING SYSTEM, THE CONTRACTOR MUST HAVE A CONTINGENCY PLAN IN PLACE TO ENSURE THAT ALL RELEVANT PERSONNEL ARE AWARE OF THE PROCEDURES TO FOLLOW.
11. ALL EXCAVATIONS BELOW EXISTING FOOTINGS SHALL BE HAND DUG.

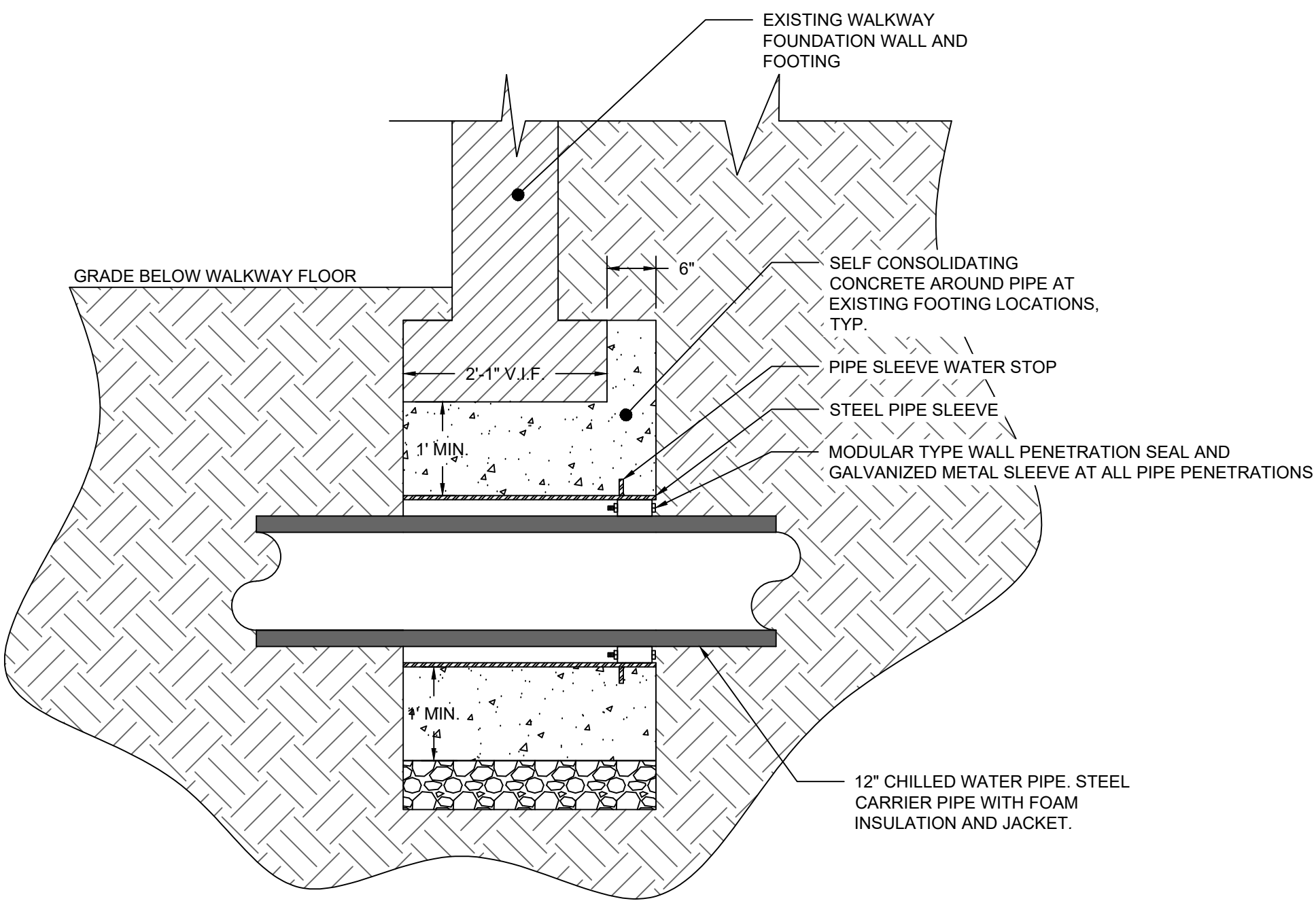

2 PIPE UNDER ENCLOSED WALKWAY FOOTING
NTS

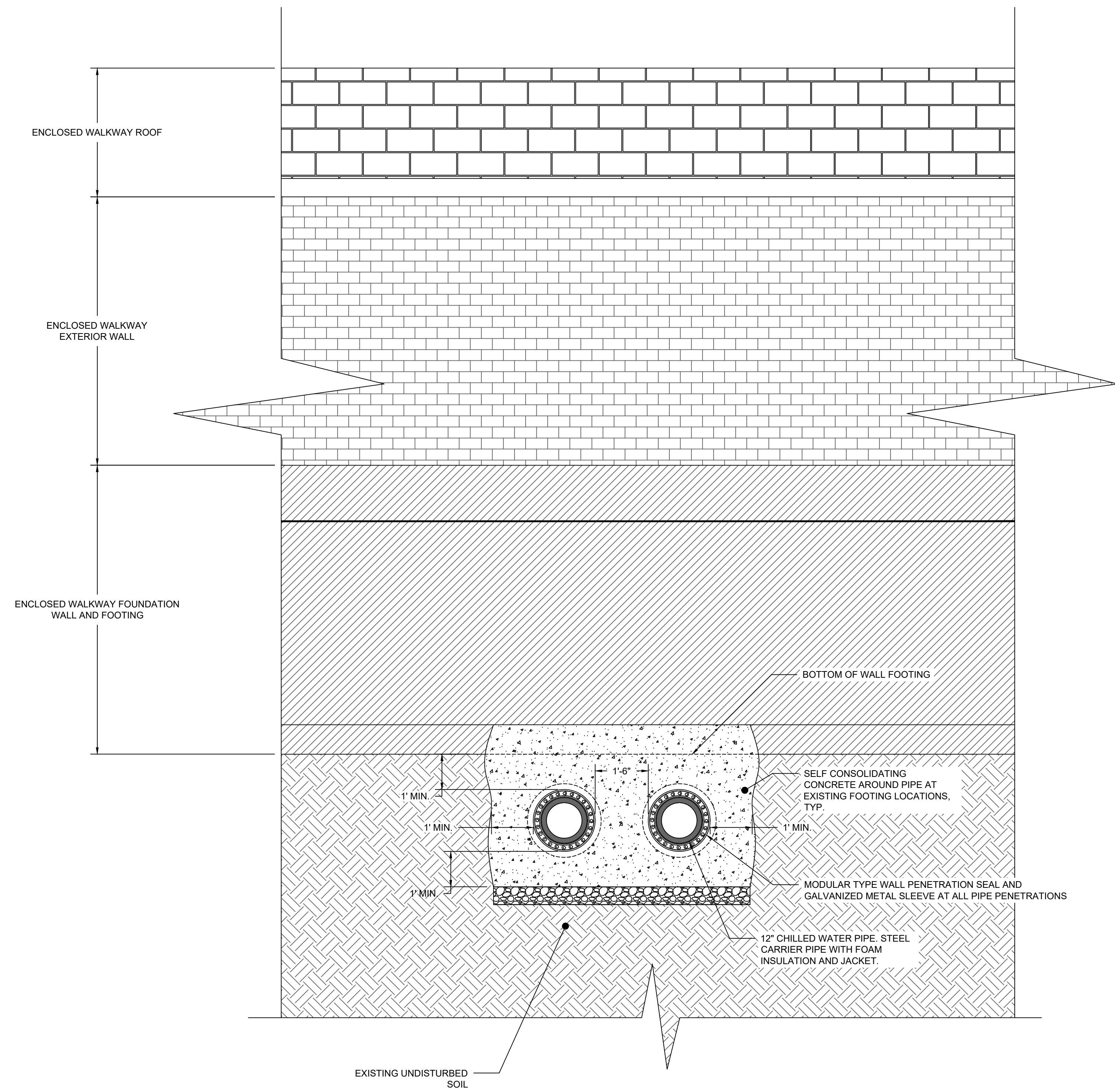

3 PIPE UNDER ENCLOSED WALKWAY - ELEVATION VIEW
NTS

<div>ISSUED FOR DD SUBMISSION</div> <div>Revisions:</div>		<div>4/22/24</div> <div>Date:</div>	<div>DESIGNER OF RECORD</div> <div>A/E:</div> <div>WATSON ENGINEERING, P.C.</div> <div>4500 STATE ROUTE 434</div> <div>APALACHIN, NEW YORK, 13732</div> <div>607-223-4334</div>		<div>STAMP</div> <div>NOT FOR CONSTRUCTION</div>	<div>Office of Construction and Facilities Management</div> <div>VA</div> <div>U.S. Department of Veterans Affairs</div>	<div>Drawing Title</div> <div>PRECAST CONCRETE VAULT DETAILS</div> <div>Approved: Project Director</div>	<div>Phase</div> <div>95% COSTING SET</div> <div>Scale</div>	<div>Project Title</div> <div>REPLACE CHILLED WATER LINES PHASE I</div> <div>Location</div> <div>LEBANON VA MEDICAL CENTER</div> <div>Issue Date</div> <div>6/20/24</div> <div>Checked</div> <div>JWE</div> <div>Drawn</div> <div>MJM</div>	<div>Project Number</div> <div>595-21-101</div> <div>Building Number</div> <div>CU-403</div>
---	--	-------------------------------------	---	--	--	--	--	--	---	--