



STRUT 1

TOP OF
WALL IS
1' ABOVE
BEAM ON
THIS
SIDE

TOP OF
WALL IS 1'
ABOVE BEAM

STRUT 2

Two way
Traffic



Two way
Traffic

KEEP
LEFT

Strut 1 n.t.s

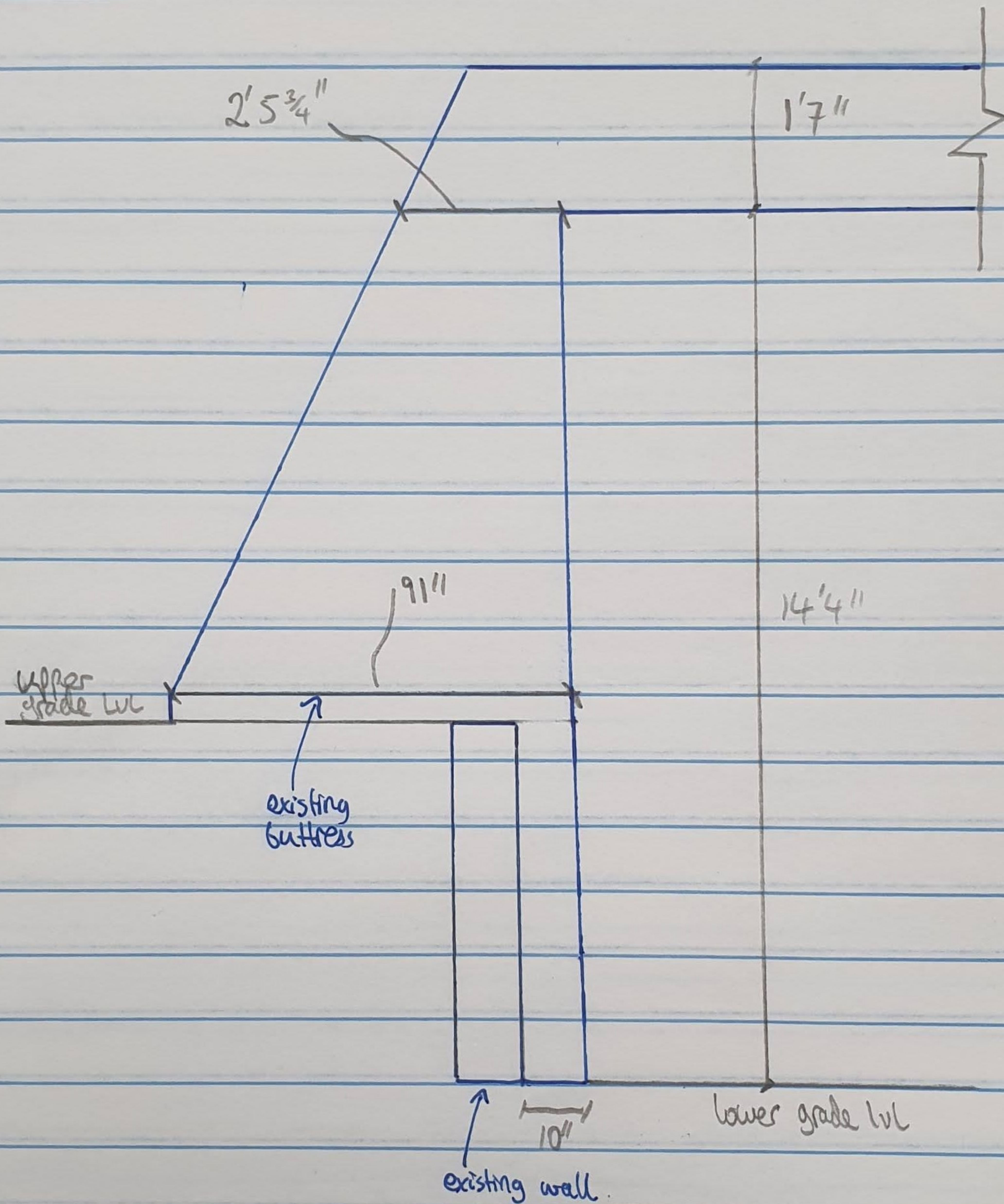

Strut 2 n.t.s

