

Method 1

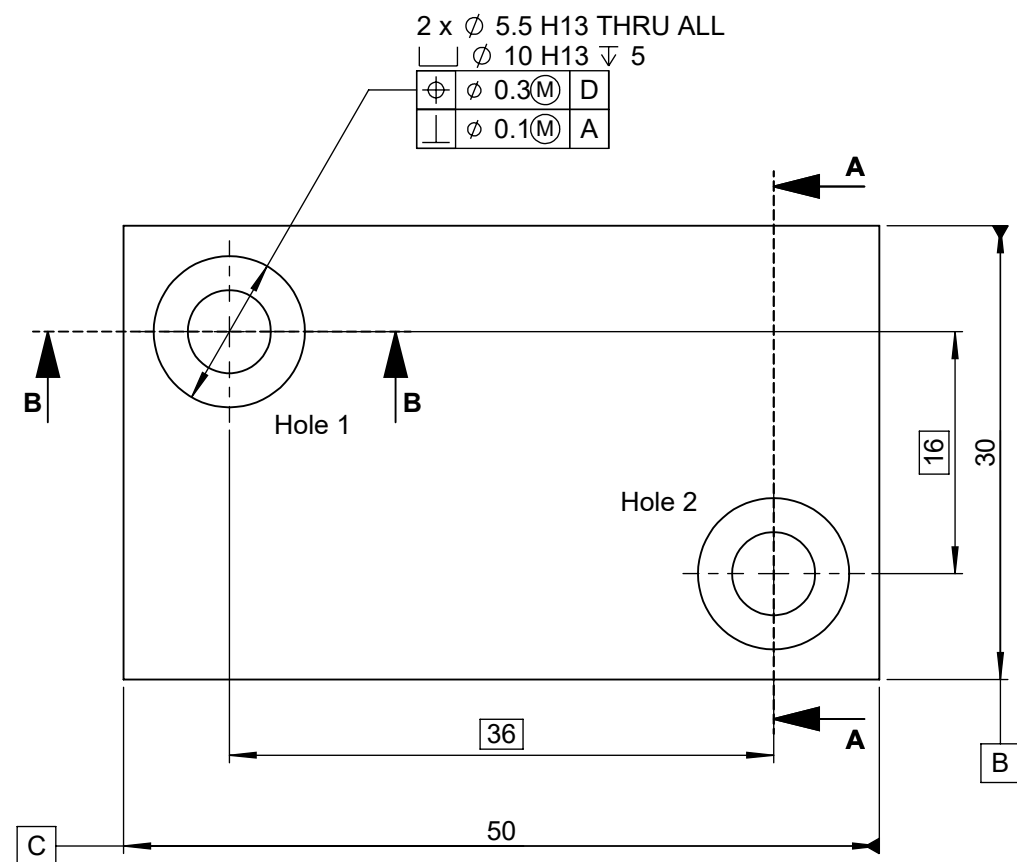

Method 2

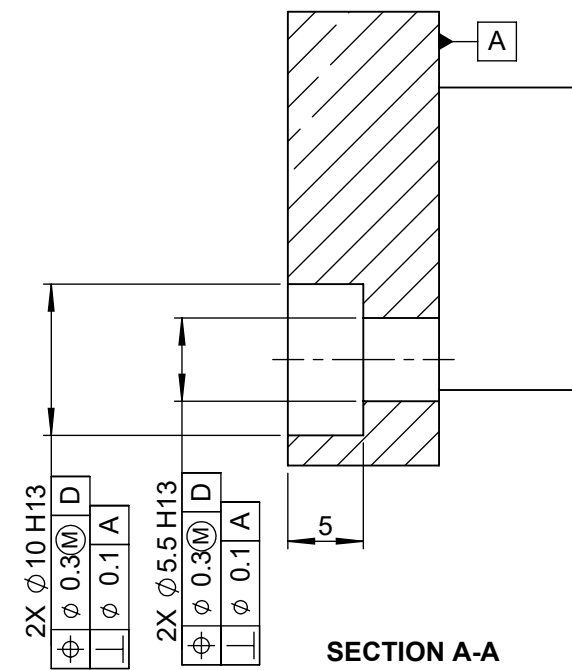

Method 3

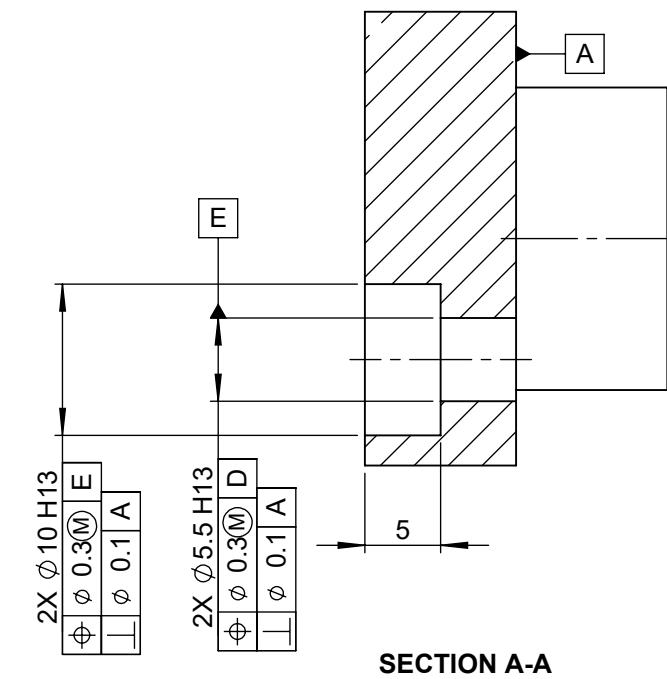

Requirement:

- 1) Axis of dia 20 to be positioned at centre of the rectangle.
- 2) Two clearance hole dia 5.5 to be positioned equally away from axis of dia 20.
- 3) Two counter bore dia 10 to be positioned coaxial to the axis of clearance hole dia 5.5.

Doubts:

- 1) Which method (1 or 2 or 3) is correct and why other methods are wrong?
- 2) Is it possible to define single axis as a datum without affecting the orientation of the holes as displayed?
- 3) Does the method 2, implies SIMULTANEOUS REQUIREMENT?
- 4) Does the method 3, datum E is simulated from hole 1 for counter bore of hole 1 and datum E is simulated from hole 2 for counter bore of hole 2?

Assumed tolerance zones

