

GENERAL NOTES:

1. ALL CONSTRUCTION SHALL CONFORM WITH THE PROVISIONS OF THE INTERNATIONAL RESIDENTIAL CODE/2015, NJ EDITION, OSHA, AND ALL STATE AND LOCAL LAWS AND THEIR SUPPLEMENTS.
2. THE CONTRACTOR SHALL BE RESPONSIBLE FOR DETERMINING THE LOCATION OF ANY UTILITIES IN THE VICINITY OF THE CONSTRUCTION AND SHALL COMPLETE THE CONSTRUCTION IN A MANNER WHICH WILL PREVENT DAMAGE TO THEM. SHOULD ANY DAMAGE TO SUCH UTILITIES OCCUR, THE CONTRACTOR SHALL REPAIR THE DAMAGE AT ITS OWN EXPENSE AND TO THE SATISFACTION OF THE OWNER.
3. THE CONTRACTOR SHALL FIELD CHECK AND VERIFY ALL DIMENSIONS AND ELEVATIONS OF EXISTING WORK PRIOR TO THE START OF FABRICATION & CONSTRUCTION.
4. CONTRACTOR IS TO CONTACT OWNER’S REPRESENTATIVE AND ENGINEER OF RECORD IN WRITING OF ANY CHANGES IN THE PLANS WITH RESPECT TO FIELD CONDITIONS OR DEVIATIONS FROM THE PLANS WITH REGARDS TO CONSTRUCTION.
5. CONTRACTOR SHALL PROVIDE ALL NECESSARY TEMPORARY SHORING REQUIRED TO RETAIN THE STABILITY OF THE STRUCTURE WHILE RENOVATION TAKES PLACE.
6. CONTRACTOR IS RESPONSIBLE FOR OBTAINING ALL PERMITS AND SCHEDULING OF ALL INSPECTIONS.

WOOD NOTES:

1. SAWN LUMBER AND ENGINEERED LUMBER MUST NOT BE INSTALLED IN DIRECT CONTACT WITH CONCRETE OR MASONRY CONSTRUCTION PER CODE AND SHALL BE USED IN COVERED, DRY–USE CONDITIONS ONLY (MOISTURE CONTENT LESS THAN 16%).
2. WOOD JOISTS AND BLOCKING MUST BE RESTRAINED AGAINST ROTATION.
3. 4x6 WOOD MEMBERS ARE TO BE PRESSURE TREATED.
4. THE FRAMING LUMBER SHALL HAVE THE FOLLOWING ENGINEERING PROPERTIES (DOUGLAS– FIR #2 OR BETTER)

STRUCTURAL STEEL NOTES:

1. DESIGN, DETAILING, FABRICATION, AND ERECTION OF STRUCTURAL STEEL SHALL CONFORM TO THE REQUIREMENTS OF THE AISC "SPECIFICATION FOR THE DESIGN, FABRICATION AND ERECTION OF STRUCTURAL STEEL FOR BUILDING", 13TH EDITION AND WITH ALL LOCAL LAWS AND ORDINANCES AND OSHA REQUIREMENTS.
2. ALL WELDING SHALL CONFORM TO THE SPECIFICATIONS OF THE AMERICAN WELDING SOCIETY (AWS) D1.1, WELDING ELECTRODES SHALL BE E-70 SERIES. NO SINGLE PASS FILLET WELD SHALL EXCEED 5/16" WELDS SHALL BE 3/16" FILLET WELD UON.
3. ALL CONSTRUCTION MATERIALS SHALL BE NEW AND IN ACCORDANCE WITH THE SPECIFICATIONS AND THE FOLLOWING GRADES, UNLESS NOTED OTHERWISE: SHAPES (TUBES, W, & WT): ASTM A992 AND ALL OTHERS: ASTM A36
4. SURFACE PREPARATION SHALL CONFORM TO SSPC–SP–6. ALL STRUCTURAL STEEL SHALL RECEIVE A PRIME COAT OF RUST INHIBITING PAINT & A TOP COAT OF FINISH PAINT PER THE OWNER’S REQUIREMENTS OR SHALL MATCH EXISTING PAINTING SYSTEM.
5. SHOP CONNECTIONS SHALL BE WELDED OR BOLTED. FIELD CONNECTIONS SHALL BE BOLTED UNLESS OTHERWISE INDICATED. ALL BOLTED CONNECTIONS SHALL BE MADE WITH HIGH STRENGTH BOLTS.
6. HIGH STRENGTH BOLTS SHALL BE 1/2"Ø IN 3/8"Ø. HOLES (UNLESS OTHERWISE NOTED) CONFORMING TO ASTM A-325. LATEST EDITION.
7. HIGH STRENGTH BOLTED CONNECTIONS SHALL BE OF BEARING TYPE. CONFORMING TO THE AMERICAN INSTITUTE OF STEEL CONSTRUCTION "SPECIFICATION FOR STRUCTURAL JOINTS USING ASTM A-325 OR A-490 BOLTS" LATEST EDITION.
8. CONTRACTOR SHALL FURNISH ALL PLATES, CLIP ANGLES, AND CONNECTIONS, ETC. AS REQUIRED FOR COMPLETION OF THE STRUCTURE, EVEN IF SUCH ITEMS ARE NOT EXPLICITLY CALLED FOR ON THE STRUCTURAL DRAWINGS.
9. GUSSET PLATES AND CONNECTION ANGLES SHALL HAVE A MINIMUM THICKNESS OF 5/16"
10. PROJECTING CORNERS, BURRS, AND SHARP EDGES SHALL BE GROUND SMOOTH.
11. WELDING SEQUENCE AND PROCEDURES SHALL BE SUCH AS TO MINIMIZE DISTORTION AND SHRINKAGE.
12. ALL STRUCTURAL STEEL COMPONENTS SHALL BE FABRICATED AND SHOP ASSEMBLED TO THE MAXIMUM EXTENT POSSIBLE CONSISTENT WITH SHIPPING CONSIDERATIONS.

GROUT NOTES:

1. GROUT IS TO BE NON–SHRINK

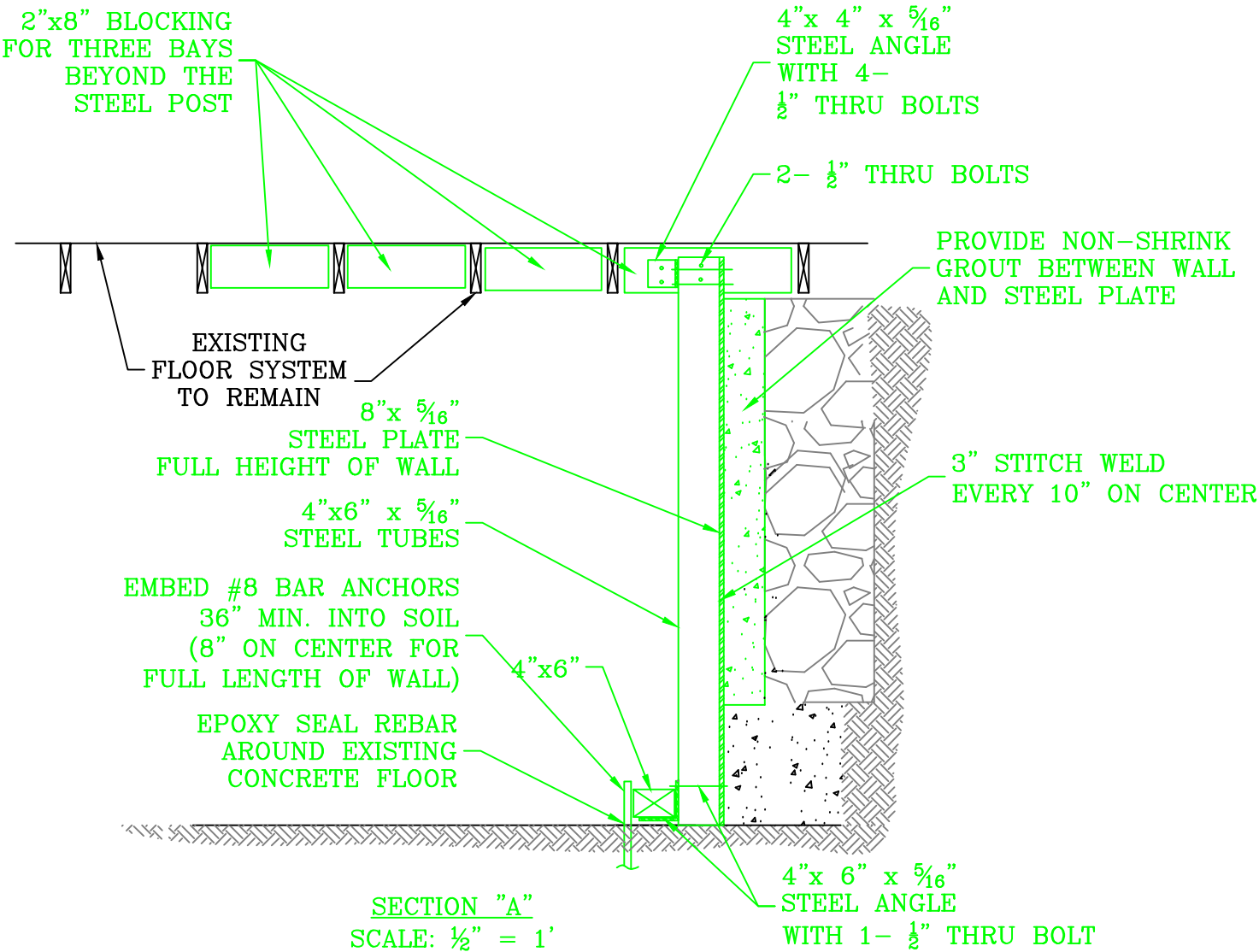

CAUTION!

1. DO NOT SCALE DRAWINGS. FIELD MEASURE PRIOR TO PURCHASING OF MATERIALS.
2. DO NOT OFF LOAD HOUSE STRUCTURE FROM WALL. INSTALL REINFORCEMENT LOOSE AND LOAD WITH GROUT.

STRUCTURAL REINFORCEMENT OF BULGING RUBBLE FOUNDATION WALL				
DESIGNED BY: J.G.	DRAWN BY: R.S.	REVISIONS		PROJECT:  3 LAMINGTON RD. READINGTON, (WHITEHOUSE STATION POST STOP) NJ BLOCK: 13, LOT 52
APPROVED BY: J.G.	CHECKED BY: J.G.	NO.	DATE	
JAMES GUIDER, P.E.				<div>J. Guider &amp; Associates, P.C. Consulting Engineers and Designers</div> <div>364 PARSIPPANY ROAD &gt; UNIT 10B &gt; PARSIPPANY, NJ 07054 TELEPHONE 973/428-1101 &gt; FAX 973/428-1308 E-MAIL: JGA@JGUIDER.COM / WEB: WWW.JGUIDER.COM</div> <div>ENVIRONMENTAL &gt; CIVIL/STRUCTURAL &gt; FORENSIC</div>
N.J. PROFESSIONAL ENGINEER NO. 32411		SCALE: AS NOTED		DATE: 04/23/19
				SHEET: 2 of 2