

**STANDARD LOAD TABLE FOR OPEN WEB STEEL JOISTS, K-SERIES**  
Based on a 50 ksi Maximum Yield Strength - Loads Shown in Pounds per Linear Foot (plf)

| Joist Designation      | 24K4       | 24K5       | 24K6       | 24K7       | 24K8       | 24K9       | 24K10      | 24K12      | 26K5       | 26K6       | 26K7       | 26K8       | 26K9       | 26K10 |
|------------------------|------------|------------|------------|------------|------------|------------|------------|------------|------------|------------|------------|------------|------------|-------|
| Depth (In.)            | 24         | 24         | 24         | 24         | 24         | 24         | 24         | 24         | 26         | 26         | 26         | 26         | 26         | 26    |
| Approx. Wt. (lbs./ft.) | 8.4        | 9.3        | 9.7        | 10.1       | 11.5       | 12.0       | 13.1       | 16.0       | 9.8        | 10.6       | 10.9       | 12.1       | 12.2       | 13.8  |
| Span (ft.)             | 18.0       | 22.2       | 23.9       | 25.1       | 28.1       | 29.5       | 32.9       | 41.7       | 21.8       | 23.7       | 24.7       | 28.1       | 28.7       | 33.0  |
| 41                     | 176<br>101 | 198<br>114 | 216<br>124 | 241<br>137 | 266<br>150 | 290<br>162 | 344<br>191 | 427<br>235 | 215<br>134 | 235<br>146 | 262<br>162 | 289<br>177 | 315<br>192 |       |
| 42                     | 168<br>94  | 189<br>106 | 206<br>115 | 229<br>127 | 253<br>139 | 276<br>151 | 327<br>177 | 417<br>224 | 205<br>125 | 224<br>136 | 249<br>150 | 275<br>164 | 300<br>178 |       |
| 43                     | 160<br>88  | 180<br>98  | 196<br>107 | 219<br>118 | 242<br>130 | 263<br>140 | 312<br>165 | 406<br>213 | 196<br>116 | 215<br>126 | 238<br>140 | 263<br>153 | 286<br>166 |       |
| 44                     | 153<br>82  | 172<br>92  | 187<br>100 | 209<br>110 | 231<br>121 | 251<br>131 | 298<br>154 | 387<br>199 | 187<br>108 | 204<br>118 | 227<br>131 | 251<br>143 | 273<br>155 |       |
| 45                     | 146<br>76  | 164<br>86  | 179<br>93  | 199<br>103 | 220<br>113 | 240<br>122 | 285<br>144 | 370<br>185 | 179<br>101 | 194<br>110 | 217<br>122 | 240<br>133 | 261<br>145 |       |

probable joist design



typical efflorescence under paint

typical joist bearing with bottom chord extension

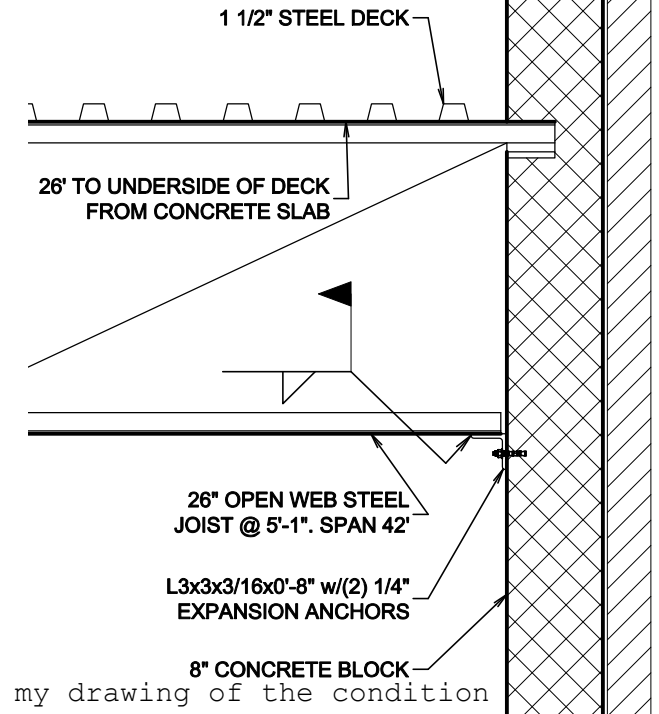

my drawing of the condition



bottom chord angle



series of joists