

| SPLICE BOLT TABLE |     |     |     |     |      |       |
|-------------------|-----|-----|-----|-----|------|-------|
| Mark              | Qty | Top | Bot | Int | Type | Dia   |
| CL1-1             | 8   | 8   | 0   |     | A325 | 0.500 |
| CL1-2             | 8   | 8   | 0   |     | A325 | 0.500 |

| MEMBER SIZE TABLE |          |              |
|-------------------|----------|--------------|
| MARK              | MEMBER   | LENGTH       |
| RF1-1             | 10x55D12 | 10'-9 13/16" |
| RF1-2             | 10x55D14 | 20'-9 5/8"   |

| CONNECTION PLATES |           |
|-------------------|-----------|
| ID                | Mark/Part |
| 1                 | CL1-1     |
| 2                 | CL1-2     |
| 3                 | CLC101    |
| 4                 | CLC100    |
| 5                 | CLC003    |

▽ FLANGE BRACES: Both Sides(U.N.)  
FB20.2B(1): 20.2=length(in), (1)=one side  
B - L2X2X10G

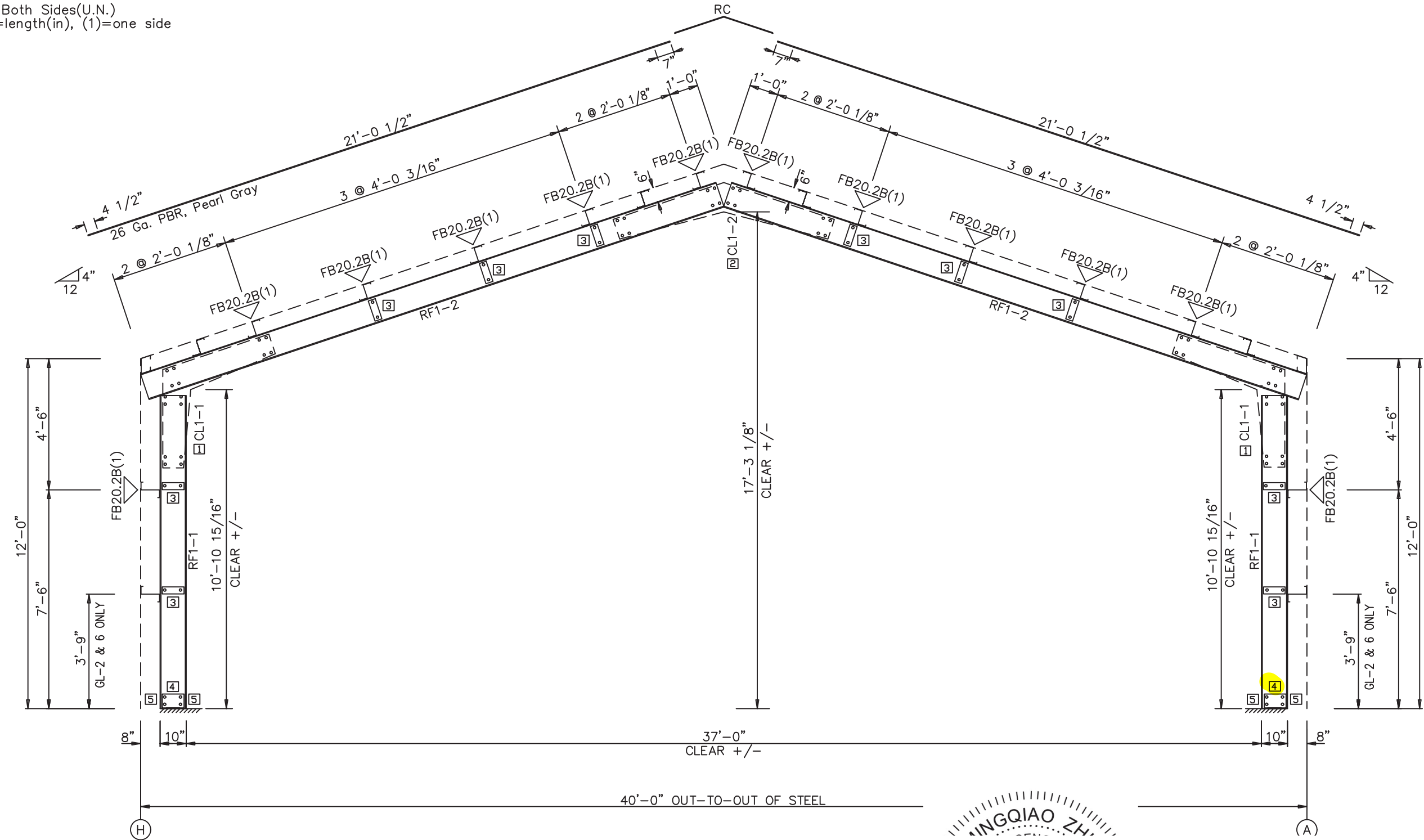

GENERAL NOTES:  
MINOR FIELD WORK OF STRUCTURAL, SECONDARY AND PANEL/TRIM ITEMS MAY BE NECESSARY TO ENSURE PROPER FIT. SUCH WORK IS CONSIDERED A NORMAL PART OF METAL BUILDING ERECTION. WE WILL NOT HONOR BACKCHARGES FOR MINOR FIELD WORK.

