

NOTES:

- 1) INSTALL ITEM (15) USING ITEM (16) AND LEAVE FINGER TIGHT.
- 2) LOCATE ITEM (17) OVER ITEM (15) THEN PLACE ITEM (18) AROUND ITEM (17).
- 3) WHEN ASSEMBLING ITEM (18) ONTO ITEM (17) ENSURE THEY ARE ALSO WRAPPED AROUND THE UNDERSIDE OF ITEM (15). LEAVE ITEM (18) SNUG ENOUGH TO ADJUST ITEM (17) AS NEEDED.
- 4) DURING INSTALLATION YOU WILL ALSO NEED TO ALIGN ITEM (17) TO THE TURBO OF ITEM (1). THE TURBO HAS STUDS THAT PROTRUDE OUTWARD. SLIDE ITEM (19) OVER THE TURBO STUDS, THEN ALIGN THE SLOTTED HOLES OF ITEM (17) AND INSTALL ITEM (20)

FOR REFERENCE ONLY - CONFIRM WITH ENGINEERING BEFORE BUILDING

	FAN P/N	SPACER P/N	BOLT P/N & BOLT DESCRIPTION	WASHER P/N	LOCK WASHER P/N
PUSHER	MWD34P	79210038	91280A559 - M8-1.25 x 85mm LEG x 22mm THD LEG	91166A270	91202A238
SUCTION	MWD34S	79210039	91280A562 - M8-1.25 x 100mm LEG x 22mm THD LEG	91166A270	91202A238

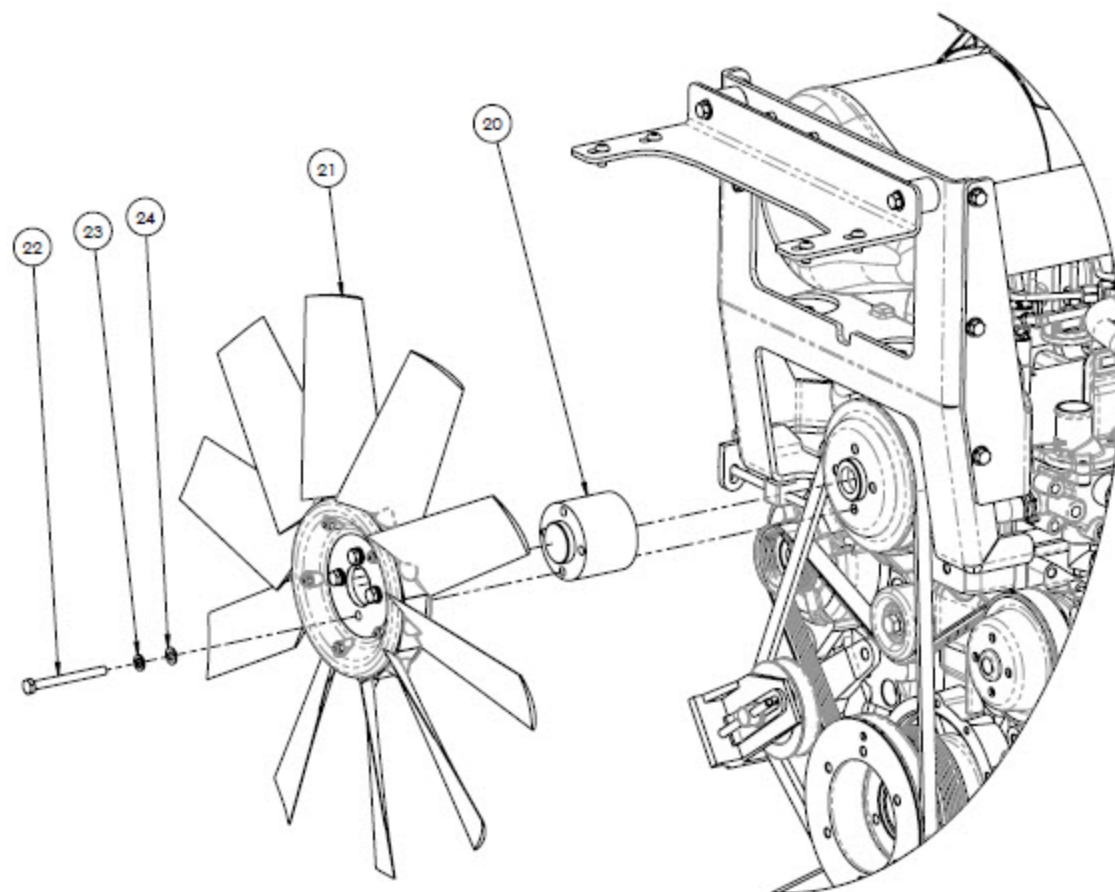

ITEM NO.	PART NUMBER	DESCRIPTION	QTY
1		3.4 POWER UNIT - 130hp	1
2		D34 BRACKET KIT	1
3		D34, 130hp UPPER MOUNTING BRACKET	1
4		REAR LEG KIT	1
5		MUFFLER, CATALYTIC, SCR	1
6		CLAMP ASSY, EXHAUST	2
7		MODULE, DOSING	1
8		GASKET	1
9		COVER, END PLATE	1
10		GASKET, FLANGE	1
11		BOLT, HEX, FLANGE	3
12		GASKET, FLANGE	1
13		CLAMP, PIPE	1
14		2.812"-3.750"ID, WORM DRIVE CLAMP .500" WIDE	2
15		BRACKET, MUFFLER	1
16		BOLT, HEX	4
17		MUFFLER, CATALYTIC	1
18		CLAMP ASSY, EXHAUST	1
19		NUT, FLANGE	3
20		D34 FAN SPACER 60mm PUSHER FAN	1
21		D34 - 74, 97.4, & 130hp PUSHER FAN, FITS RCP HD AND COMPACT	1
22		M8 x 1.25mm x 85mm x 22mm	4
23		M LW 8.5mm x 14.8mm x 1.9mm	4
24		MGPFW - 16mm x 8.4mm x 1.4mm	4

NOTES:

- 1) REMOVE THE ORIGINAL BOLTS FROM THE WATER PUMP PULLEY.
- 2) INSTALL THE PROPER SPACER (20), FAN (21), BOLTS (22), LOCK WASHER (23), AND FLAT WASHER (24).
- 3) USE BLUE LOCK TIGHT ON ALL FAN BOLTS. TORQUE DOWN ALL BOLTS TO THEIR PROPER TORQUE SPEC. (SEE SHT 16 FOR TORQUE SPECS).
- 4) SPACER, FAN AND BOLT CAN VARY DEPENDING ON FAN DIRECTION, HEAVY DUTY VERSUS COMPACT RADIATOR AND/OR ENGINE SIZE.
- 5) DOUBLE CHECK THE CORRECT BOLTS ARE BEING USED. **INCORRECT BOLT LENGTH COULD CAUSE CATASTROPHIC FAILURE.**



TITLE:
D34 130hp W/ RCP COOLING PACKAGE
- HEAVY DUTY

PROPRIETARY AND CONFIDENTIAL
THE INFORMATION CONTAINED IN THIS DRAWING IS THE SOLE PROPERTY OF EVAPAR ANY
REPRODUCTION IN PART OR AS A WHOLE WITHOUT THE WRITTEN PERMISSION OF EVAPAR IS
PROHIBITED.

DO NOT SCALE DRAWING

MATERIAL:
WEIGHT:
1376.61 Lbs.

FINISH:
COLOR CODE:

DWG. NO.:
L-A-0010

SCALE: 1:4
SHT: 8/16

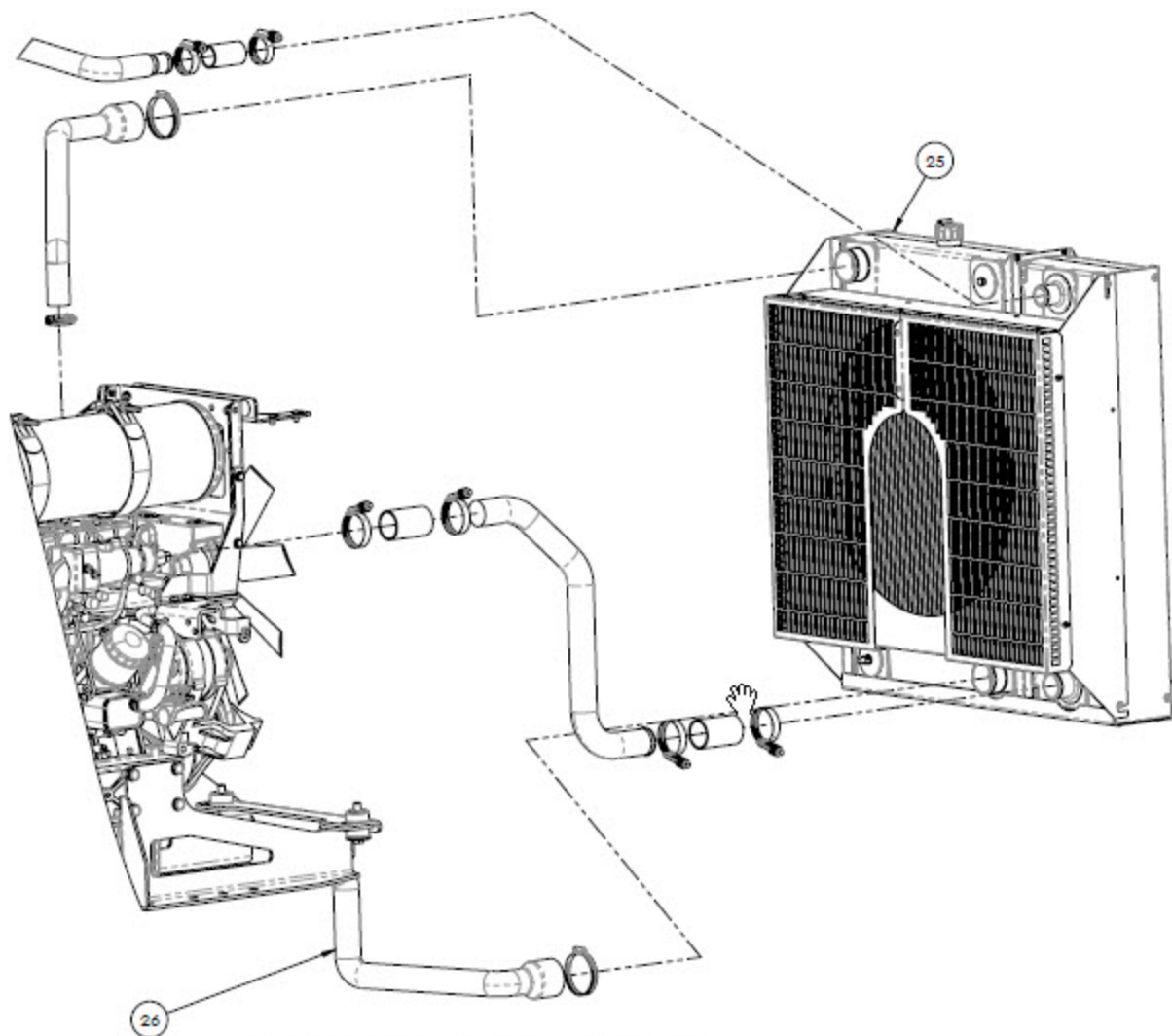

HOSE AND PIPE KIT TO RADIATOR

ITEM NO.	PART NUMBER	DESCRIPTION	QTY.
1		3.4 POWER UNIT - 130hp	1
2		D34 BRACKET KIT	1
3		D34, 130hp UPPER MOUNTING BRACKET	1
4		REAR LEG KIT	1
5		MUFFLER, CATALYTIC, SCR	1
6		CLAMP ASSY, EXHAUST	2
7		MODULE, DOSING	1
8		GASKET	1
9		COVER, END PLATE	1
10		GASKET, FLANGE	1
11		BOLT, HEX, FLANGE	3
12		GASKET, FLANGE	1
13		CLAMP, PIPE	1
14		2.812"-3.750"ID, WORM DRIVE CLAMP .500" WIDE	2
15		BRACKET, MUFFLER	1
16		BOLT, HEX	4
17		MUFFLER, CATALYTIC	1
18		CLAMP ASSY, EXHAUST	1
19		NUT, FLANGE	3
20		D34 FAN SPACER 60mm PUSHER FAN	1
21		D34 - 74, 97.4, & 130hp PUSHER FAN, FITS RCP HD AND COMPACT	1
22		M8 x 1.25mm x 85mm x 22mm	4
23		M LW 8.5mm x 14.8mm x 1.9mm	4
24		MGPFW - 16mm x 8.4mm x 1.4mm	4
25		D34 - HEAVY DUTY RADIATOR	1
26		D34, HOSE AND PIPE COMPLETE KIT, RCP-15-092	1

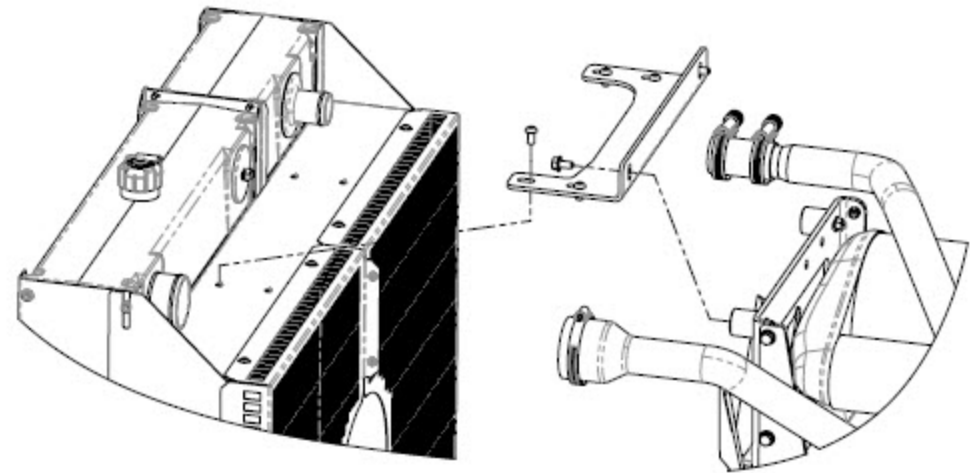

**UPPER MOUNTING BRACKET INSTALLATION
VIEW SCALE 1:5**

NOTES:

- 1) PLACE ALL CLAMPS OVER TUBE AND INSTALL ALL HOSE COUPLERS AND PIPES TO ENGINE, LEAVE ALL CLAMPS LOOSE.
- 2) LOCATE RADIATOR TO PROPER LOCATION AND INSTALL HOSE COUPLERS, AND PIPES TO RADIATOR.
- 3) LOCATE ALL CLAMPS TO DESIRED LOCATION AND SNUG ALL CLAMPS.
- 4) INSTALL UPPER MOUNTING BRACKET. INSTALL ALL FASTENERS AND LEAVE THEM FINGER TIGHT.
- 5) CONFIRM ITEM (25) ALIGNMENT WITH DEPTH OF FAN IN SHROUD. CONFIRM FAN IS CLEAR TO MOVE AND DOES NOT COLLIDE WITH ANY PART OF ITEM (25). ITEM (25) SHOULD BE APPROX 90° FROM FLOOR. IF NOT, ADJUST AS NEEDED.
- 6) TIGHTEN LOWER ISOLATORS TO PROPER TORQUE SPEC (SEE SHT 16 FOR TORQUE SPECS).
- 7) TIGHTEN ALL UPPER MOUNTING BRACKET TO PROPER TORQUE SPEC (SEE SHT 16 FOR TORQUE SPECS).
- 8) TIGHTEN ALL HOSE CLAMPS (CONSTANT AND WORM-DRIVE) TO PROPER TORQUE SPEC (SEE SHT 16 FOR TORQUE SPECS).
- 9) REINSTALL FAN GUARD.
- 10) SEE SHEET 11 FOR FURTHER DETAILS \ SEE SHEET 3 FOR HOSE AND PIPE KIT BOM DETAIL.

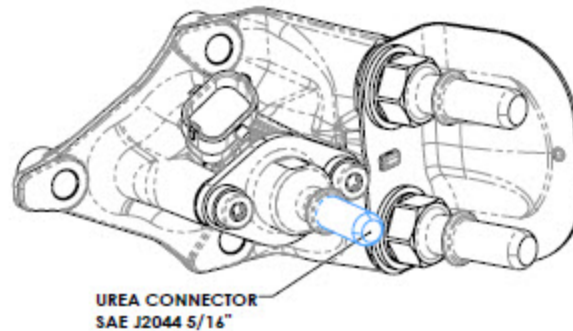
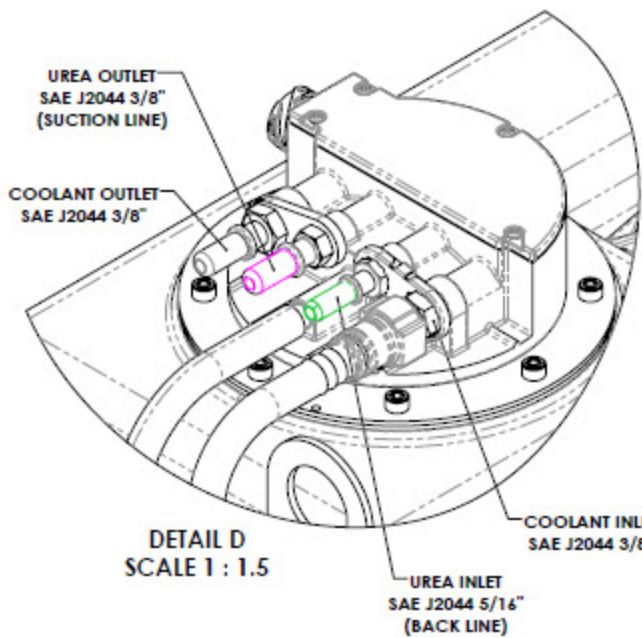

DOSING MODULE
P/N: 300630-00015

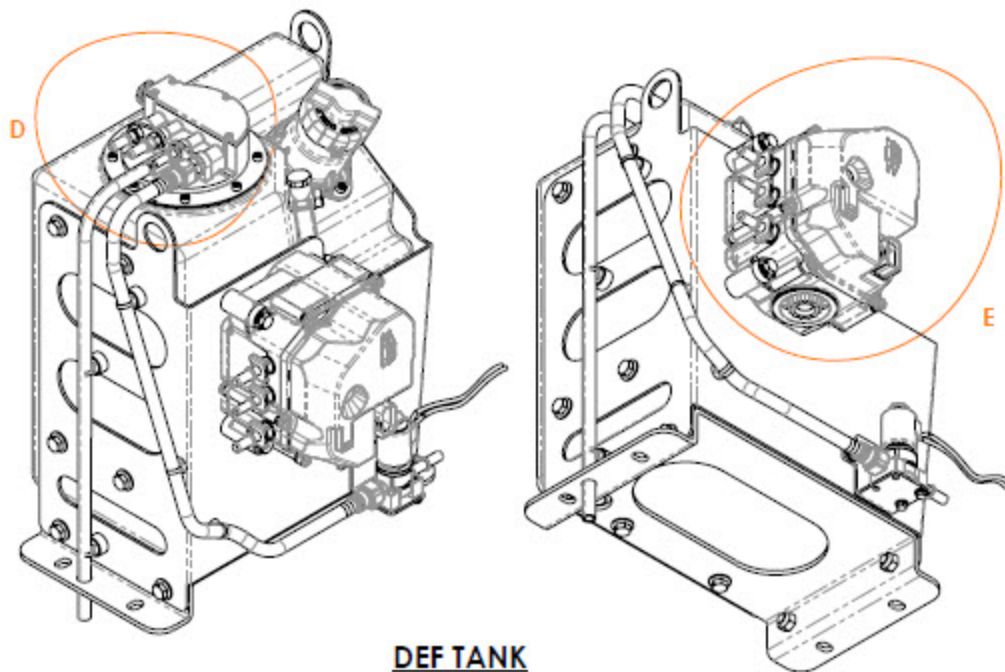
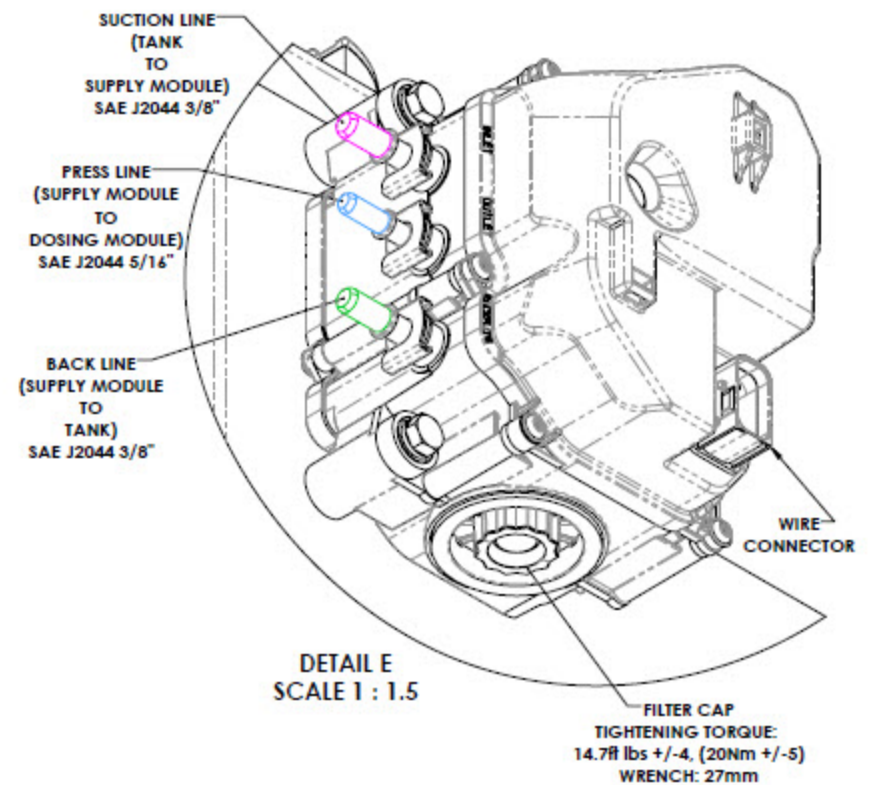

DEF TANK
P/N: 450106-00193A

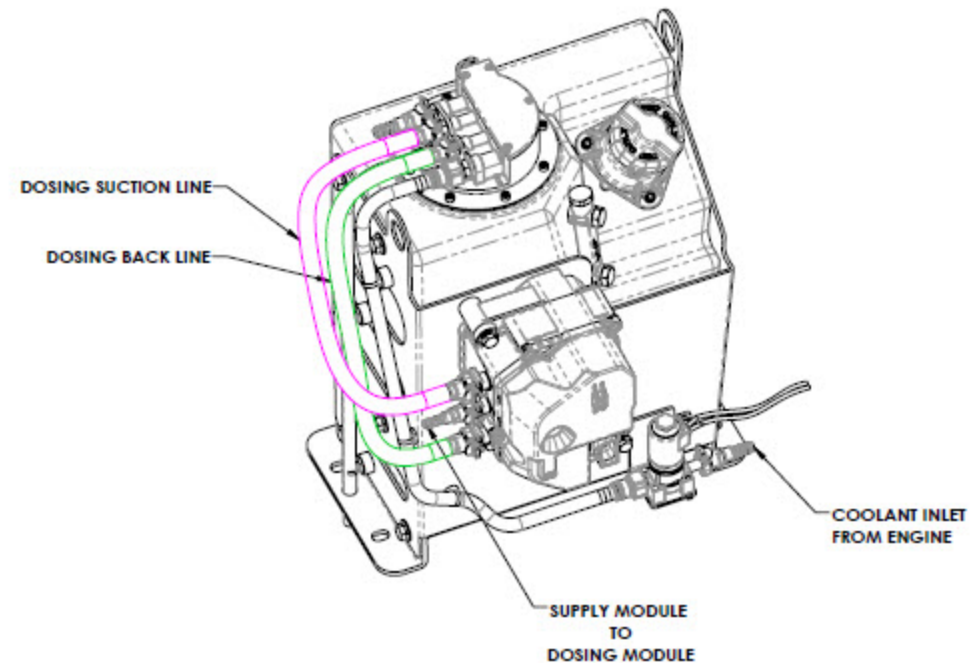

NOTES:

- 1) ALL CONNECTIONS USE QUICK PUSH ON CONNECTORS
- 2) RECOMMENDED PART NO: A624M53 08 02 TO BE USED ON ALL 3/8" ID CONNECTIONS.
- 3) RECOMMENDED PART NO: A614M53 08 02 TO BE USED ON ALL 5/16" ID CONNECTIONS.
- 4) SOME HOSES AND CONNECTIONS ARE SHIPPED FROM DOOSAN WITH THE DEF TANK.
- 5) MATCH THE COLORS TO FIND THE PROPER CONNECTION WHEN INSTALLING THE ALL THE HOSES BETWEEN THE DEF TANK, SUPPLY MODULE, AND DOSING MODULE.
- 6) THE HEATED DEF HOSE, AND PRESS LINE TO DOSING MODULE (UREA) HOSE PART NUMBERS ARE AS FOLLOWS: SCR1150BAFA130, SCR31050ACFA130, SCR31050CCFA130.