



TABOR 8 WINCH

Part Number: 96995

Rated Line Pull: 8000 lbs. (3629 kgs)

Motor: 12V DC, Series Wound

Controls: Remote switch, 12" (3.7m) Lead

Gear train: 3-Stage Planetary

Gear Ratio: 216:1

Clutch (Freespool): Sliding Ring Gear

Brake: Automatic Direct Drive Cone

Drum diameter/length: 2.5"/9.0" (6.4cm/23cm)

Kit Shipping Weight: 80 lbs. (36.3 kgs)

Rope: Synthetic rope, \varnothing 3/8" x 90' (\varnothing 8mm x 27.4m)

Fairlead: Hawse

Recommended Battery: 650CCA Minimum for winching

Duty Cycle: Intermittent

Battery leads: 2 gauge, 72" (1.83m)

Finish: Black Powder Coat

Warranty: Limited Lifetime

Mounting Bolt Pattern: 10.0" x 4.5" (254mm x 114.3mm)

Winch Dimensions: 20.80" L x 6.3" D x 9.8" H (528mm L x 160mm D x 249mm H)

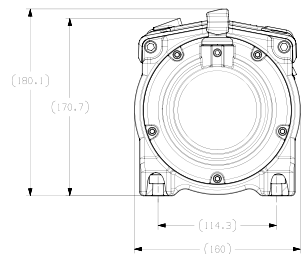
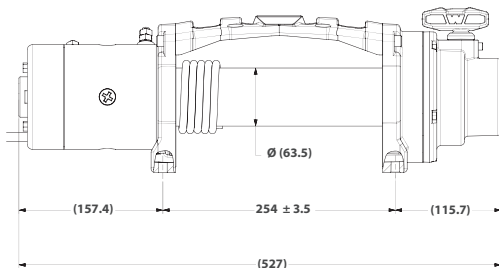

SERVICE INSTRUCTIONS

Should you encounter a problem during installation or operation of your winch, please follow these steps toward resolving the problem:

1. Refer to your operator's guide and installation instructions. It has illustrations and detailed information on the installation and safe and proper operation of your winch. It also includes a replacement parts list and assembly diagrams. If you are unable to resolve the problem, then go to step 2.
2. Contact your dealer where you purchased your winch. If, after discussing the problem with their parts and service staff, you are still unable to resolve the problem then go to step 3.
3. Call an Authorized WARN Service center from the list provided on the back of the warranty sheet included with the product. When calling, please have the following information available: winch model number and purchase date, make, model and year of vehicle.
4. If you are unable to resolve the problem to your satisfaction, please call Warn Industries Customer Service at: 1-800-543-9276. When calling, please have the following information available: winch model number and purchase date, make, model and year of vehicle. You may also contact Warn Industries by visiting our website: www.warn.com

SERVICE/UPGRADE KITS

KIT#	PN	ITEM	QTY	DESCRIPTION
KIT 1	88049			END HOUSING KIT
		1	1	END HOUSING
		2	1	CLUTCH LEVER
		3	1	SEAL, O-RING
		4	1	CLUTCH LEVER DETENT SCREW
		5	1	RING GEAR, ROTATING
		6	5	CAPSCREW, 10-24
		7	1	GASKET
		8	1	THRUST WASHER
KIT 2	88050			DRUM SUPPORT KIT
		21	1	GEAR SIDE DRUM SUPPORT
		22	1	MOTOR SIDE DRUM SUPPORT
		23	2	BUSHING
KIT 3	97781			TIE PLATE KIT
		24	1	TIE PLATE
		25	4	5/16" BOLTS

KIT 4	88129	7	1	RING GEAR KIT
		13	1	GASKET
		14	1	CARRIER ASSEMBLY, STAGE 3
		33	1	RING GEAR
KIT 5	90902	33	1	SPLINED DRIVE GEAR
		10	1	CARRIER KIT
		11	1	SUN GEAR
		12	1	CARRIER ASSEMBLY, STAGE 1
KIT 6	32455	32	1	CARRIER ASSEMBLY, STAGE 2
		30	1	SHAFT, DRIVE
		31	1	BRAKE KIT
		32	1	COUPLER
KIT 7	900548	33	1	BRAKE
		32	1	SHAFT, DRIVE
		33	1	SPLINED DRIVE GEAR
		40	1	MOTOR KIT
KIT 8	97771	45	1	MOTOR
		54	1	SPACER
		60	1	GROUND BOLT
KIT 9	97776	62	1	CONTROL PACK KIT
		60	1	CONTROL PACK
KIT 10	90796	62	1	CONTACTOR
		6	5	BOLT AND GASKET KIT
		7	1	CAPSCREW, 10-24
		8	1	GASKET
		23	2	THRUST WASHER
		25	4	BUSHING
		54	1	5/16" BOLTS
55	1	GROUND BOLT		
				PARTS PACK
				LABEL KIT

INDIVIDUAL ITEMS

26107	26	DRUM ASSEMBLY
86514	27	WIRE ROPE ASSEMBLY
16463	28	TERMINAL KIT
87452	53	GROUND CABLE
38626	68	REMOTE ASSEMBLY
89214	80	FAIRLEAD, ROLLER

